

100.157

Candle stand for tealights

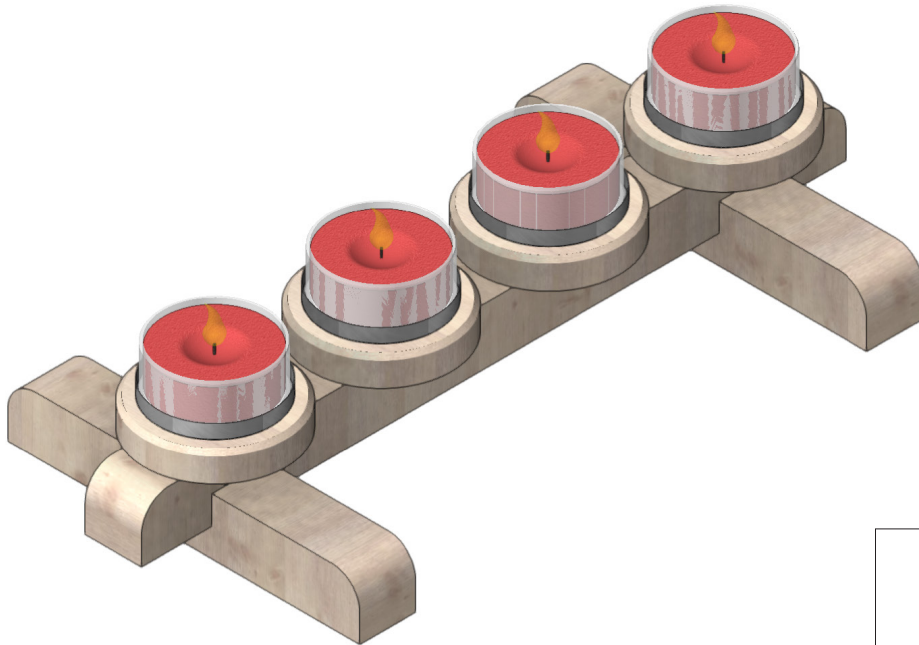

Necessary tools:

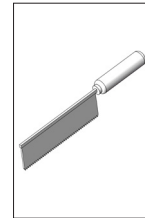

fine saw

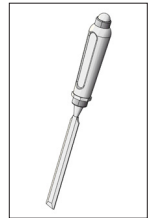

Chisel

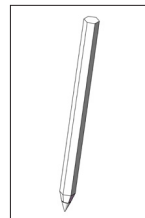

Pencil

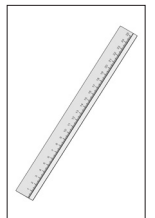

Ruler

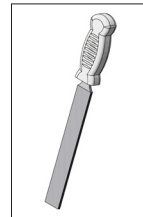

wood rasp

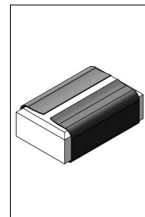

Sandpaper

combination
pliers

Please Note

The OPITEC range of projects is not intended as play toys for young children. They are teaching aids for young people learning the skills of Craft, Design and Technology. These projects should only be undertaken and tested with the guidance of a fully qualified adult. The finished projects are not suitable to give to children under 3 years old. Some parts can be swallowed. Danger of suffocation!

Fire warning: Never leave a candle to burn unattended!!

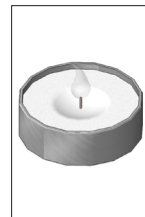

tealight

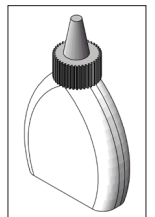

wood glue

Parts List	Quantity	Size (mm)	Designation	Part No.
pine strip	1	250x20x20	Middle bar	1
pine strip	2	125x20x20	Feet	2
Pine disc	4	ø50	Candle holder	3
Tea light holder	4		Tealight holder	4
	4		Attachment of tealight holder	5

Instructions 100.157
Candle stand for tealights

1

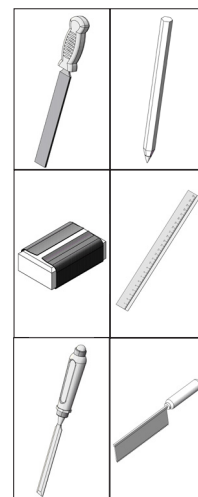
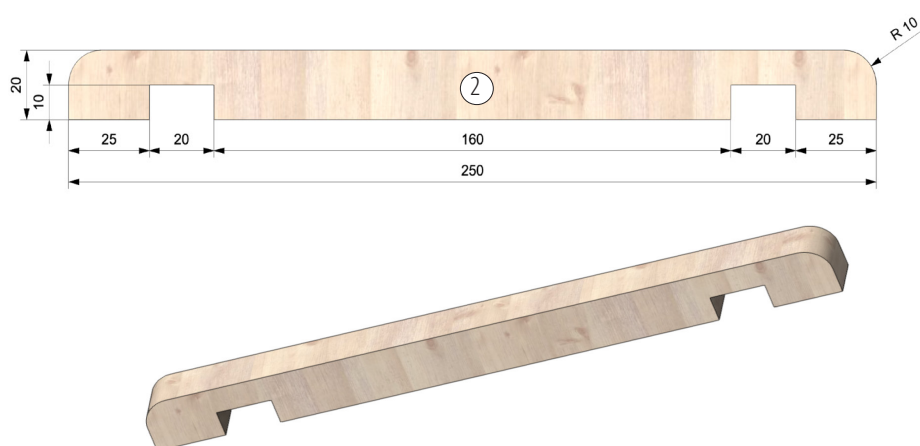

Mark out the measurements on the pine strip 250x20x20 mm (Part 1). Saw and out the joints with a chisel as shown Round off the ends of the stand

2

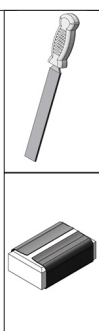
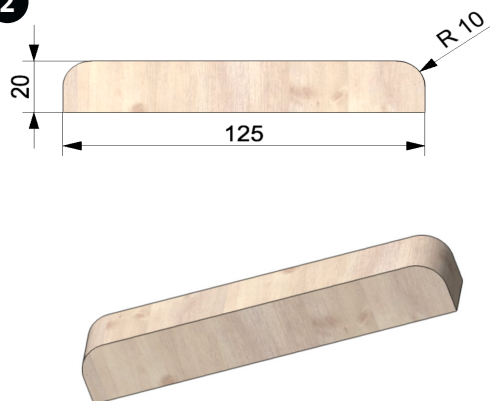

3

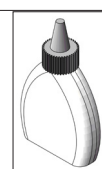
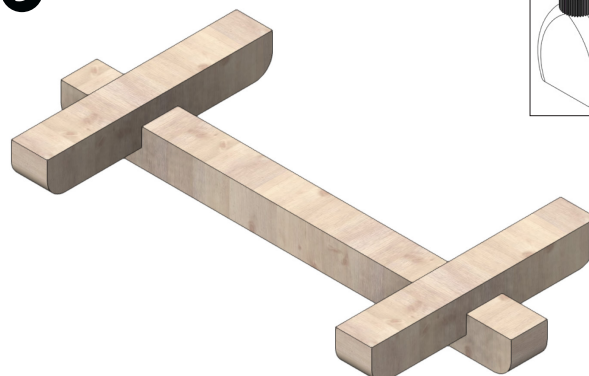

Round off the ends of the pine strip 125x20x20 mm (Part 2).
Sand parts 1 and 2 to finish

Glue the feet (Part 2) into the slots cut out in the stand (Part 1) (See diagram)

4

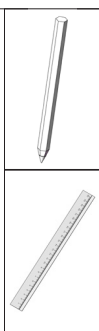

5

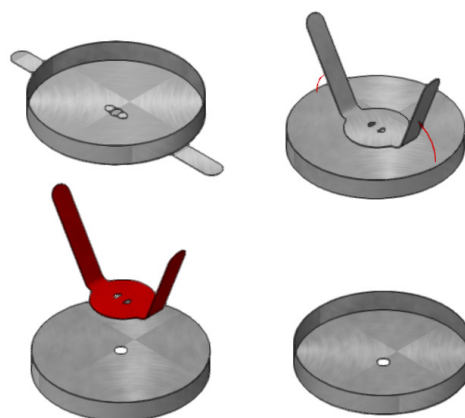

Measure and mark out the middle of the wooden discs (Part 3) (Use a centre finding tool)

Use a pair of pliers to remove the tabs from the tealight holders.

Instructions 100.157
Candle stand for tealights

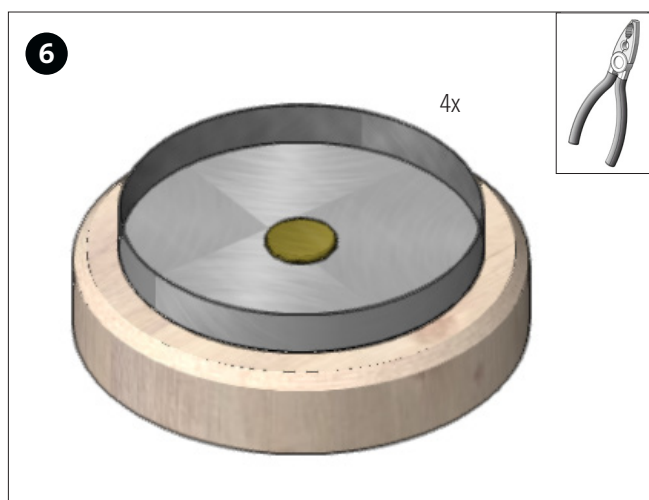

Mount a drop dish on the wooden discs using a drawing pin (part 6) (see diagram)

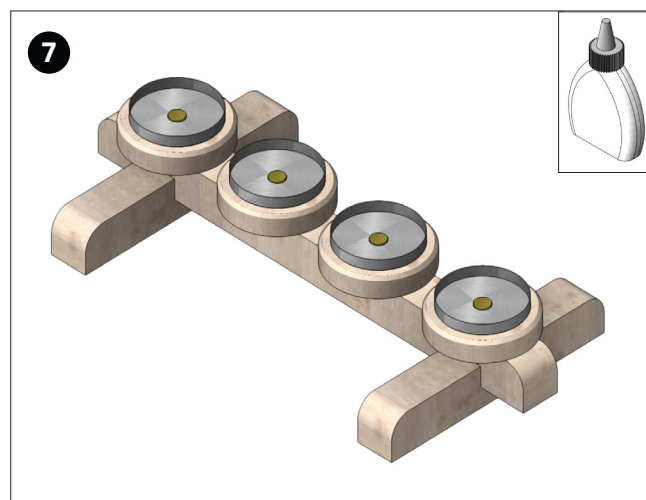

Layout and glue the four holders (Step 4) at equal distance along the stand

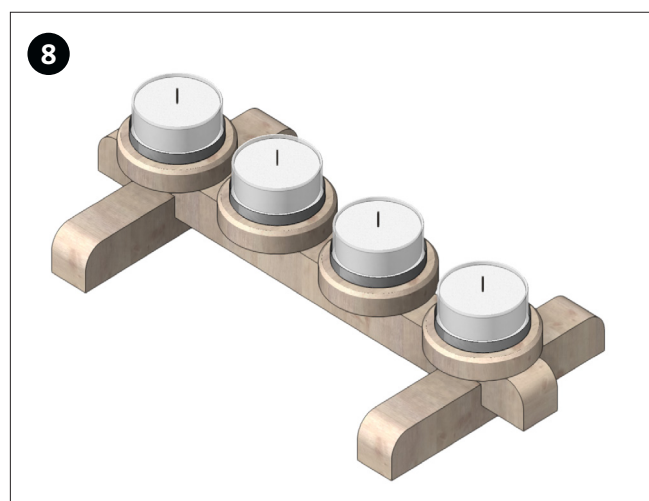

Place the candles in the holders Your project is now finished !