

115.338

# Bird Nesting Box

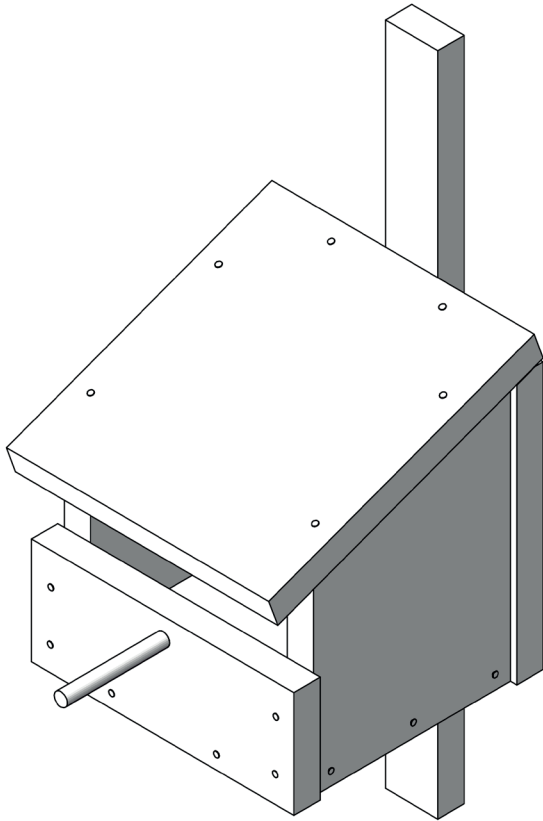

## Required Tools:

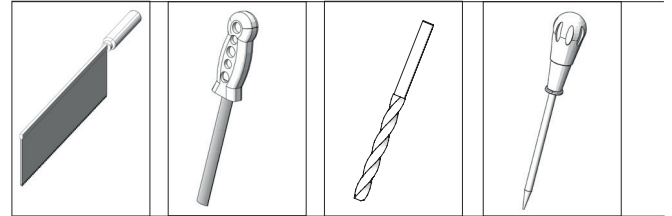

fine saw

rough rasp

drill:  
ø 10mm

pricking awl

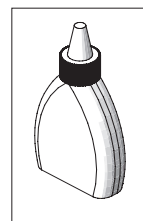

wood glue  
(water proof)

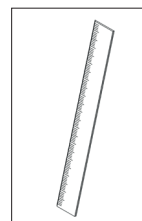

ruler

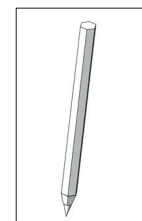

pencil

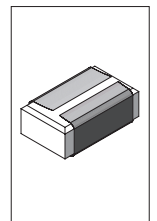

sandpaper

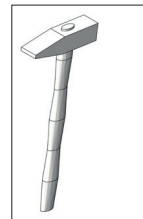

hammer



round file

Contents List	Qty	Size (mm)	Designation	Part No.
wooden board	1	350x150x20	side parts	1
wooden board	1	300x200x20	roof/ frontside	2
wooden board	1	200x200x20	back wall	3
wooden board	1	150x150x20	base plate	4
wooden strip	1	500x40x20	hanging strip	5
round rod	1	ø10x100	perch	6
nails	30		nails	7

## The nesting box is suitable for the following bird species:

dipper, wagtail, grey wagtail, robin, gray-billed catchfly, red-tailed wagtail, and sometimes red-tailed hare

### Please Note!

The Opitec Range of projects is not intended as play toys for young children. They are teaching aids for young people learning the skills of craft, design and technology. These projects should only be undertaken and operated with the guidance of a fully qualified adult. The finished projects are not suitable to give to children under 3 years old. Some parts can be swallowed. Danger of suffocation!

**OPITEC**

## Instructions 115.338 Bird Nesting Box:

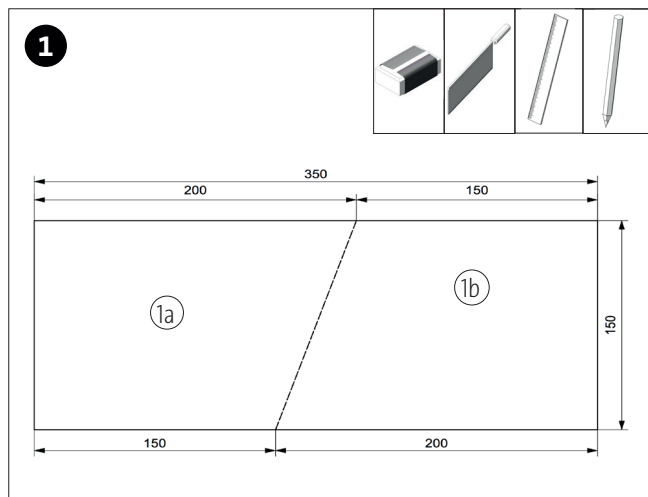

Transfer the dimensions to the wooden board (1). Use the saw to saw apart the wooden board and clean the saw cuts.

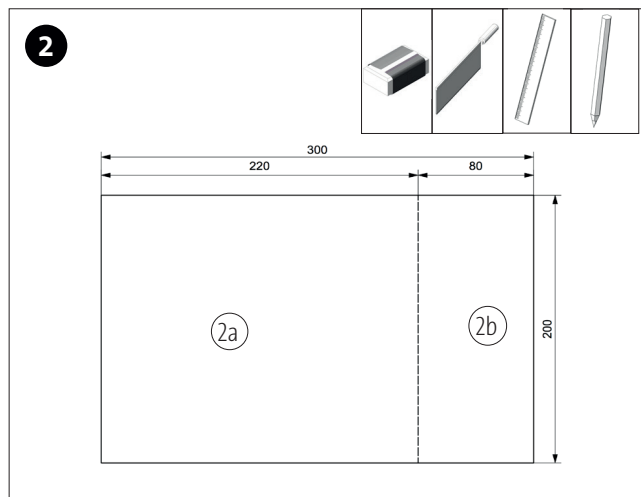

Transfer the dimensions to the wooden board (2). Cut it with the fine saw and clean the saw cuts..

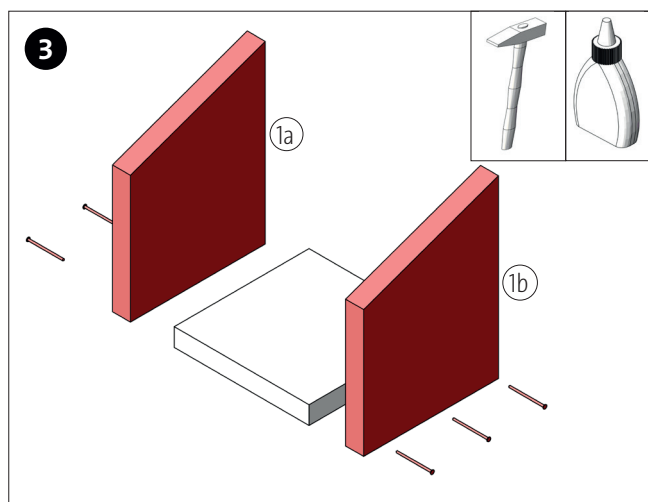

Glue the two side parts (1a + 1b) to the base plate (4) as shown and fix each side with 3 nails (7).

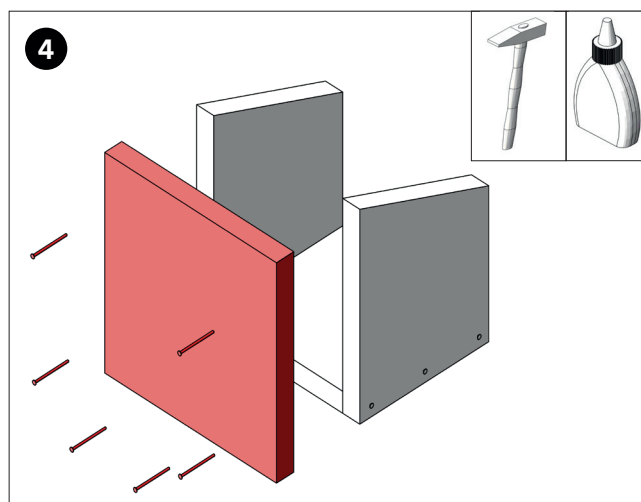

Glue the back wall (3) flush to the sides as shown and fix it with 6-8 nails (7).

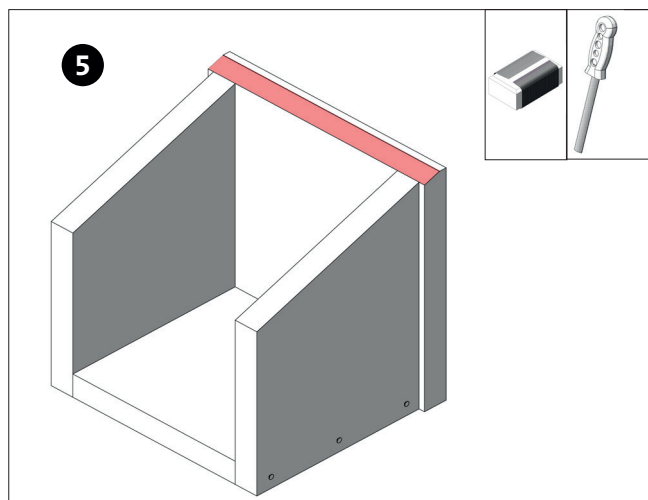

Taper the upper edge of the back wall with the wood rasp and smooth it with sandpaper

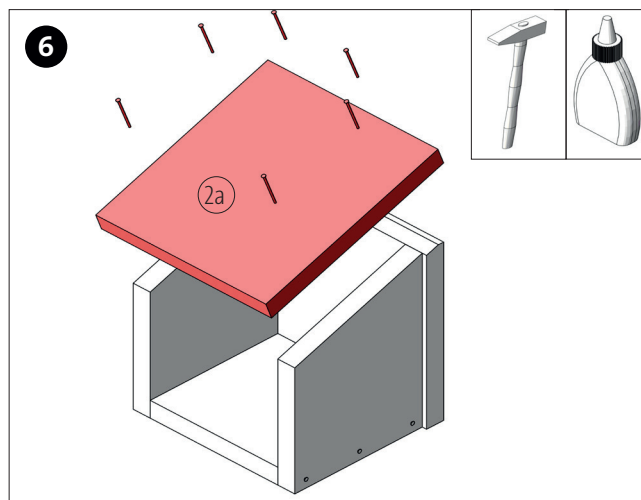

Glue the wooden board (2a) flush to the back wall as shown and fix it with nails (7).

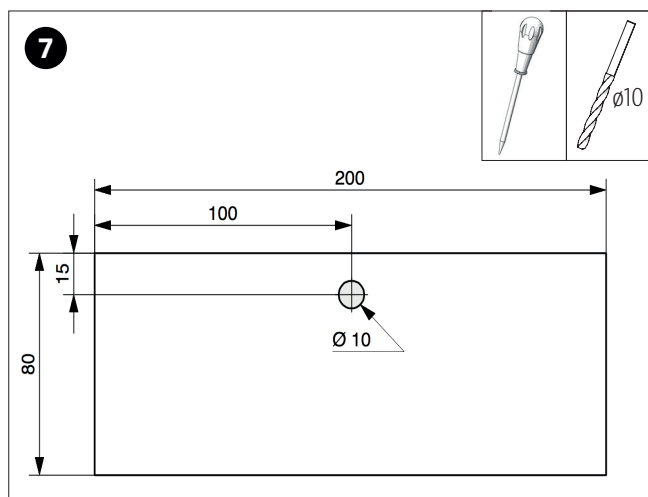

Mark the drill  $\varnothing 10\text{mm}$  with the pricking awl on the wooden board (2a) according to the dimensions and then drill through

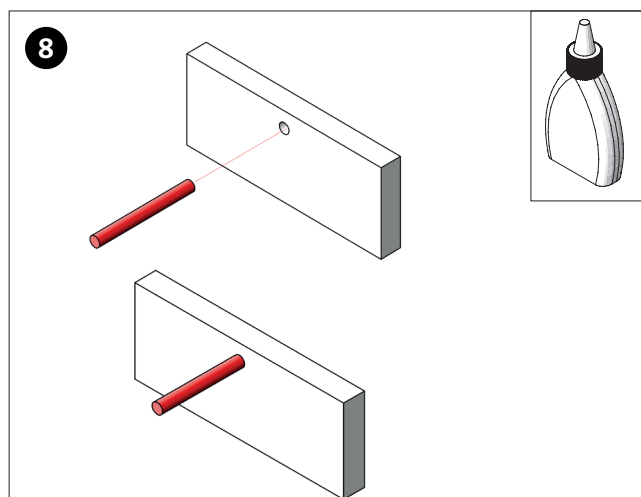

Glue the round rod (6) with wood glue into the hole ( $\varnothing 10\text{mm}$ ) in the wooden board (2a).

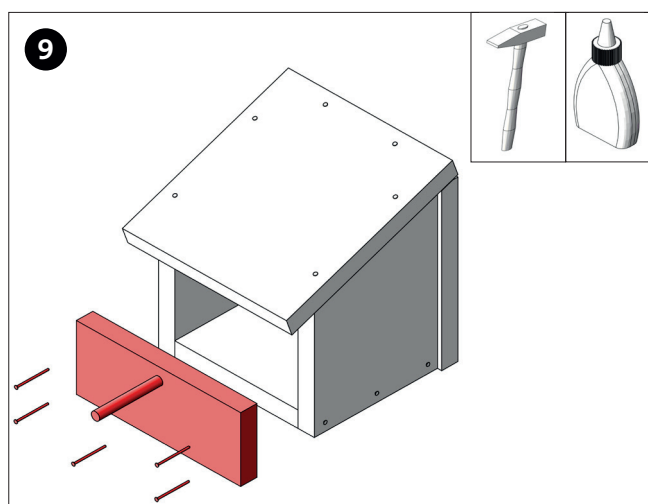

Glue the front panel (2a) as shown and fix it with 4-5 nails (7).

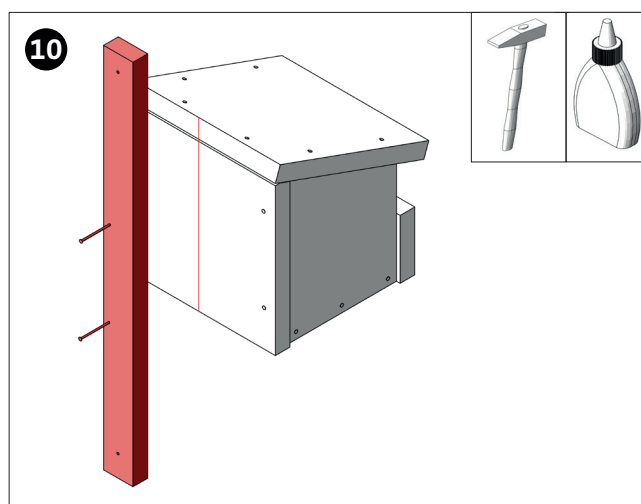

Glue the wooden strip (5) centered to the back wall as shown and fix it with at least two nails (7).

#### Note:

The wooden strip on the back wall is used for mounting on a wall, a tree, etc. For this purpose holes for screws or for wire/ cord can be installed. You can also hammer down a nail (7) in the side parts and attach a cord or a wire to hang it on a branch

#### Notes for species appropriate nesting aid:

The wood, which has been delivered, must not be smoothed and should remain rough. This is important for the fledged boys to leave the nesting box. The animals can not rest on smooth wood! Only wood preservatives which are nontoxic and odorless may be used for impregnation

#### Hanging up the nest box:

Attention must be paid to mount the nest box in sufficient height to ensure protection from natural enemies. Furthermore, the flight hole should be placed away from the main weather direction and it should be protected from direct sunlight. Nest boxes should be hang up in autumn, because some bird species use them as sleeping place in the winter.

#### Cleaning:

Nest boxes should be cleaned annually. This should be done in the non-breeding months. The nest box must be cleaned exclusively with a brush and hot water. The use of cleaning agents should be avoided.