

# 124.395

## Paint rocket

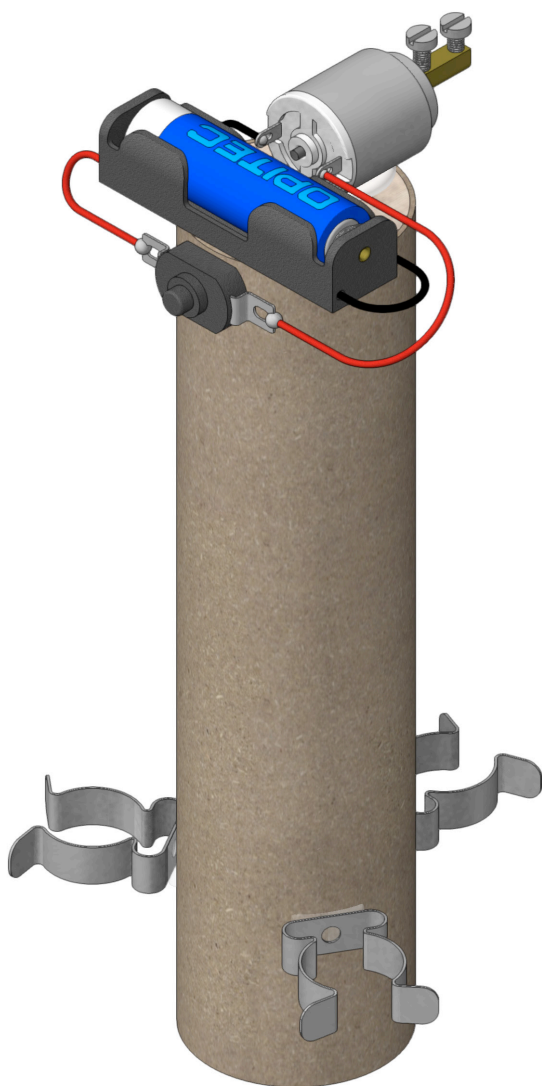

### Tools Needed

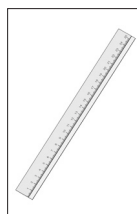

Ruler

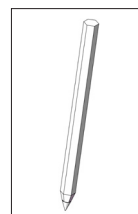

Pencil

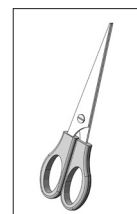

Scissors

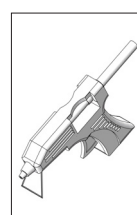

Hot glue

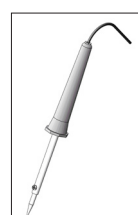

Soldering iron

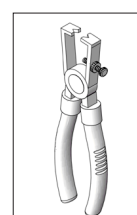

Wire stripper

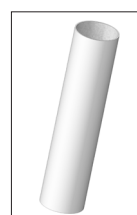

Hard paper roll



Side cutters

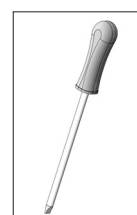

Slot Screwdriver

### Note

After completion, the OPITEC work kits are not articles with toy character of a generally commercial kind, but teaching and learning aids to support educational work. This kit may only be built and operated by children and young people under the guidance and supervision of competent adults. Not suitable for children under 36 months. Danger of suffocation!

Parts list	Number of pieces	Dimensions (mm)	Description	Part no.
Wooden wheel	1	ø40	Cover	1
Battery holder	1		Power source	2
Pressure switch	1		Switch	3
Motor	1		Motor	4
Spring steel clip	3		Pen holder	5
Luster terminal insert	1		Imbalance	6

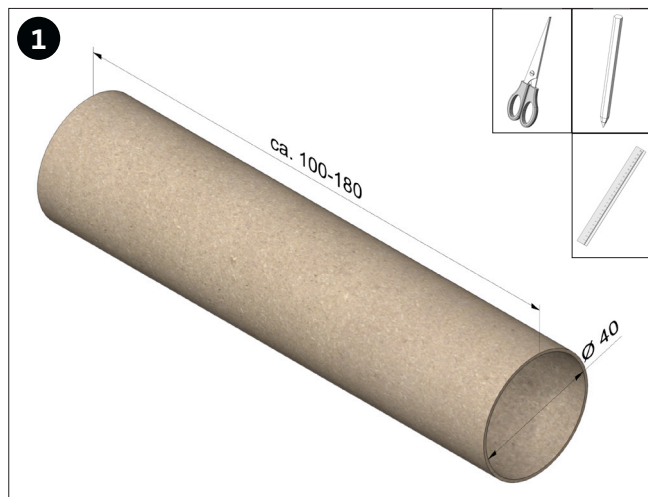

Shorten the hard paper roll (e.g. kitchen roll) to the desired length.  
TIP: Press the hard paper roll together before cutting.

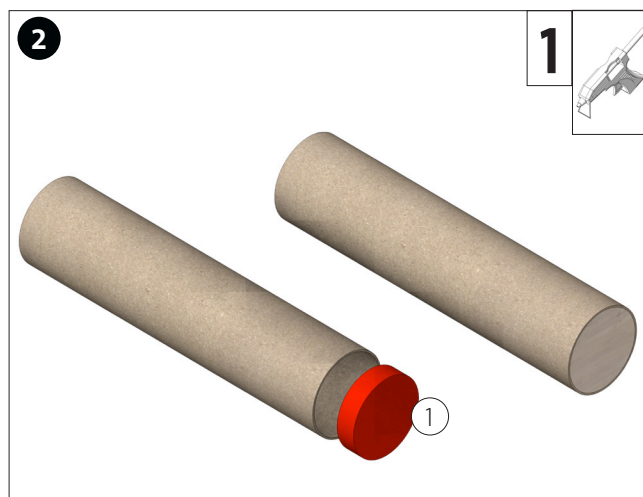

Glue the wooden wheel (1), flush with the outer edge, into the hard paper roll.

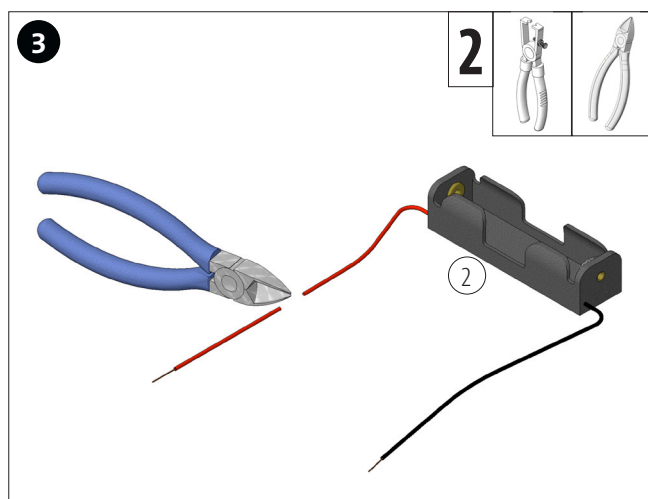

Cut the red wire from the battery holder (2) in half and strip all ends.

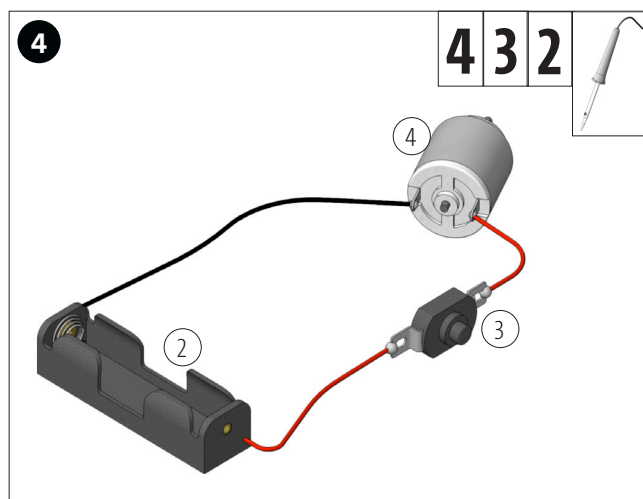

Connect the battery holder (2) to the switch (3) and the motor (4) by twisting or soldering the cables. Then connect the disconnected cable of the battery holder (2) to the free terminals of the switch (3) and the motor (4).

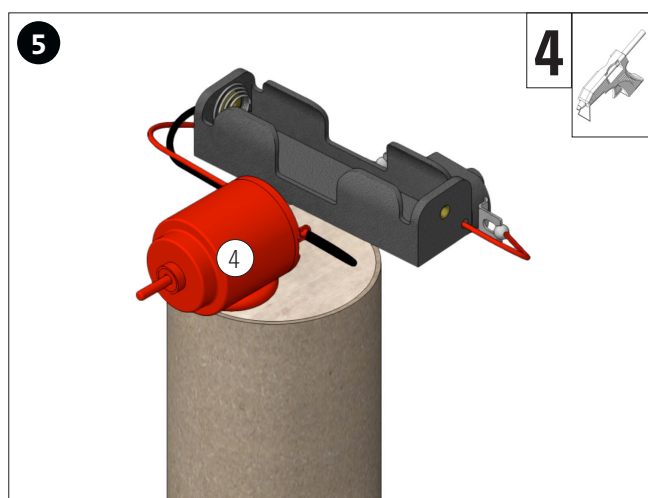

Glue on the motor (4) as shown.

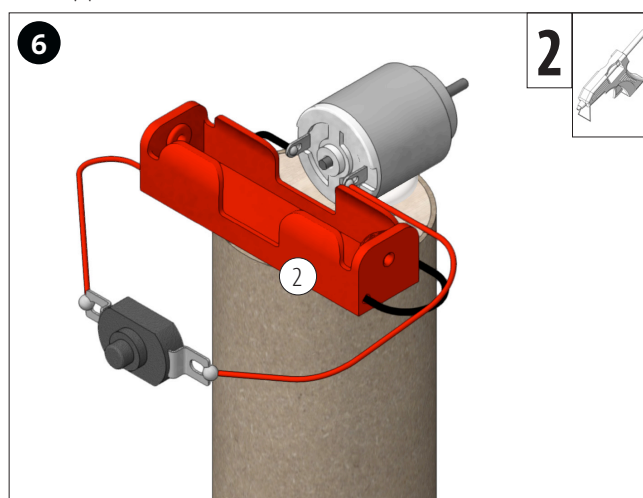

Glue on the battery holder (2) as shown.

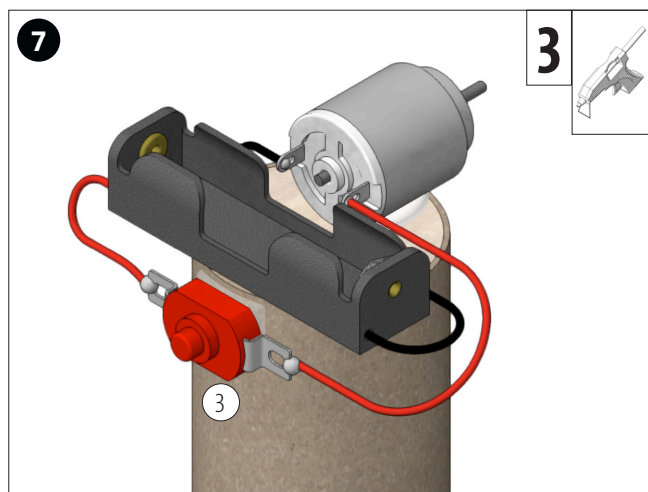

Then glue the switch to the side of the kitchen roll.

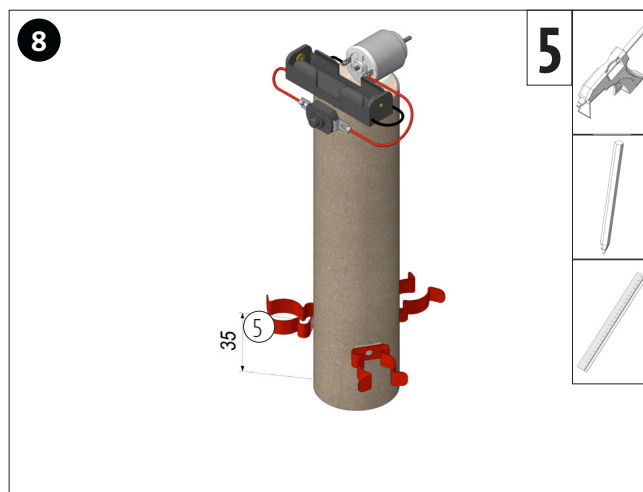

Measure 35mm from the bottom edge of the hard paper roll. Then glue on the 3 spring steel clips (5) rotated by 120°.

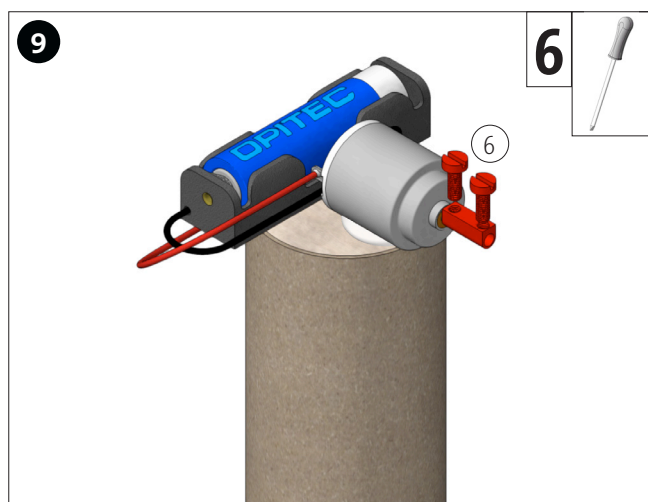

Push the luster terminal insert (6) onto the motor shaft as shown and screw tight.  
Insert battery and check function!

Done!

Insert three colored pencils (we recommend item no. 539099 - Funtustics children's fiber pens) into the spring steel clips as shown.

Place the paint rocket on a large sheet of paper and turn on the switch.

