

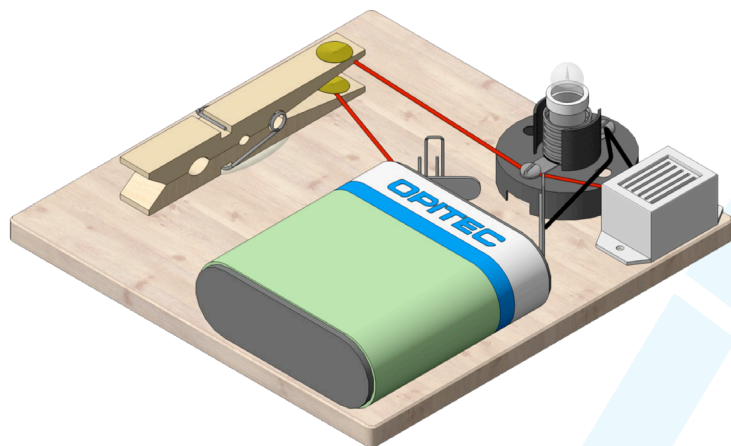

125,656

Morse apparatus

SCAN ME!



Tools Needed:



Phillips screwdriver

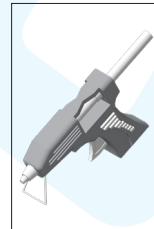

hot glue gun

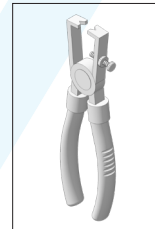

wire stripper

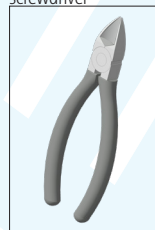

side cutters

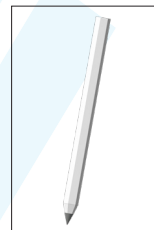

pencil

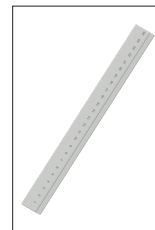

ruler

Please Note:

After completion, the OPITEC factory packs are not toys that are generally commercially available, but teaching and learning materials to support educational work. This kit may only be built and operated by children and young people under the guidance and supervision of knowledgeable adults. Not suitable for children under 36 months. Danger of suffocation!

parts list	number of pieces	Dimensions (mm)	Description	Part No.:
plywood panel	1	126x126x6	Ground Plate	1
Clothespin	1	72x10	switch	2
thumbtack	2	ø9x7	Switch contact	3
Lamp holder	1	E10		4
LED bulbs	1	E10	Signal generator optical	5
buzzer	1	30x20	Signal generator acoustic	6
Flat battery 4.5V	1		power source	7
Electrical Wire	1	500	Conductor	8
paperclip	2	26	Battery contact	9

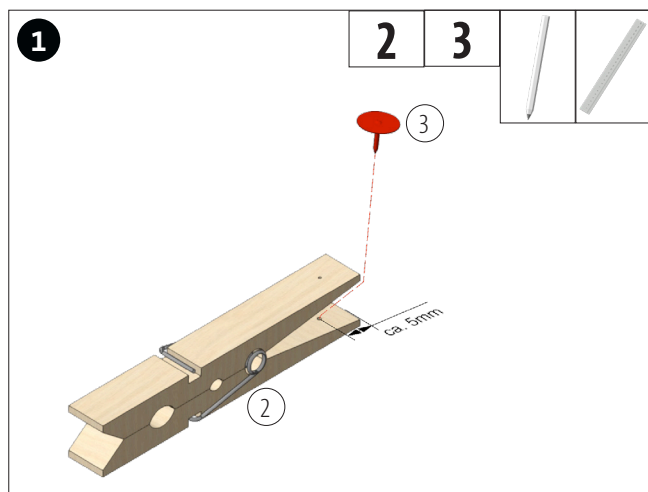

Switch assembly: Push a thumbtack (3) into the lower clothespin leg as shown

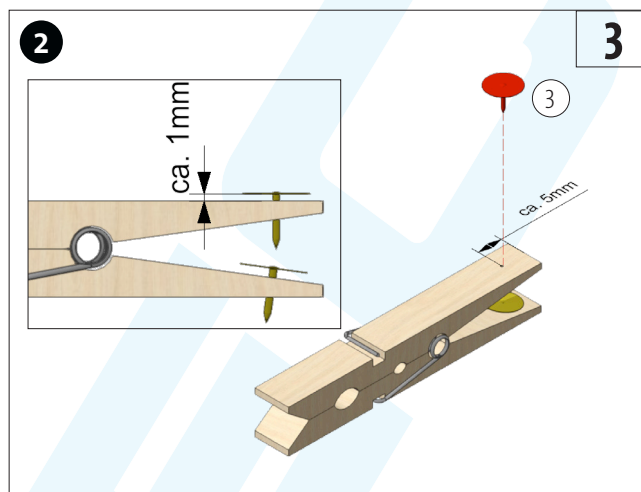

Press the second thumbtack (3) into the upper leg of the clothespin as shown in the picture. Do not press both thumbtacks in completely, as the cables will be wrapped around this later.

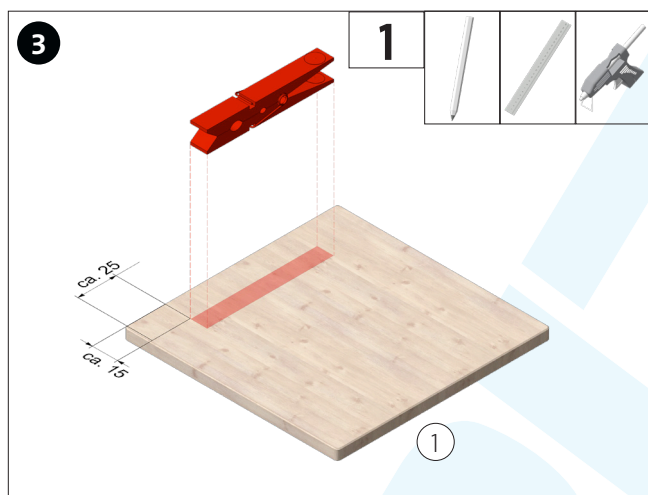

Glue the prepared clothespin to the position shown with hot glue.

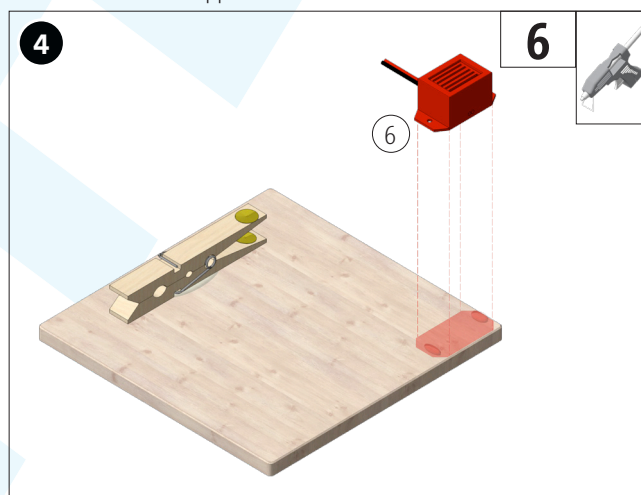

Glue the buzzer (6) to the plate with 2 dots of hot glue under the tabs, with the cable pointing towards the clothespin.

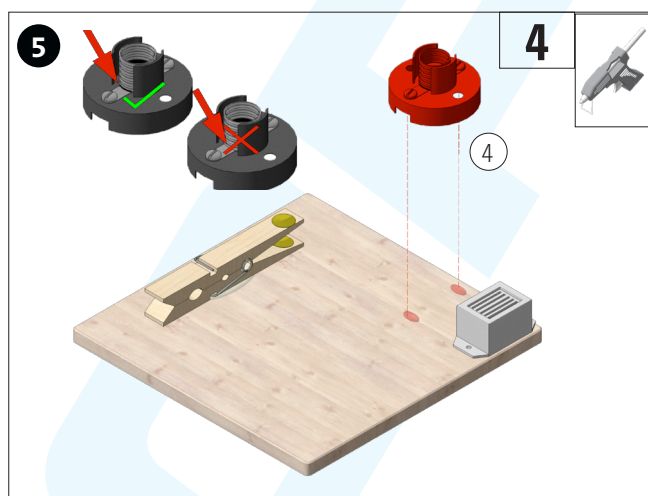

Glue the lamp holder (4) next to the buzzer. Make sure it is aligned correctly: visible insulating disc facing forward (positive pole)!

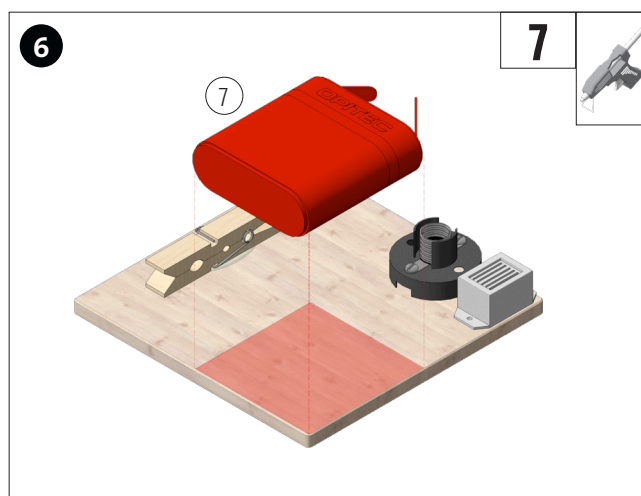

Glue the flat battery (7) in the bottom right corner, short flag to the left (positive pole).

Assembly instructions 125.656 Morse apparatus

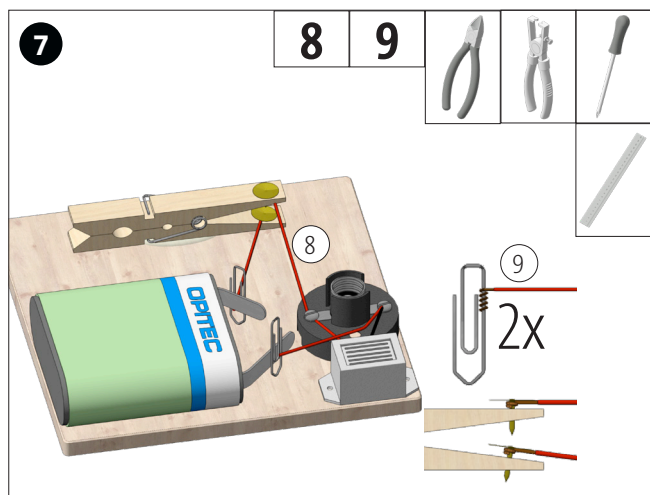

Cut 3x 150mm wires to length, strip approx. 20mm on both sides. Twist and wire as shown in the picture, see also circuit diagram in the next picture. Caution: Only loosen the screws of the bulb holder slightly, do not unscrew them completely!

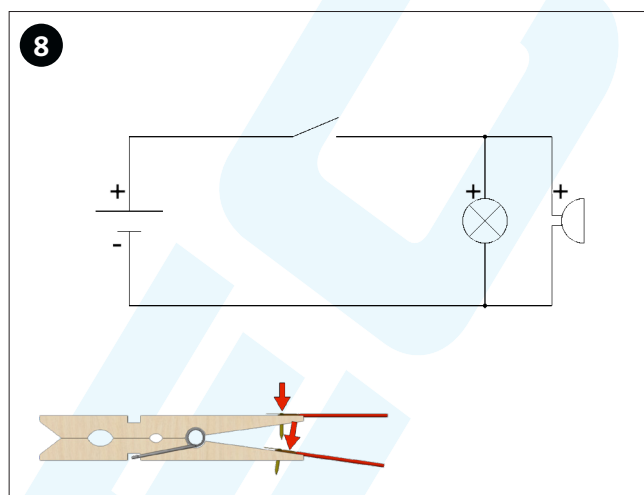

Press the thumbtacks firmly to clamp the cables

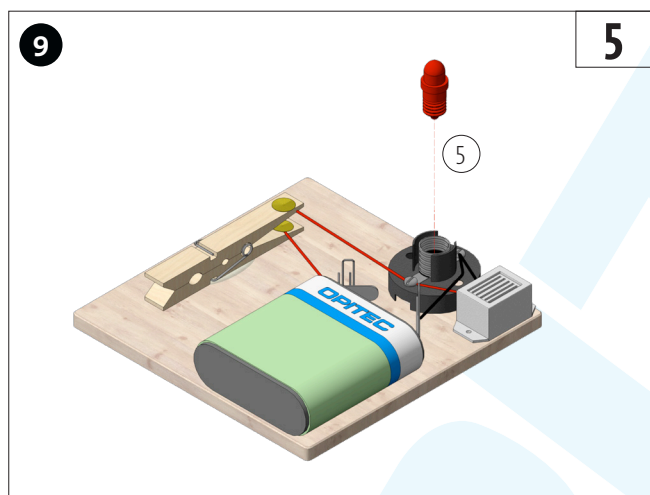

Screw in the lamp (5)

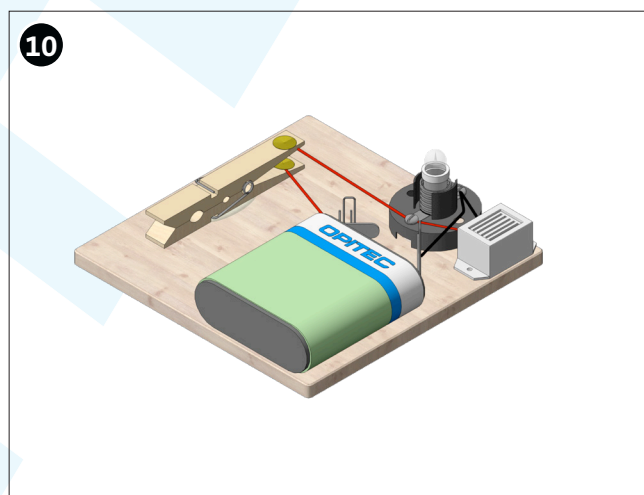

Done!