

# 112.743 Modern Candle-Light

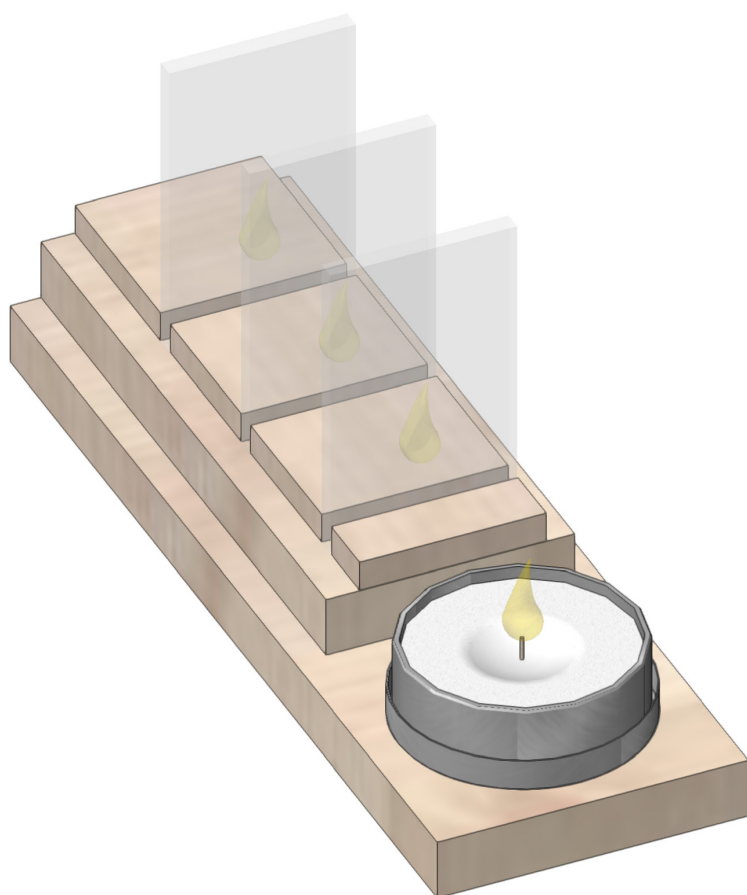

## Necessary tools:

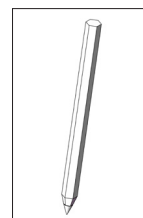

Pencil

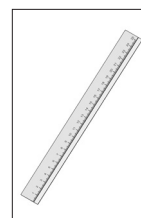

Ruler

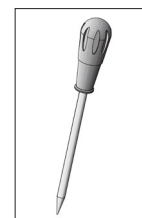

Hole maker

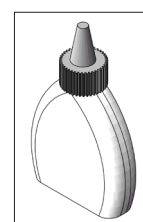

Wood glue

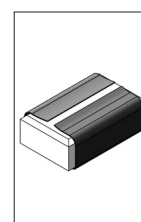

sandpaper



Combination  
pliers

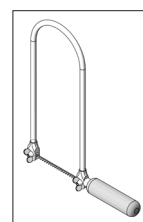

Fretsaw



Tea light

### Please Note

The OPITEC range of projects is not intended as play toys for young children. They are teaching aids for young people learning the skills of Craft, Design and Technology. These projects should only be undertaken and tested with the guidance of a fully qualified adult. The finished projects are not suitable to give to children under 3 years old. Some parts can be swallowed. Danger of suffocation!

Parts List	Quantity	Size (mm)	Designation	Parts No.
Wood strip	1	150x50x10	Base	1
Wood strip	1	150x40x10	Spacer	2
Wood strip	1	150x30x5	Holder acrylic sheet	3
Acrylic sheet	1	161x30x3	Reflector wall	4
Tea light holder	1	ø40	Tea light holder	5
Drawing pin	1		Fixing	6

Instructions 112.743  
Modern Candle-Light

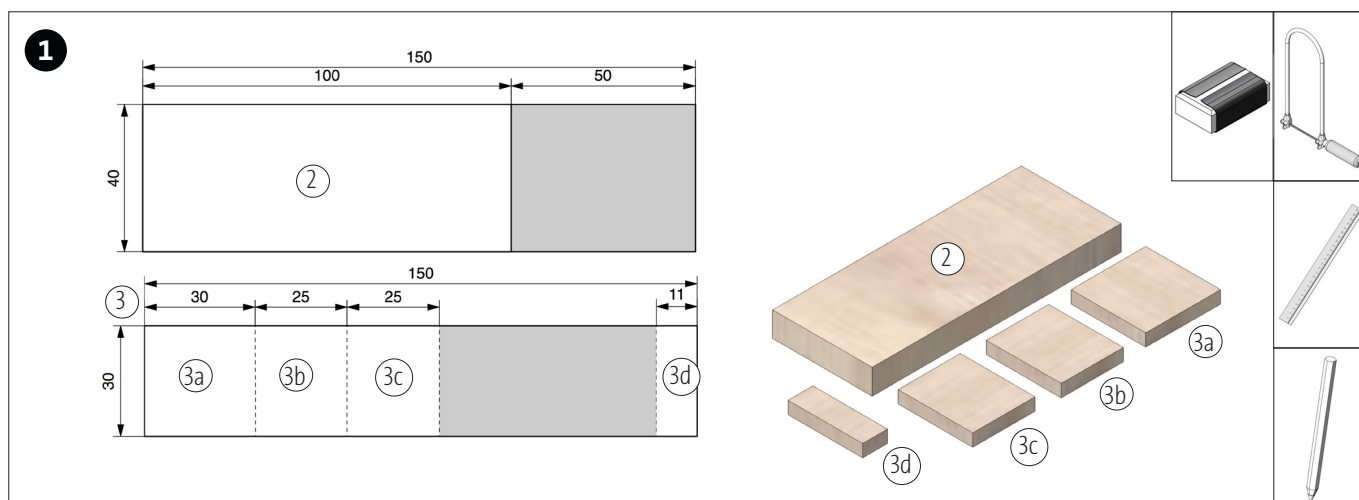

Mark out and saw the three wood strips 1, 2 and 3 according to the plan ( page 5) and sand the ends

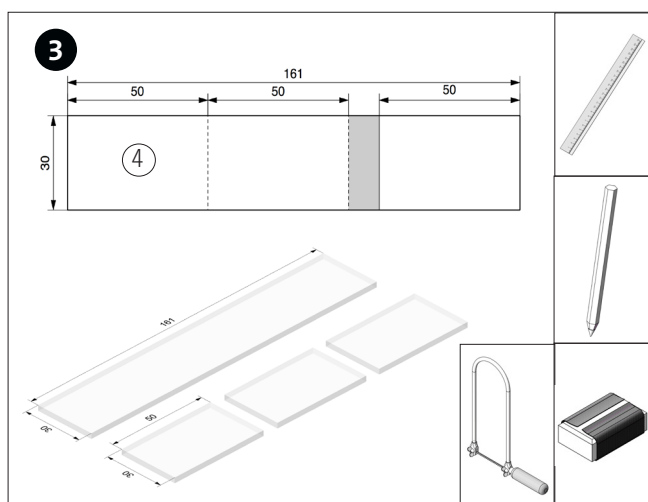

Saw out the acrylic pieces ( 4) according to the patterns (Page 5). Clean up the edges carefully.

**Note:** Do not remove the protective foil!

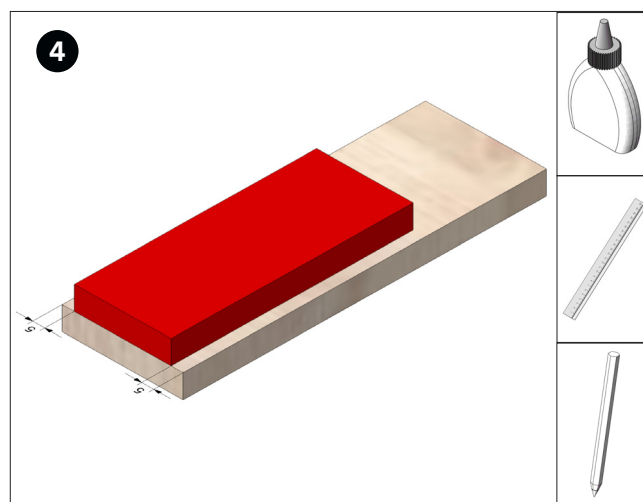

Take the wood pieces (2) and glue them on to wood strip 1 as shown

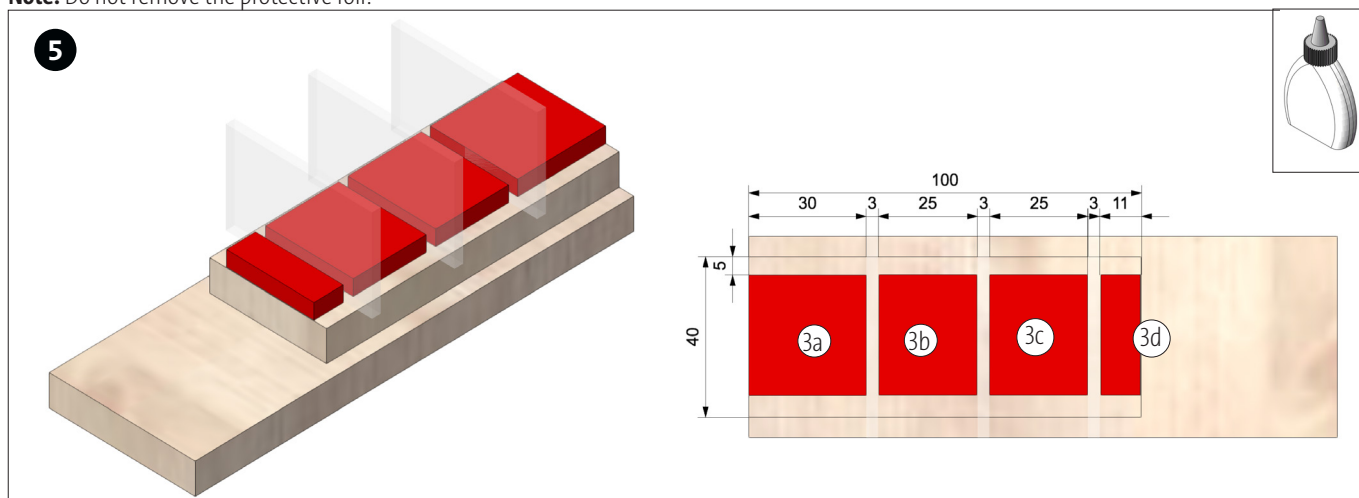

Take the pieces sawn from the wooden length (3) and glue them on top (2). The gap between them is 3mm for the acrylic pieces to slot in between

**Instructions 112.743**  
**Modern Candle-Light**

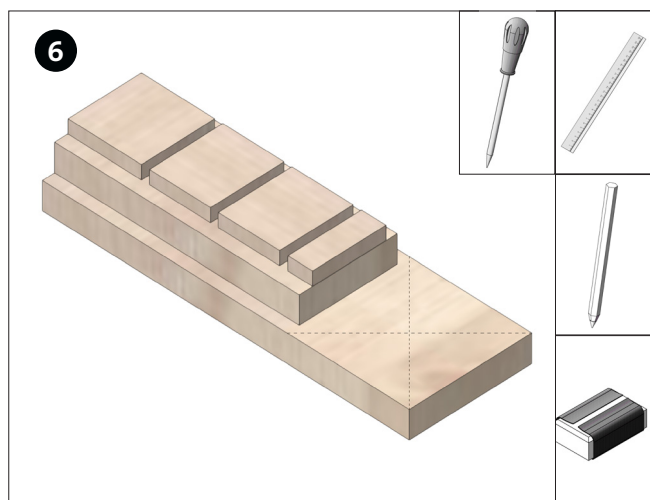

Take the wood strip (1) and mark out the middle by using two diagonals and on the middle point use a bradawl or holemaker. Sand all the parts and decorate at this stage

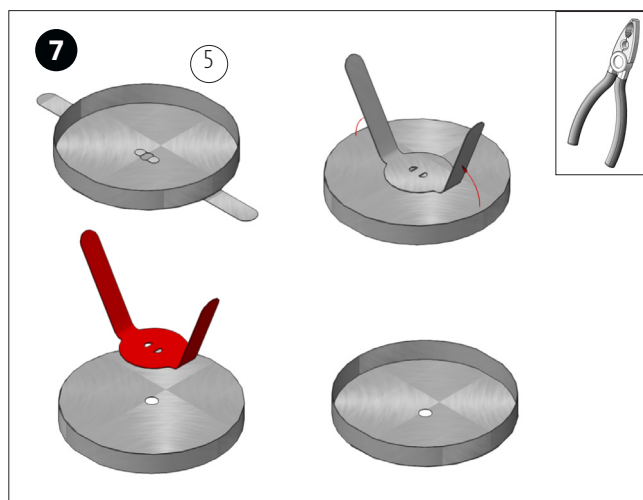

Remove the tabs on the back of the tea light holder (5) with a pair of combination pliers.

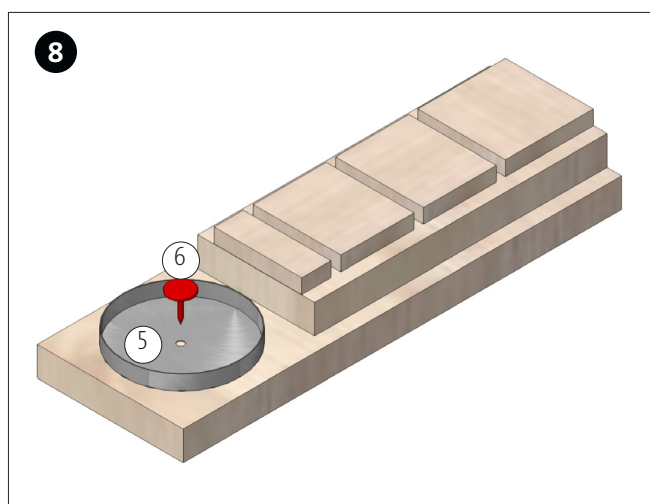

Fix the tea light holder (5) with a drawing pin (6) on the wooden strip (1).

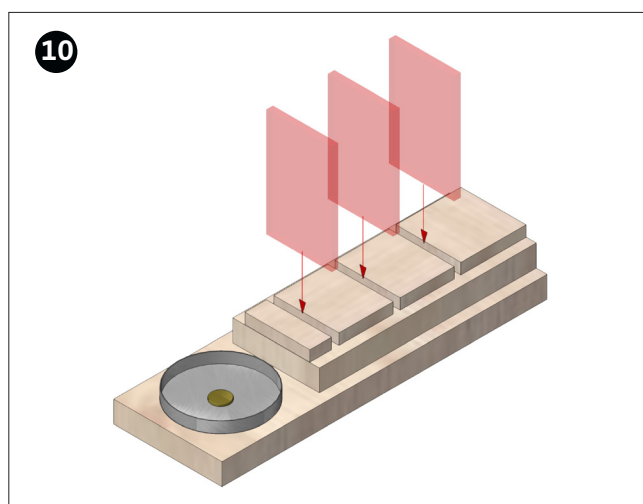

Take the finished acrylic glass reflectors ( see step 2) and insert them between the blocks (3)

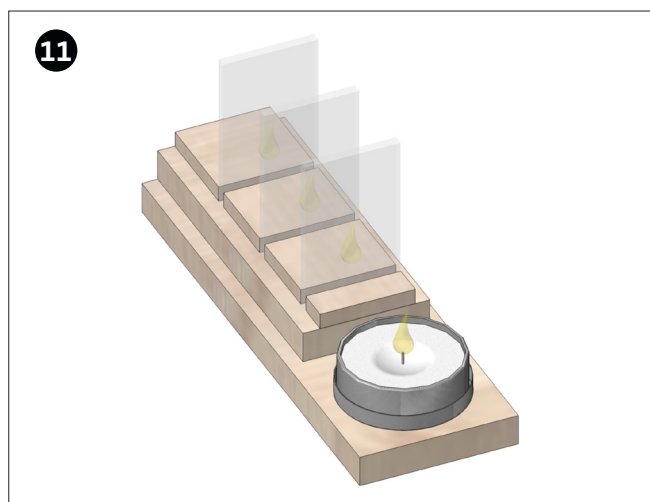

Place a tea light candle in the holder and light it. The flame should reflect in the acrylic pieces creating an optical illusion of four candles burning. Removing one sheet of acrylic gives you the effect of 3 candles burning and so on



Pattern for wooden strip 2,3  
M 1:1

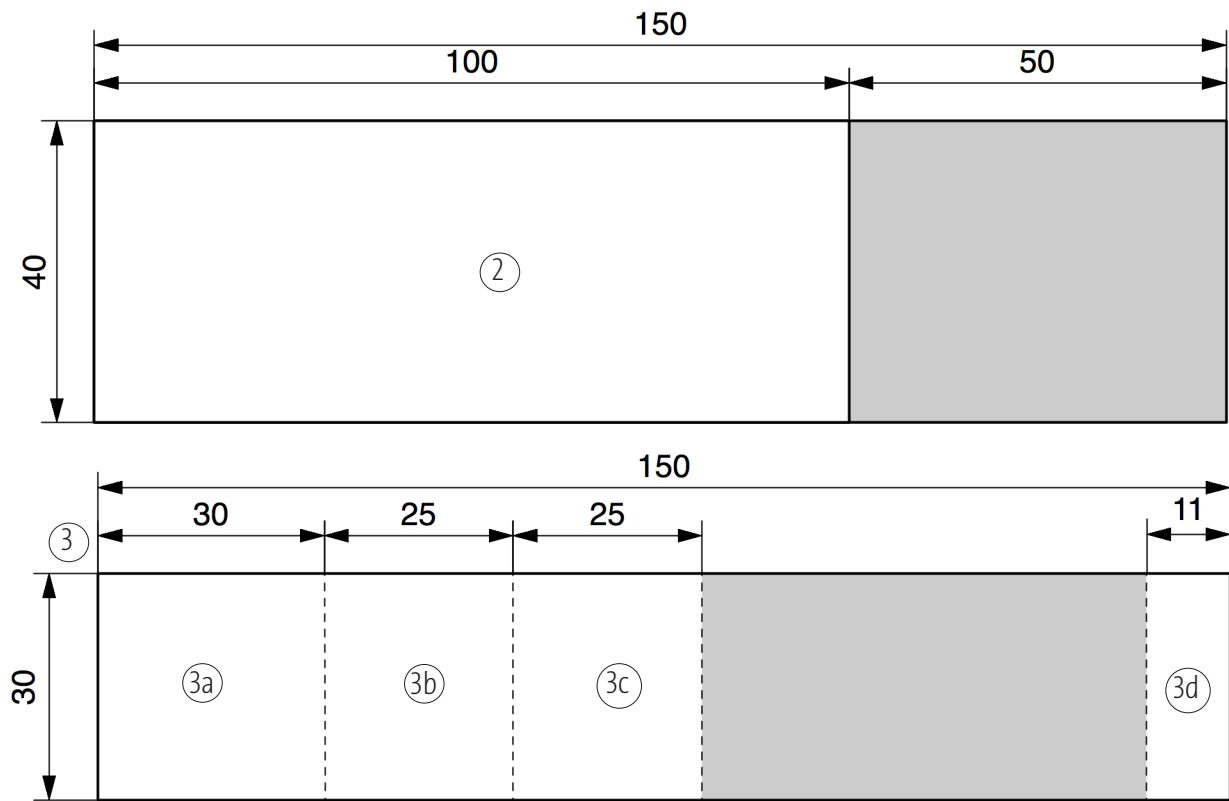

Pattern for acrylic sheet  
M 1:1

