

106.809

# Table top nutcracker

## Necessary tools and equipment:

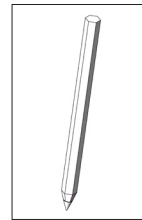
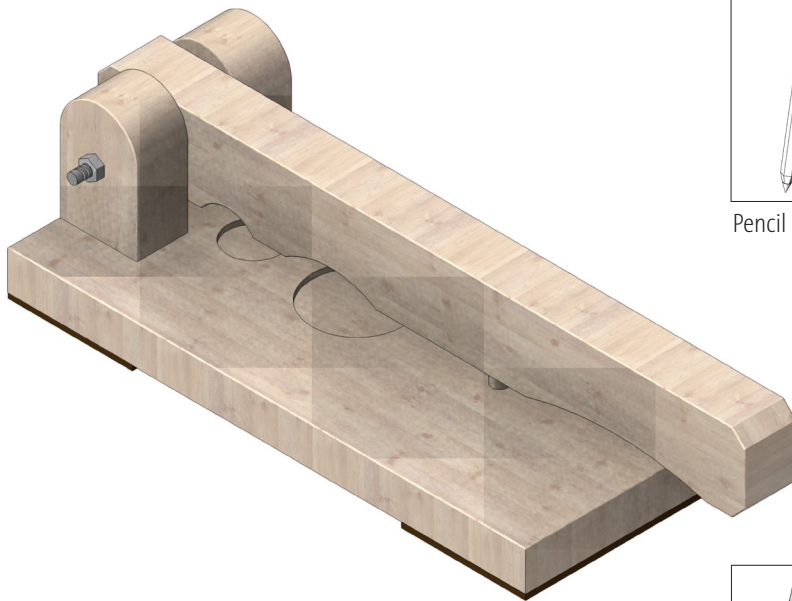

Pencil

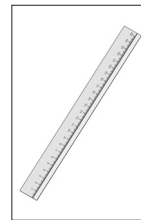

Ruler

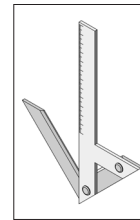

Try square

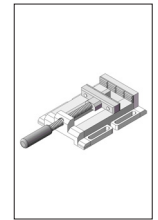

Machine vice

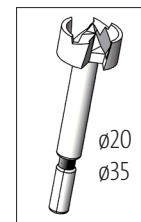

Forstner bit

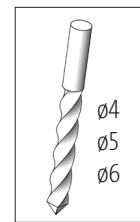

Drills

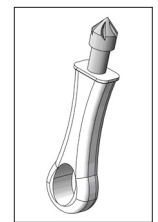

Countersink bit

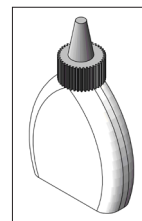

Wood glue

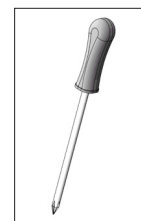

Fine saw



saw guide



Spanner

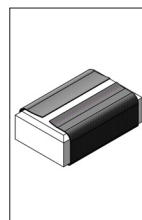

Sandpaper

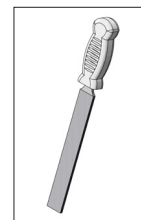

Rasp

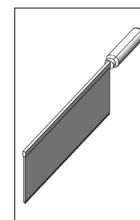

Crosshead screwdriver

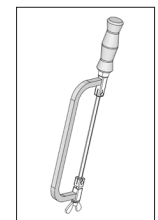

Metal hacksaw

### Please Note

The OPITEC range of projects is not intended as play toys for young children. They are teaching aids for young people learning the skills of Craft, Design and Technology. These projects should only be undertaken and tested with the guidance of a fully qualified adult. The finished projects are not suitable to give to children under 3 years old. Some parts can be swallowed. Danger of suffocation!

Parts List	Quantity	Size (mm)	Designation	Part No.
Plywood sheet	1	15x100x200	Plywood sheet	1
Pine strip	1	20x30x100	Pine strip	2
Pine strip	1	250x30x20	Pine strip	3
Pine dowel	1	ø6x50	Pine dowel	4
Brass tube	1	5diax15	Brass tube	5
Set screw	1	M4x70	Set screw	6
Stop nut	1	M4	Stop nut	7
Screws	2	ø3x25	Screws	8
Set screw	2	ø4x16	Set screw	9
Modelling foam	1	95x90x2	Modelling foam	10

**Instructions 106.809**  
**Table top nutcracker**

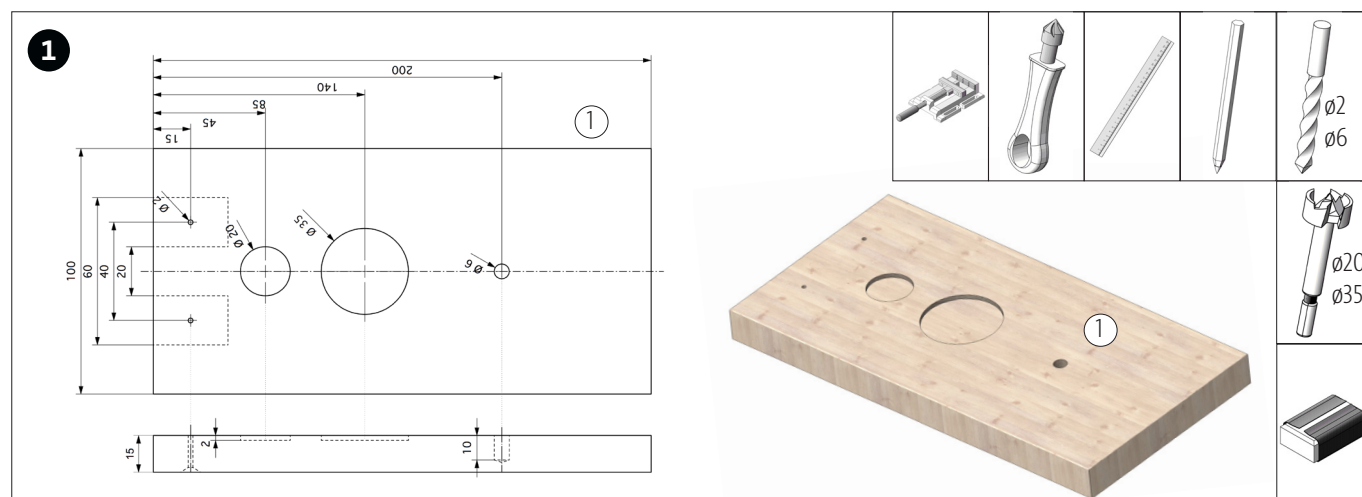

Mark out the base (1) 15x100x200mm as shown in the plans. Drill the holes 20 and 35mm diameter, 2mm deep only - do not drill all the way through! Drill the 2x2mm holes and countersink them underneath - sand the base to finish.

**Note:** Please drill carefully when using a forstner bit. It is important that the work is held securely when drilling. Ask a teacher to check before starting and adhere to the normal safety procedure-apron, safety glasses, hair tied back etc

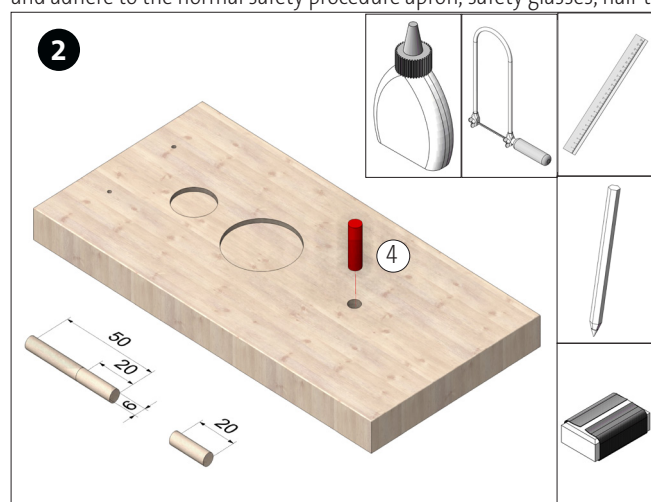

Cut the dowel 6x50mm to 20mm long and place in the 6mm hole.

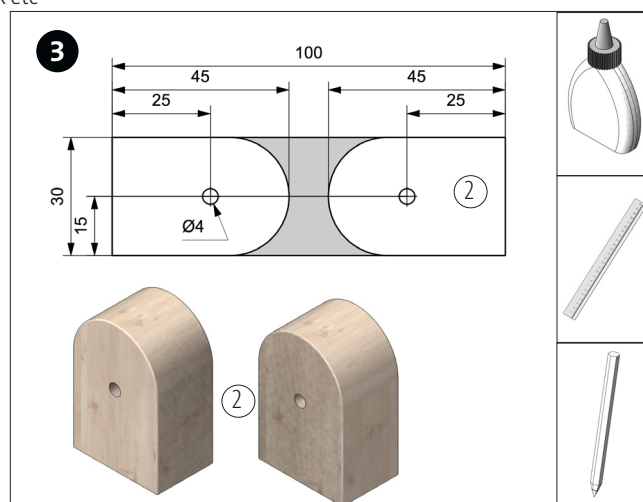

Trace the bearing blocks x2 on to the pine 20x30x100mm and drill the 4mm hole. Place the blocks together and sand them to finish.

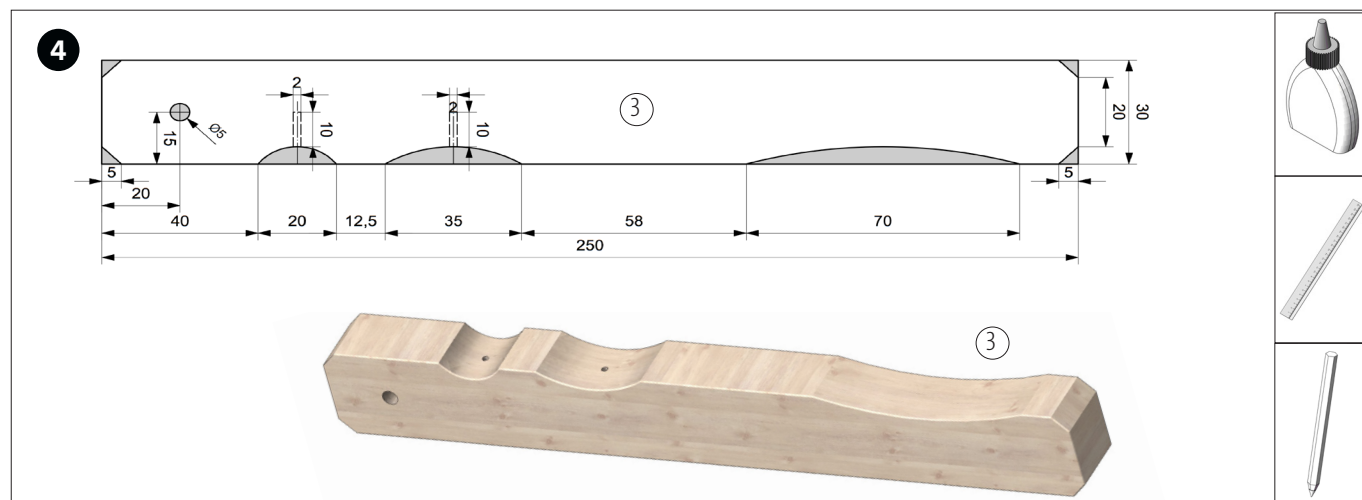

Take the lever (3) 20x30x250 and mark it out according to the plan-drill the 5mm and 2mm holes. Finally saw out the shape and sand to finish.

**Instructions 106.809**  
**Table top nutcracker**

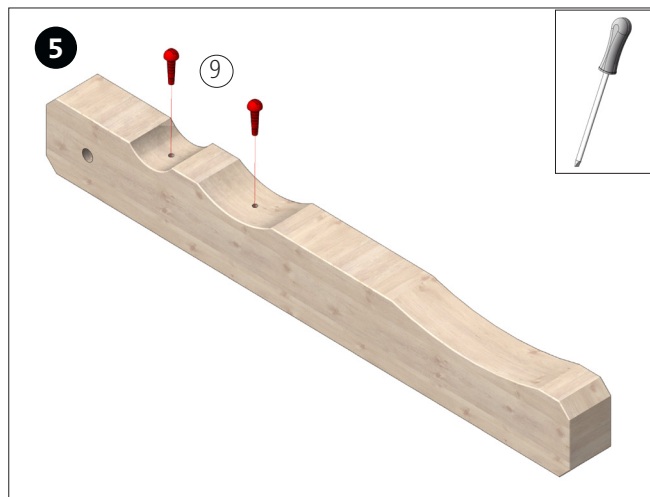

Insert the screws (9) in the 2mm holes.



Press the brass tube (5) in the bearing blocks.

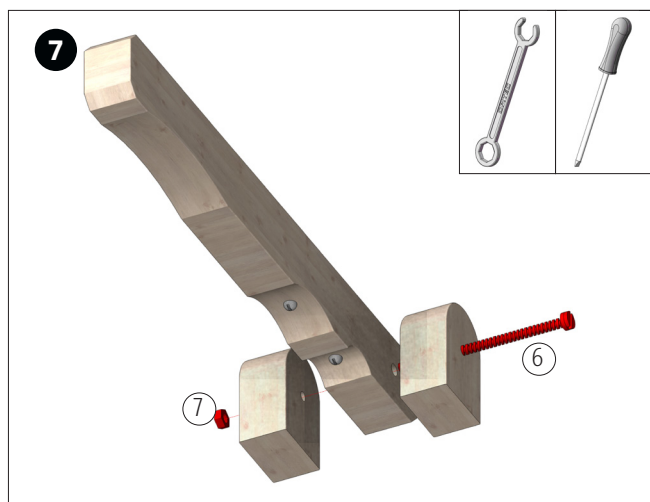

Connect the lever and bearing blocks (6) and stop nut (7) so that the lever is easy to use.

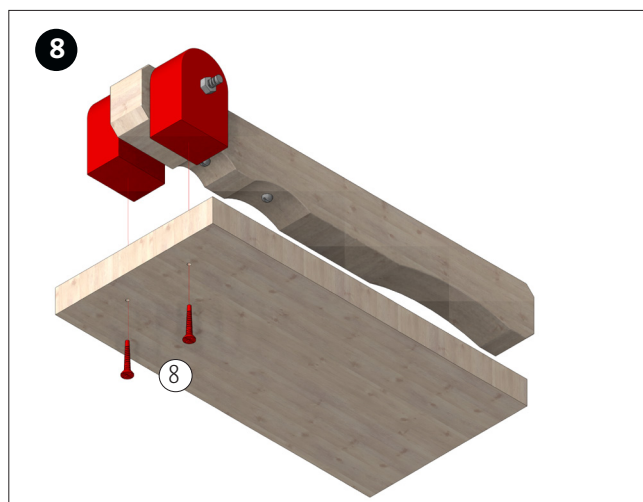

Connect the lever and bearing blocks (6) and stop nut (7) so that the lever is easy to use. Place the bearing blocks on the base and screw them centrally in place from underneath through the pre-drilled 2mm holes using the screws.

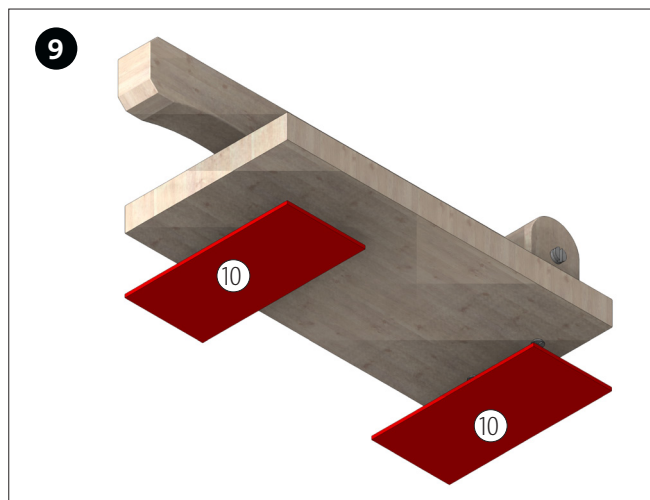

Finally glue a piece of modelling foam underneath to make a non slip surface.

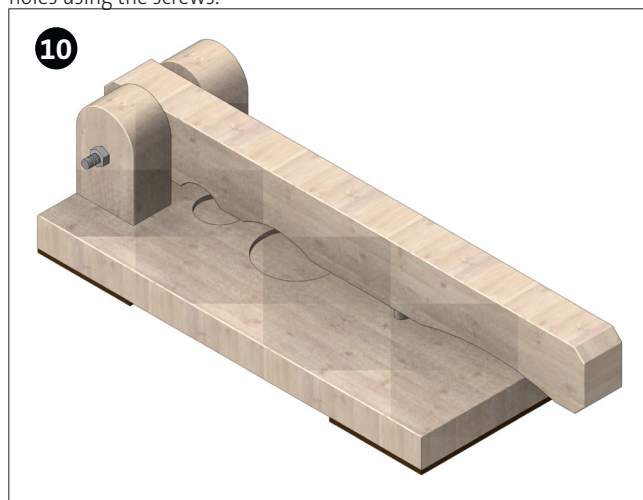

Once tested the table top nutcracker can be decorated. Any excess thread on the set screw (6) up to the stop nut (7) can be sawn off with a junior hacksaw and filed flat.



