

124.362

Step ball track drive set

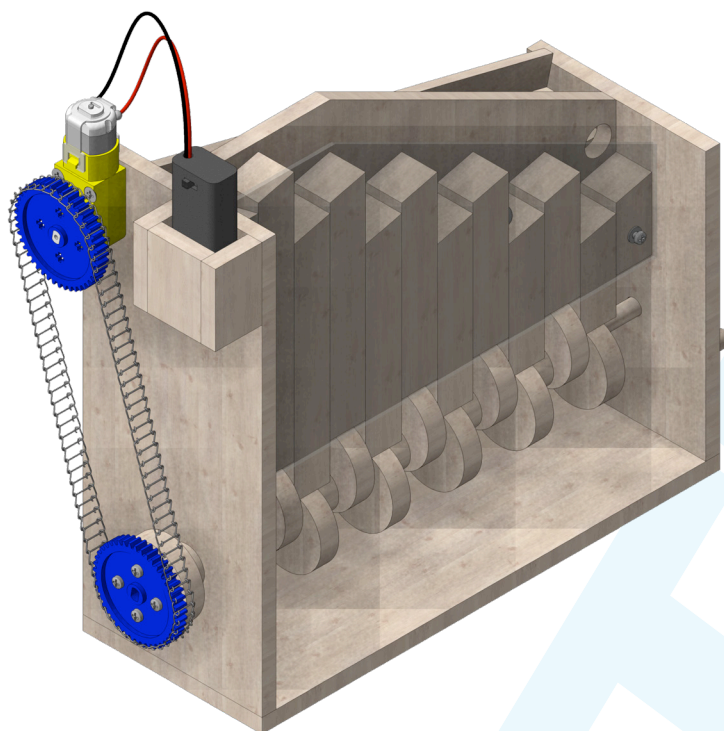

Tools required:

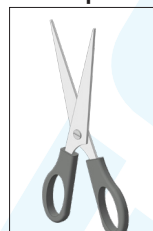

Scissors

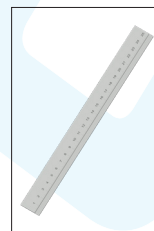

Ruler

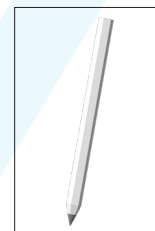

Pencil

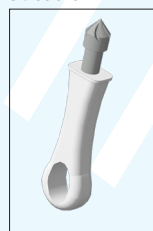

Hand countersink

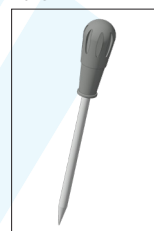

Prickling Awl



Twist drill



Wood Glue

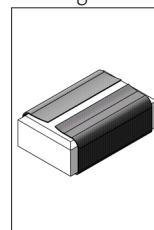

Sand paper

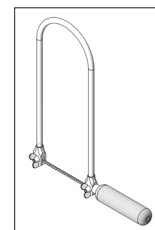

Jigsaw



Soldering iron



Screwdriver



Combination pliers

NOTE:

After completion, the OPITEC work kits are not articles with toy character of a generally commercial kind, but teaching and learning aids to support educational work. This kit may only be built and operated by children and young people under the guidance and supervision of competent adults. Not suitable for children under 36 months. Danger of suffocation!

Parts list	Quantity	Dimensions (mm)	Designation	Part no.
Softwood wheel	1	ø40x10		11
Battery holder	1	250x20x20		12
Gear motor	1	250x20x5		13
Gear wheel	2	z45		14
Gear wheel	1	z30		15
Metal chain	1	450		16
Spacer rolls	4	ø5x10		17
Screw	2	ø3x25		18
Screw	4	ø2,9x13		19

Instructions 124.362
Step ball track drive set

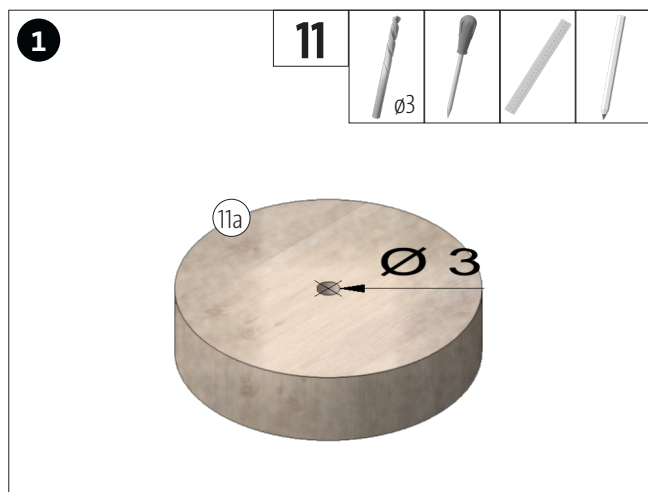

Prick the wooden wheel (6) according to template (G) and pre-drill with $\varnothing 3$ mm.

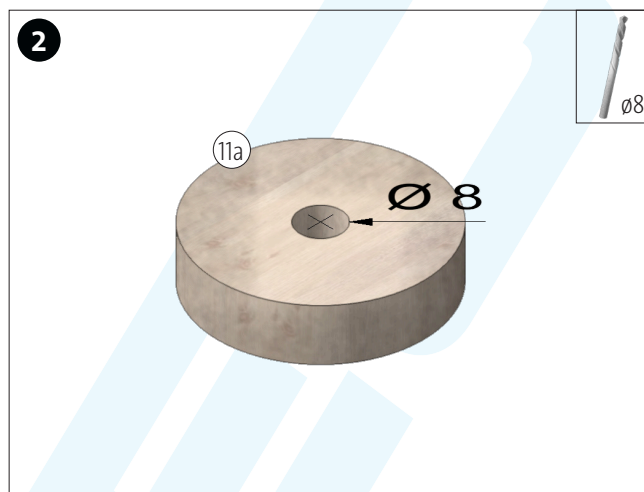

Drill out the hole with $\varnothing 8$ mm.

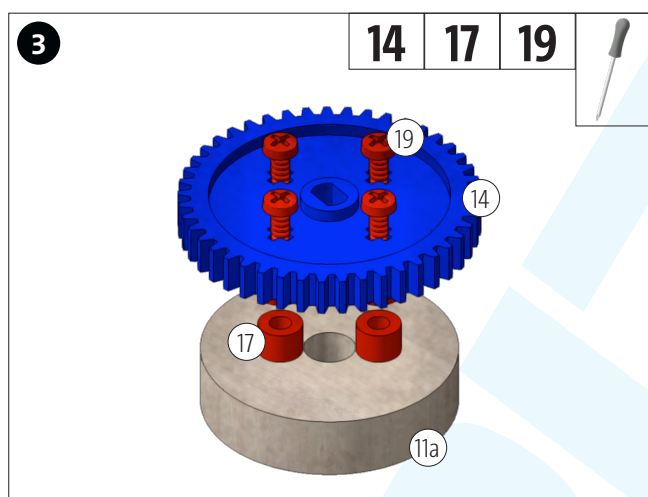

Screw the gear wheel (14) centered on the wooden wheel (11a).

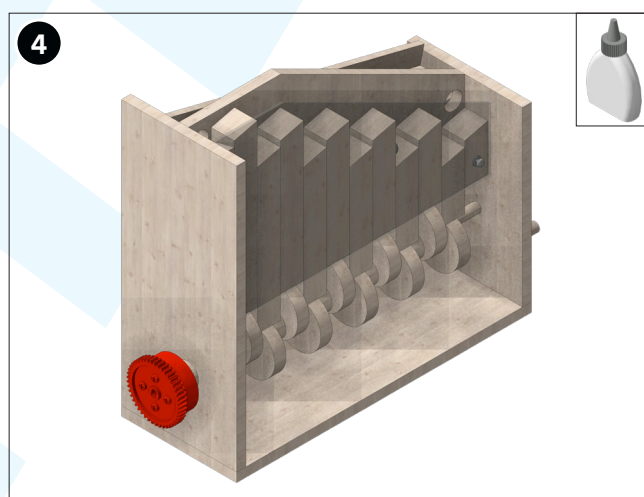

Glue the wooden wheel onto the shaft.

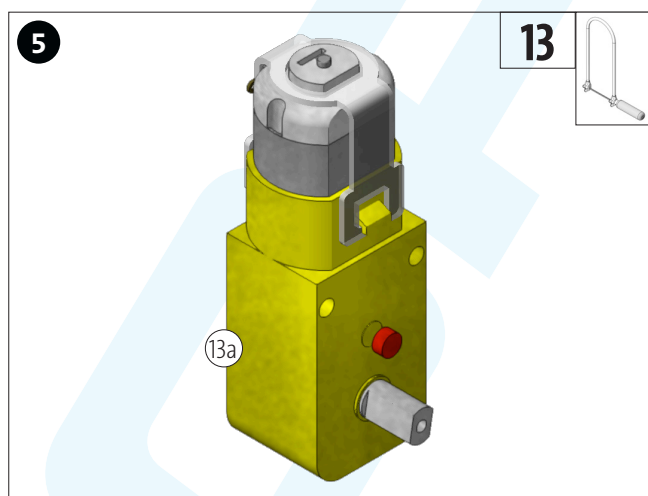

Saw off the protruding pin on the geared motor (13) as shown.

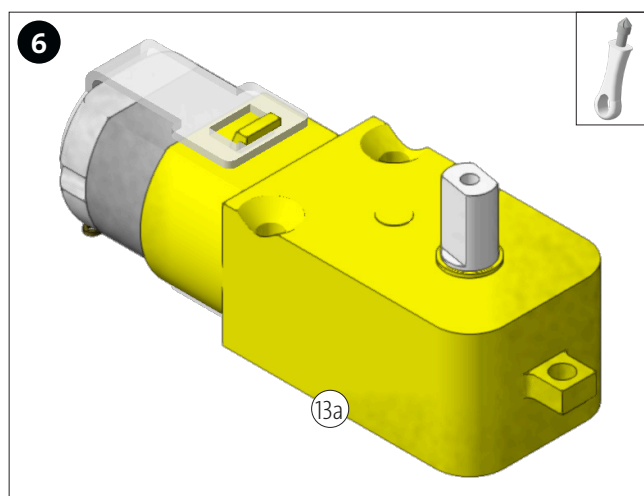

Countersink the holes as shown.

Instructions 124.362
Step ball track drive set

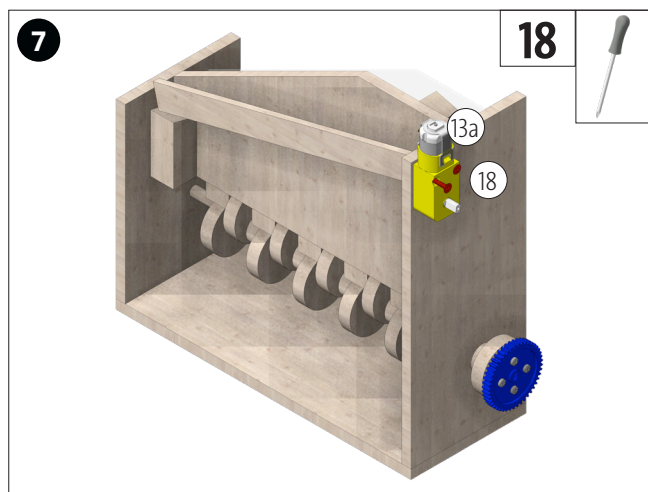

Screw the gear motor (13a) in the top left corner as shown.

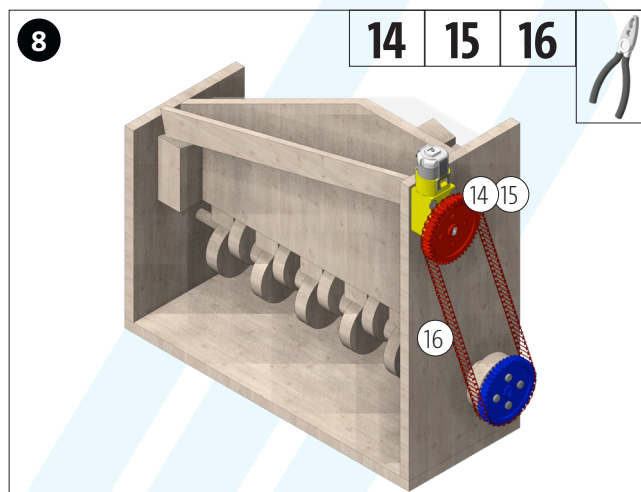

Push the gear wheel (14 or 15) onto the shaft. Shorten the metal chain (16), bend open the chain links, remove and then bend them together again. Then pull up the metal chain.

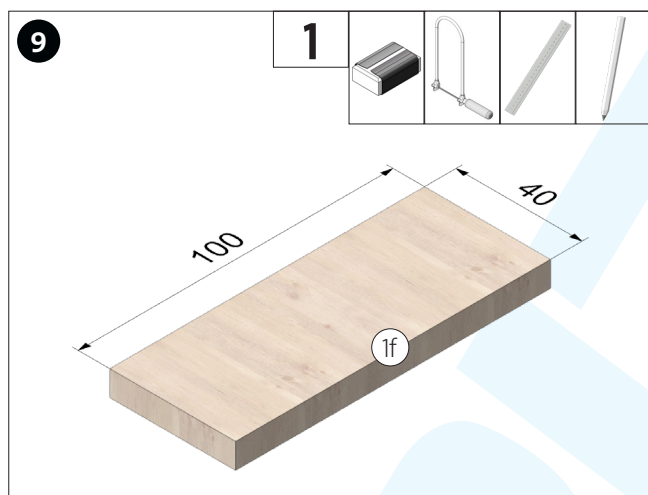

Transfer the dimensions for Teol (1f) to the remaining plywood panel (1) according to the cutting plan (G) and saw out. Clean saw cuts.

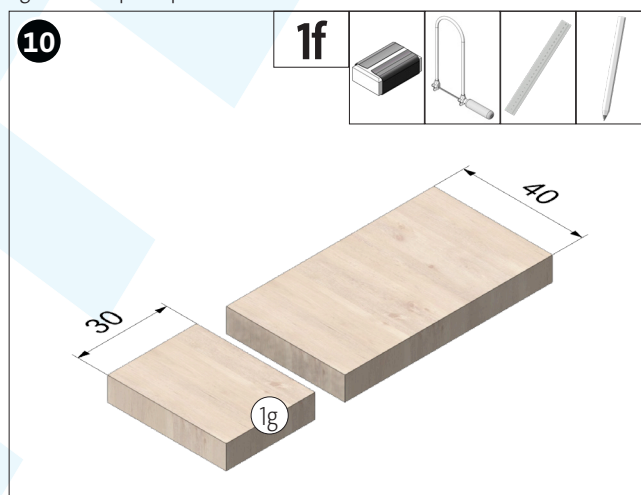

Transfer part (1g) as shown and cut to length. Clean saw cuts.

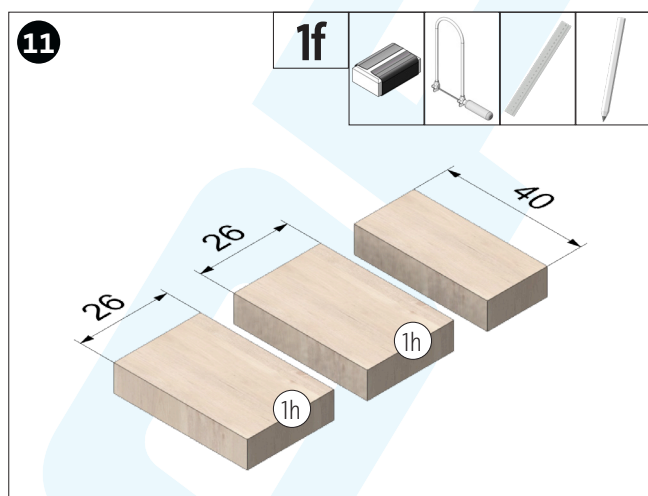

Transfer the dimensions and cut the two parts (1h) to length. Clean saw cuts.

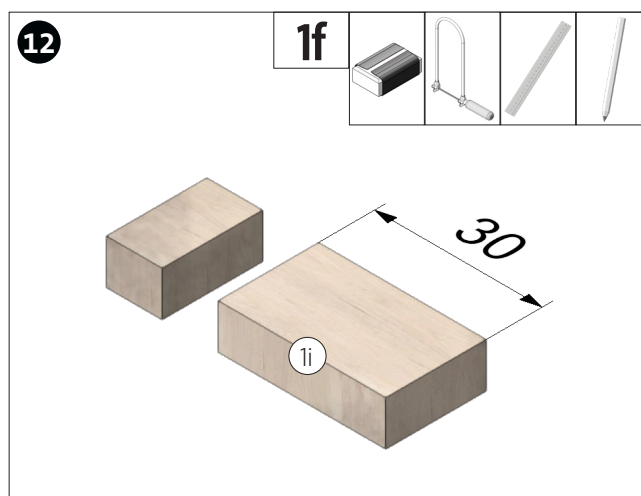

Transfer the dimensions to the leftover piece (1f) as shown and cut to length. Clean saw cuts.

Instructions 124.362
Step ball track drive set

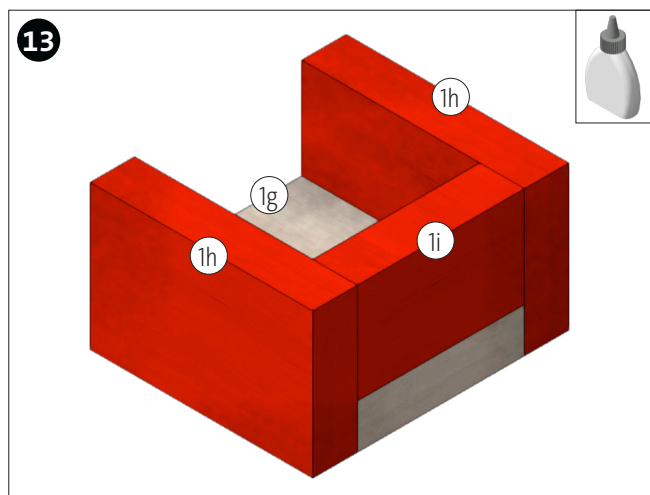

Glue the housing as shown. Let the wood glue dry well.

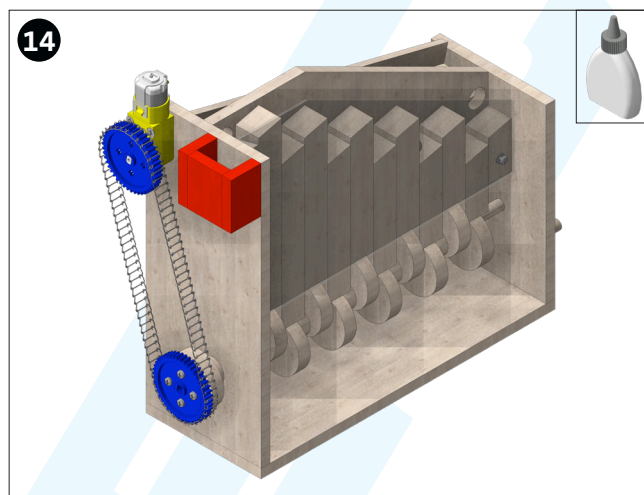

Glue the mount for the battery holder to the top right corner of the case.

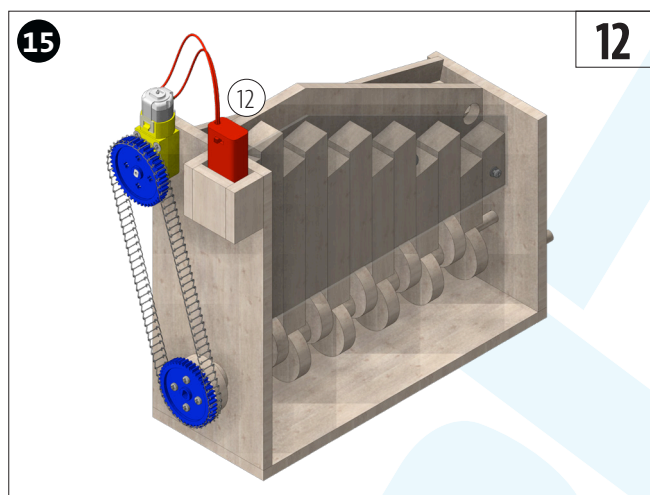

Insert the battery holder (12) into the holder.

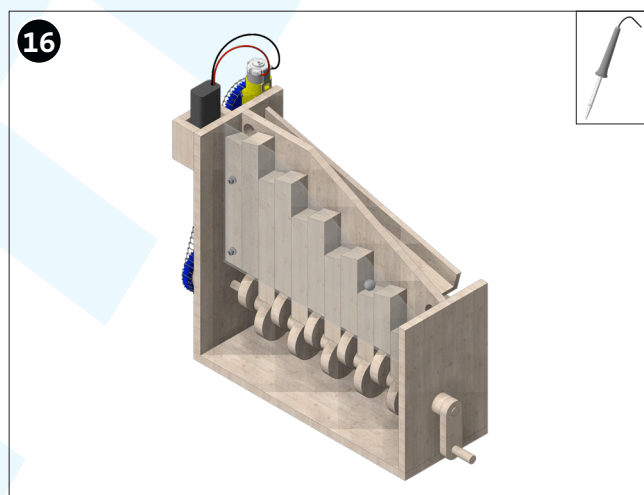

Solder the connecting cables to the geared motor as shown.

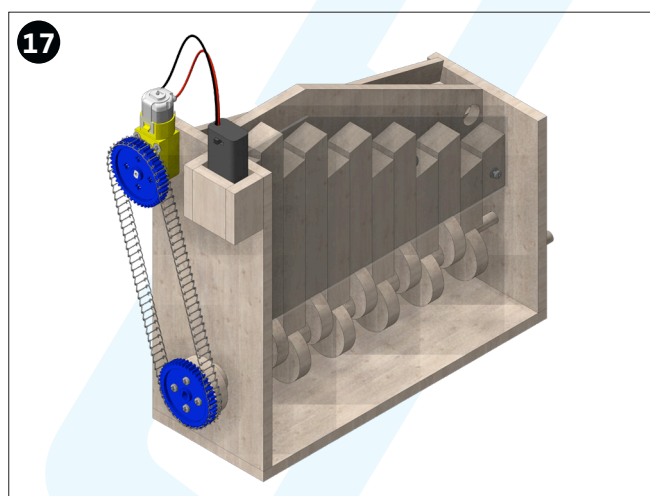

DONE!