

125.494 Swing flyer

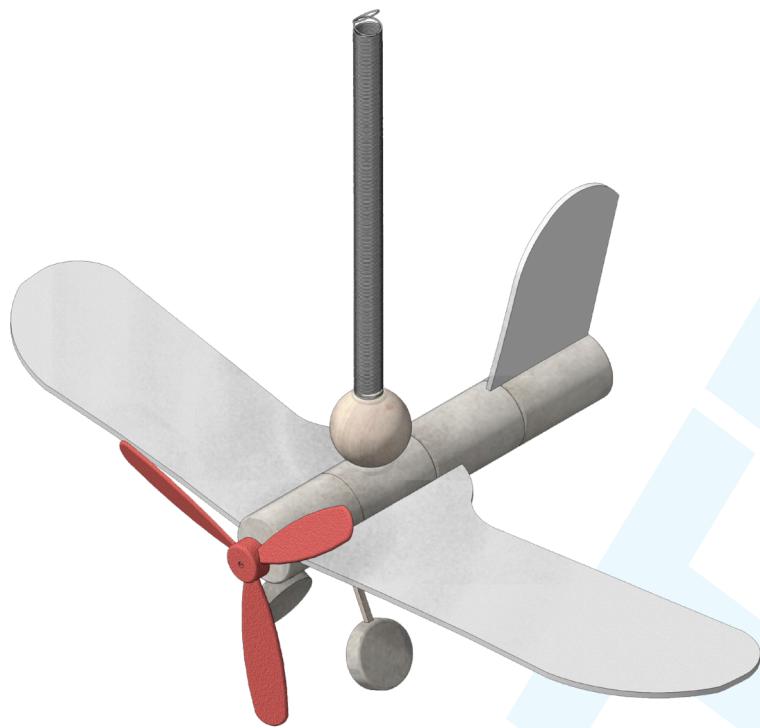

Required tools:

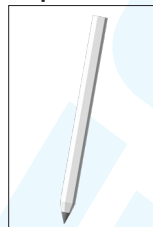

Pencil

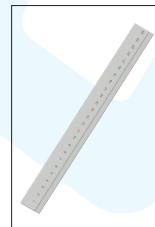

Ruler

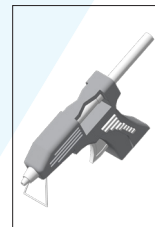

Hot glue

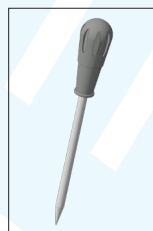

Piercer

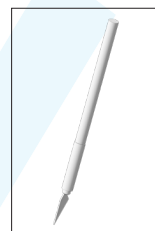

Craft knife



Scissors

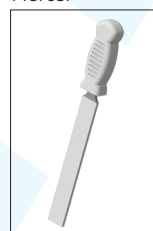

Brush and colour

NOTE:

After completion, the OPITEC work kits are not articles with toy character of a generally commercial kind, but teaching and learning aids to support educational work. This kit may only be built and operated by children and young people under the guidance and supervision of competent adults. Not suitable for children under 36 months. Danger of suffocation!

Parts list	Quantity	Dimensions (mm)	Description	Part no.
Craft corks	4	ø23x38	Body	1
Craft wood	10	2x2x42	Wheel/propeller axle/wing reinforcement	2
Wooden ball without hole	1	ø25	Pilot head	3
Propeller	1	ø115	Propeller	4
Foam rubber	1	290x200x2	Wing/tail rudder	5
Swing spring with eyelet	1	133x9x0,5	Suspension	6

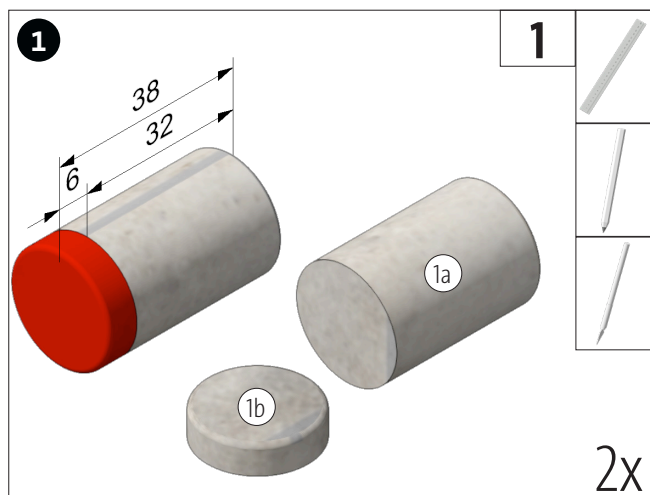

To make the wheels, cut a slice (6 mm) off each of two corks (1) using a craft knife.

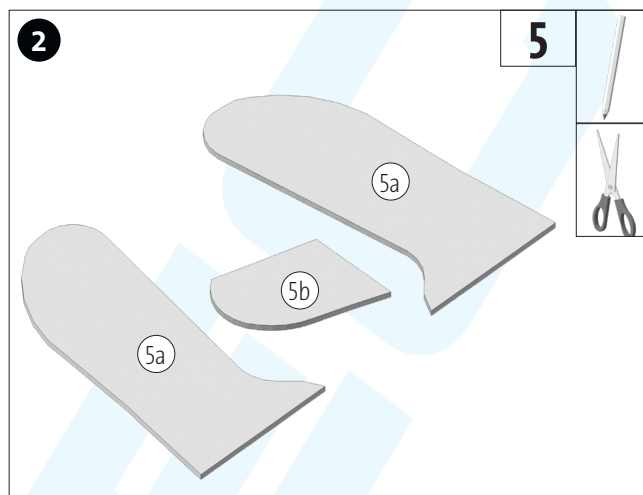

Transfer the template for the wings (ailerons) and the rudder (A) to the foam rubber (5). Then cut out carefully with scissors.

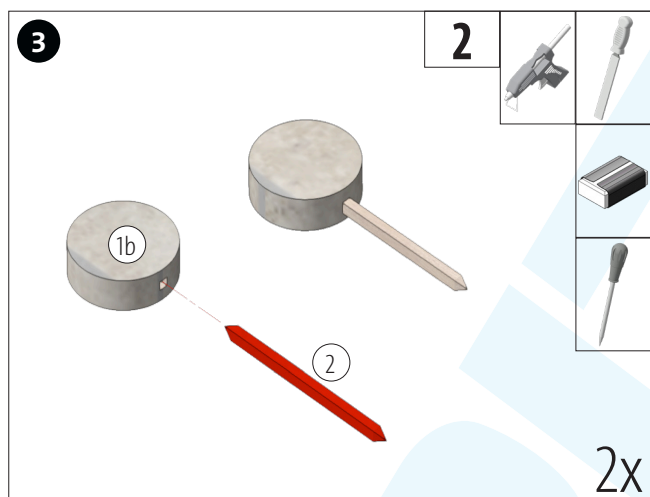

Sharpen a piece of craft wood at both ends with sandpaper or a file. Centre a hole in the cork wheel (1b) using the centre punch. Then insert the craft wood into the hole as shown. Glue in if necessary.

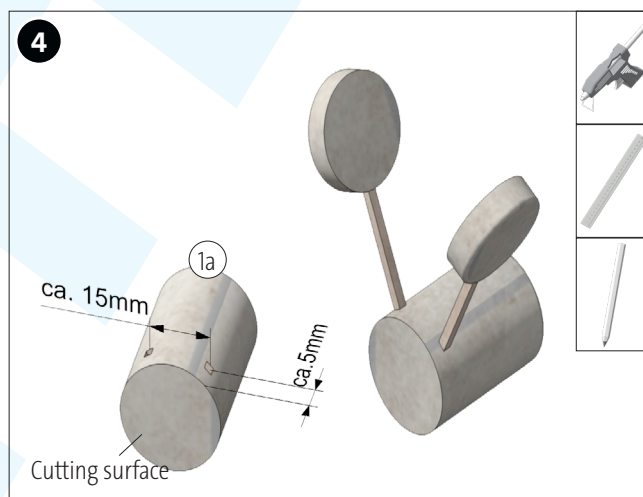

Mark the position for the wheel axles on a cork (1a). Then insert or glue in both wheel axles with wheels.

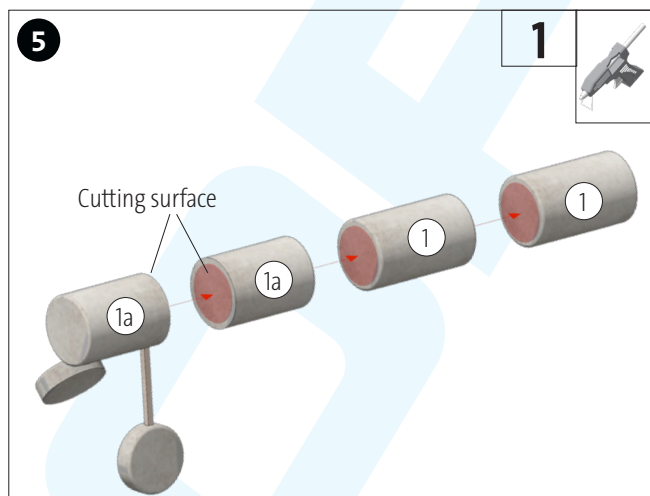

Glue the fuselage together from the four corks as shown. Make sure that the two parts (1a) are glued together at the cut surfaces.

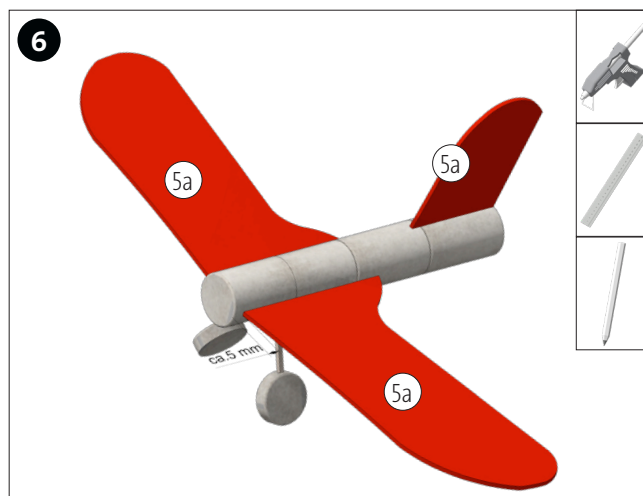

Measure 5 mm from the leading edge of the fuselage and glue on a wing (aileron) (5a) centred on the right and left. Glue on the rudder (5b) centred flush with the trailing edge.

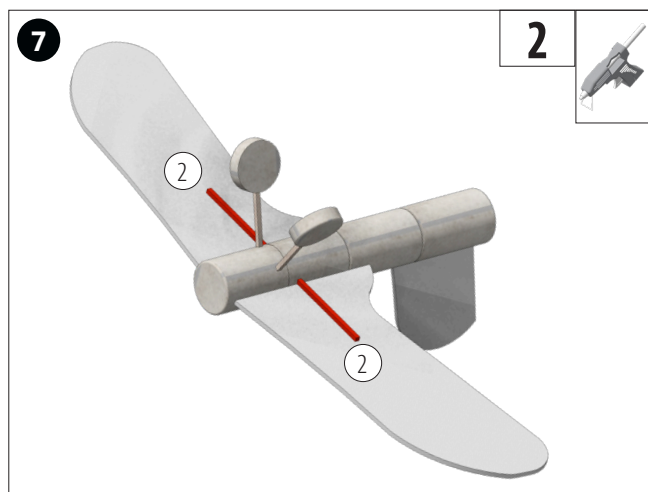

Turn the aeroplane over and glue two pieces of craft wood (2) to the underside to reinforce the wings. See illustration!

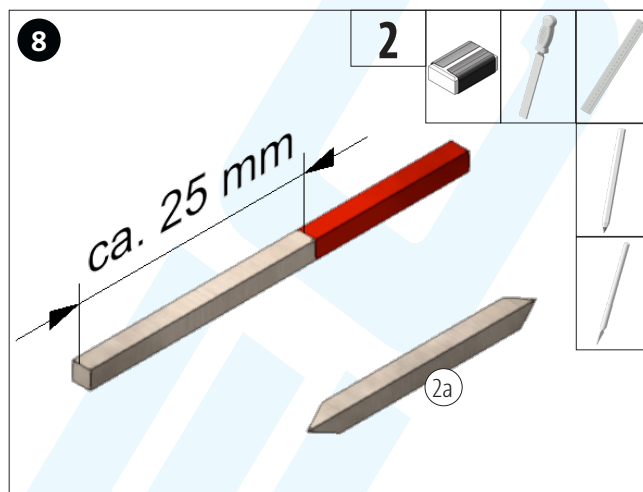

Shorten the remaining craft wood (2) to a length of approx. 25 mm. Sharpen both ends with sandpaper or a file.

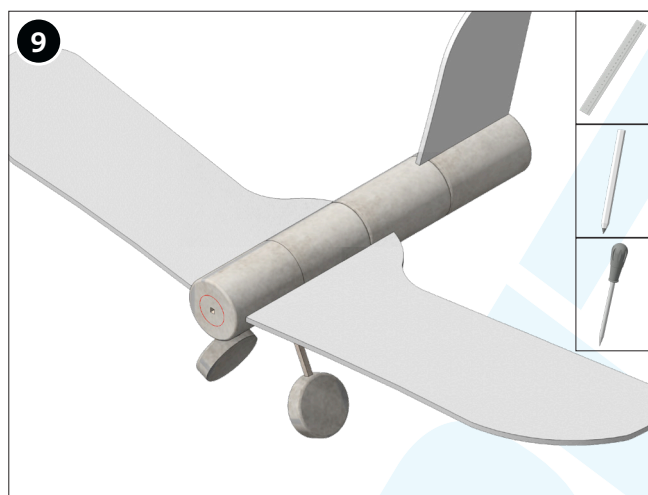

Pierce a hole in the centre of the bow (nose) as shown.

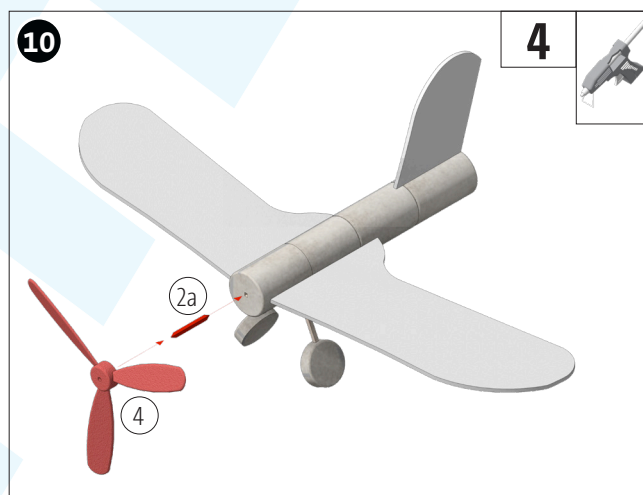

Insert or glue the propeller axle (2a) into the nose hole. Then attach or glue the propeller (4) in place.

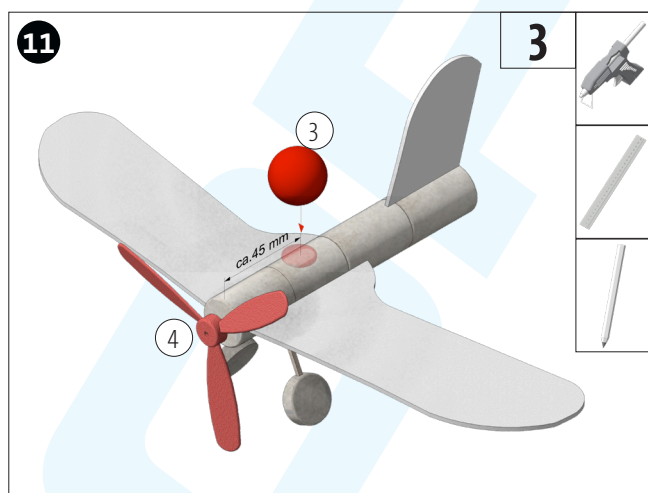

Measure and mark the position for the pilot head (3) and glue it on centred.

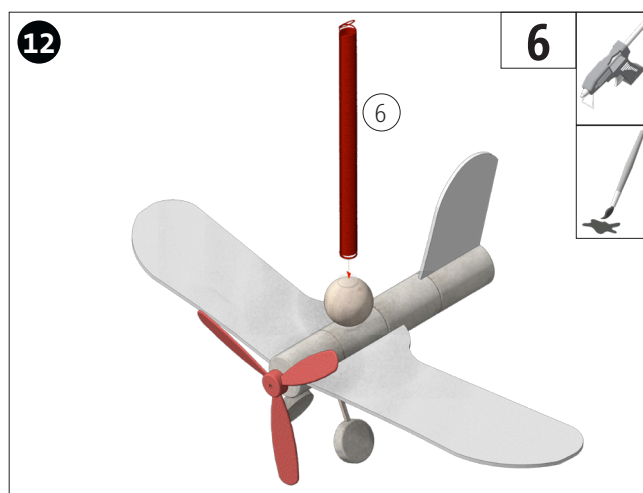

Then glue the oscillating spring (6) centred on the pilot's head. Finally, the pilot can be painted as desired. Finished!



Instructions 125494
Swing flyer

Template (A
)M 1:1

