

103.236

Kitchen Roll Holder

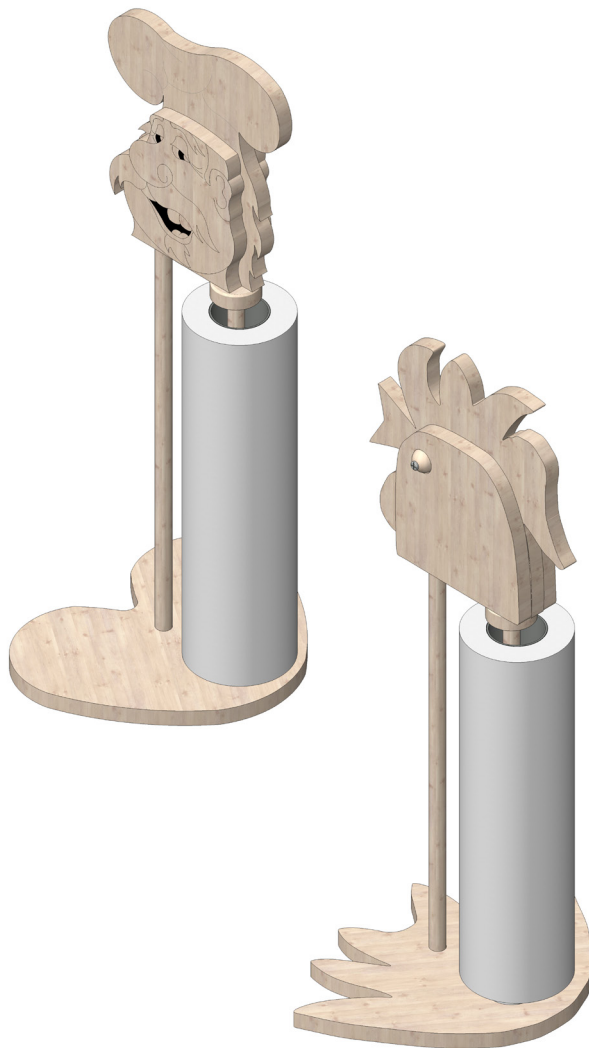

Tools Required:

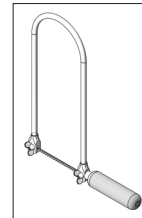

Fretsaw or
Scroll Saw

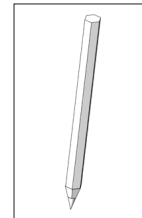

Pencil

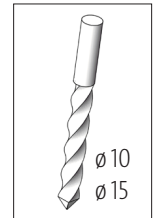

Drill

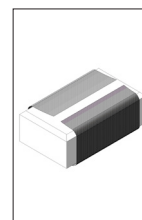

Sandpaper

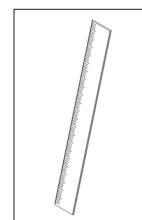

Ruler

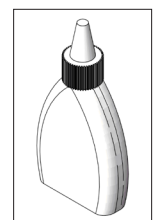

Wood Glue

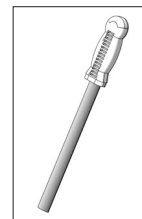

Engineer's File

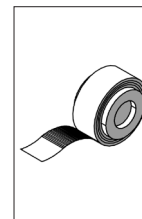

Adhesive Tape

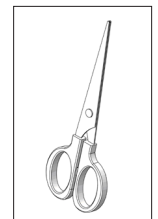

Scissors

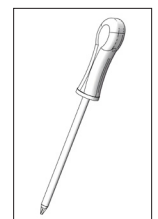

Phillips
Screwdriver

Please Note:

Finished projects of OPITEC handcraft kits are not play toy articles in the same sense as general commercially available ones, but rather are intended as teaching and learning material supporting educational objectives. The content of this construction kit may only be built and used by children and adolescents under the guidance and supervision of qualified adults. Not suitable for children under 36 months. Risk of suffocation!

Material	Quantity	Size (mm)	Designation	Part Number
Plywood	1	400 x 150 x 10	Base Plate Head / Stand	1
Plywood	1	200 x 100 x 10	Base Plate Exterior Parts / Head	2
Round Bar	2	Ø 10 x 300	Roll Holder	3
Wooden Wheel	2	Ø 30	Roll Guide	4
Wooden Ball	2	Ø 15	Eyes Cock	5
Screw	2		Fixing Eyes	6

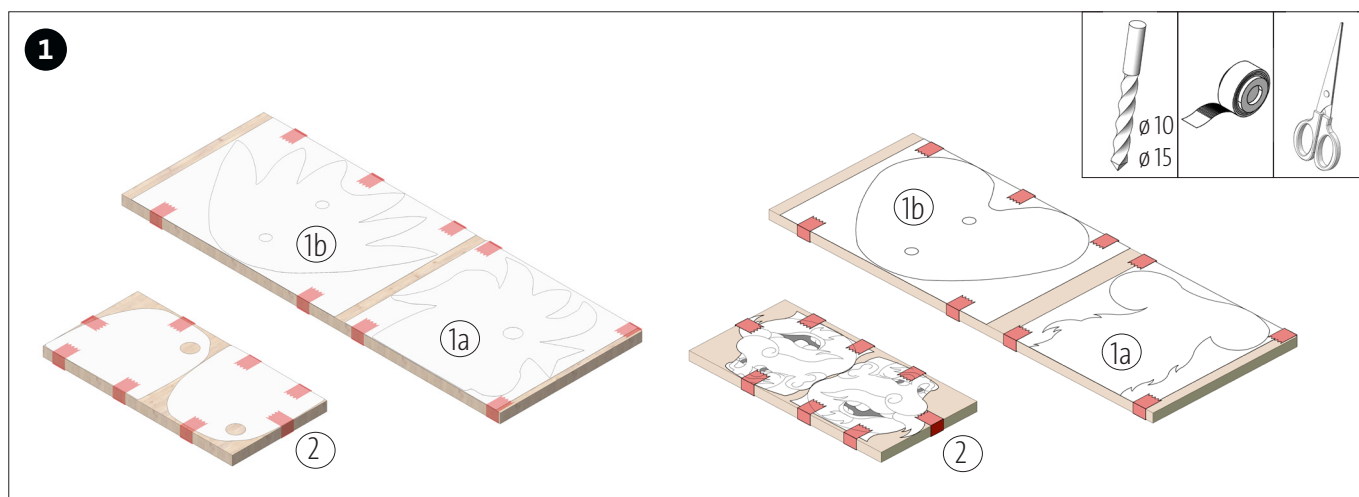

Cut out the templates either for the cook or the cock and attach with adhesive tape on the wooden plates (1+2) as shown in the drawing. Drill all boreholes completely through the board.

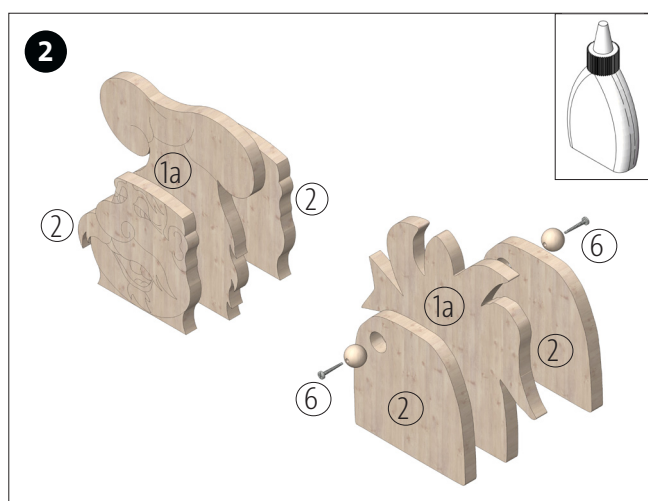

Glue the two exterior head parts (2) to the central head part (1a) on both sides as shown. For the cock insert the wooden balls (5) into the bore holes and fix with the screws (6). Allow completely to dry!

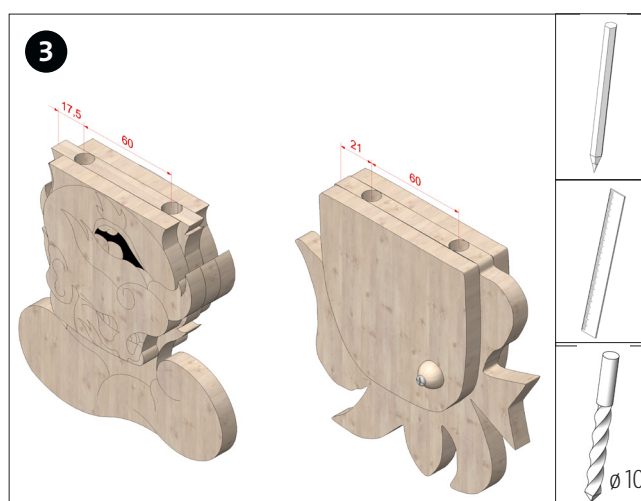

Measure and mark the position for the bore holes to attach the round bars and drill approx. 20 mm deep with a $\varnothing 10$ mm bit.

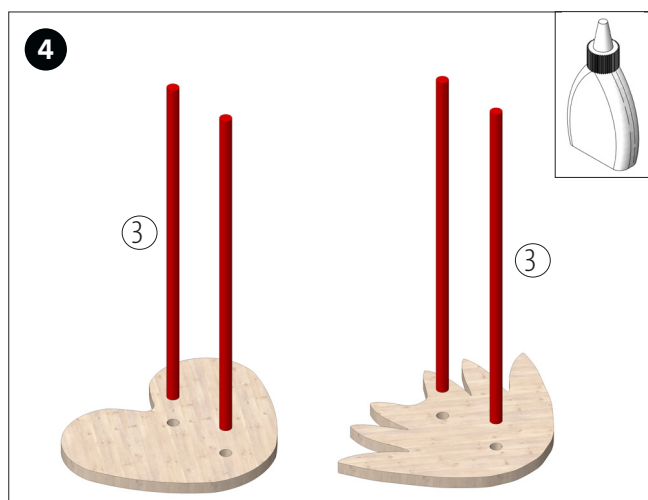

Glue the two round bars (3) into the drilled holes of the stand (1b) as shown.

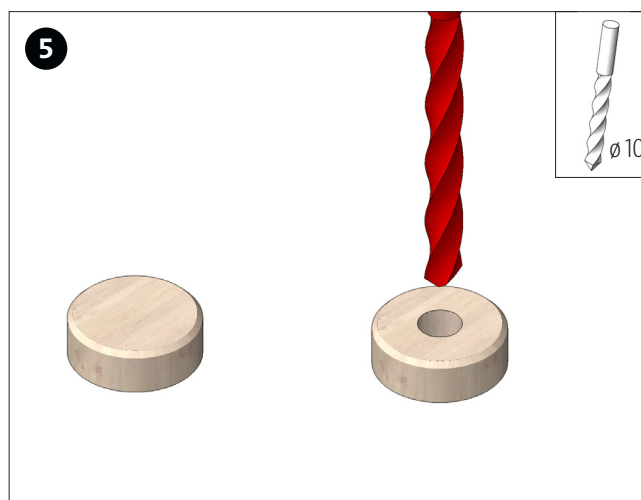

Mark the centre of the two wooden discs (4) and drill a hole of $\varnothing 10$ mm.

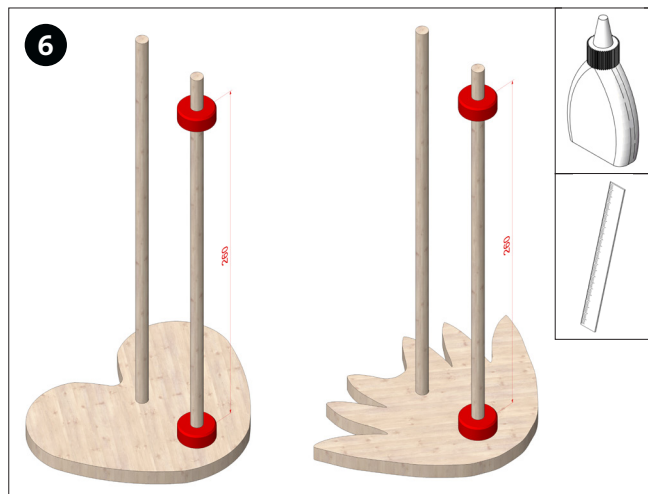

Place one wooden wheel (4) on the posterior round bar (3) and glue to the stand (1b). From the lower wooden wheel (4) measure 260 mm and glue the second wooden wheel (4) to the round bar at this height.



Attach the head to the two round bars as shown in the drawing.
 Done!



Please Note:

For inserting the kitchen roll remove the head and place the kitchen roll onto the round bar. Then put back the head!

