

124.845 Ropitec

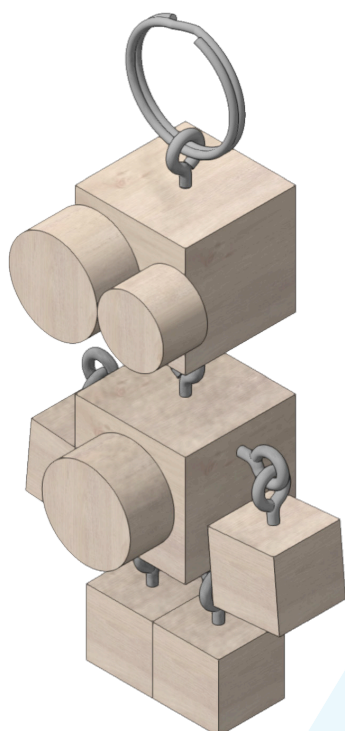

Tools required:

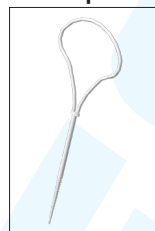

Hand Drill

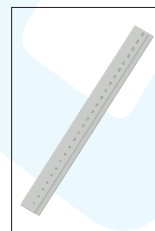

Ruler

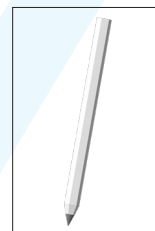

Pencil

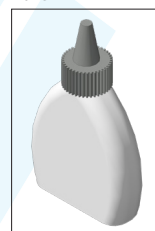

Wood Glue



Combination pliers

NOTE:

After completion, the OPITEC work kits are not articles with toy character of a generally commercial kind, but teaching and learning aids to support educational work. This kit may only be built and operated by children and young people under the guidance and supervision of competent adults. Not suitable for children under 36 months. Danger of suffocation!

Parts list	Quantity	Dimensions (mm)	Designation	Part no.
Wooden dice	4	15x15x15	Arms, Legs	1
Wooden dice	2	25x25x25	body, head	2
Wooden wheel	1	ø15x10	Eye	3
Wooden wheel	2	ø20x10	eye, belly	4
Ring Screw	11		Fastener	5
Key Ring	1	ø 25	Fastener	6

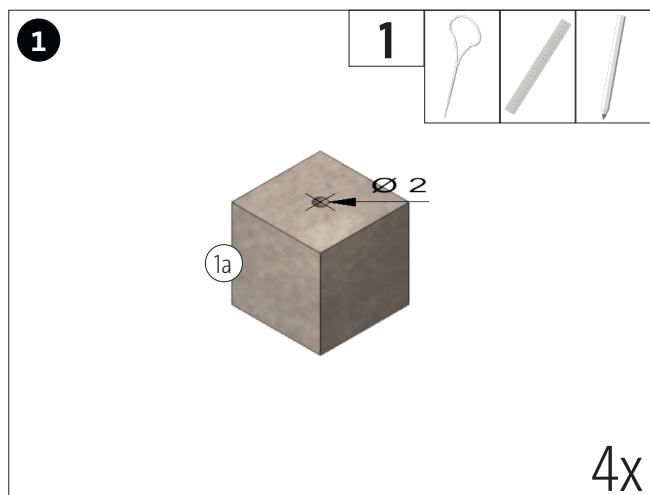

Pre-drill the wooden cube (1), for the arms, with the hand drill.
NOTE: Pre-drill with the grain direction, otherwise the wooden cube will break!

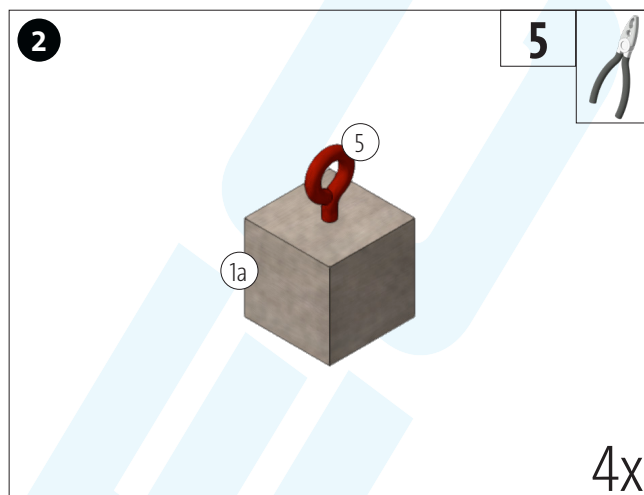

Carefully screw the ring screw (5) into the wooden cube (1a).

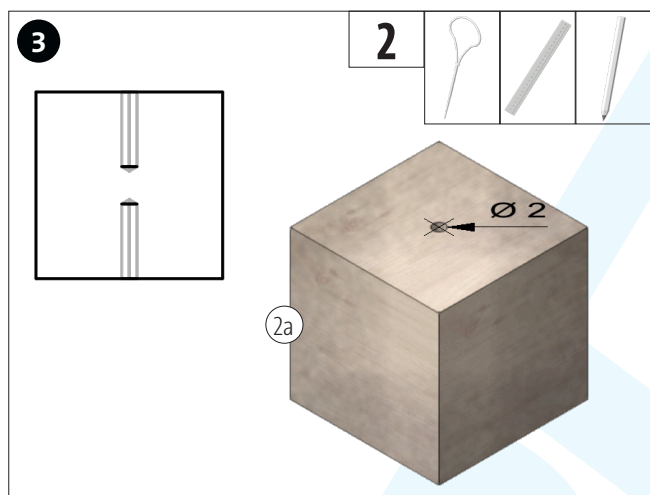

Pre-drill the wooden cube (2), for the head, with the hand drill on the bottom and top side as shown.
NOTE: Pre-drill with the grain direction, otherwise the wooden cube will break!

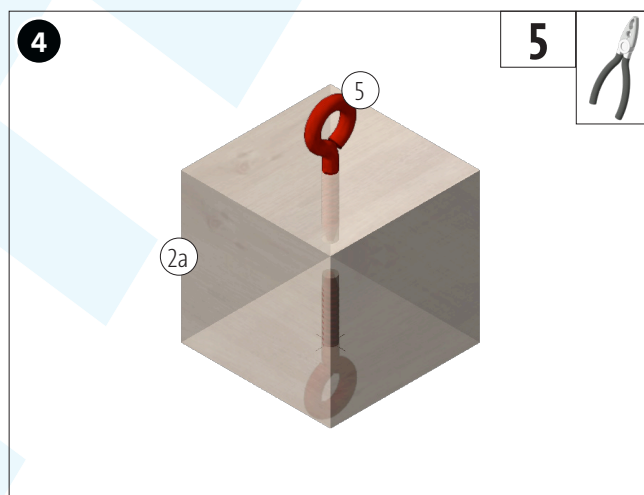

Carefully screw the eyebolts (5) into the wooden cube (2a).

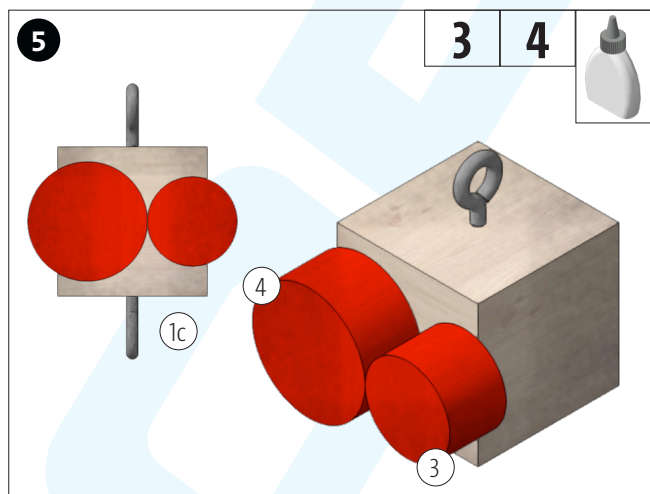

Glue on the wooden wheels (3 and 4) as shown.

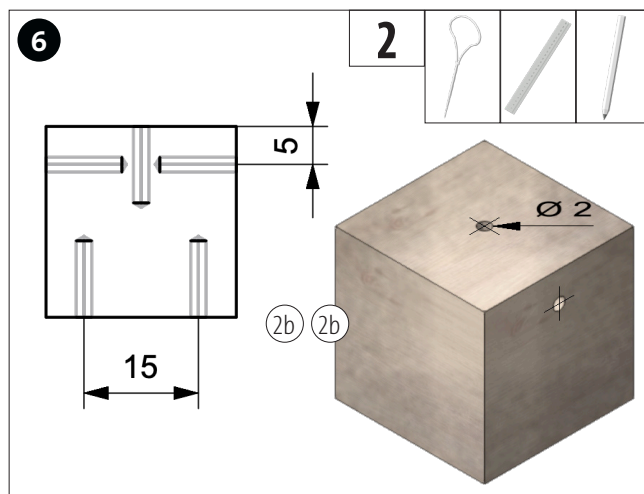

Pre-drill the wooden cube (2) for the body with the hand drill as shown.
NOTE: Pre-drill with the grain direction, otherwise the wooden cube will break!

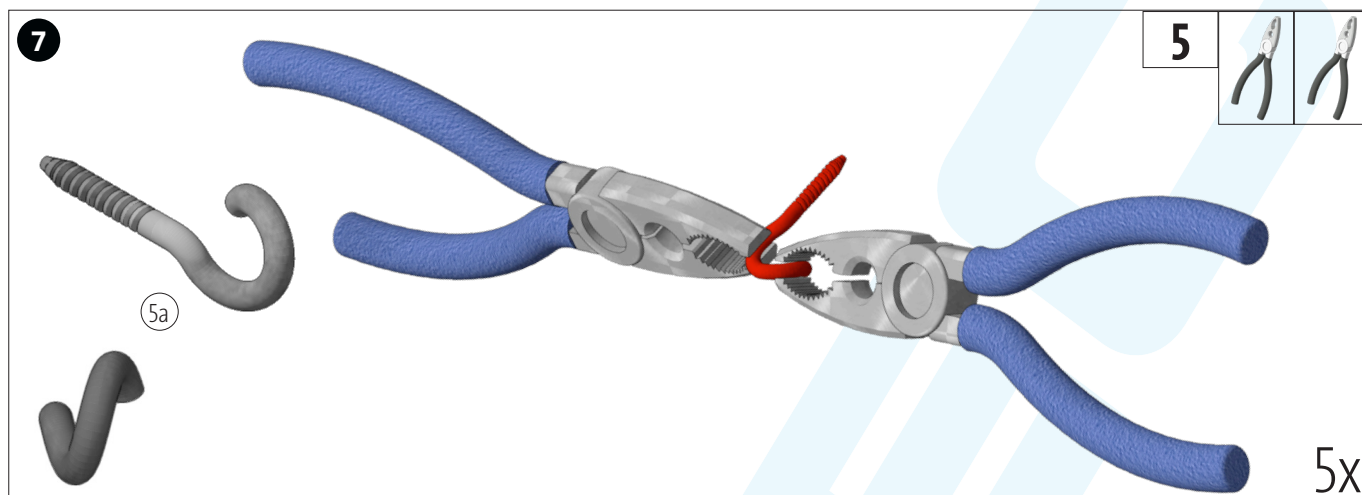

Bend the eyebolt (5) backwards.

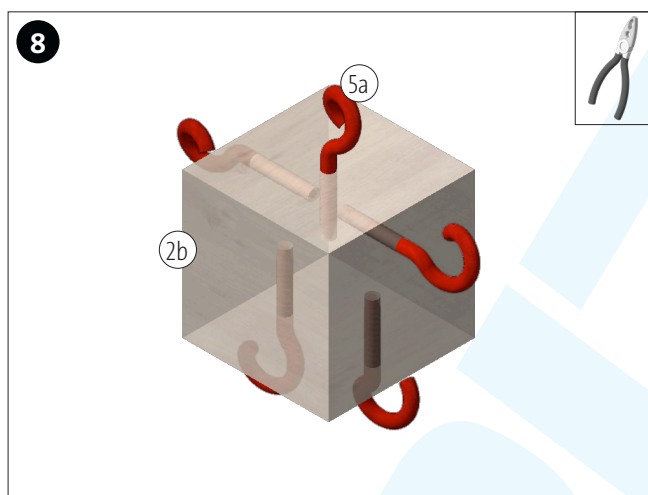

Screw the bent eyebolts (5a) into the wooden cube (2b).

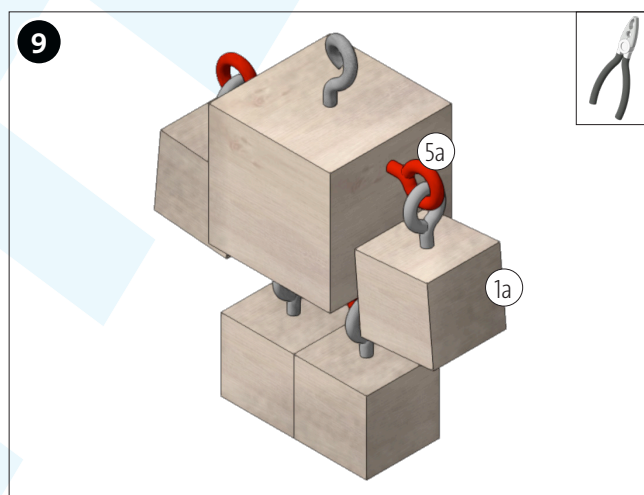

Hang the wooden cubes (1a) in the bent-up ring bolts (5a) and then bend the ring bolts.

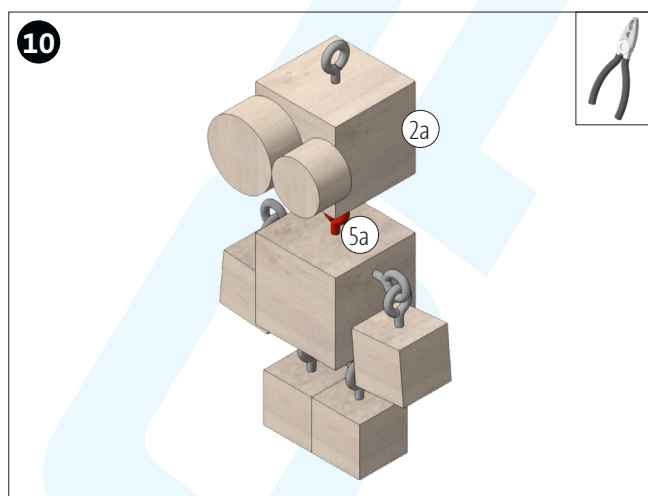

Hang the wooden cube (2a) in the bent ring bolt (5a) and then bend the ring bolt.

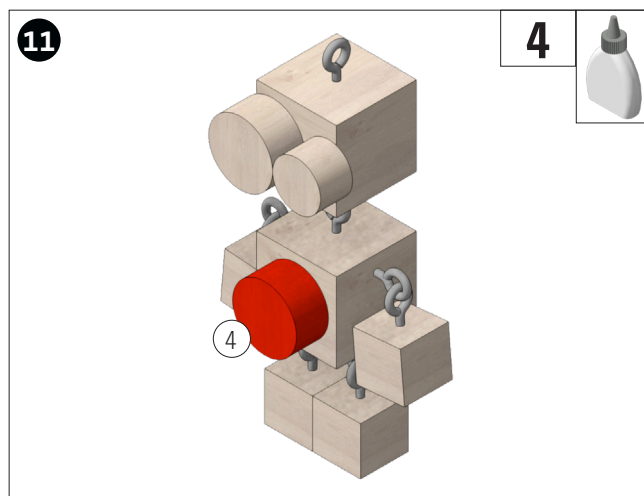

Glue the wooden wheel (4) in the center as shown.

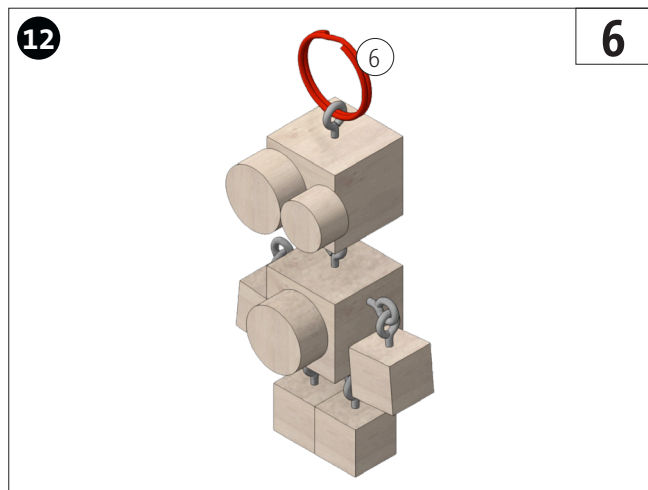

Screw in the key ring (6).
FINISHED!

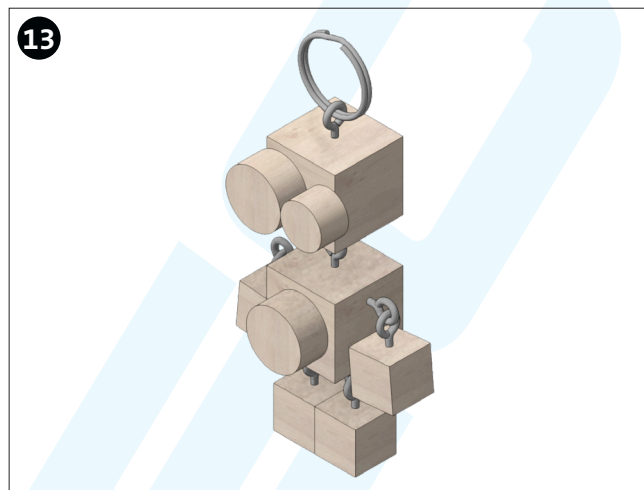

DONE!