

123.034

Guitar "Smartrock"

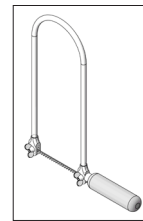

Tools required:



Fretsaw

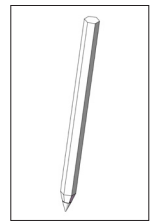

Pencil

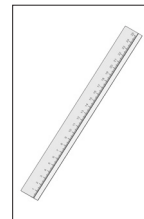

Ruler

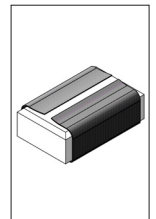

Triangle Ruler

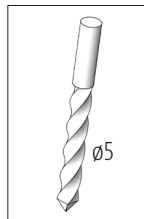

Drill bit



Adhesive Tape

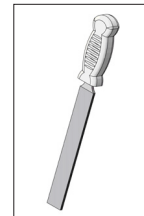

Wood rasp

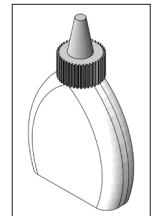

Wood glue

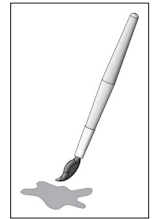

Brush and paint

Please Note

After completion, the OPITEC work kits are not articles with toy character of a generally commercial kind, but teaching and learning aids to support educational work. This kit may only be built and operated by children and young people under the guidance and supervision of competent adults. Not suitable for children under 36 months. Danger of suffocation!

Parts list	Number of	Dimensions (mm)	Description	Part no.
Plywood	1	400x300x8	body/guitar head	1
Wooden strip	2	250x15x15	Guitar neck	2

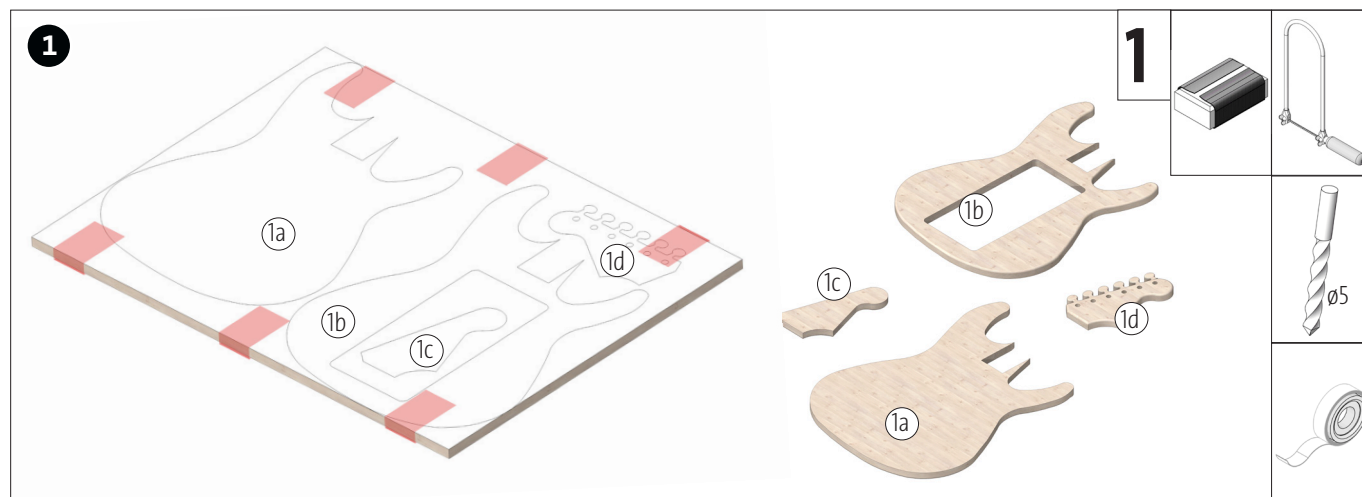

The guitar can be made in three different variants. Rock (1), Classic (2) and Hard Rock (3). Choose the template with the desired body shape (page 5-19), glue it together and fix it on the plywood base plate (1). Drill and saw out all individual parts. Clean saw cuts. **Note:** The holes in the head (variant 1+2) are not absolutely necessary and can be left out as you wish!

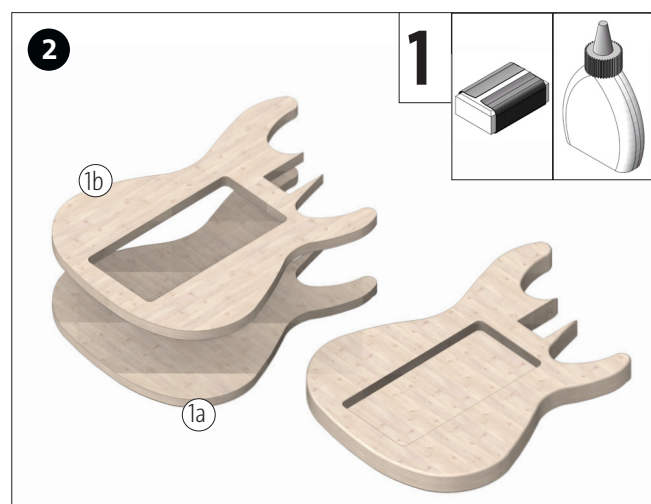

Glue body part (1a) to part (1b). Allow the glue to dry thoroughly and then sand clean.

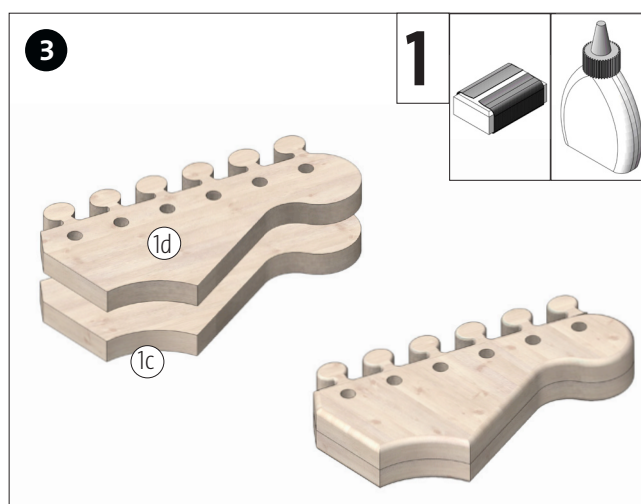

Glue the head part (1d) flush to the part (1c). After the glue has dried, sand clean.

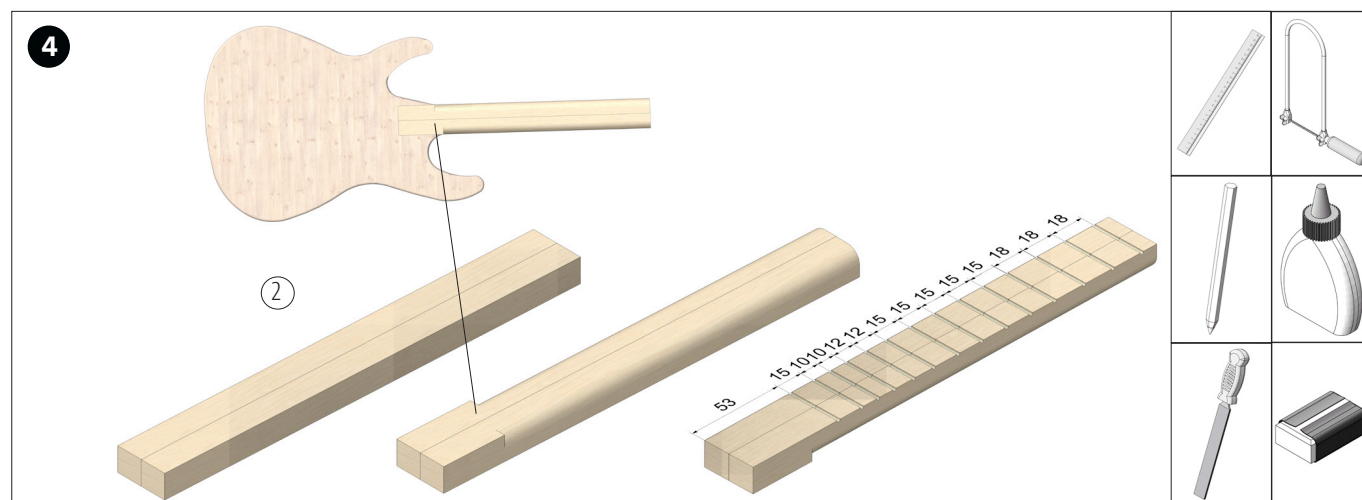

Glue the two wooden strips (2) together. Then insert into the head and mark the area where the neck is to be glued into the body. Then take it out again, round off with a wooden rasp and leave out the marked area. Draw the frets of the guitar according to the dimensions and saw them in with a precision saw. Then clean the neck with sandpaper.

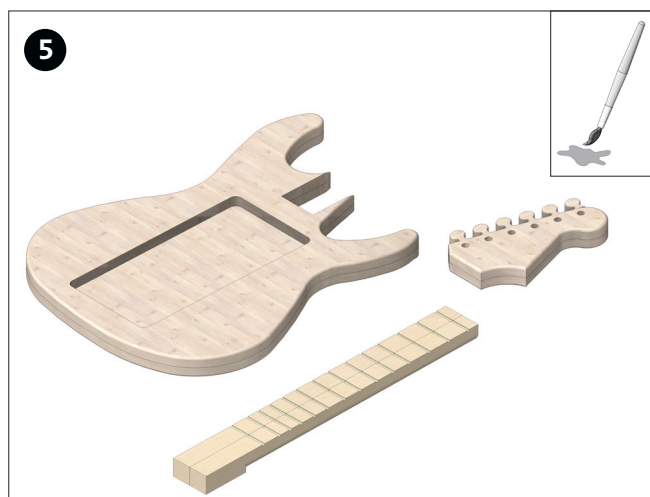

The colored design should be done before gluing. We recommend acrylic paint or acrylic varnish for this. Make sure that the intended adhesive surfaces are not coated.

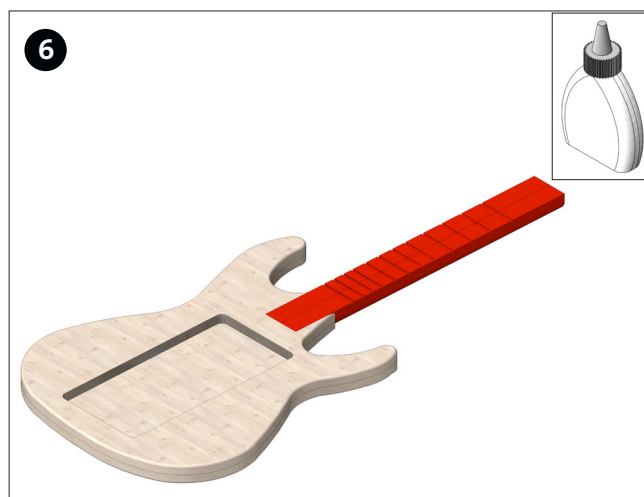

Glue the neck into the body as shown.

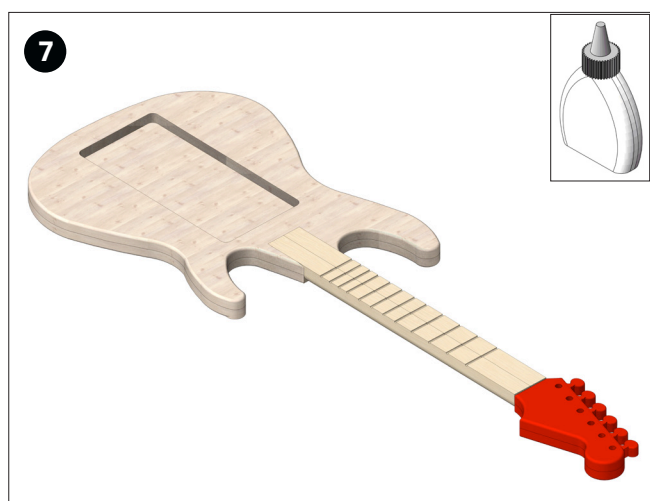

Glue on the top part as shown.



To play, all you have to do is load one of the many guitar simulator apps (e.g. Real Guitar) onto your smartphone. Insert your mobile phone, start the simulator and start playing!

