

# 329.555 Pricker

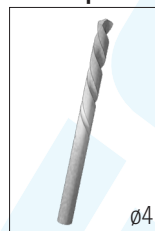

## Tools required:



Twist drill

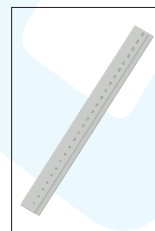

Ruler

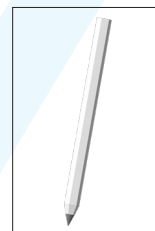

Pencil

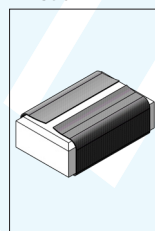

Sand paper

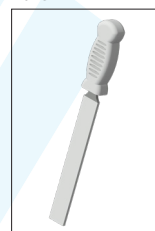

File



Hacksaw

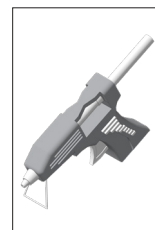

Hot glue

## NOTE:

After completion, the OPITEC work kits are not articles with toy character of a generally commercial kind, but teaching and learning aids to support educational work. This kit may only be built and operated by children and young people under the guidance and supervision of competent adults. Not suitable for children under 36 months. Danger of suffocation!

Parts list	Quantity	Dimensions (mm)	Designation	Part no.
Wooden egg	1	60x40	Handle	1
Welding rod	1	Ø4x200	Tip	2

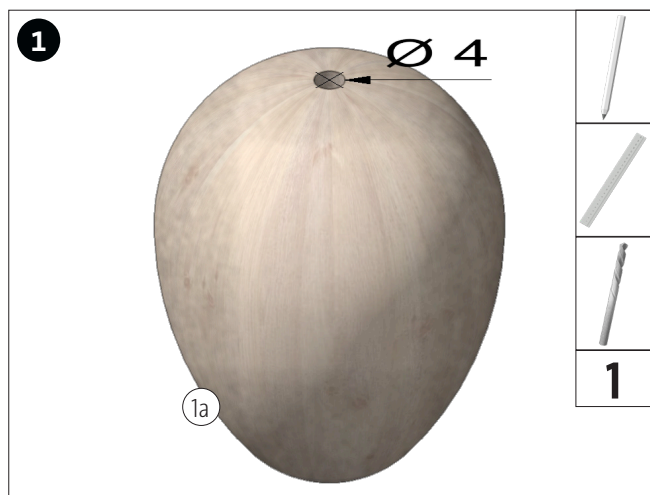

Drill through the wooden egg (1).

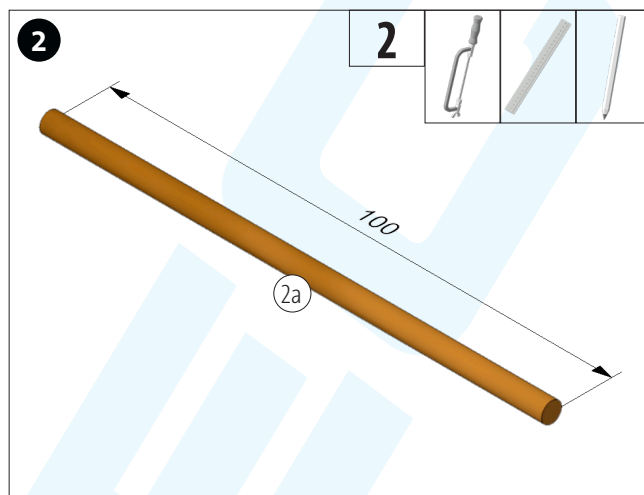

Cut the welding wire (2) to length.

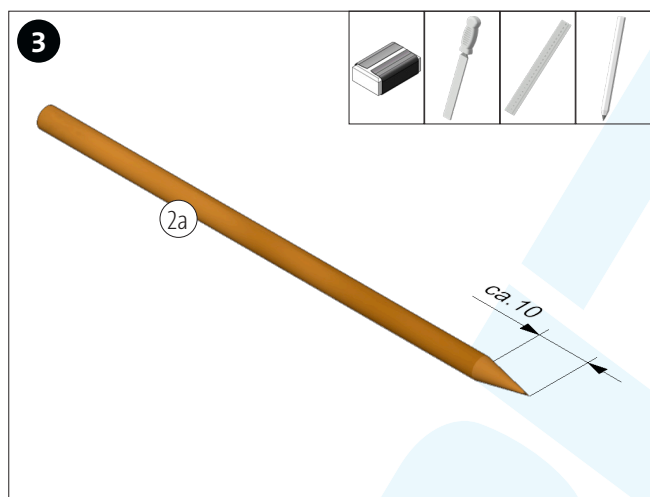

Sharpen the welding wire (2a) as shown.

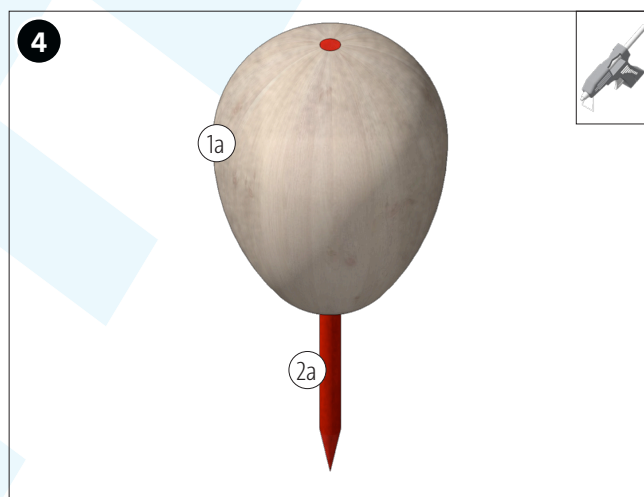

Glue the welding wire (2a) into the wooden egg (1a).



DONE!