

101.821

Barrel trolley

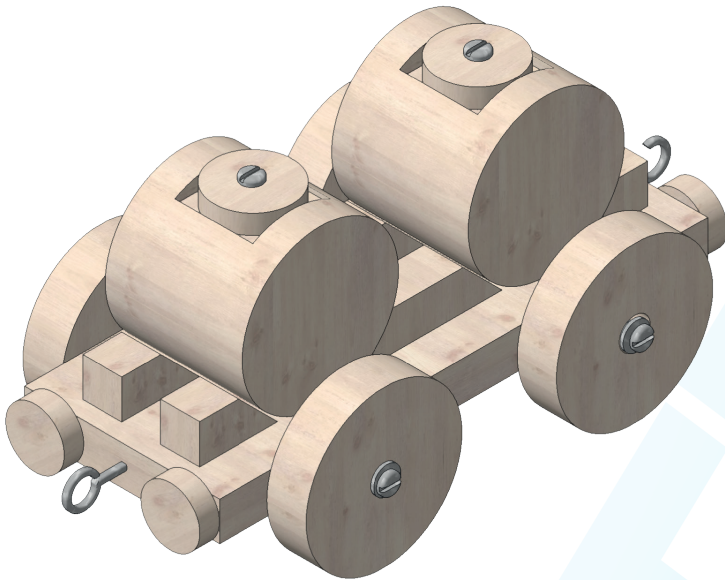

Tools Required:

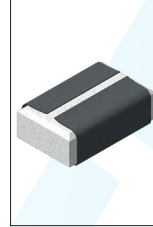

Sandpaper

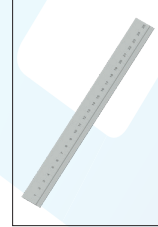

Ruler

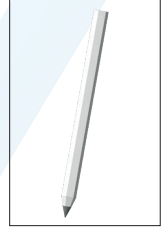

Pencil

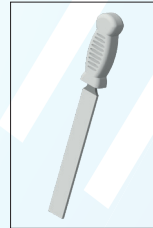

File

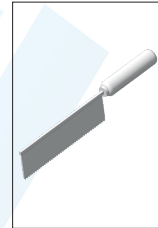

Miter saw



Jig saw

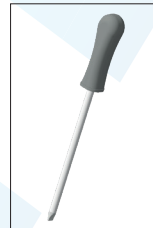

Screwdriver



Drill



Pricker



Pliers



Wood glue

NOTE:

The OPITEC range of projects is not intended as play toys for young children. They are teaching aids for young people learning the skills of Craft, Design and Technology. These projects should only be undertaken and tested with the guidance of a fully qualified adult. The finished projects are not suitable to give to children under 3 years old. Some parts can be swallowed. Danger of suffocation! Not suitable for children under 36 months. Choking hazard!

Part List	Quantity	Dimensions (mm)	Description	Part no.
Wooden strip	1	200x50x10	Base plate + tipper	1
Round rod	1	ø15x100	Buffer	2
Round rod	1	ø40x75	Tanks	3
Wooden strip	2	150x10x10	Wedges	4
Wooden wheel	4	ø40x10	Wooden wheel	5
Wooden wheel	2	ø20x6	Tanks	6
Ring Screw	1	12	Clutch	7
Screw Hooks	1	20	Clutch	8
Washer	20	9/4.3	Washer	9
Screw	6	2,9x25	Mounting wheel	10

Instructions 101.821
Barrel trolley

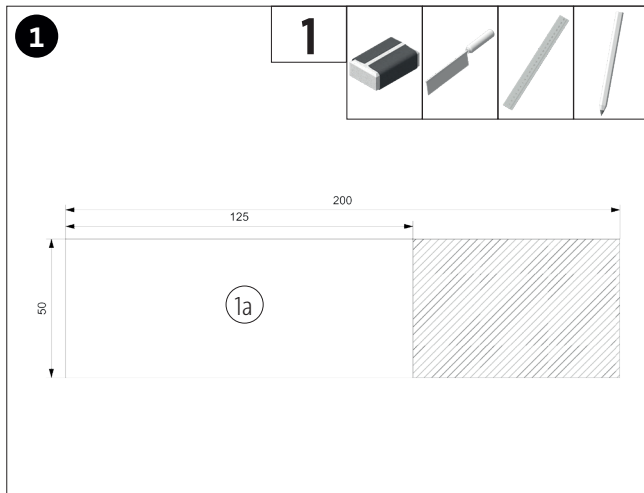

Shorten the wooden moulding (1) to 125 mm as shown and clean the saw cuts.

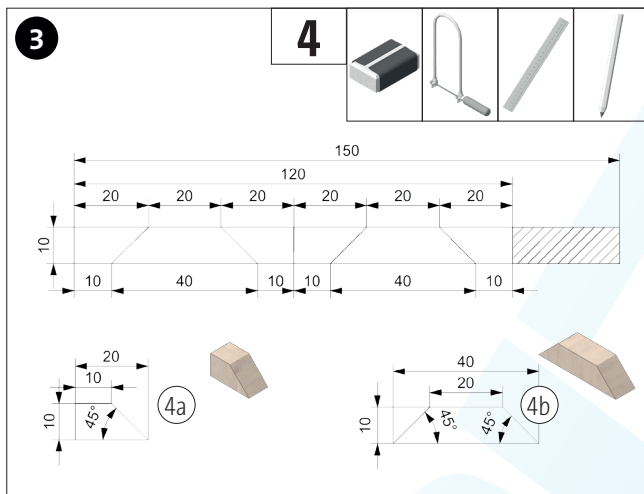

Transfer four wedges (4a) and two wedges (4b) to the pine moulding (4) according to the drawing and saw them out. Clean the saw cuts.

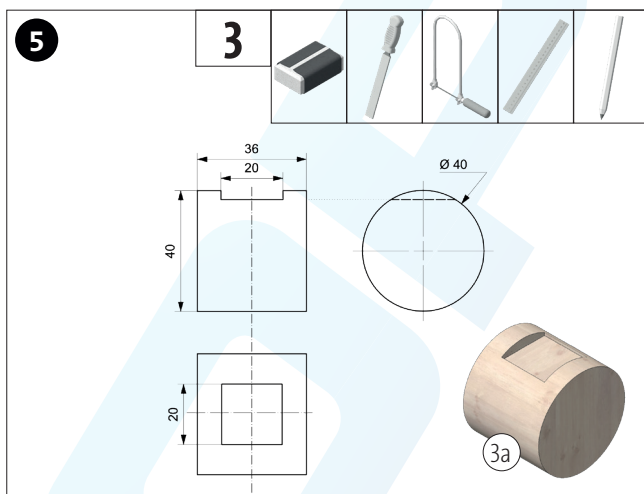

Cut the round pine stick (3) in half and work out and neaten the indentation according to the drawing.
NOTE: The tank can also remain in one piece and be glued lengthways onto the base plate. The wedges (4a) must then be made shorter and the centre wedges (4b) omitted.

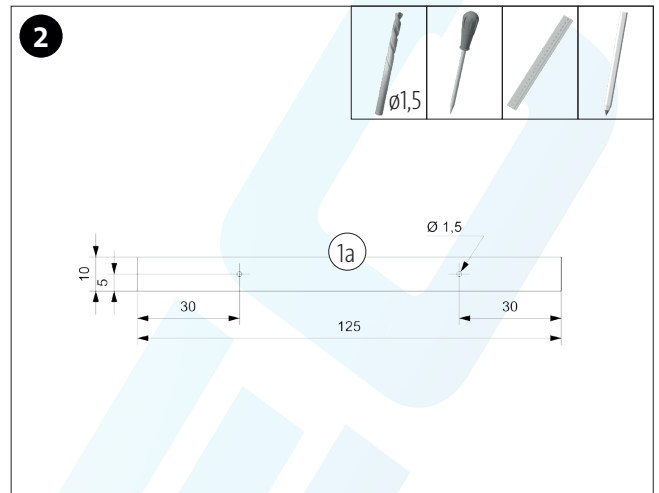

Mark the holes for the wheel bolts on both long sides of the wooden moulding (1a) according to the drawing and pre-drill with a $\varnothing 1.5$ mm drill bit.

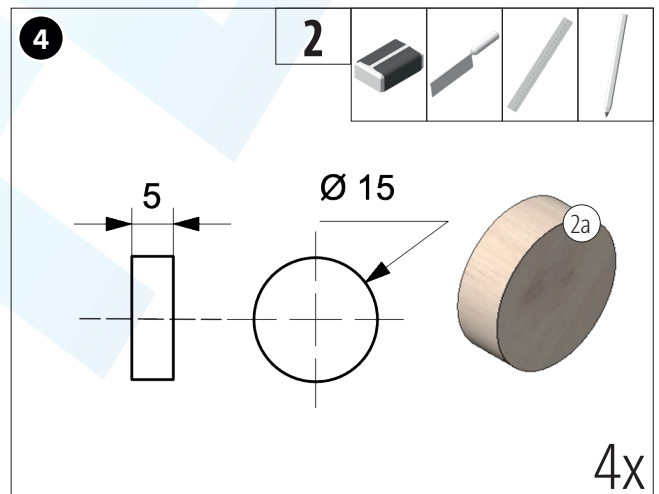

Saw off four 5 mm long buffers from the round bar (2) and neaten them.

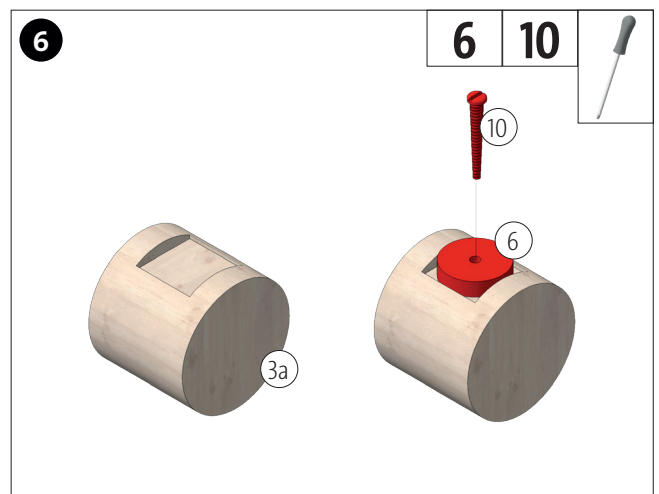

Screw the two wooden wheels (6) into the recess of the tanks (3a) with one screw (10) each as shown.

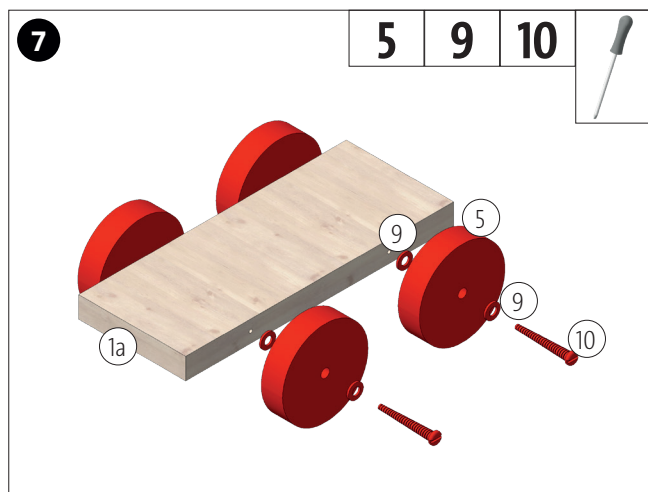

Screw the wheels (5) to the base plate (1a) using the washers (9) and the screws (10).

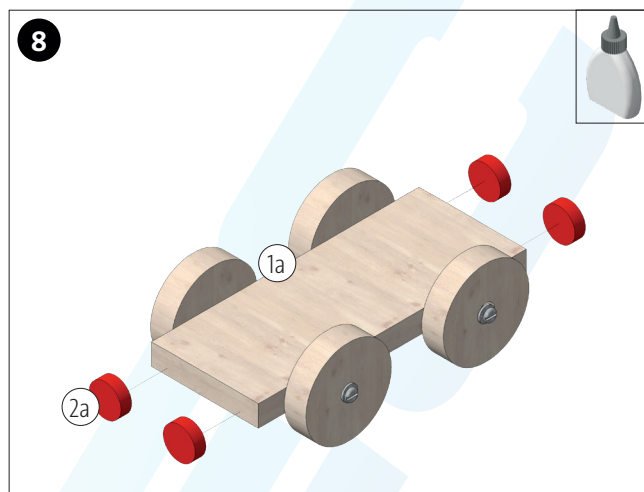

Glue the 4 buffers (2a) to both sides of the base plate (1a) as shown

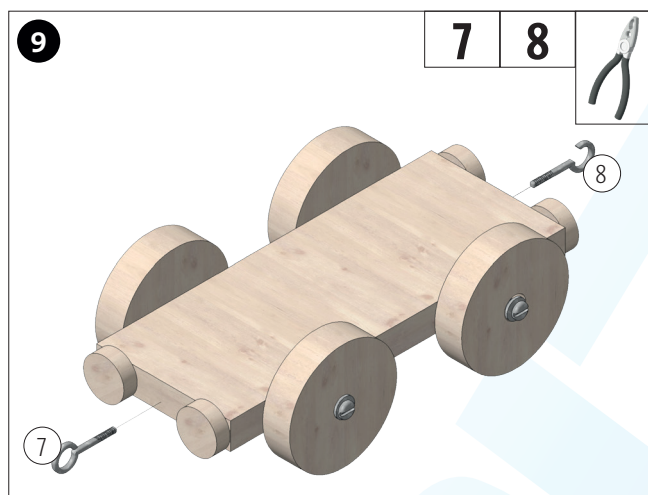

Screw in the eyebolt (7) and the screw hook (8) centred between the buffers.

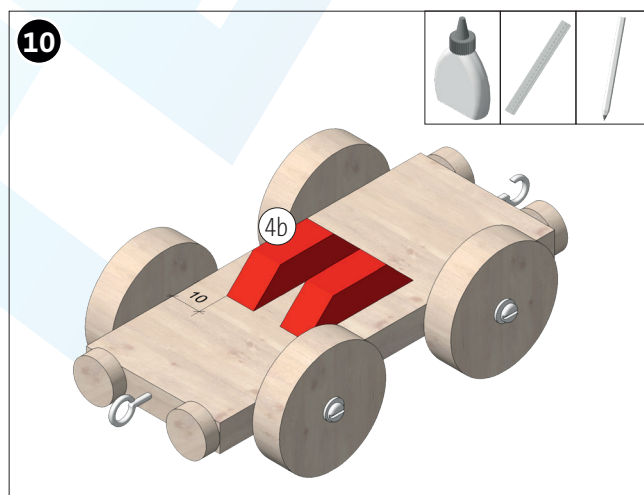

Glue the two wedges (4b) onto the base plate, centred and with a lateral gap (10 mm).

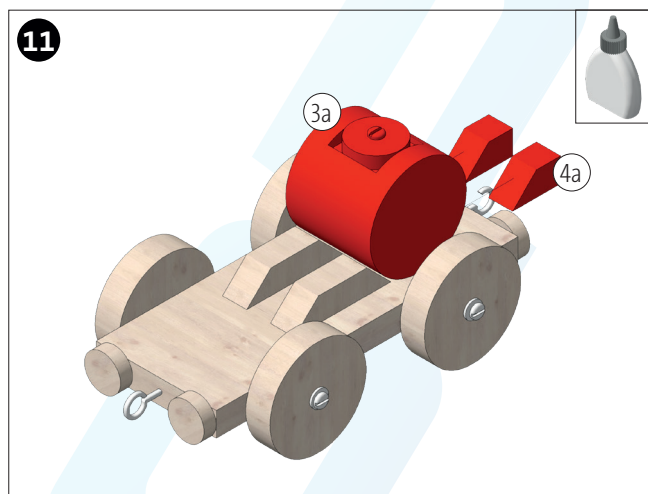

Glue on one of the tanks (3a) and glue on two wedges (4a) with a lateral distance (10 mm).

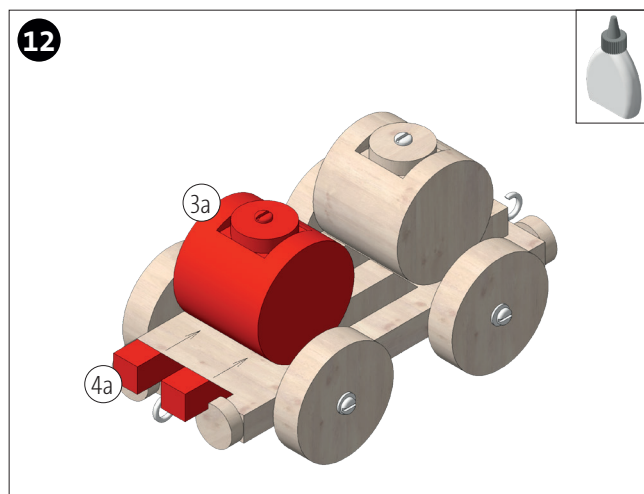

Glue on the second tank (3a) and glue on two wedges (4a) from the front with a lateral gap (10 mm).

13

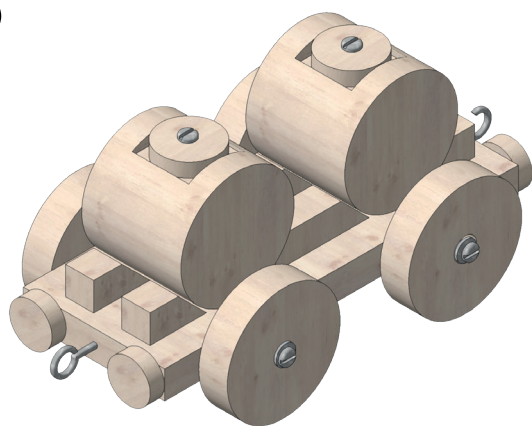

DONE!