

OPITEC

Hobbyfix

110.648

MULTI-STORAGE

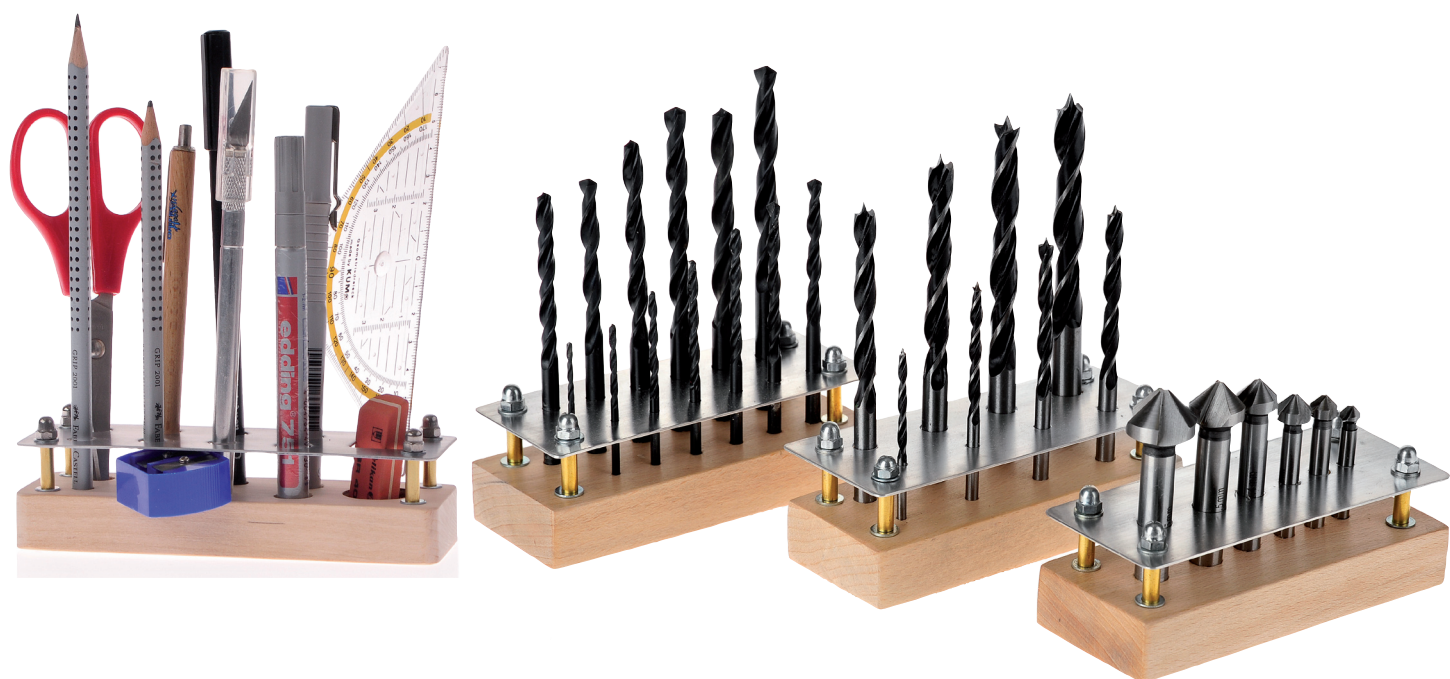

Please Note

The OPITEC range of projects is not intended as play toys for young children. They are teaching aids for young people learning the skills of Craft, Design and Technology. These projects should only be undertaken and tested with the guidance of a fully qualified adult. The finished projects are not suitable to give to children under 3 years old. Some parts can be swallowed. Danger of suffocation!

Necessary tools:

- Files, sandpaper
- Range of drills
- Slotted screwdriver
- Spanner 7mm
- Chisel
- Machine vice
- Hammer + punch
- Hacksaw
- Countersink

PARTS LIST				
			Description	Part-no
Wood strip	1	150x50x20	Base	1
Alu-sheet	1	150x50x1	Covering plate	2
Set screws	4	40x4	Spacer	3
Domed nut	4	M4	Fixing	4
Washer	12	4,3/9	Material protection	5
Brass tube	4	15	Spacer	6

INSTRUCTIONS

General:

The instructions show a drill holder but it can be re-designed for many other purposes.

1. Trace the stencil (see page 5) on the aluminium (2). Centre punch the markings. see diagram

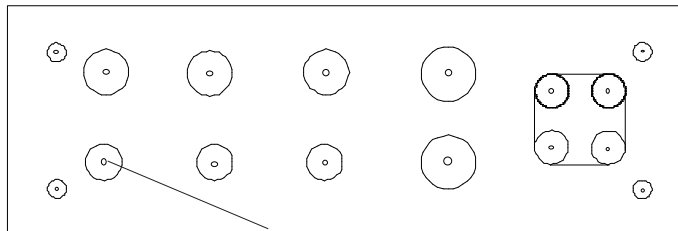

Centre punch

2. Fit the Aluminium strip (2) over the wood block (1) and fix with double sided sellotape.

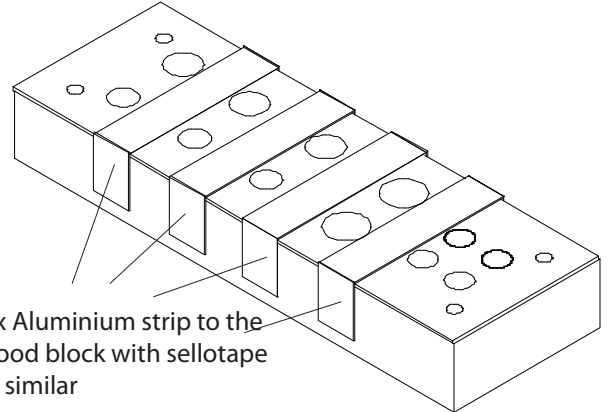

Fix Aluminium strip to the wood block with sellotape or similar

3. Round the corners

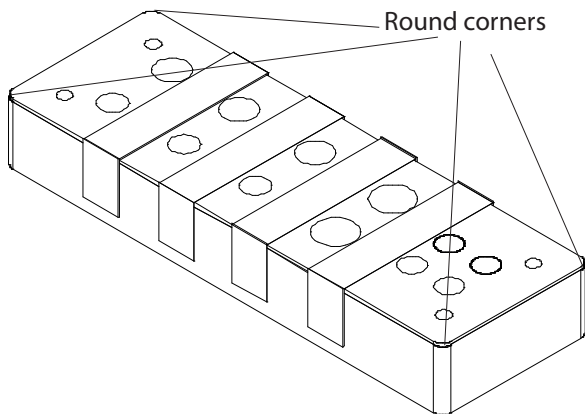

Round corners

4. Place the work piece (2+1) in a machine vice. Drill the 4 corner holes in the corner. The remaining holes according to the pattern. 8mm deep through the aluminium into the wood.

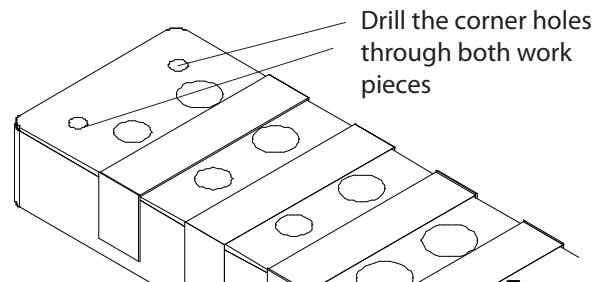

Drill the corner holes through both work pieces

5. Remove the aluminium sheet from the wood.

6. Countersink the holes .

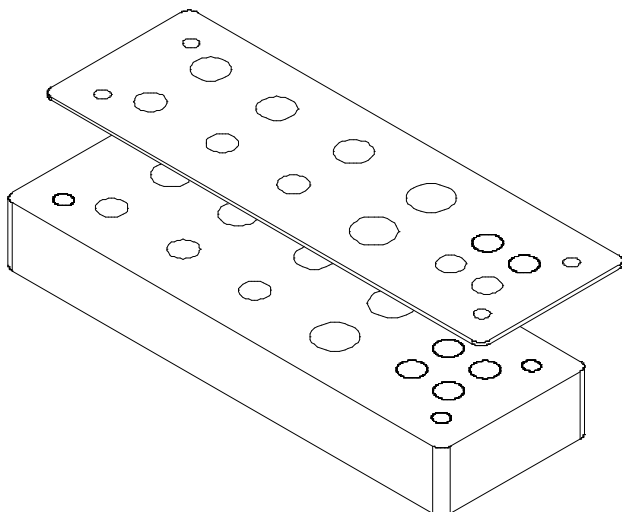

7. Lightly countesink the holes in the wood.

Note:

Due to the manufacture of drills it is possible that there shanks are larger than drilled. In this case you can drill the holes out slightly larger or use a round file to ease the hole.

8. The qudrat hole in the aluminium can be cut out with a metal working saw and cleaned up with a file.

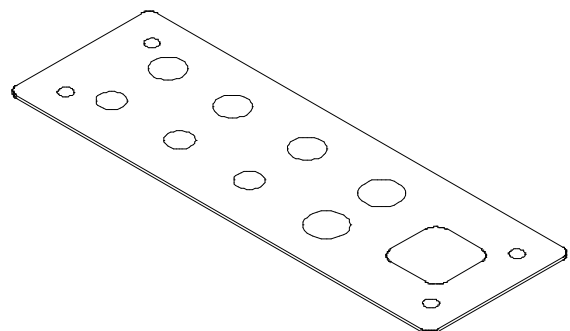

INSTRUCTIONS

9. Cut out the square hole in the wood block with a chisel .

Note :

You can also use a Forstner bit $\varnothing 20\text{mm} \times 8\text{ mm}$ deep, removing the remainder with a chisel .

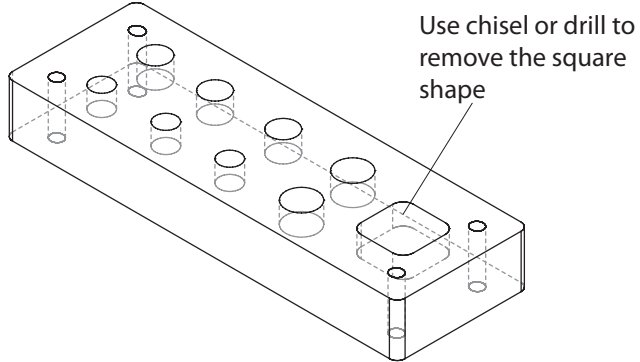

10. Insert the set screws(3) up through the wooden blocks

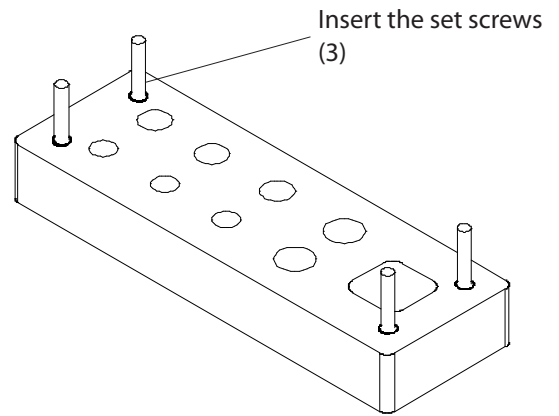

11. Place a washer (5) on each set screw.

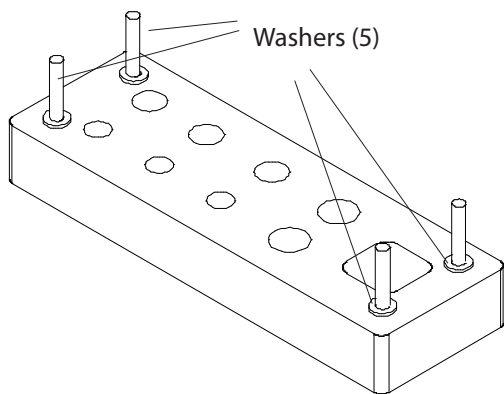

12. Place a brass tube spacer (6) on each of the set screws on to the washer (5)

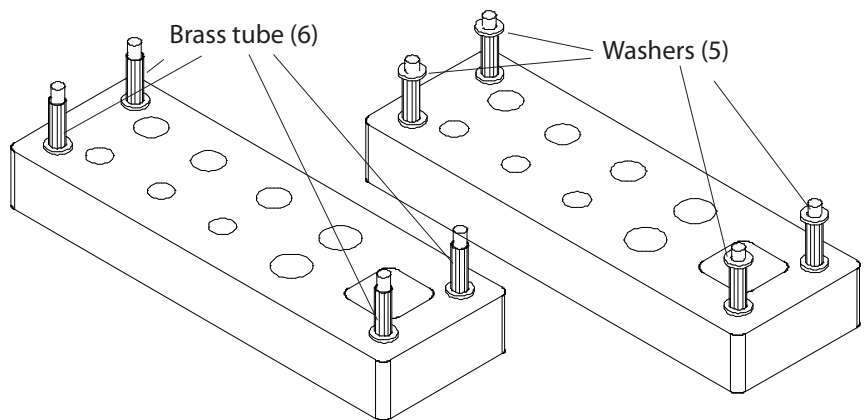

13. Place the aluminium sheet on the 4 set screws (3) see diagram .

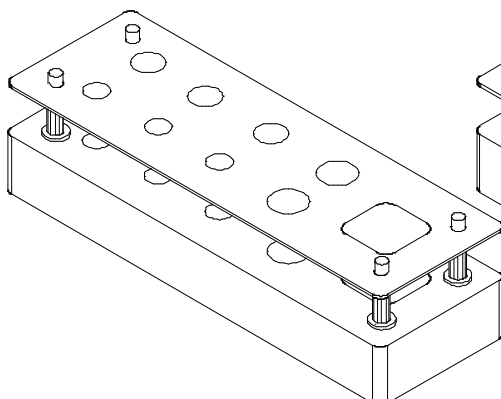

14. Place a washer on top and then screw on the domed nuts (4)

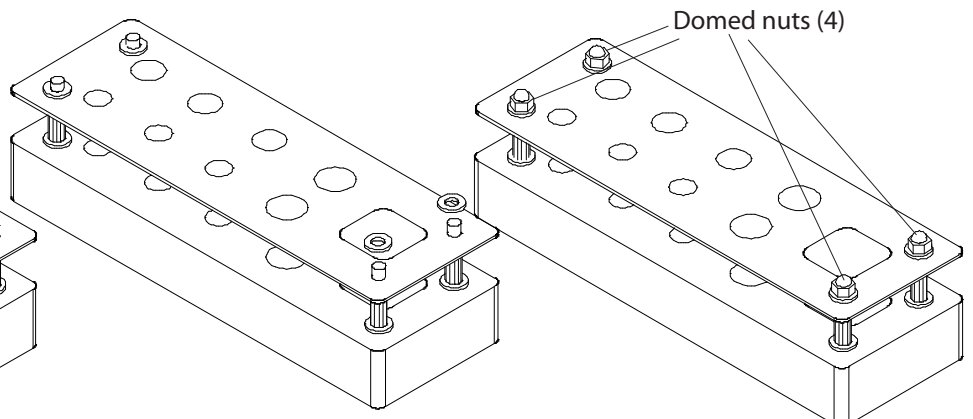

INSTRUCTIONS

Drilling pattern

E 1:1

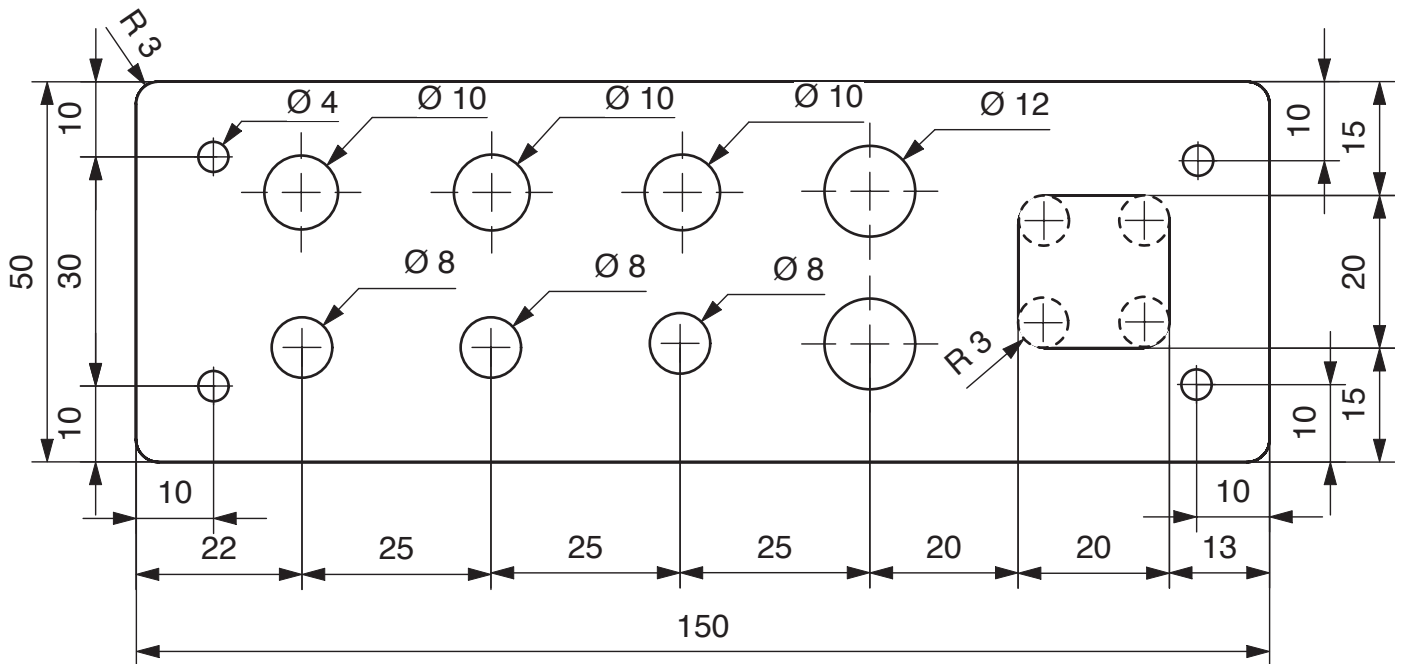

Pattern for countersink

E 1:1

General:

If the shanks of the drills do not fit easily in the holes you can either drill them out a little larger, or use a round file to makethem larger!

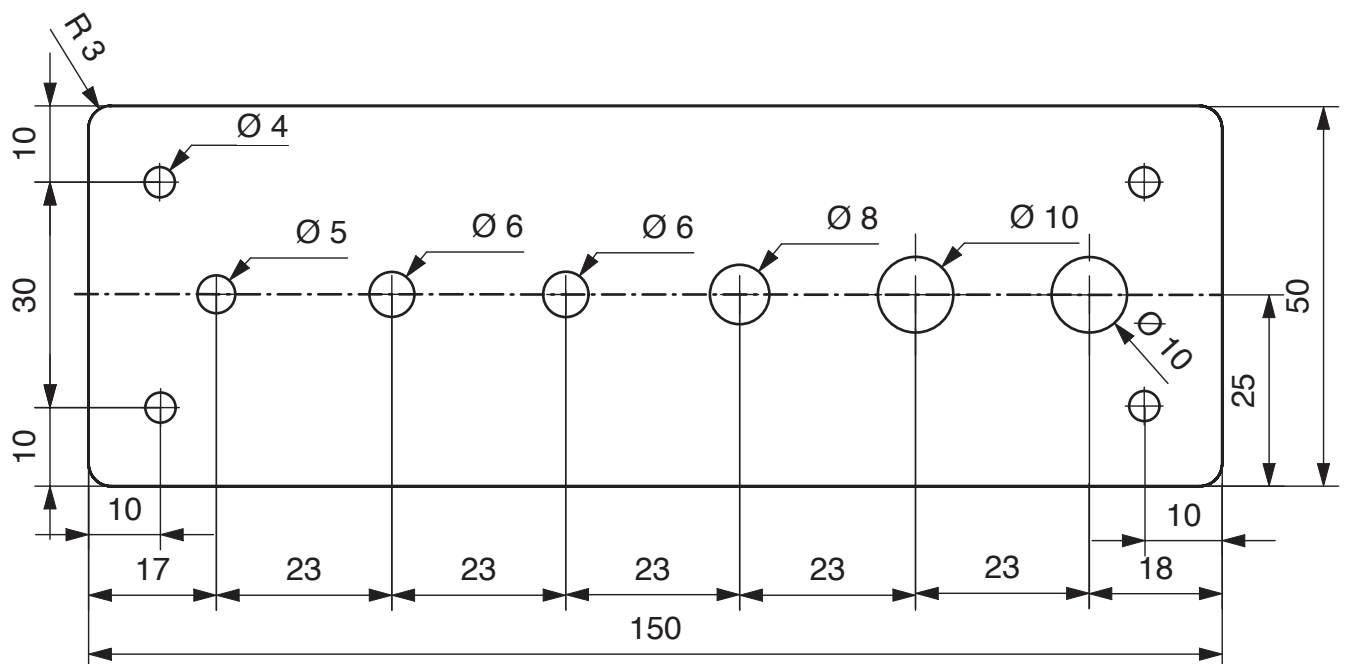

INSTRUCTIONS

Pattern for metal drills

E 1:1

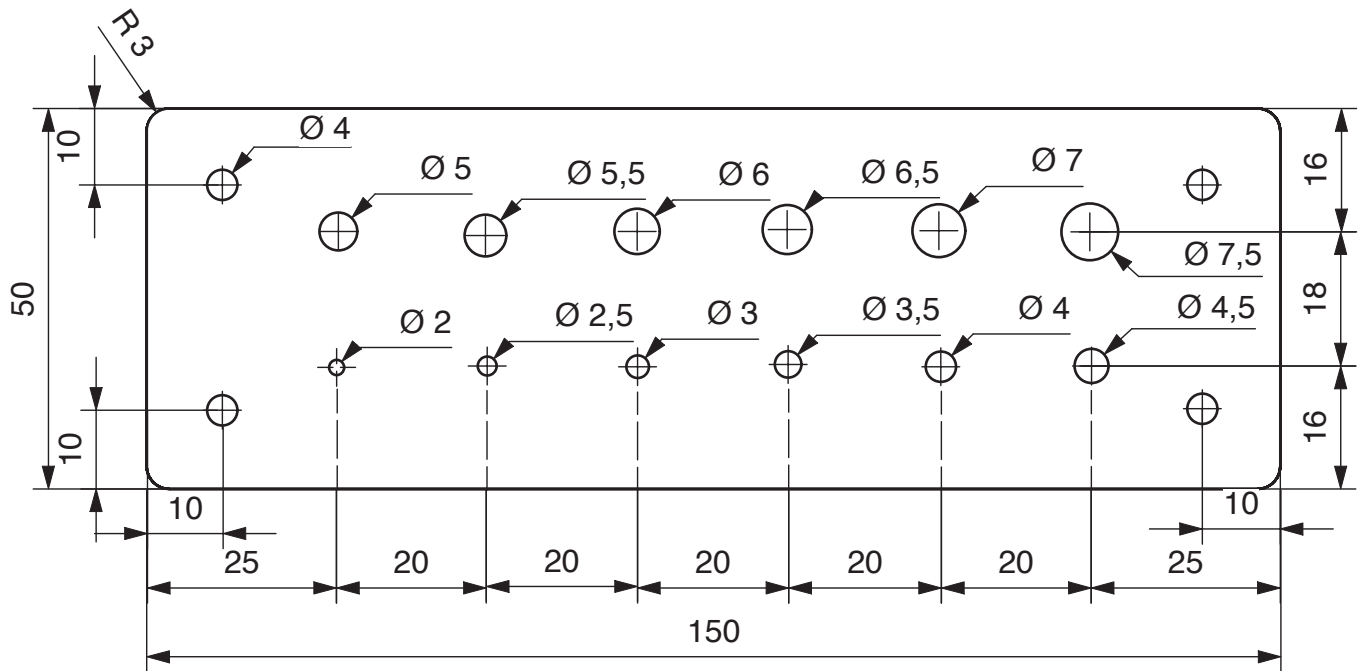

Drilling pattern for wood drills

E 1:1

