

100.205 Smoking Man

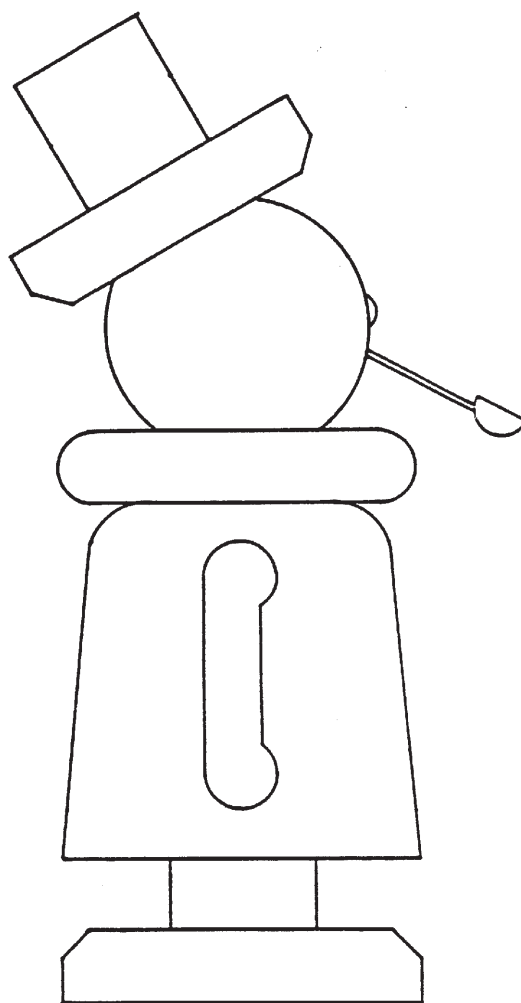
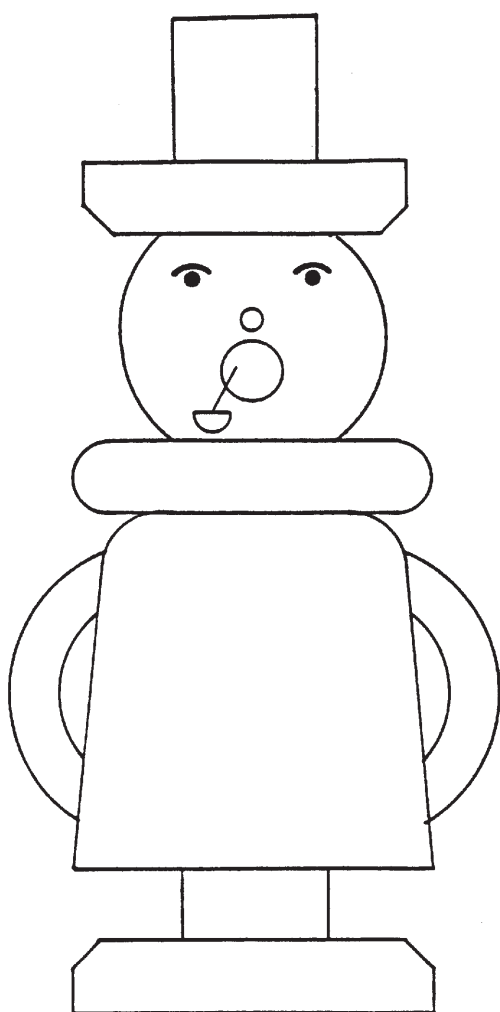

Contents

2 Beech Wheels	ø 50 x 10 mm
2 Beech Dowels	ø 30 x 20 mm
1 Beech Dowel	ø 50 x 50 mm, with hole ø 28 mm
1 Beech Dowel	ø 3 x 50 mm
1 Wooden Ball	ø 40 mm
1 Wooden Ball	ø 15 mm
1 Wooden Ball	ø 10 mm
2 Beech Wood-Profile Wheels	ø 50 mm
1 Wire	20 mm

Please Note

The OPITEC range of projects is not intended as play toys for young children. They are teaching aids for young people learning the skills of Craft, Design and Technology. These projects should only be undertaken and tested with the guidance of a fully qualified adult. The finished projects are not suitable to give to children under 3 years old. Some parts can be swallowed. Danger of suffocation!

Warning!

This product contains small parts that can be swallowed. There is a danger of choking.

1. Body

The body of the Smoking Man is made from the beech dowel 50 mm dia. x 50 mm with the 28 mm dia. hole through the middle. On the top of the body a circle with a radius of 18 mm is drawn and the outer 7 mm should be tapered to the bottom of the tube (see diagram). Finally on the top of the body dowel, file out a pattern of air slots as shown in the diagram. Then turn the body upside down and file a similar row of air slots plus the extra openings as shown in the diagram.

Top

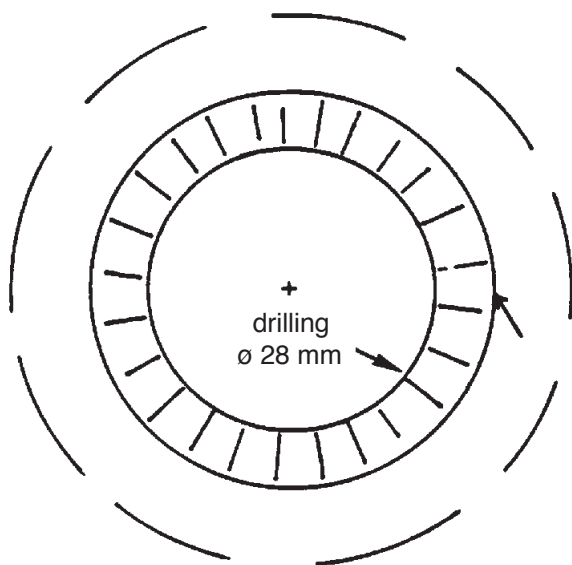

bottom

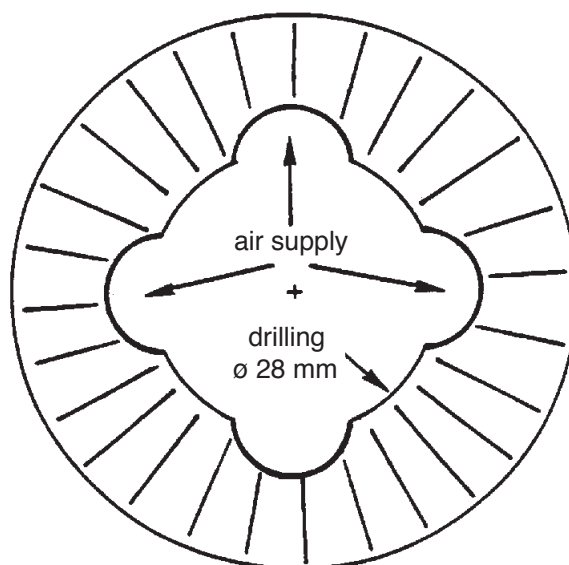

cross section

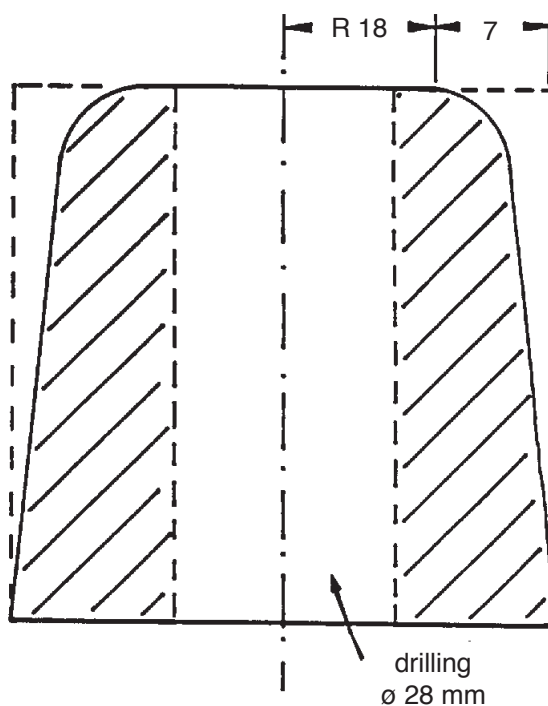

2. Feet / Hat

These parts can be made one after the other as they are similar (see drawing).

The feet should be tapered in conical fashion to fit inside the body of the Smoking Man so that it is tight. To hold the smoke candle, the wire included in the pack should be fixed in the centre of the feet. The candle should be eventually set with an 5 mm gap between the candle and the holder. This is to stop the candle burning the wood.

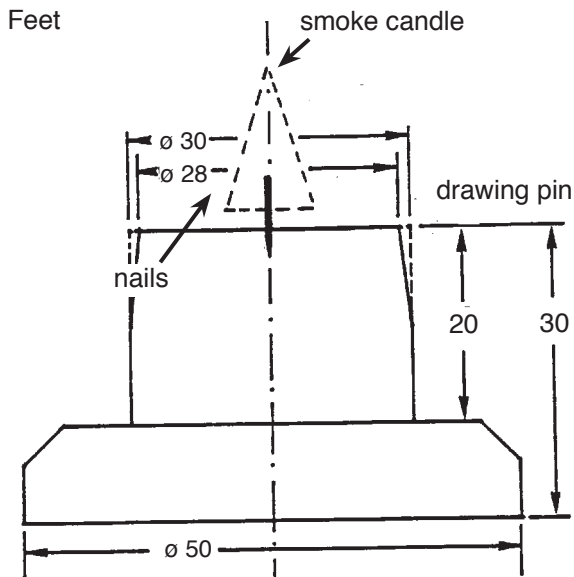

Hat

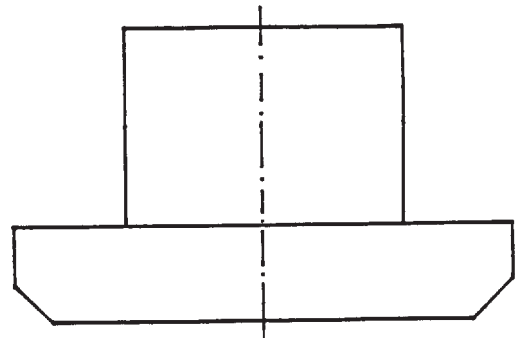

3. Collar

The collar is made from the beech profile wheel with the centre bored out to 28 mm dia.

4. Arm

The arms are made from the beech wheel which has been sawn in half and sanded back so that the middle hole is no longer visible. An end sanding machine would be quicker for this operation. Before gluing the arms to the body, make sure the area where they are to be glued is flatterened to ensure a good contact.

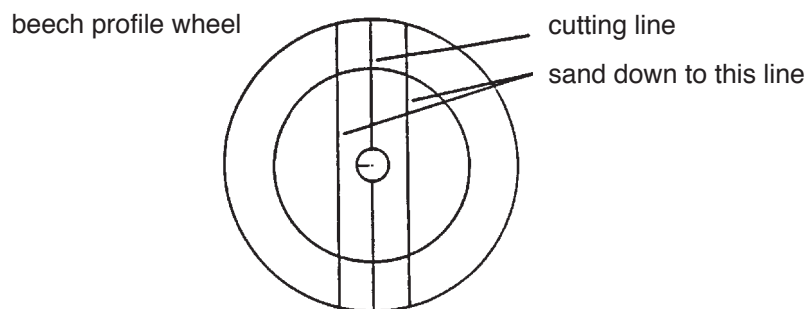

5. Head

The head is made from the 40 mm dia. wooden ball which has been bored out in the middle to 10 mm dia. For the smoke tunnel another 10 mm dia. hole must be drilled at an angle to the first (see diagram). To make sure this process is easily achieved use a machine vice and pillar drill. A further 3 mm dia. hole will need to be drilled to take the pipe. The nose is made from a flattened 10 dia. wooden ball.

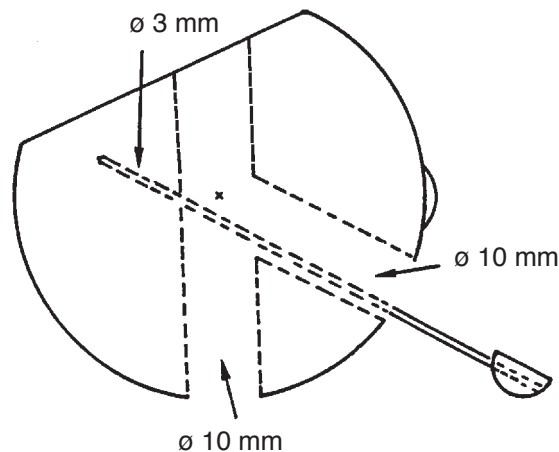

6. Pipe

A 15 mm dia. wooden ball is cut down to make the pipe bowl approx. $\frac{1}{4}$ of the original ball size. Then it is joined to a 50 mm long x 3 mm dia. dowel for the stem. Glue and shape the pipe and insert into the mouth.

7. Last notes

All parts should be glued together (except and foot/body). Then sand the Smoking Man to a good finish and finally use clear varnish. Of course, you can paint your own designs on the figure but it is better to add any colour sparingly. The eyes can be added with a felt tip pen or rub down transfers as you want. Extra candles are available from OPITEC.