

108.993

# Perpetual Calendar/ Advent Calendar

## Required Tools:

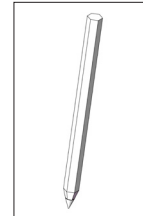

pencil

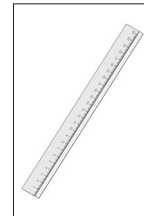

ruler

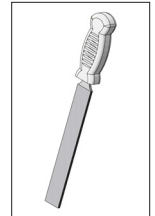

engineer's file

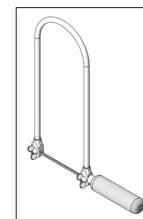

fretsaw or  
scroll saw

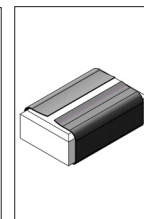

sandpaper

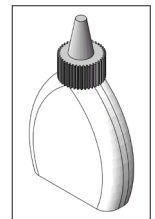

wood glue



scissors

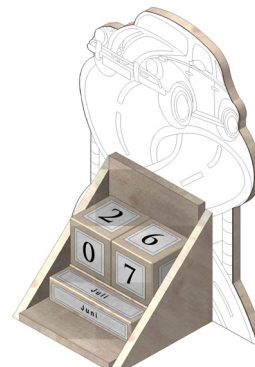
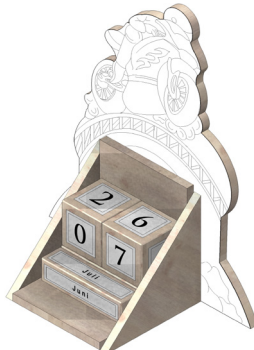
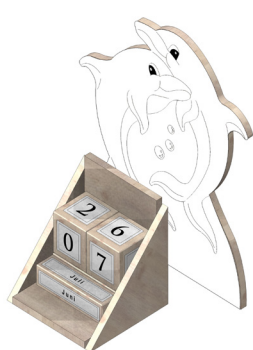
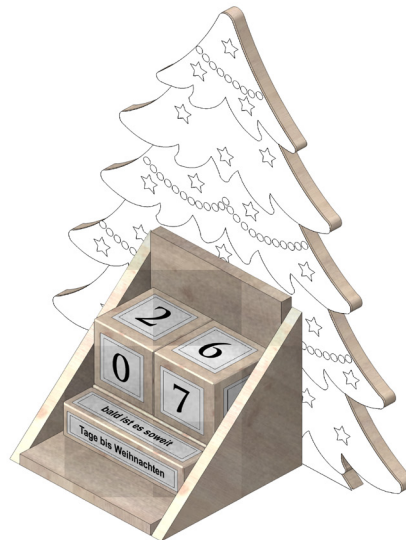

### Please Note

The Opitec Range of projects is not intended as play toys for young children. They are teaching aids for young people learning the skills of craft, design and technology. These projects should only be undertaken and operated with the guidance of a fully qualified adult. The finished projects are not suitable to give to children under 3 years old. Some parts can be swallowed. Danger of suffocation!

| Parts List                  | Quantity | Size (mm) | Designation         | Parts No. |
|-----------------------------|----------|-----------|---------------------|-----------|
| wooden strip                | 1        | 250x15x15 | month specification | 1         |
| wooden cube                 | 2        | 30x30x30  | date                | 2         |
| plywood                     | 1        | 250x70x5  | filing              | 3         |
| plywood                     | 1        | 200x200x5 | motif               | 4         |
| drawing template dog        | 1        |           | motif pattern       | 5         |
| drawing template dolphin    | 1        |           | motif pattern       | 6         |
| drawing template motorcycle | 1        |           | motif pattern       | 7         |
| drawing template car        | 1        |           | motif pattern       | 8         |

**Building Instruction 108.993**  
**Perpetual Calendar**

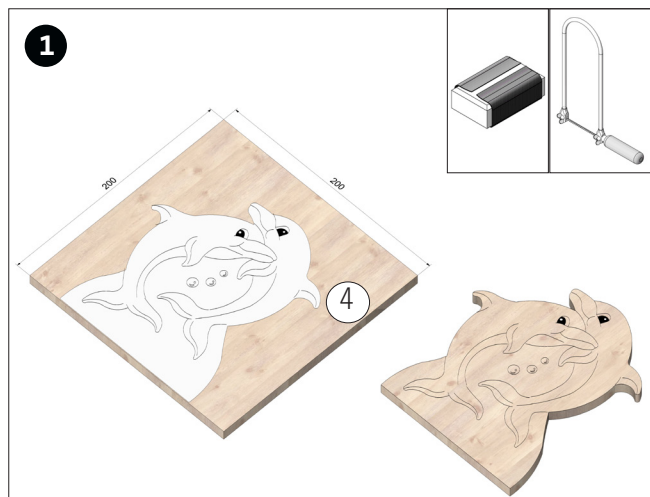

Transfer your desired motif (pages 7-10) to the plywood plate (4) and saw it out. Clean the saw cuts.

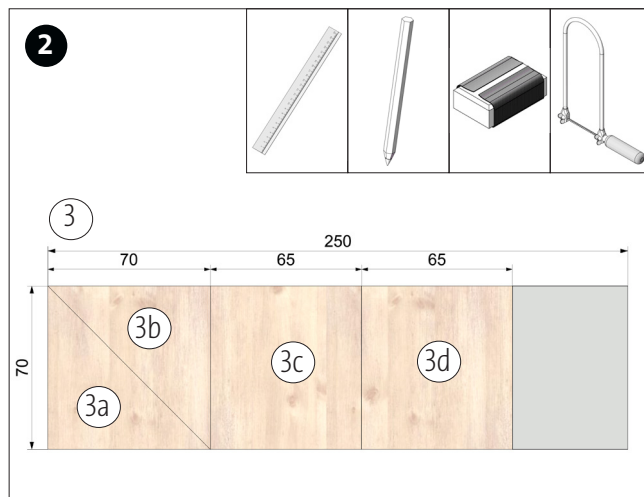

Transfer the wooden parts for the shelf to the plywood (3). Saw out all parts and clean the saw cuts.

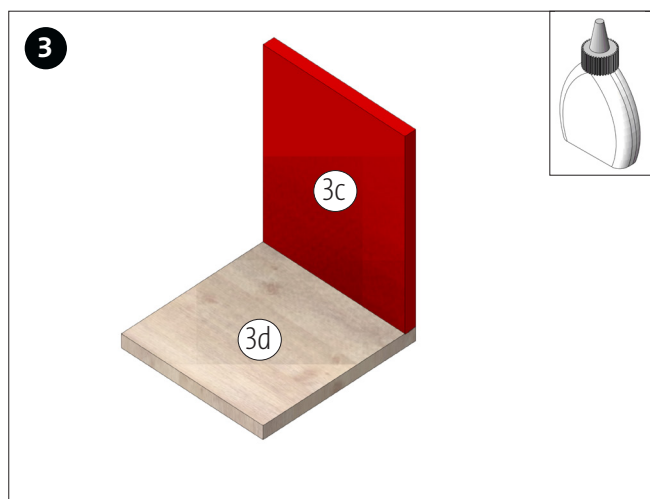

Glue the back part (3c) to the base (3d) as shown. Let the glue dry well.

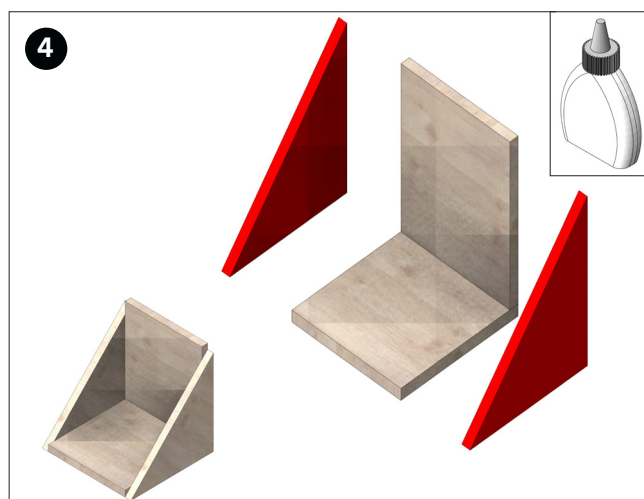

Then glue the side parts (3a) and (3b). Let the glue dry well.

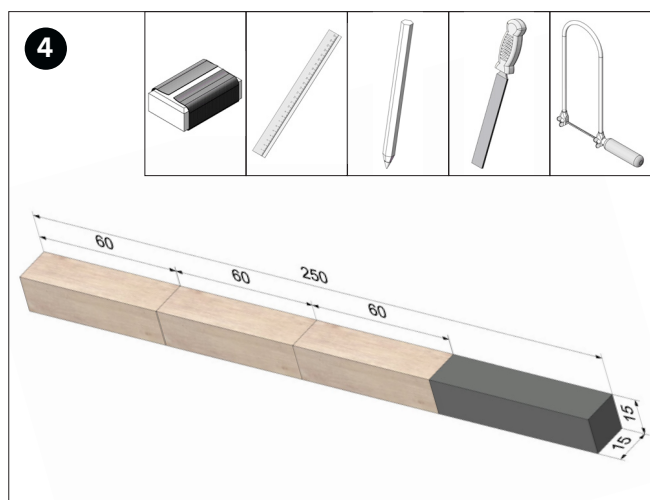

Measure 3 x 60 mm of the wooden strip (1). Saw off the parts and clean the saw cuts. Chamfer all edges.

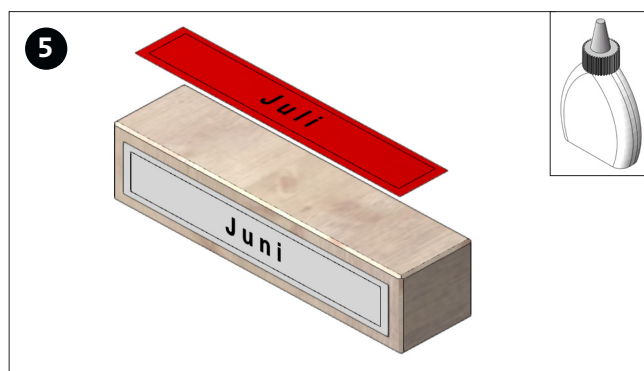

Cut out the months (page 5) and glue them to the wooden strips as follows.

**Bar 1:**

Side 1 - January  
 Side 1 - February  
 Side 1 - March  
 Side 1 - April

**Bar 2:**

Side 1 - May  
 Side 1 - June  
 Side 1 - July  
 Side 1 - August

**Bar 3:**

Side 1 - September  
 Side 1 - October  
 Side 1 - November  
 Side 1 - December

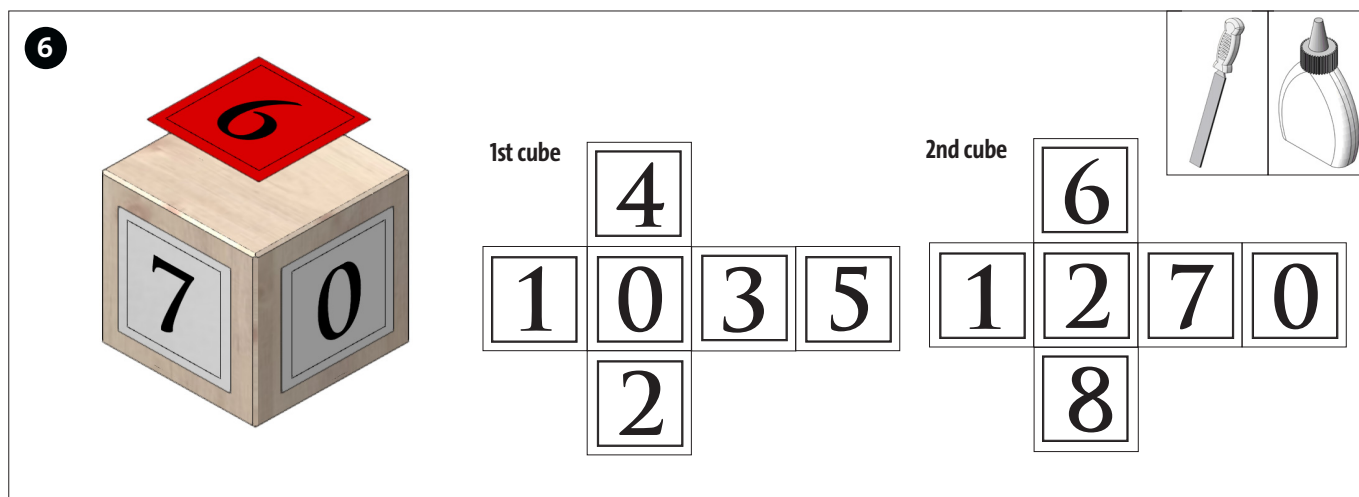

Chamfer all edges of the pine cubes (2) with the file. Cut out the numbers for the cubes (page 5) and stick them onto the cube surfaces as shown above.

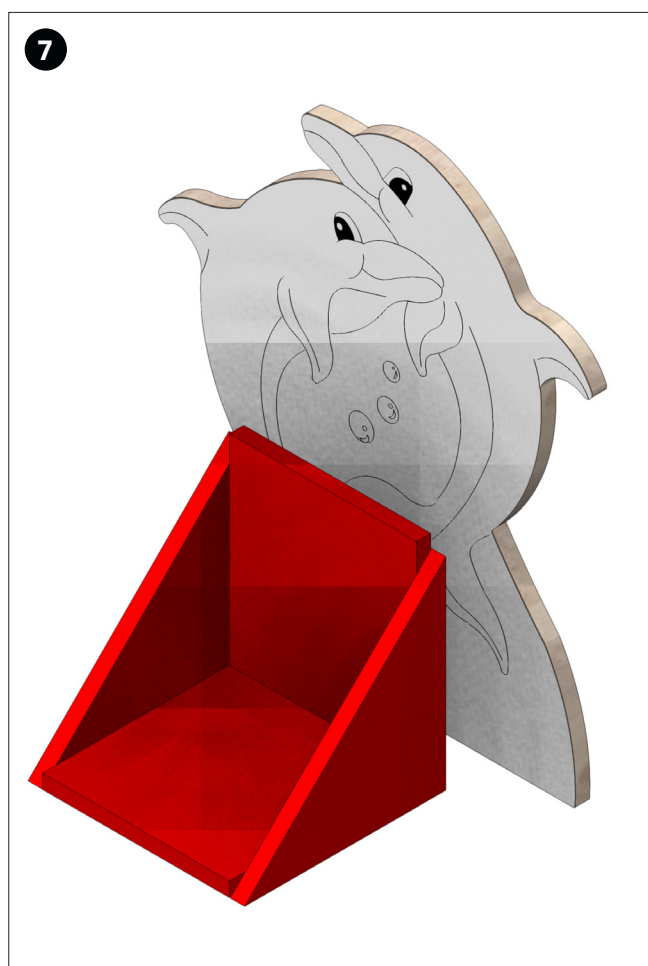

Glue the finished shelf centrally onto the front and flush with the lower edge of the wooden motif.  
Colour the finished calendar (wooden strips and cubes) as desired.

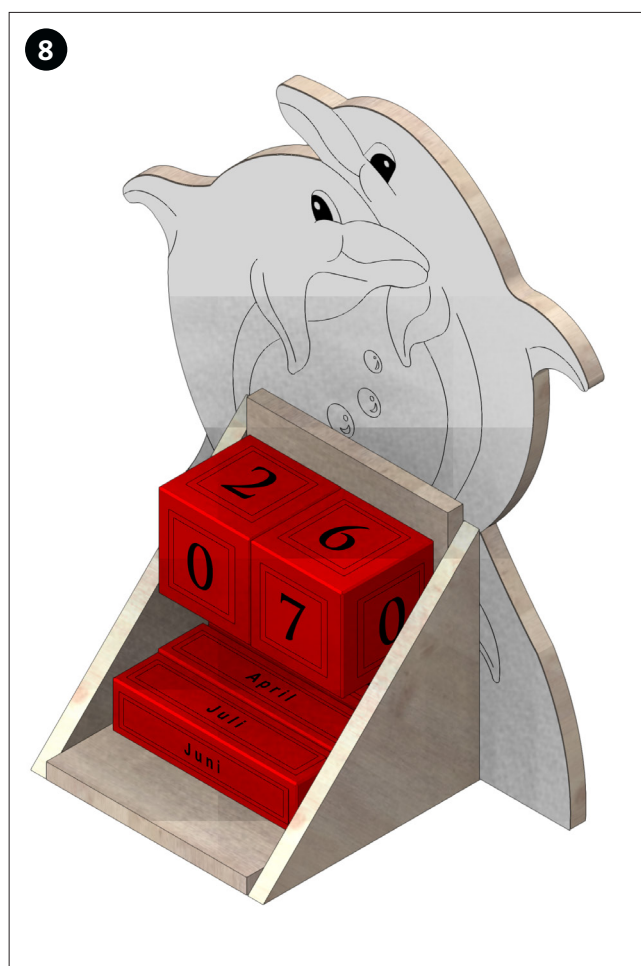

After the paint has dried thoroughly, place the strips and cubes in the tray and set the date by turning the cubes and strips.



Bar 1:

|          |
|----------|
| January  |
| February |
| March    |
| April    |

Bar 2:

|        |
|--------|
| May    |
| June   |
| July   |
| August |

Bar 3:

|           |
|-----------|
| September |
| October   |
| November  |
| December  |

1st cube

|   |   |   |   |
|---|---|---|---|
| 1 | 2 | 4 | 0 |
| 3 | 5 |   |   |

2nd cube

|   |   |   |   |
|---|---|---|---|
| 1 | 2 | 7 | 0 |
| 6 | 8 |   |   |

Bars for Advent Calendar:

Bar 1:

|                     |
|---------------------|
| Days till Christmas |
| Saint Nicholas      |
| Christmas Eve       |
| Soon is the time    |

Bar 2:

|          |
|----------|
| 1.Advent |
| 2.Advent |
| 3.Advent |
| 4.Advent |

Bar 3:

|                   |
|-------------------|
| Back biscuits     |
| Wrap gifts        |
| Decorate the tree |
| Put shoes out     |

Bars for self labelling:

|  |
|--|
|  |
|  |
|  |
|  |

|  |
|--|
|  |
|  |
|  |
|  |

|  |
|--|
|  |
|  |
|  |
|  |



