

115.305

EasyLine Wooden House

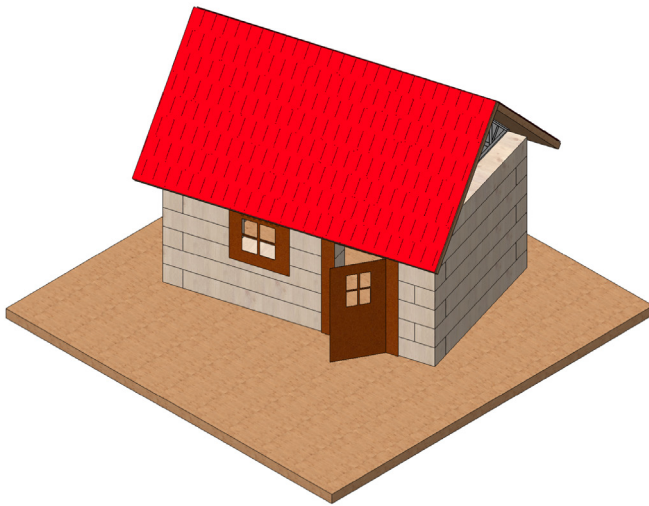

Tools required:

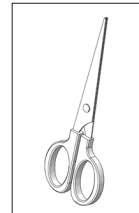

Scissors

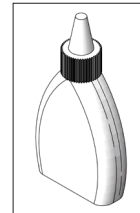

Wood Glue



Craft Knife

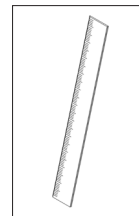

Ruler

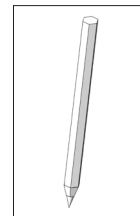

Pencil

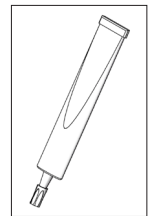

All Purpose
Glue

Please Note!

The OPITEC handicraft packs are not toys in a typical off-the-shelf sense, but rather additional teaching and learning material for educational purposes. This craft pack may only be constructed by children and adolescents under the guidance and supervision of experienced adults. Not suitable for children under 36 months. Choking hazard!

Stocklist	Quantity	Size (mm):	Description	Part-No.
Wooden Strip	7	125x10x10	Baseboard	1
Wooden Strip	7	25x10x10	Baseboard	2
Wooden Strip	17	75x10x10	Baseboard	3
Wooden Strip	2	15x10x10	Baseboard	4
Wooden Strip	6	35x10x10	Baseboard	5
Wooden Strip	1	65x10x10	Baseboard	6
Wooden Strip	1	85x10x10	Baseboard	7
Wooden Strip	1	108x10x10	Baseboard	8
MDF Board	1	200x200x5	Base Plate	9
MDF Square	2	50x50x3,2	Gable Roof	10
MDF Board	2	149x79x3,2	Roof	11

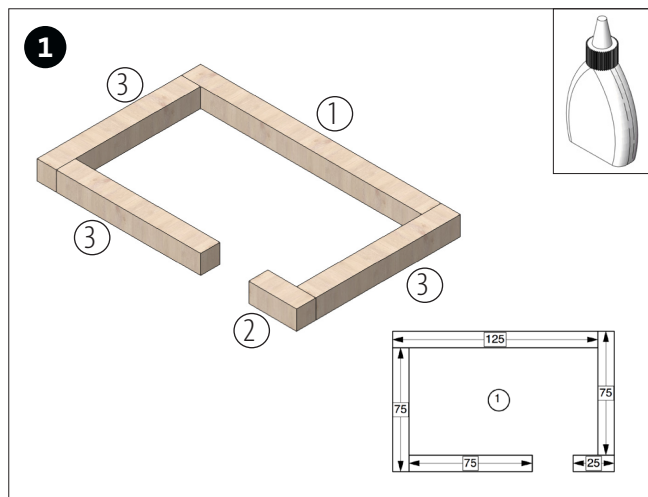

Glue the first layer as illustrated.

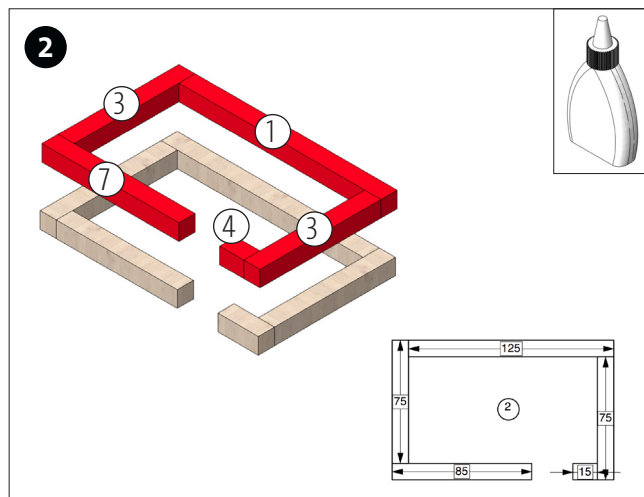

Glue the second layer before sticking it on top of layer 1 (see ill.).

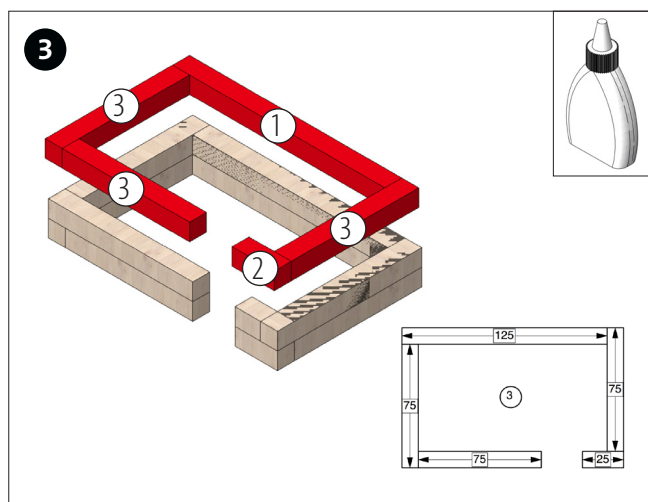

Glue the third layer before sticking it on top of layer 2 (see ill.).

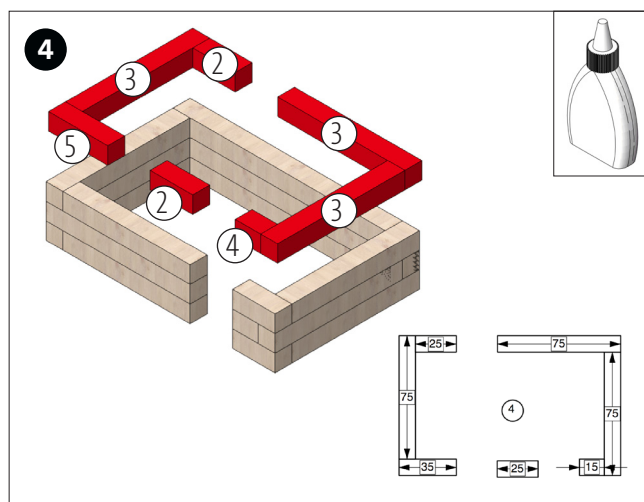

Glue the fourth layer before sticking it on top of layer 3 (see ill.).

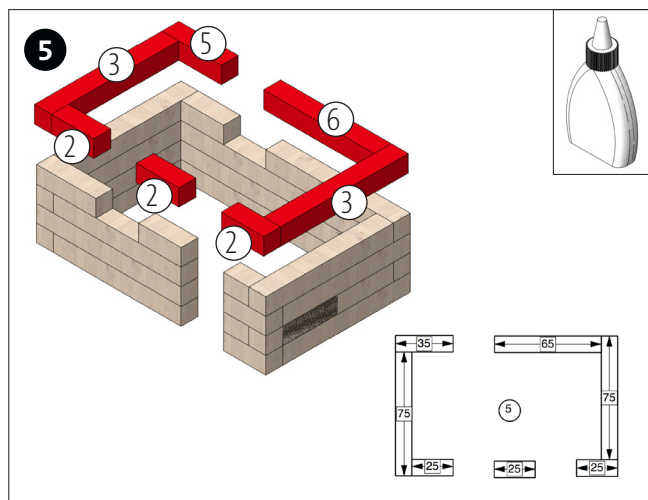

Glue the fifth layer before sticking it on top of layer 4 (see ill.).

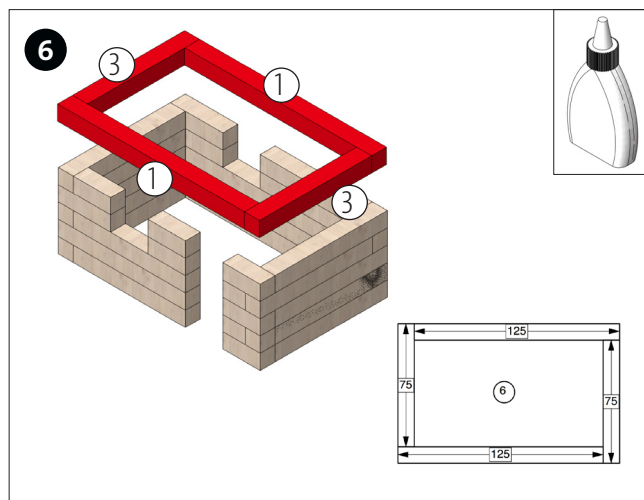

Glue the sixth layer before sticking it on top of layer 5 (see ill.).

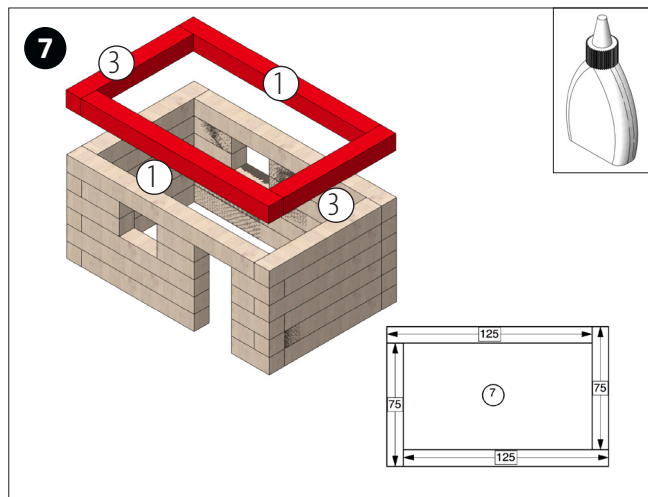

Glue the seventh layer before sticking it on top of layer 6 (see ill.).

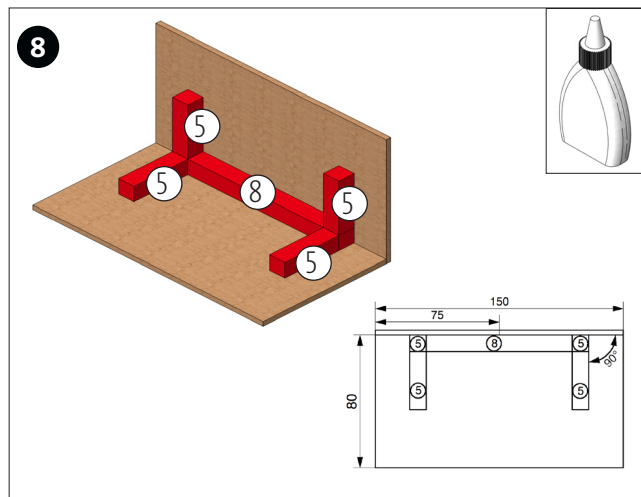

Glue the two MDF boards in a 90° angle. Glue the baseboard (8) centrally with one wooden strip (5) on each end. See illustration!

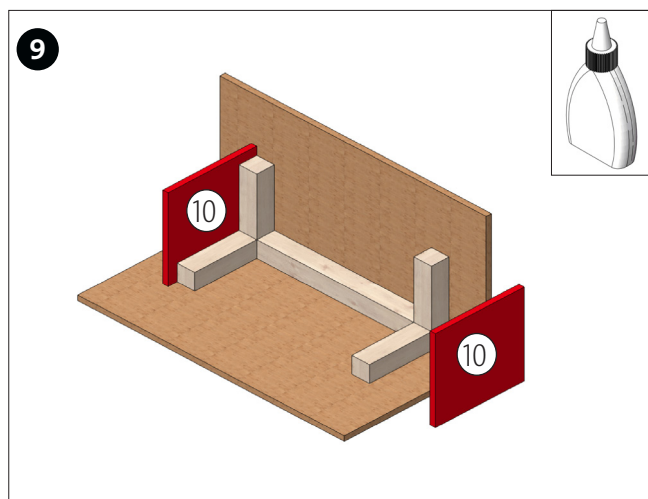

Glue the MDF squares from both sides onto the wooden construction as illustrated.

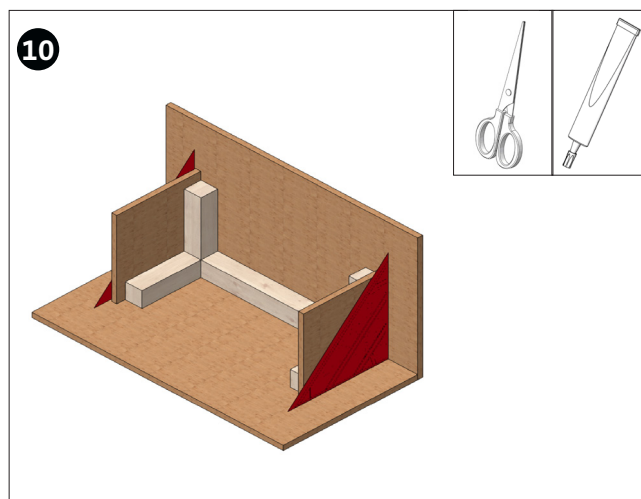

Cut out the two gable templates (a) on page 5. Flush-mount them onto the squares with glue.

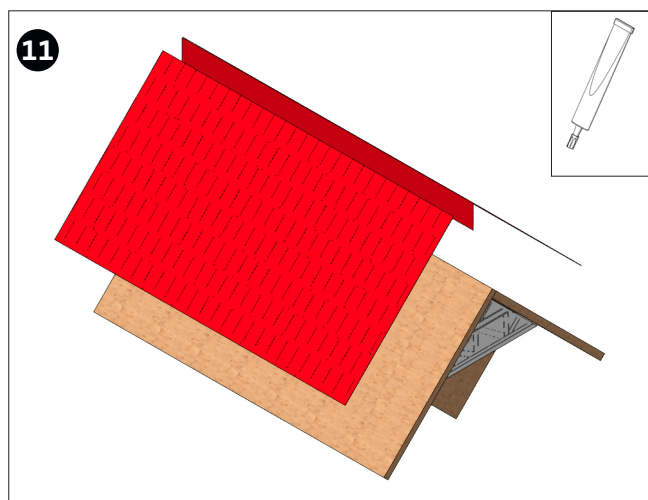

Cut the brick template and stick it onto the roof pitch (see illustration).

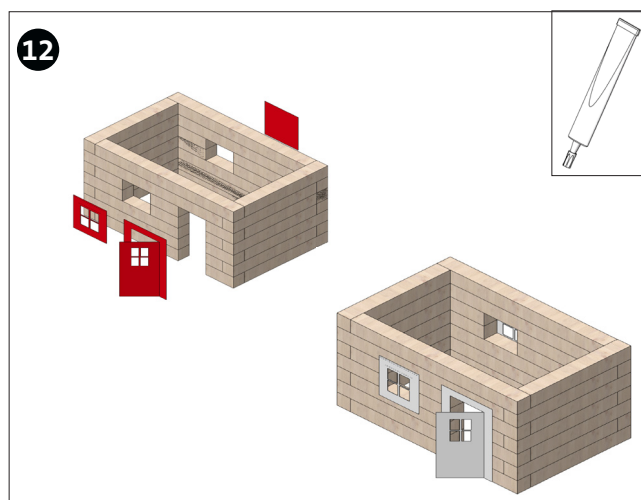

Cut the window and door template and fix them as illustrated.

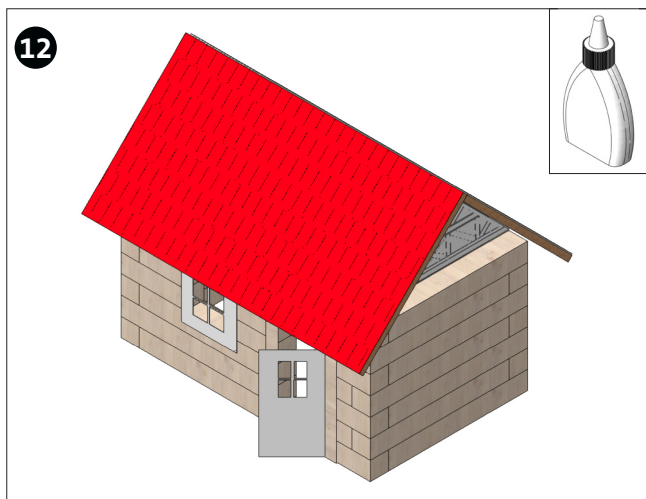

Fix the roof so that both square halves disappear in the inner edge of the house wall and the roof pitch rests on the outer edge.

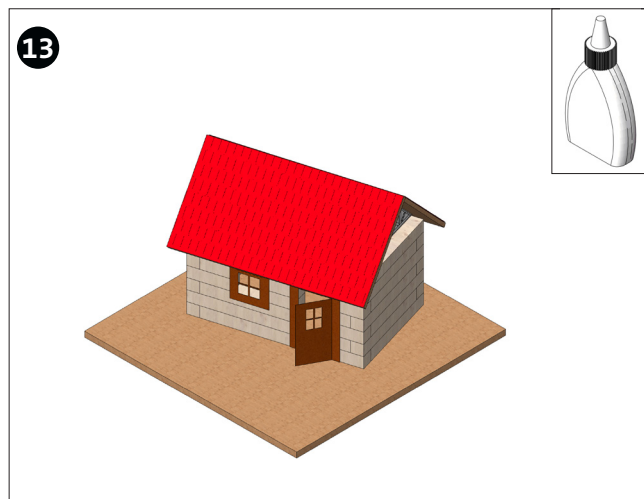

Glue the finished house onto the base plate according to your taste.

