

# 100.113

## Mammoth Jumbo

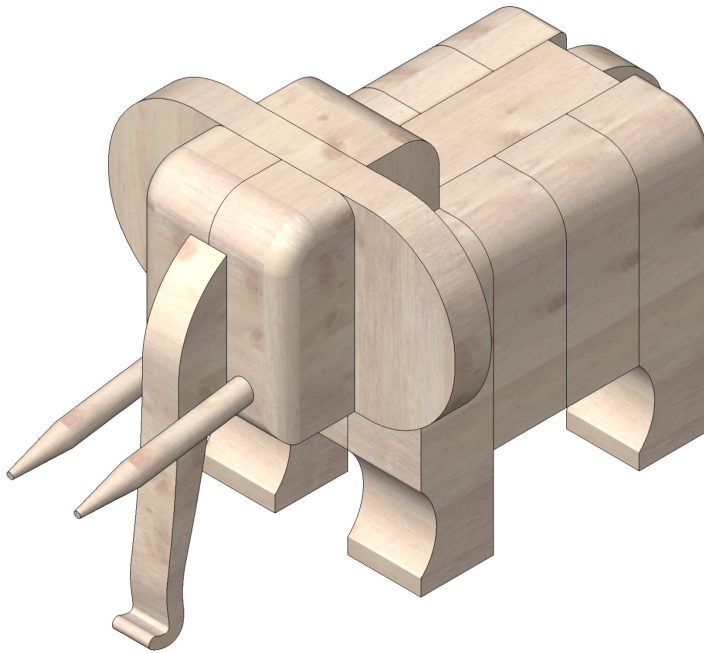

### Required Tools:

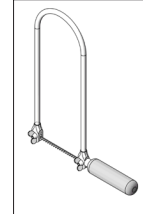

Fretsaw or  
Decoupling  
Saw

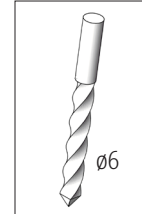

Drill Bit

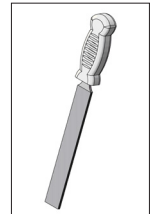

File

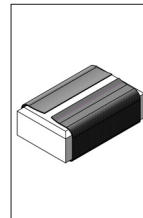

Sand Paper

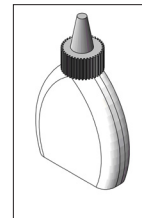

Wood Glue

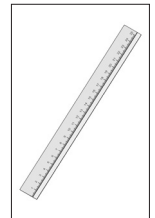

Ruler

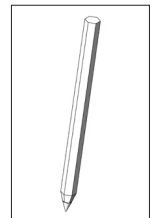

Pencil

### Please Note:

The Opitec Range of projects is not intended as play toys for young children. They are teaching aids for young people learning the skills of craft, design and technology. These projects should only be undertaken and operated with the guidance of a fully qualified adult. The finished projects are not suitable to give to children under 3 years old. Some parts can be swallowed. Danger of suffocation!

| Components List | Quantity | Size (mm) | Description            | Part No. |
|-----------------|----------|-----------|------------------------|----------|
| Wooden strip    | 1        | 75x50x20  | Body                   | 1        |
| Wooden strip    | 1        | 200x50x10 | Ears, trunk, tail      | 2        |
| Wooden strips   | 7        | 50x20x20  | Side parts, face, neck | 3        |
| Wooden strips   | 4        | 75x20x20  | Legs                   | 4        |
| Round Rod       | 1        | ø6x100    | Tusks                  | 5        |

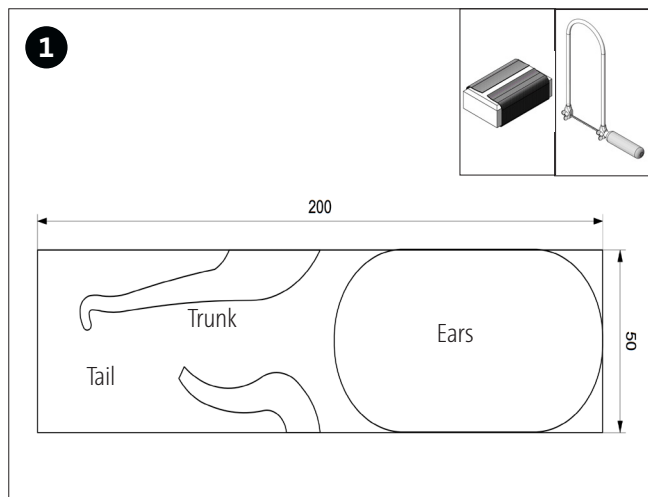

Transfer the template to the wooden strip (2). Cut out the ears, trunk and tail. Then sand the saw cuts with sandpaper.

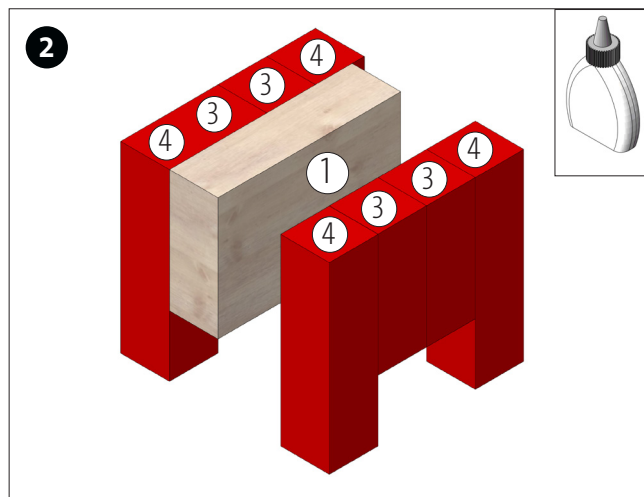

Take the body part (1) and glue one leg strip (4) on both sides, flush with the front and top edges. Then glue the side parts (3) and the remaining leg strips (4), as shown.

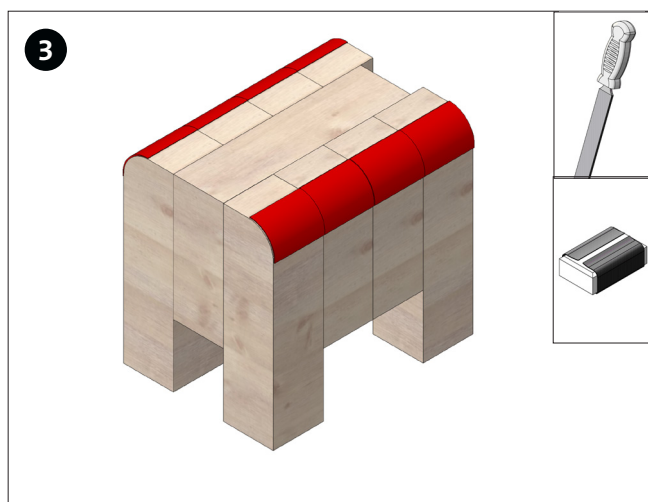

After the glue has dried, round off the two edges on the upper side with the file and sandpaper.

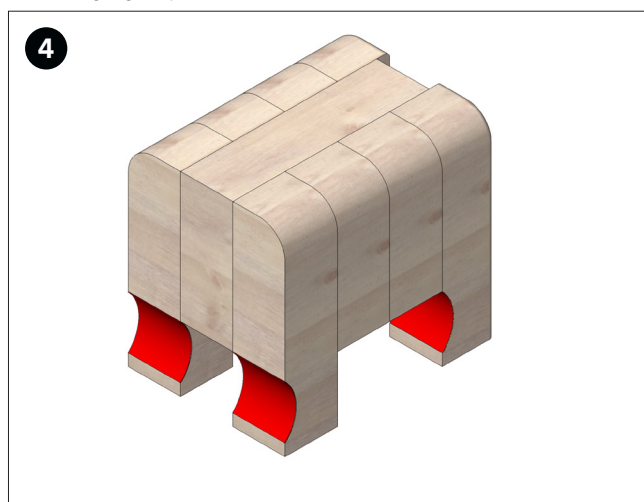

File a recess on the front of the legs as shown.

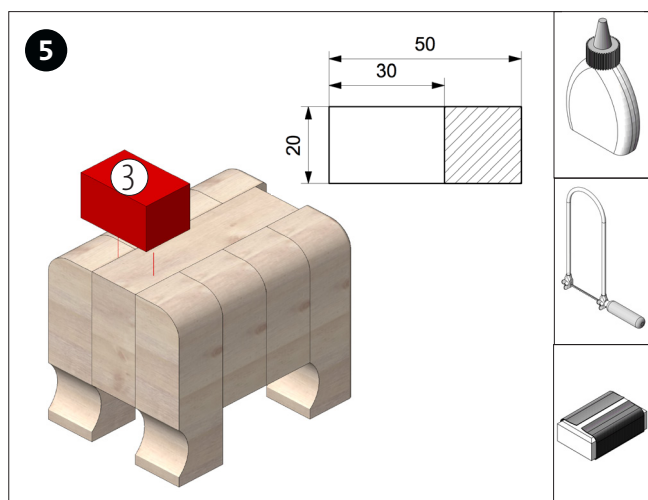

Shorten a wooden strip (3) to 30 mm and clean the saw cut. Then, glue it centred and flush to the front edge.

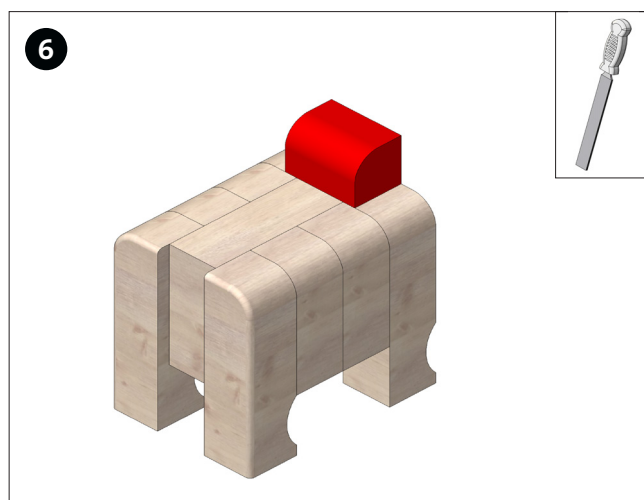

After the glue has dried, round off the neck strip with the file.

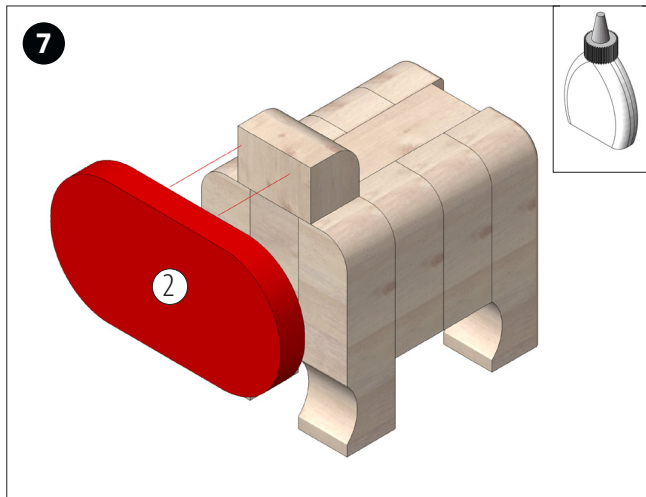

Glue the ears (2) centred and flush with the upper edge of the neck part (3).

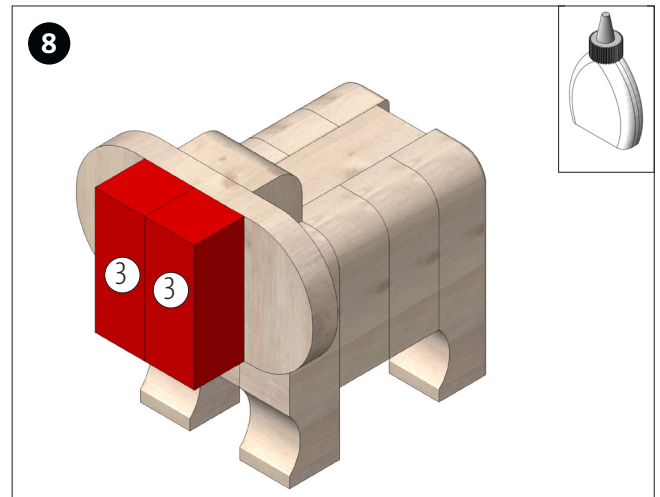

Glue 2 wooden strips (3) together as shown. Then glue them centred on the ears (2). Let the glue dry well.

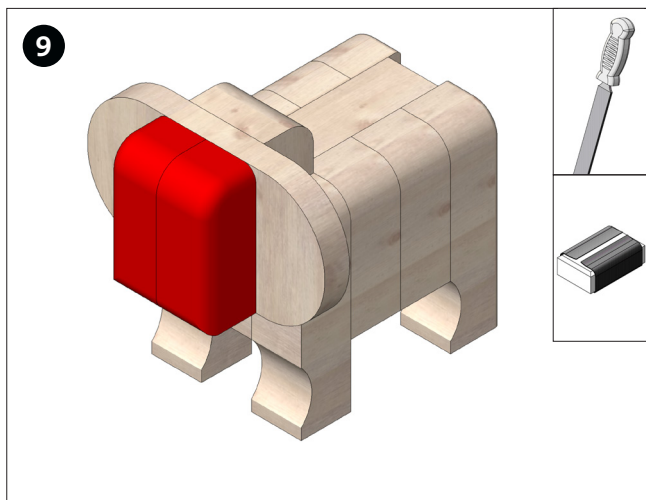

Round off with the file and sand paper.

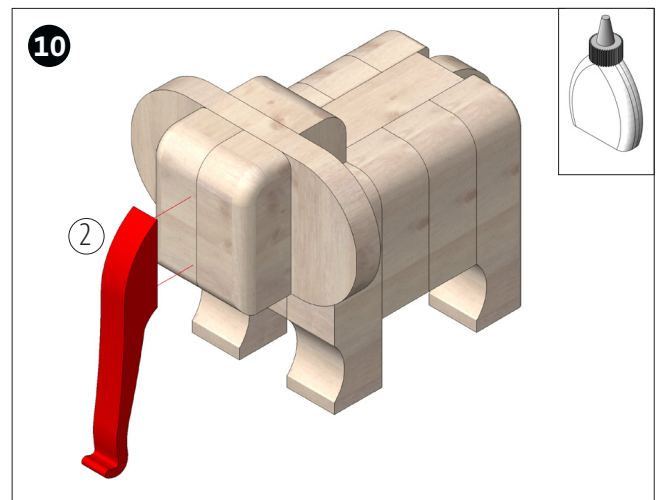

Glue the trunk (2) in the middle.

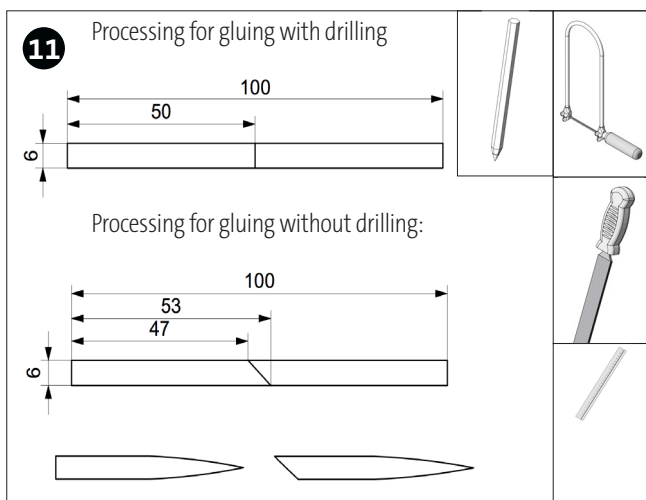

Mark the round rod depending on the processing you choose and divide it with the fretsaw. Then sharpen one side with a file and sand paper.

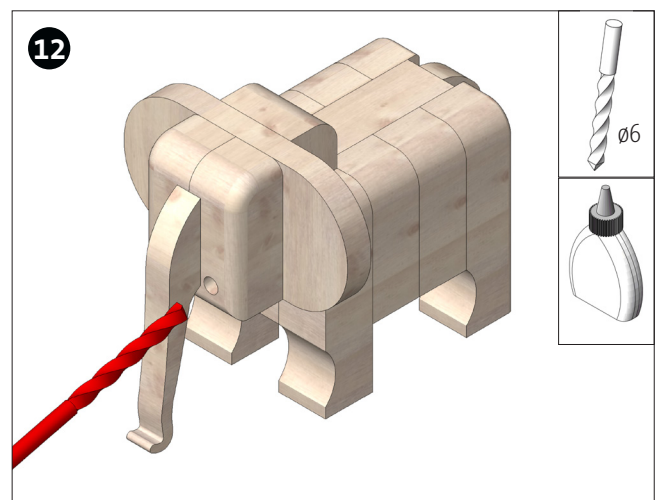

To glue in the tusks, drill a hole (drill at an angle!) on the left and right of the trunk. Then glue the tusks in the drilling or glue them without drilling.

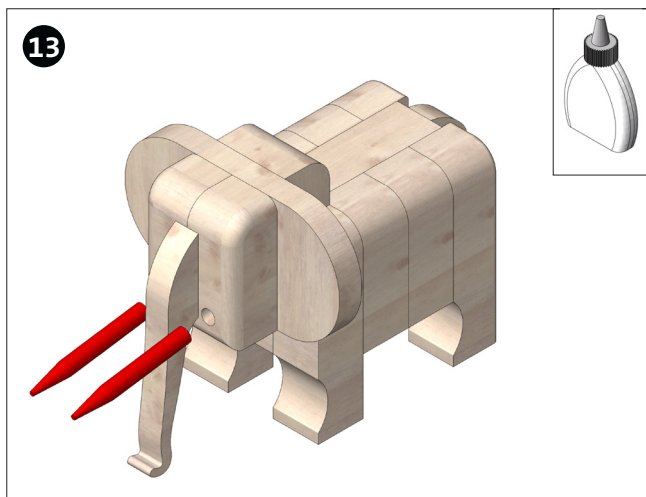

Glue the two tusks into the holes drilled for this purpose.

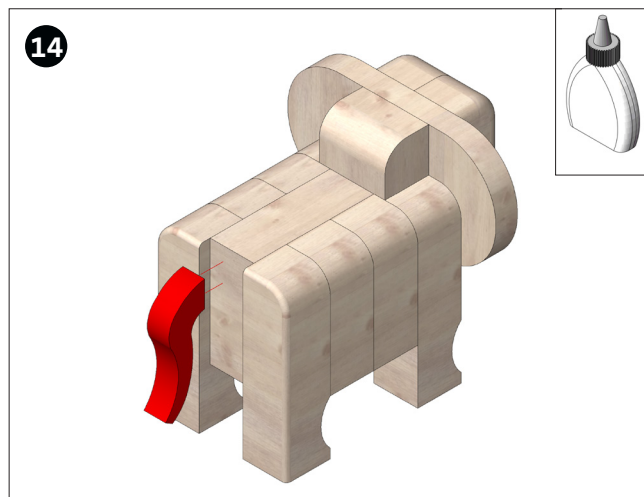

Glue the tail as shown.

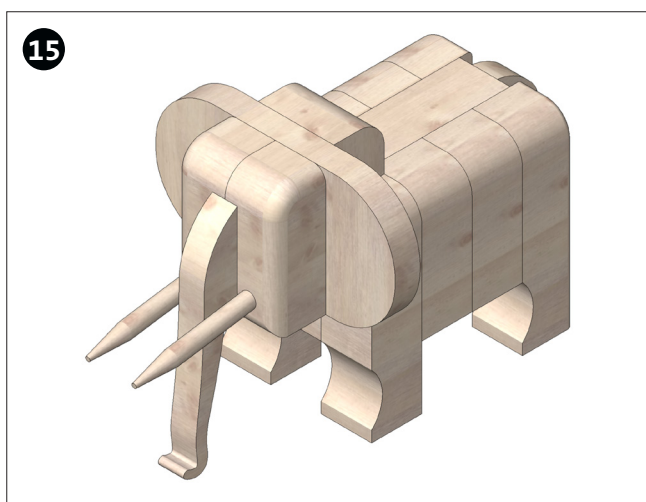

Done!

Template ears, trunk, tail  
Scale 1:1

