

122.935

Mobile phone amplifier

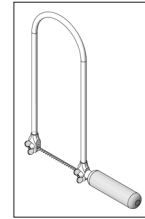

Tools required:



Round File

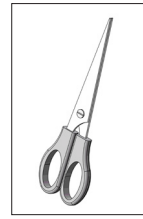

Scissors

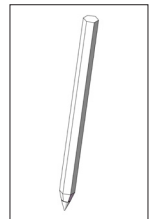

Pencil

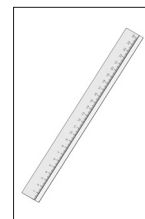

Ruler

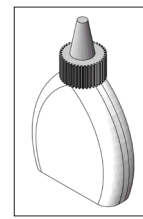

Wood glue

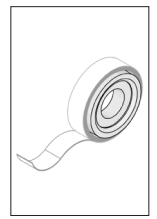

Adhesive tape

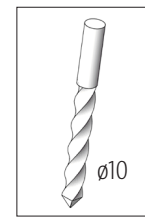

Drill Bit

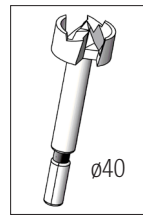

Forstner Drill

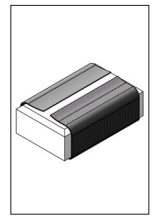

Sandpaper

Note

After completion, the OPITEC work kits are not articles with toy character of a generally commercial kind, but teaching and learning aids to support educational work. This kit may only be built and operated by children and young people under the guidance and supervision of competent adults. Not suitable for children under 36 months. Danger of suffocation!

Parts list	Number of pieces	Dimensions (mm)	Description	Part no.
Plywood	1	160x160x5	Funnel	1
Plywood	2	110x110x5	Plug-in frame	2
Wooden strip	1	250x15x15	Plug-in frame	3
Wooden strip	1	100x15x5	Plug-in frame	4
Foam rubber	1	9,92x9,56x2	Plug-in frame	5

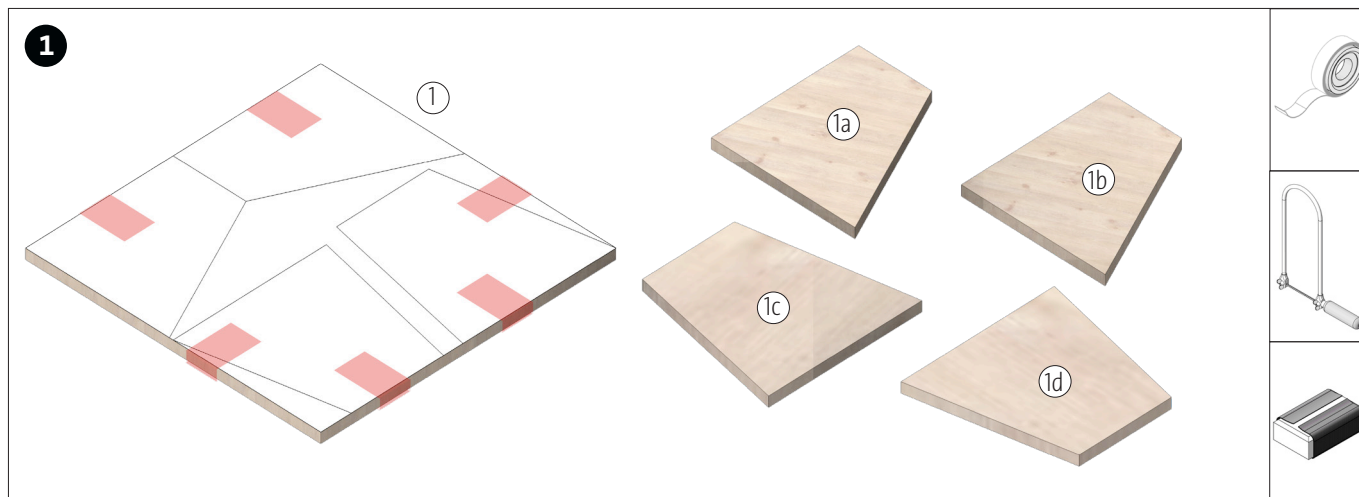

Cut out the template for the amplifier funnel (page...) and glue it to the base plate (1). Then saw out the individual parts (1a-1d) and clean the saw cuts



Cut out the templates for the slide-in compartment (side...) and glue them to the two base plates (2). Then drill the holes $\varnothing 10$ and $\varnothing 40$ mm. Saw out the base plate (2b) and clean the saw cuts.

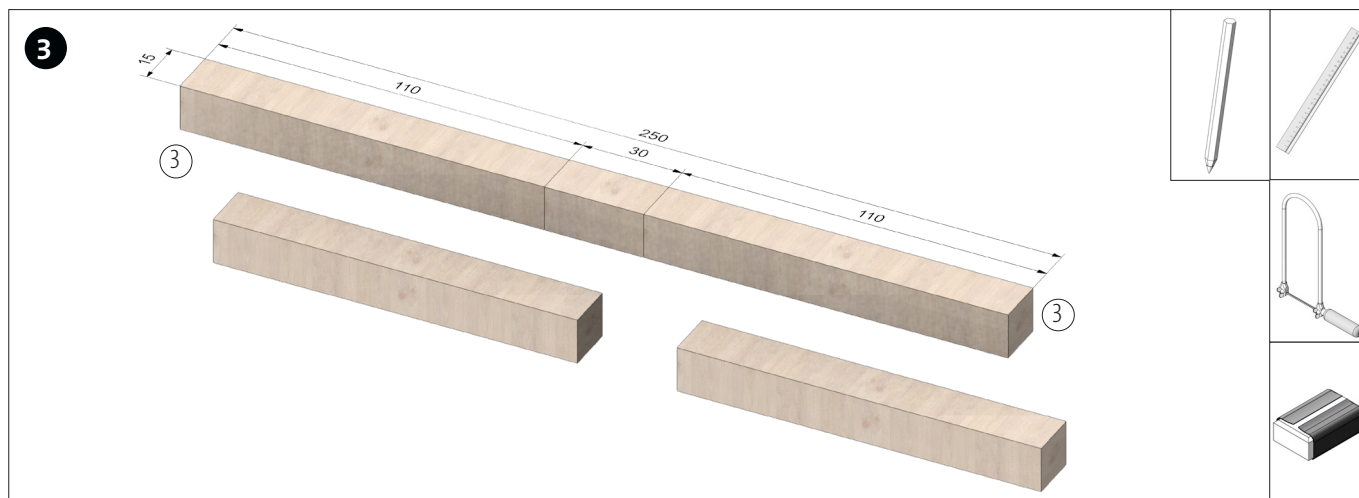

Cut the wooden strip (3) to length according to the dimensions and clean the saw cuts.

Building instruction 122.935
Mobile phone amplifier

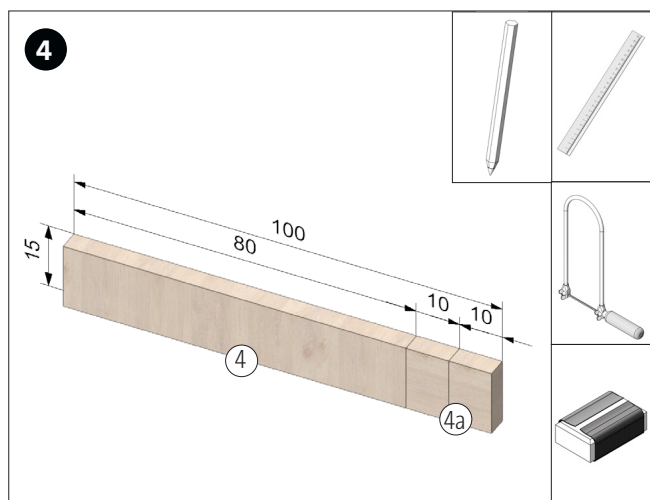

Cut the wooden strip (4) to length according to the dimensions and clean the saw cuts.

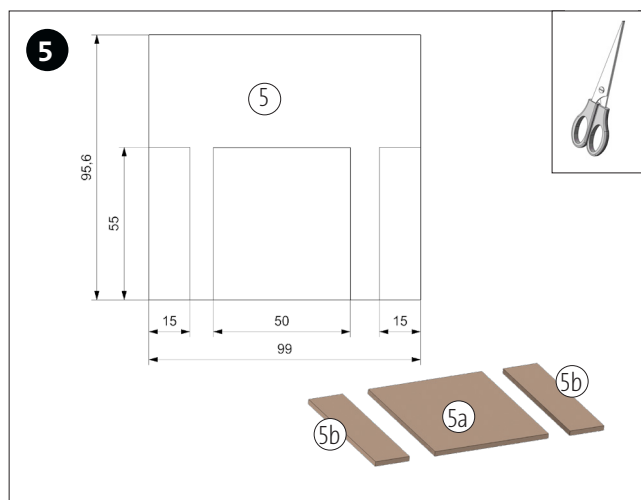

Transfer the template for the foam rubber (5-page...) to this and cut out.

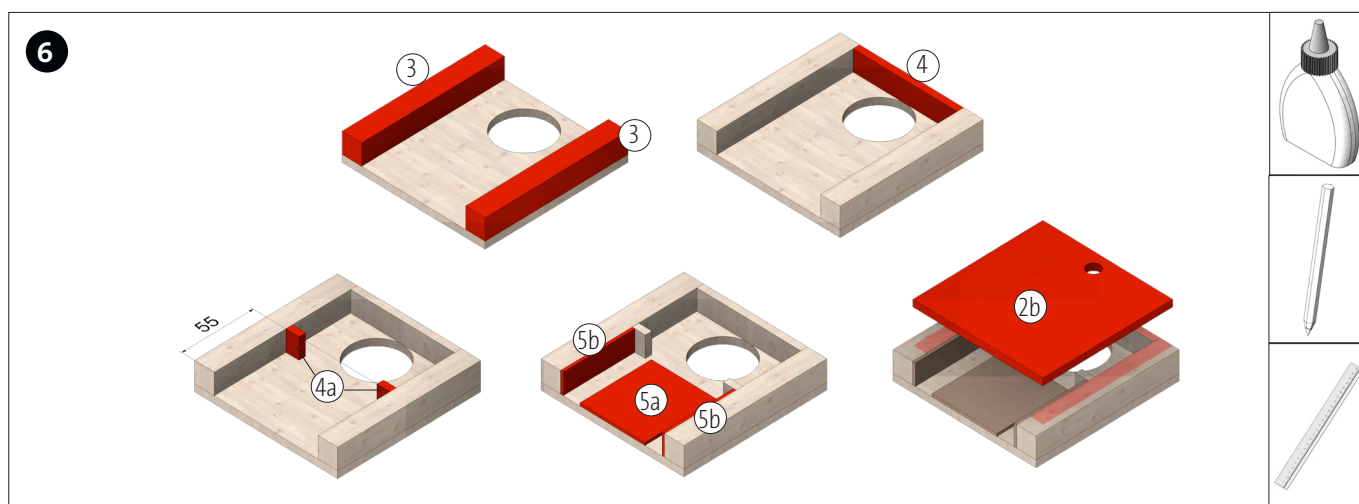

a) Glue the two wooden strips (3) onto the base plate (2a). b) Glue the strip (4) between the two strips (3) as shown. c) Glue the two strips (4a) into the frame as shown. d) Glue in the foam rubber sections (5a-5b) as well. e) Finally, center the rear cover and glue it flush to the rear edge.

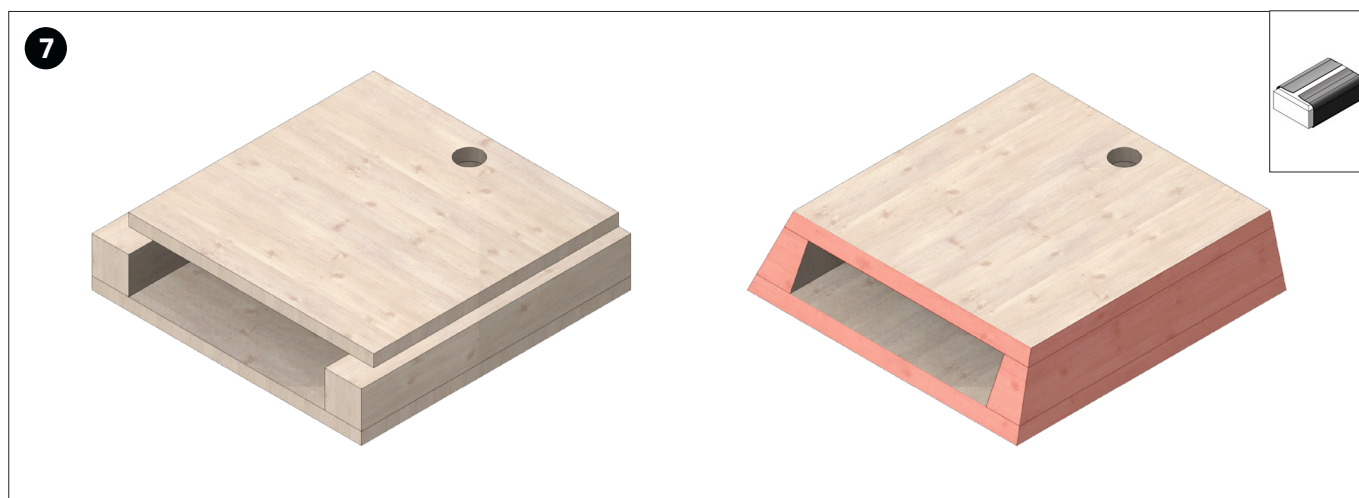

Finally, sand all sides flat from the bottom edge to the top edge as shown in the illustration.

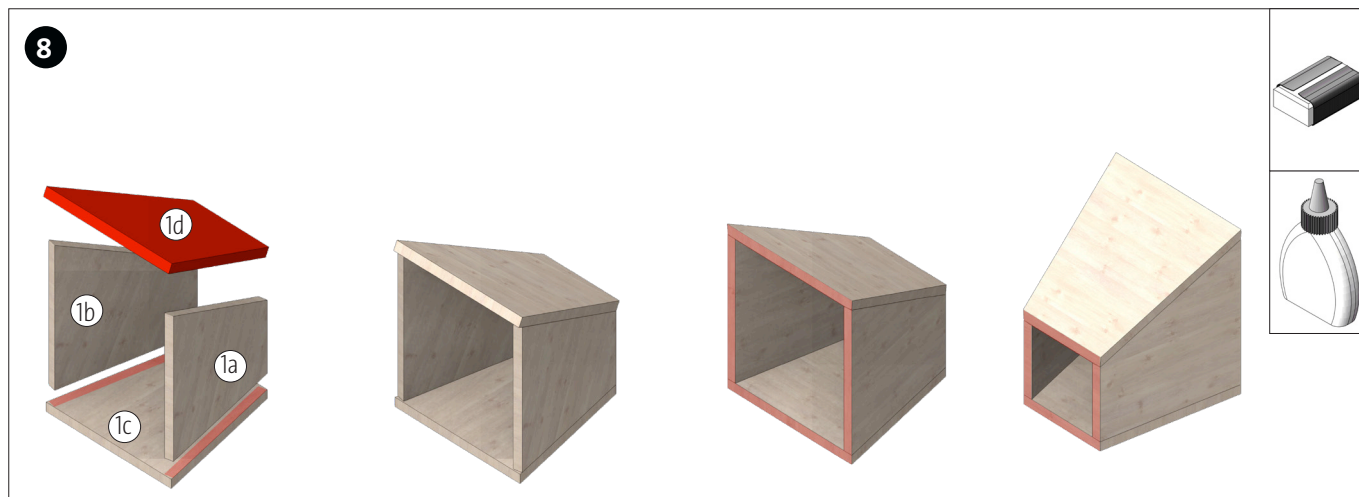

Glue the amplifier funnel parts (1a-1c) together as shown. Then sand the front edges and the rear edges flat.

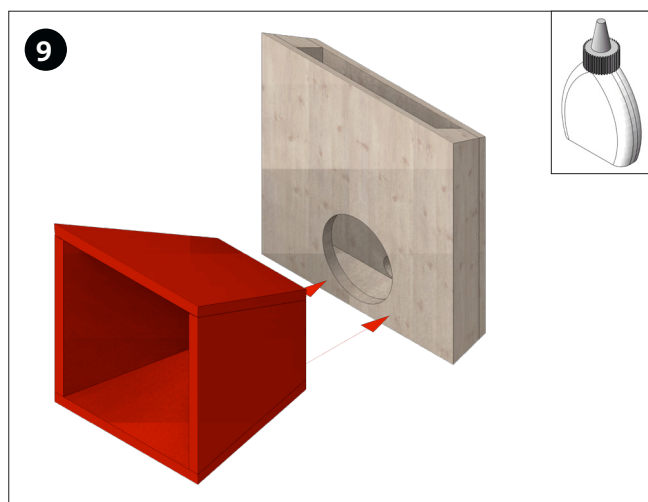

Glue the amplifier funnel, as shown, centered and flush with the lower edge so that it sits exactly over the $\varnothing 40\text{mm}$ opening.



Done! Start music on the cell phone and plug the cell phone into the amplifier.

M1:1

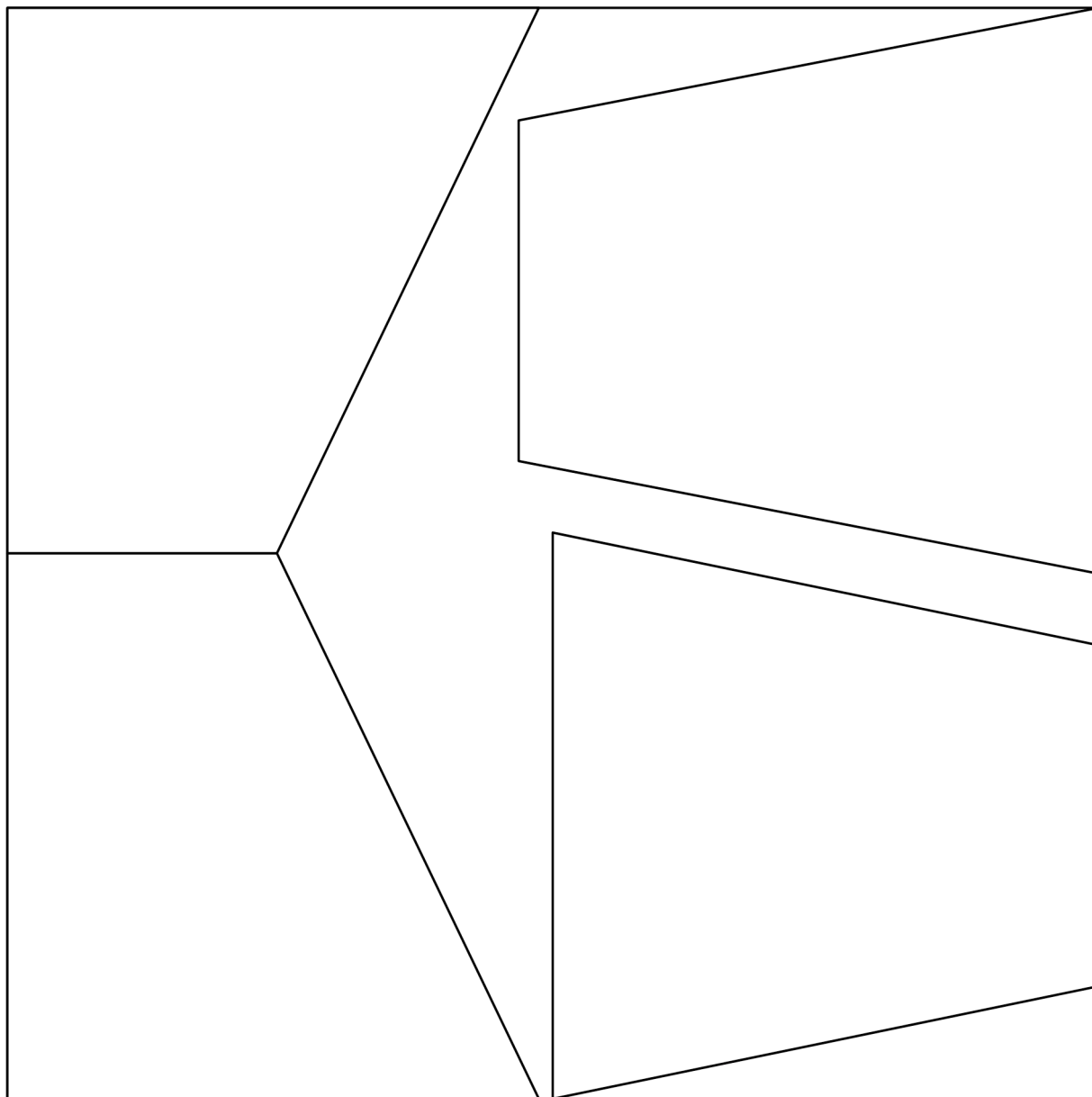

M 1:1

