

# OPITEC

## 1 0 0 . 2 6 1 Dice game

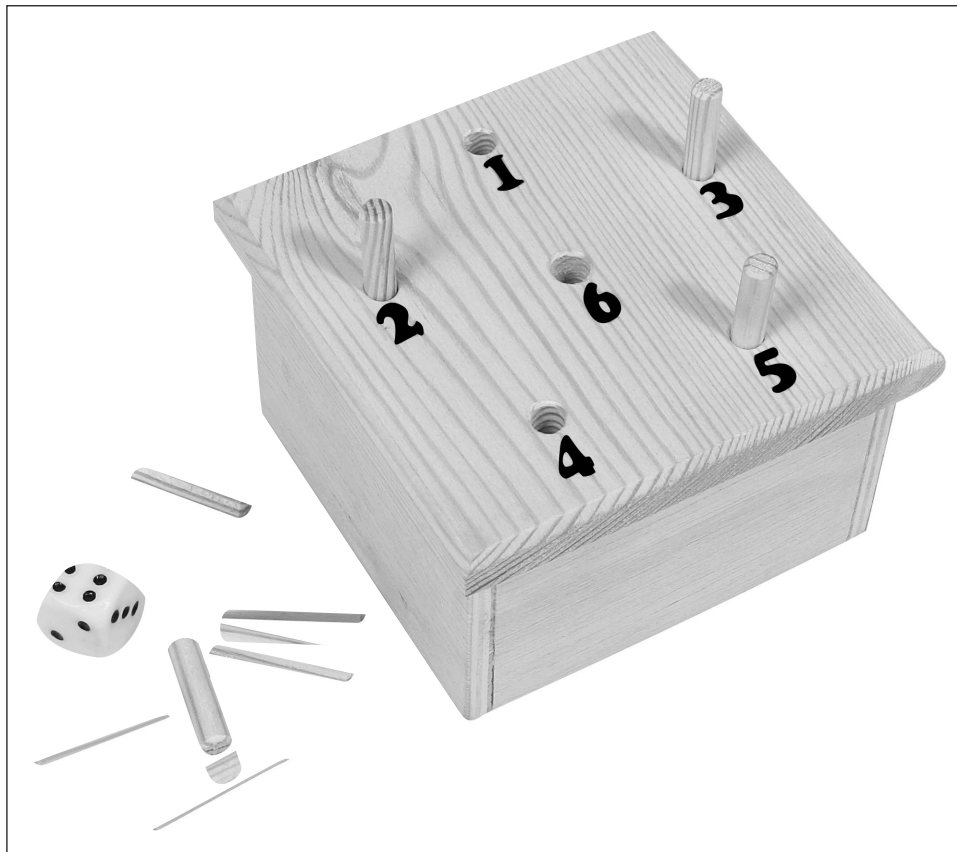

### **Parts list :**

- 1 x Pine strip 10/15 x 100 x 100mm
- 6 x Dowels 6dia x 250mm
- 2 x Plywood 4 x 80 x 80mm
- 2 x plywood 5 x 50 x 250mm
- 1 x dice

### **Necessary tools :**

- Pencil, ruler
- Try square
- Fretsaw, Dovetail type saw
- Drills 6 +7 mm dia
- Rasp, File, Glasspaper
- Wood glue

### **Please Note**

The OPITEC range of projects is not intended as play toys for young children. They are teaching aids for young people learning the skills of Craft, Design and Technology. These projects should only be undertaken and tested with the guidance of a fully qualified adult. The finished projects are not suitable to give to children under 3 years old. Some parts can be swallowed. Danger of suffocation!

## Production list :

1. Trace or measure the plan ( Page 3) on to the plywood 10/15 x 100 x 100mm and drill (6 and 7 mm diameter)

**Note:** Drill the holes in any pattern you wish.

2. Chamfer the edge 3mm deep.

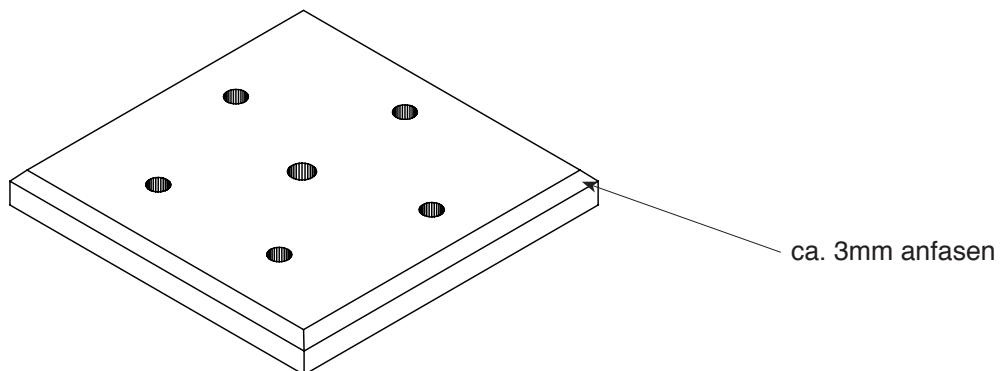

3. Glue the 4x 80 x 80mm plywood square centrally under the top.  
When dry enlarge the central hole to 7 mm dia.

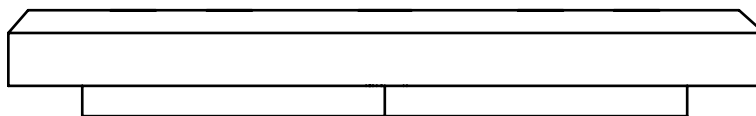

4. Mark out and saw from the plywood sheet 5 x 50 x 250mm, 2 pieces 90mm long and two 80mm long. Glue them in

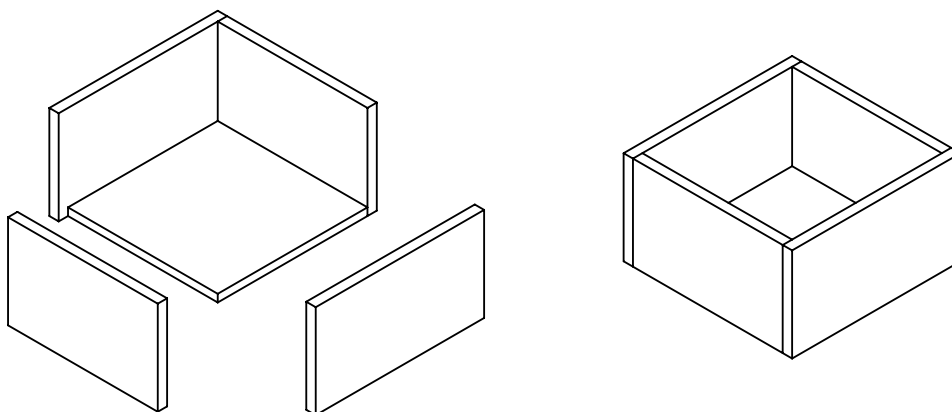

a box shape around the base 4 x 80 x 80mm.

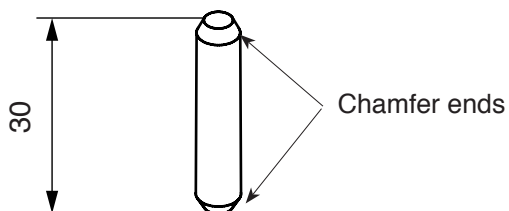

5. For 6 players 36 dowels are needed  
Mark out and saw 36 dowels x 30mm long and chamfer the ends

6. The decoration is left to you  
The holes should be numbered. The largest is  
number 6

7. The rules of the game are on page 4



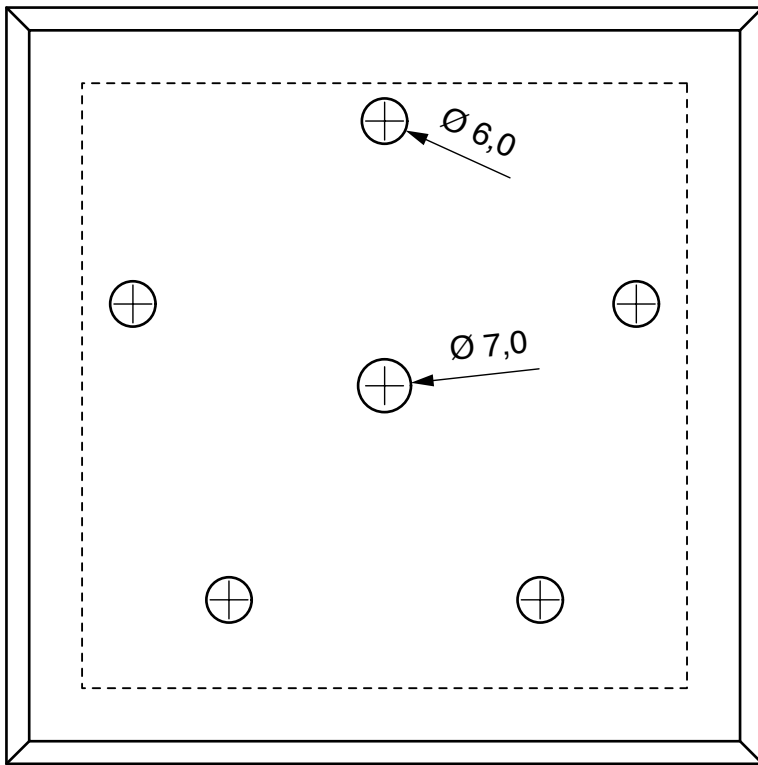

**Lid**

**M1:1**

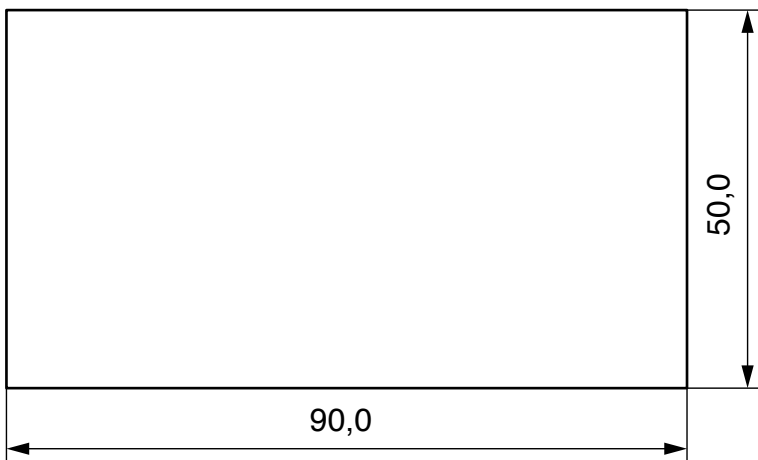

**Side pieces**

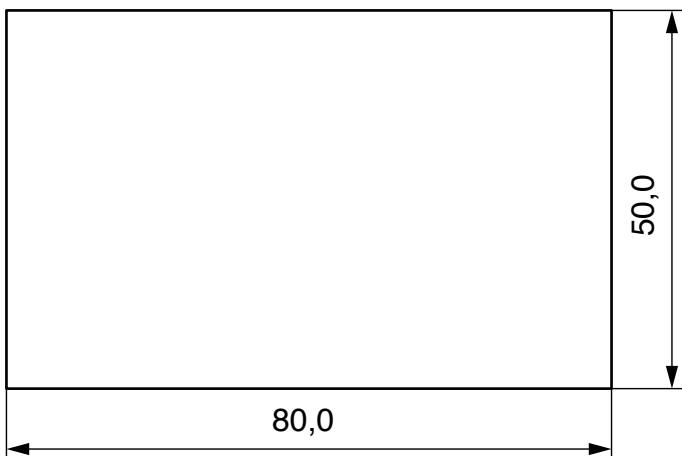

**M1:1**

### ***Rules of the game***

Dice game for 2-6 players

*Preparation:*

Each player receives 6 pegs (Dowels- If you want the game to last longer, use more pegs)

*Aim:*

The first one to get rid of all their pegs ( Dowels) is the winner

Each player takes it in turn to throw the dice, and must insert a peg in the appropriate holes. "1 to 5" the pegs will remain. In the middle hole the pegs will fall through

If a player throws a number that has a peg already in place, all the pegs have to be removed

Each player must only throw once

If a player has 3 or less dowels he must wait try to "loose" all his pegs in one go