

126.559

# OPITEC marble fun



## Tools required:



Silhouette scissors

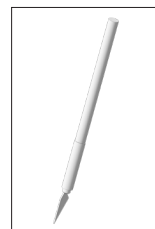

Craft knife



All-purpose glue

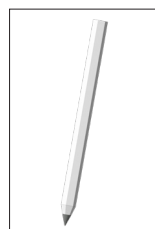

Pencil

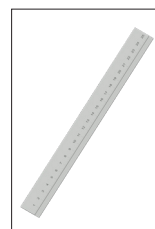

Ruler

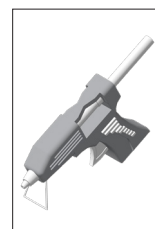

Hot glue gun



Circle



Brush &amp; colour

### NOTE:

Once completed, the OPITEC work kits are not articles with the character of toys of a generally commercially available type, but teaching and learning aids to support educational work. This kit may only be built and operated by children and young people under the guidance and supervision of a competent adult. Not suitable for children under 36 months. Choking hazard!

Parts list	Quantity	Dimensions (mm)	Designation	Part no.
Lantern cover	2	ø153	Box lid	1
Lantern base	2	ø153	Box bottom	2
Wooden ball	1	ø20	Ball	3

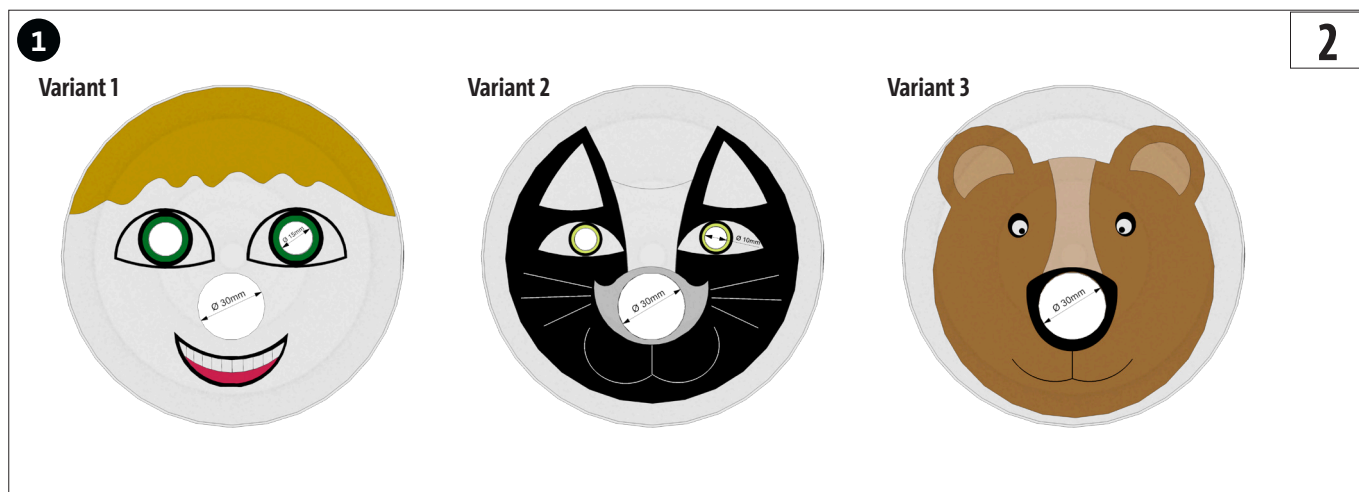

Transfer a template (different variants 1-3) or a motif of your choice to the inside of a lantern base.



Cut out the holes with a craft knife or silhouette scissors.

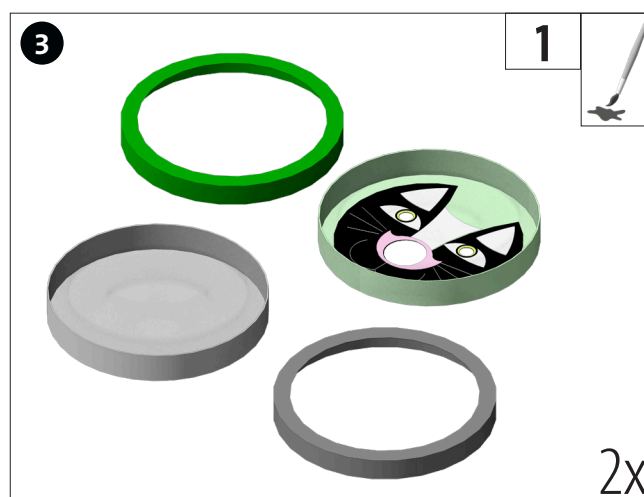

Then colour the lantern lid (1) and base (2) as desired and leave to dry.

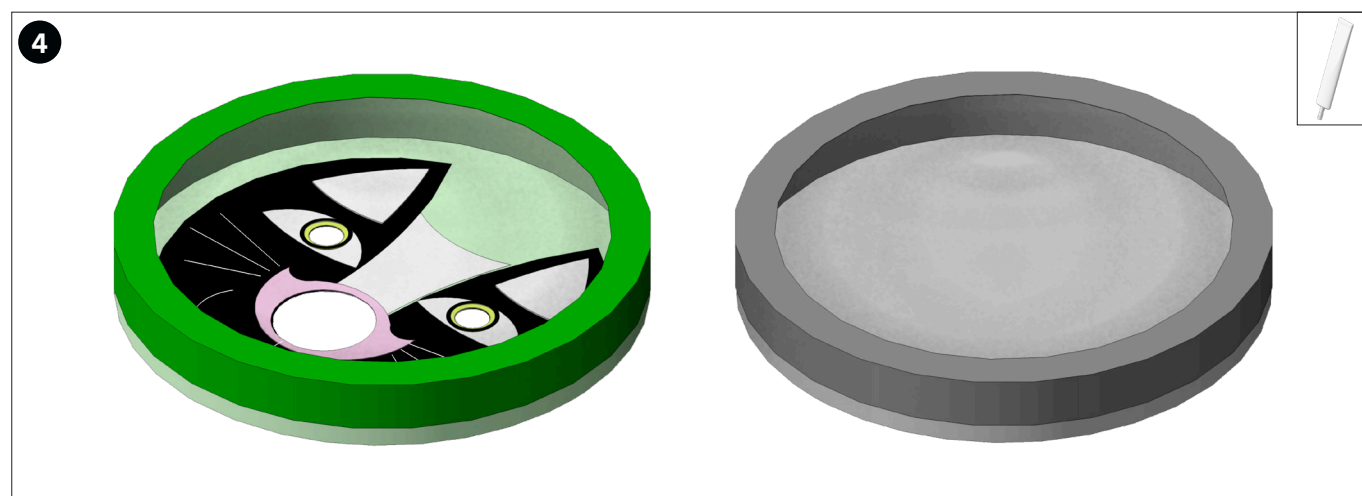

Glue the painted lantern lids (1) onto the lantern base (2) as shown and leave to dry.

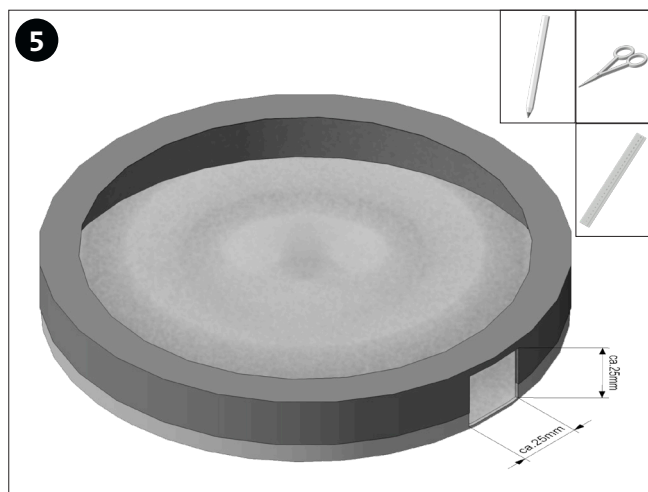

Mark an opening (approx. 25x25mm) on the outside of the finished box without the motif and cut it out with silhouette scissors.

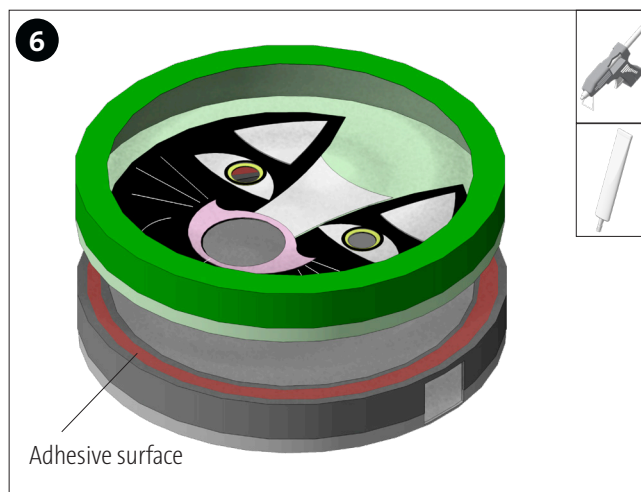

Glue the two finished boxes together with hot glue or all-purpose glue as shown and leave to dry.

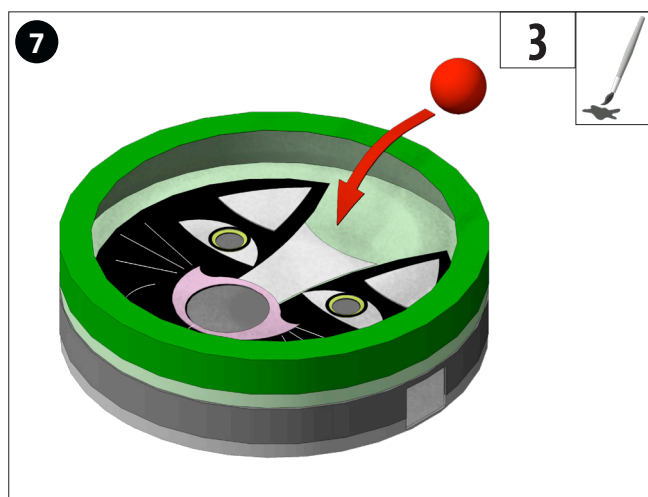

Paint the wooden ball (3) in any colour you like and place it in the top box. Now the marble fun can begin.

**Instructions:** By tilting in different directions, the ball is transported through the upper hole into the lower box and should then fall out again through the exit hole.





