

126272

Smartphone holder "Sunny"

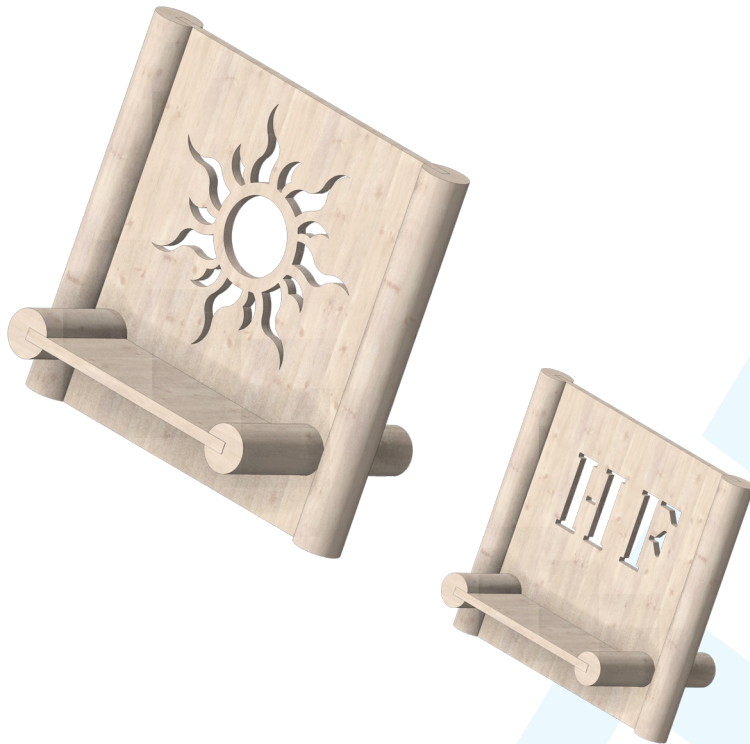

Tools Needed:

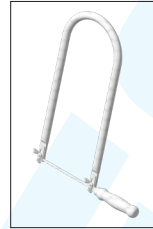

jigsaw

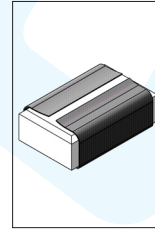

abrasive paper

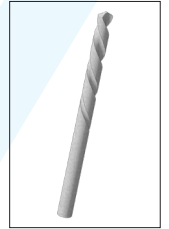

drill

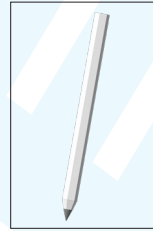

pencil

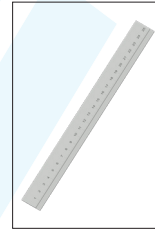

ruler



wood glue

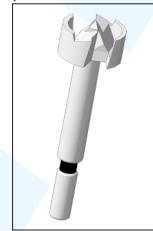

Forstner drill

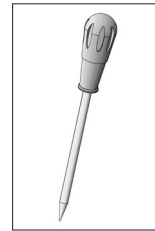

pricker



scissors

Please note:

After completion, the OPITEC factory packs are not toys that are generally commercially available, but teaching and learning materials to support educational work. This kit may only be built and operated by children and young people under the guidance and supervision of knowledgeable adults. Not suitable for children under 36 months. Danger of suffocation!

parts list	quantity	Dimensions (mm)	Description	Part No.:
plywood	1	300x210x5	Base plate	1
Wooden round rod with groove	4	ø20x160	round bar	2

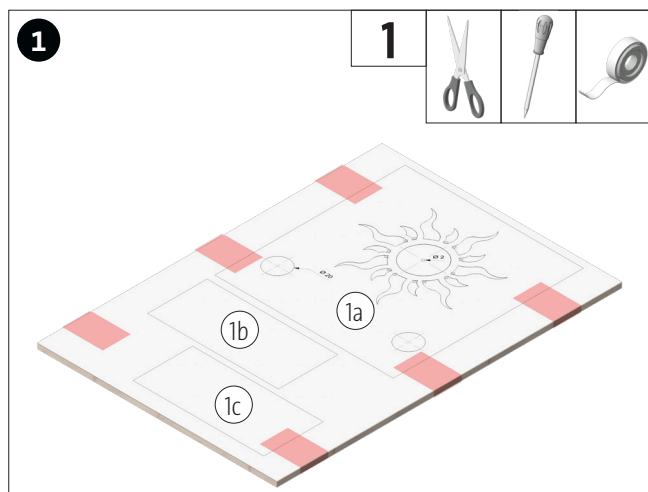

Transfer the template (page 3) to the plywood board (1). Pre-drill holes and drill holes for the jigsaw blade (\varnothing 2mm). If desired, the sun motif can be replaced with initials (pages 5/7).

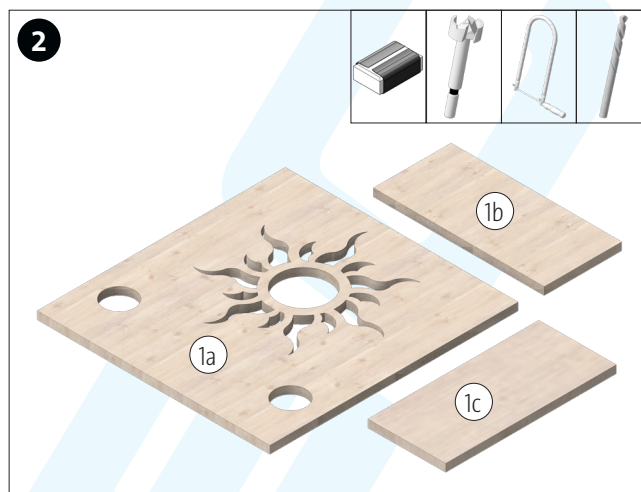

Drill all holes and saw out the motif. Then saw out the 3 individual parts (1a, 1b, 1c) as shown and clean the saw cuts.

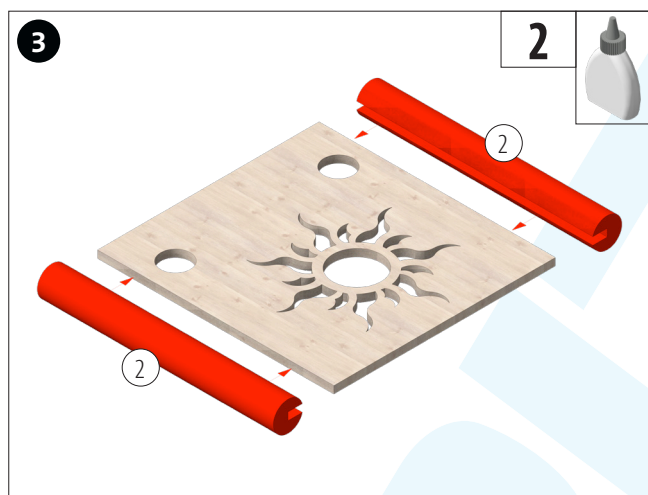

Place two round rods with groove (2) on the outer edges and glue them.

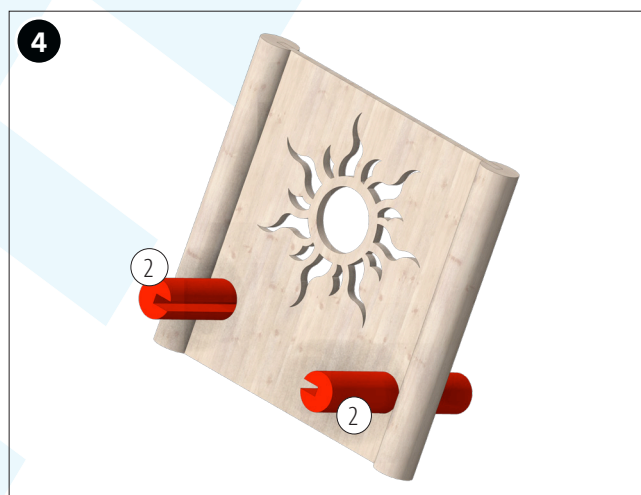

Insert the two remaining rods into the holes in the base plate (1a) so that the groove faces inwards. See illustration

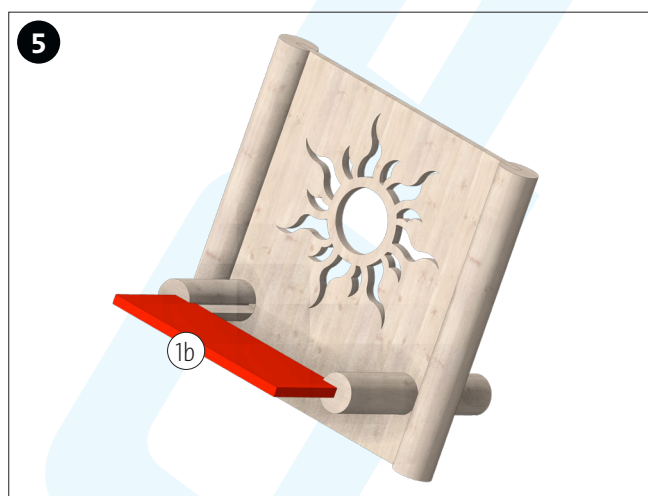

Insert the plate (1b) into the front as shown.

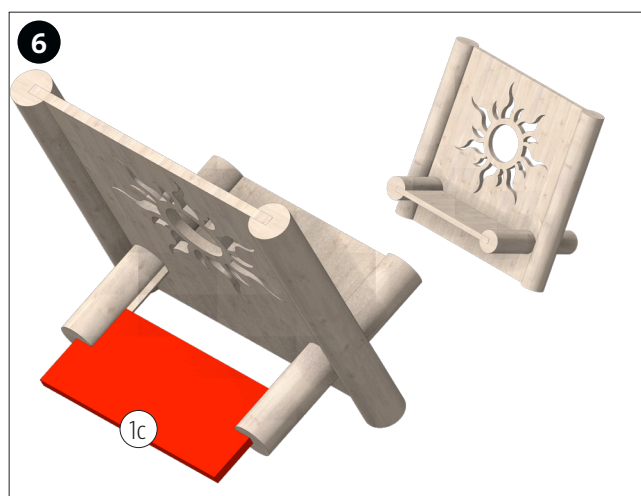

Insert the rear wooden plate (1c) into the back as shown.
Done!

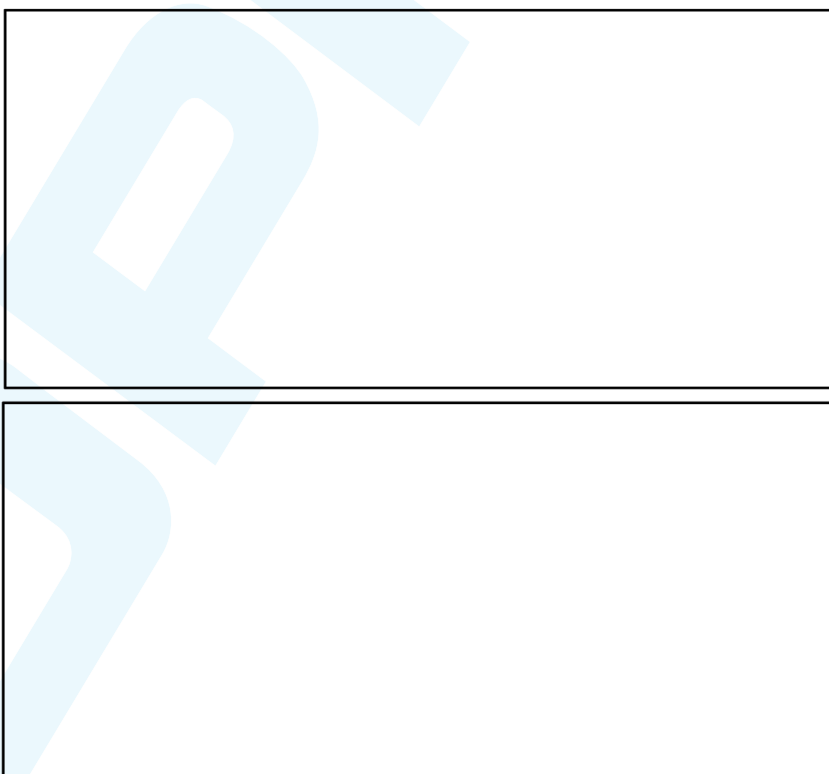
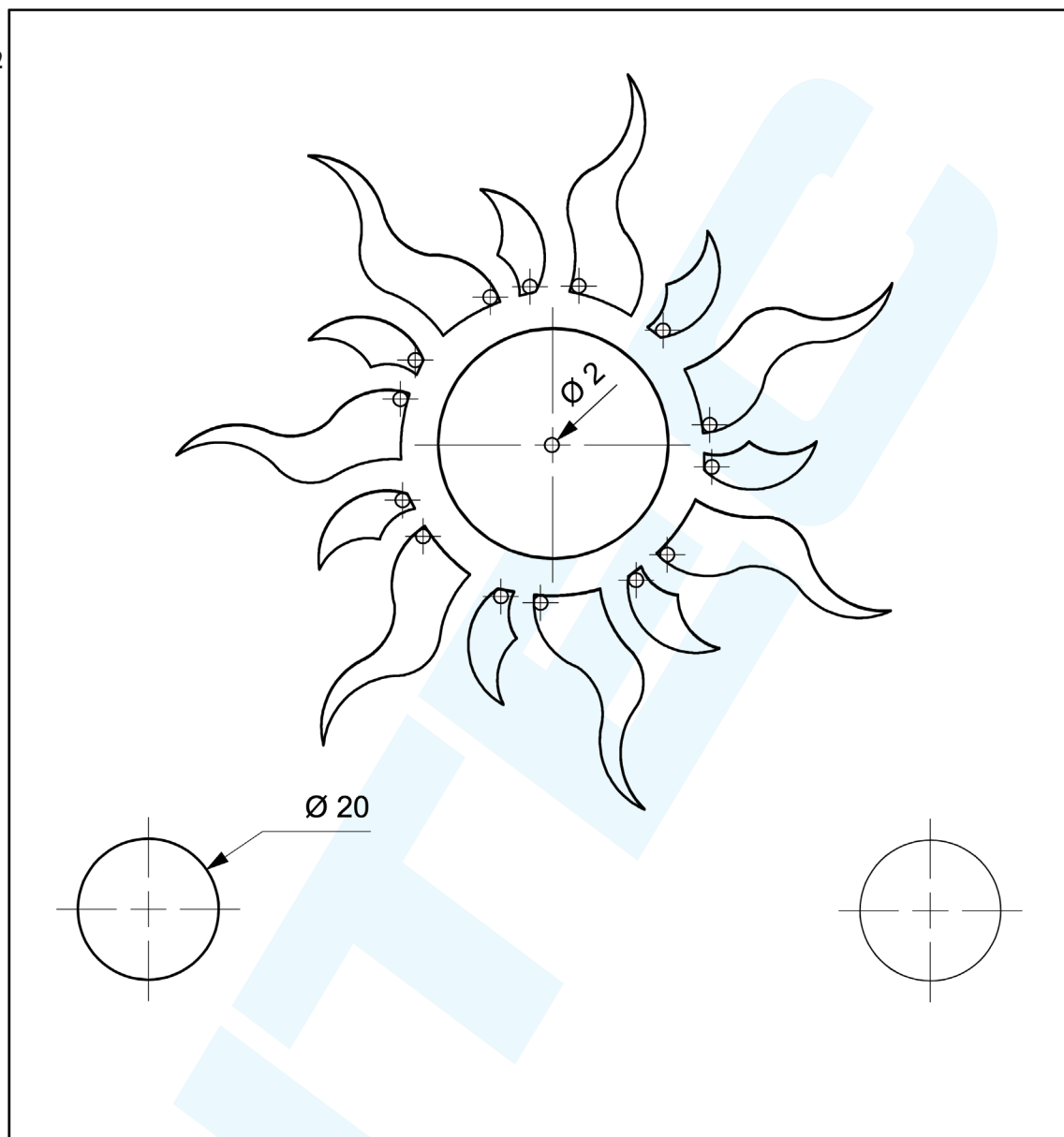



A

B

C

D

E

F

G

H

I

J

K

L



M N O P

Q R S T

U V W

X Y Z