

122256

# Wiggling Animals

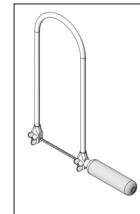

## Required Tools:



Fretsaw

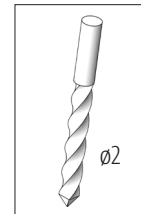

Drill

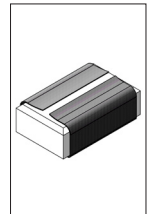

Sandpaper

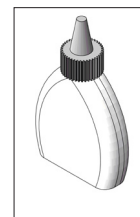

Wood Glue

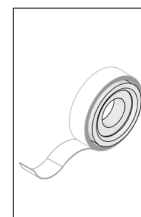

Adhesive Tape

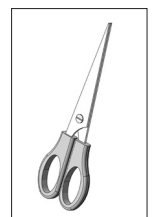

Scissors

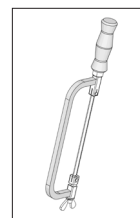

PUK Saw

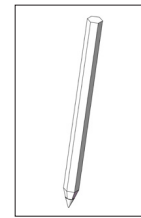

Pencil

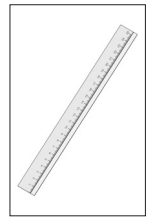

Ruler

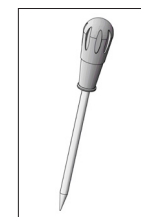

Pricking Awl

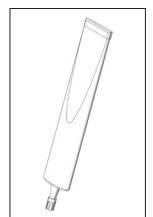

Superglue

### Please Note

The OPITEC handcraft packs are not toys in a typical off-the-shelf sense, but rather additional teaching and learning material for educational purposes. This craft pack may only be constructed by children and adolescents under the guidance and supervision of experienced adults. Not suitable for children under 36 months. Danger of suffocation!

Parts List	Quantity	Size (mm)	Description	Part No.:
Plywood	1	300x210x4	Base Plate	1
Screw Hooks	1	15	Screw Hooks	2
Ring Screw	1	10	Ring Screw	3
Wiggly Eyes selfadhesive	1	10	Eyes	4
Perforated Plate	1	120x15x1,5	Weights	5
Foam Rubber	1	9,60x9,90	Ears/Legs	6

Instructions 122.256  
Wiggling Animals  
Construction Variant 1 Dog:

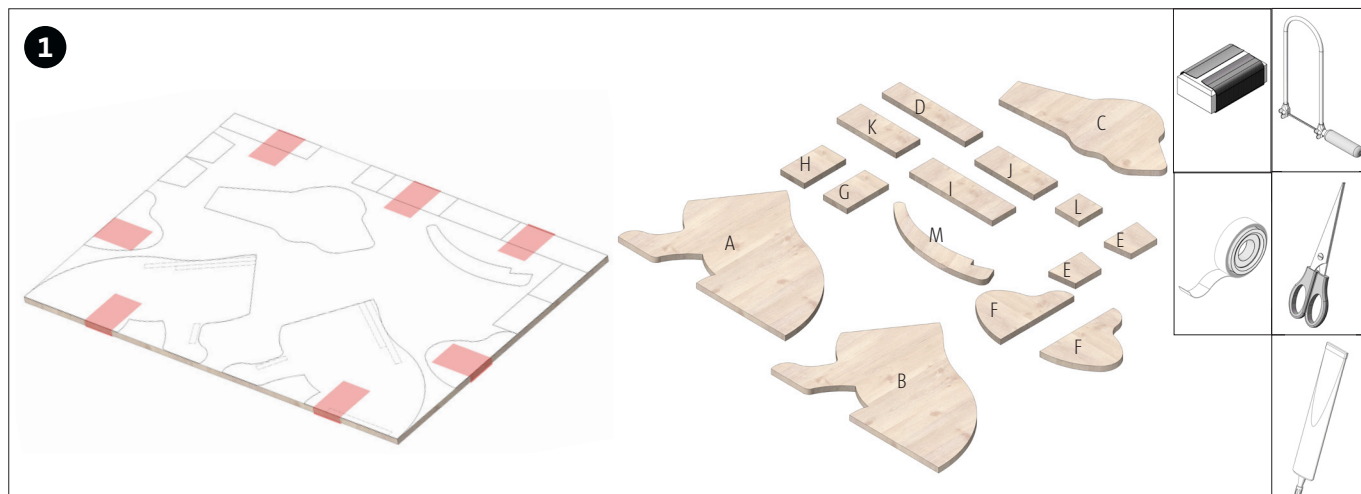

Cut out the template for the dog (page 11/13) and glue it on the adhesive surface. Then fix it with adhesive tape on the plywood panel. Saw out the single parts and clean all the saw cuts with sandpaper. Mark the position for the spacer bars on the side panels.

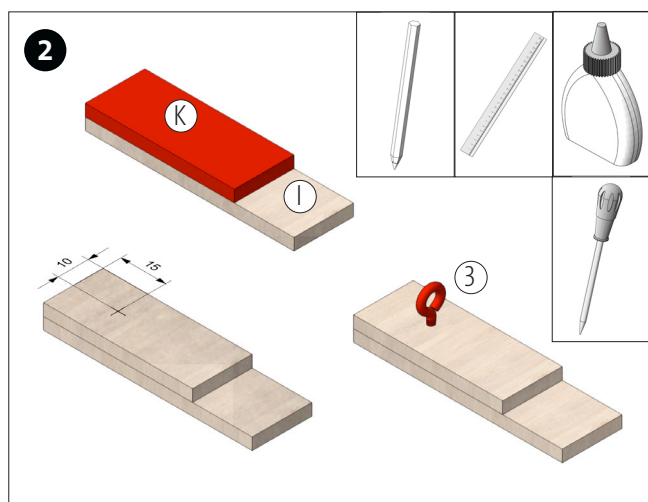

Glue the two wooden bars (I+K) together as shown. Measure the position for the ring screw (3), mark with a prick and screw in the ring screw.

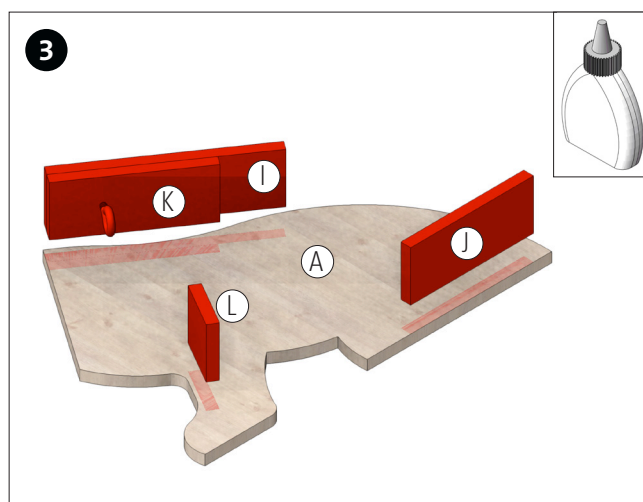

Then glue the bars created in step 2 to the side part (A) at the marked position as shown. Glue on the two bars (L+I) as well.

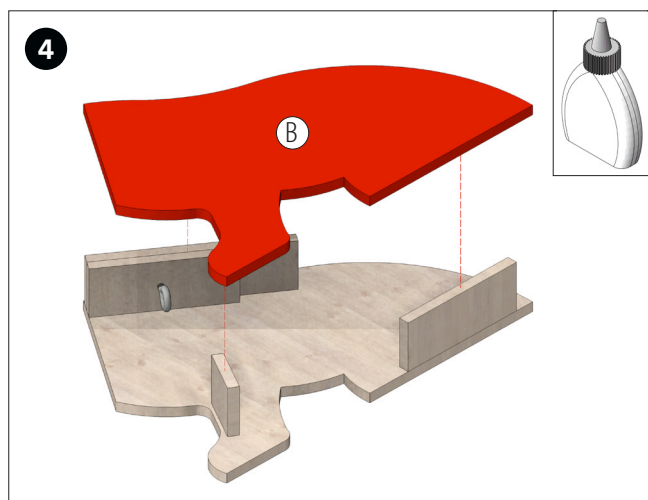

Glue the second side part (B) congruent to part (A) as shown. Let the glue dry well.

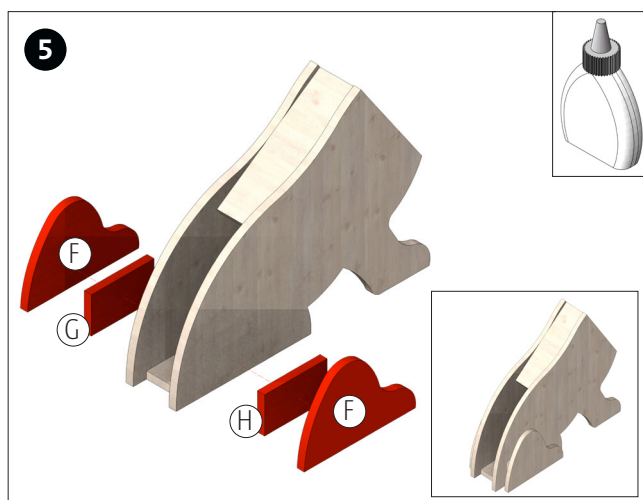

Glue the two parts (G+H) and the rear legs (F) flush to the lower edge of the two side parts as shown.

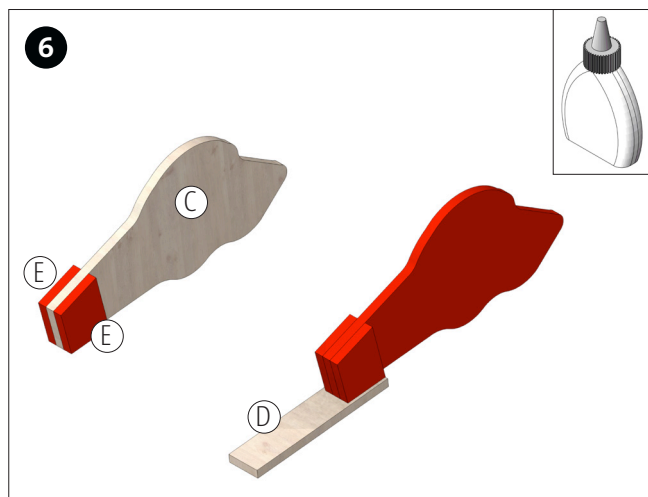

Glue the wooden parts (E) for the reinforcement of the head on both sides of the part (C) flush with the lower and rear edge. Then glue the finished head flush to the front edge on part D.

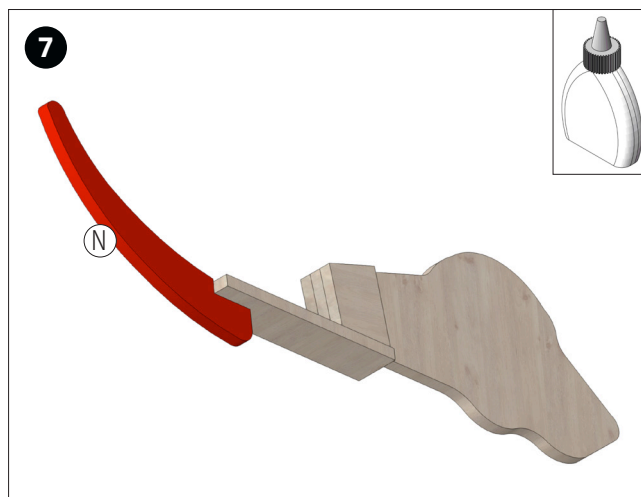

Glue the tail (N) centred to the lower edge of part (D) as shown. Let the glue dry well.

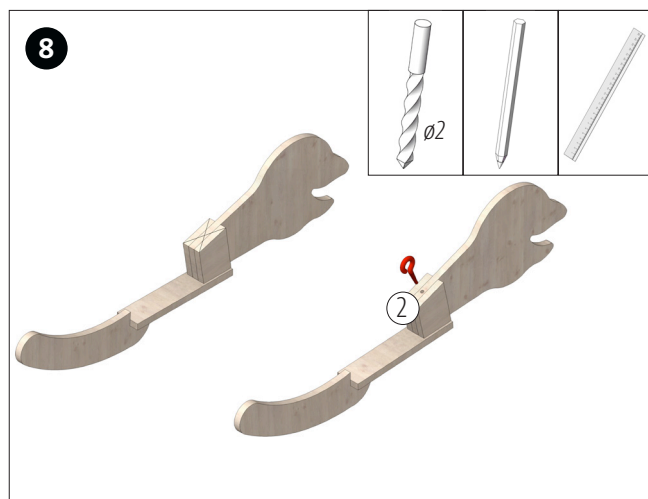

Mark the position for the screw hooks (2) through the diagonal on the top of the head reinforcement. Pre-drill with a Ø2mm drill to prevent the wood from tearing. Then screw in the screw hook.

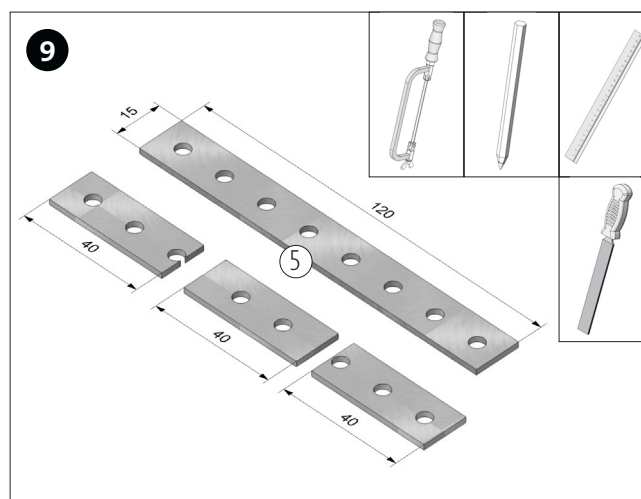

Divide the perforated plate into 3 equal pieces (40 mm each) as shown. Deburr saw cuts.

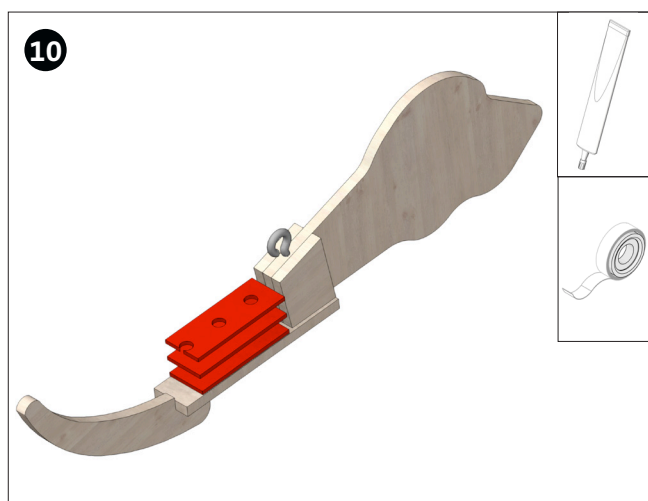

First stick the weights on with adhesive tape as shown. Then hang the head part in the animal body to check the balance. If it is not balanced, reduce the weights. Then glue on with super glue.

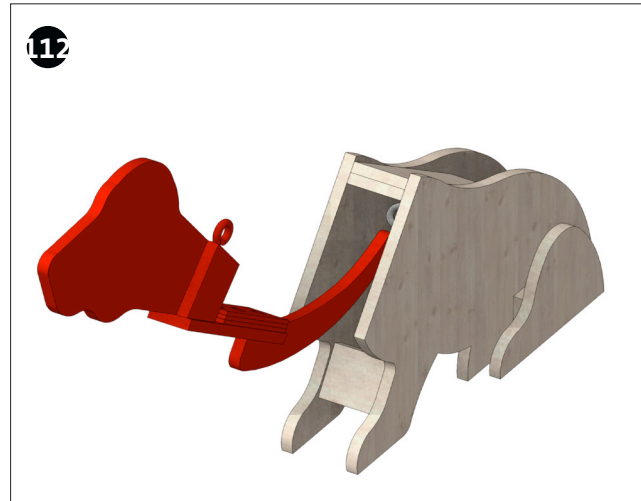

Hang the finished head in the animal body.

Instructions 122.256  
Wiggling Animals

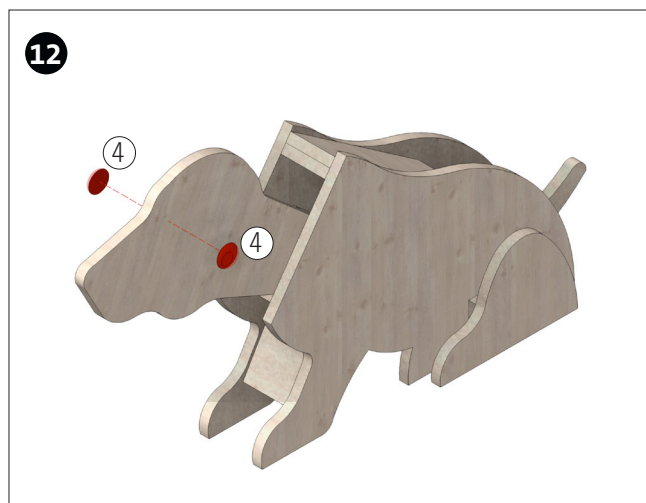

Glue the wiggle eyes (4) on both sides of the head. (Self-adhesive! Peel off the protective film!)



Done!

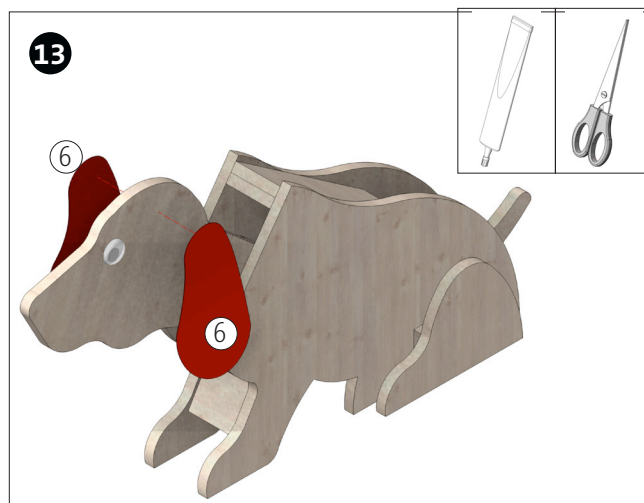

Transfer the ears from the template (page 11) to the foam rubber (6). Then glue on both sides with super glue.

Construction Variant 2 Cat:

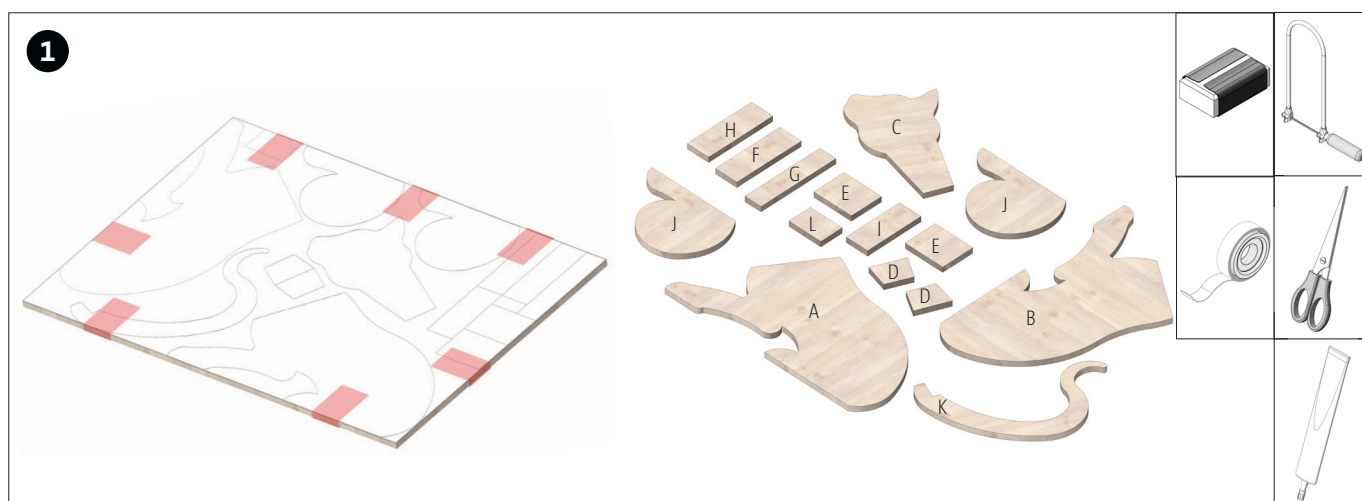

Cut out the template for the cat (page 15/17) and glue it on the adhesive surface. Then fix it with adhesive tape on the plywood panel. Saw out the single parts and clean all the saw cuts with sandpaper. Mark the position for the spacer bars on the side panels.



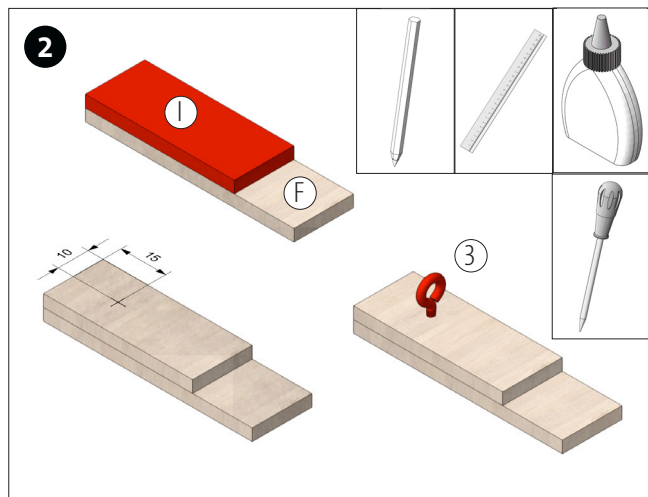

Glue the two wooden bars (F+I) together as shown. Measure the position for the ring screw (3), mark with a prick and screw in the ring screw.

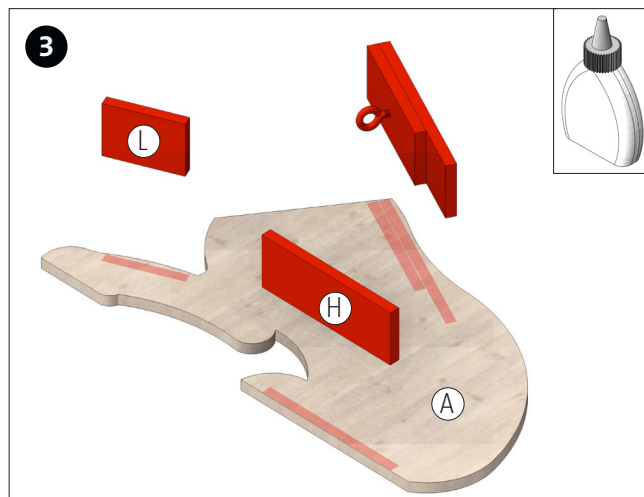

Then glue the bars created in step 2 to the side part (A) at the marked position as shown. Glue on the two bars (H+L) as well.

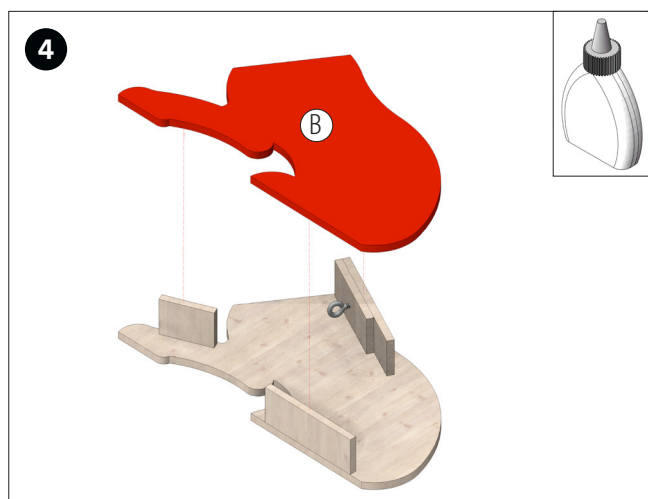

Glue the second side part (B) congruent to part (A) as shown. Let the glue dry well.

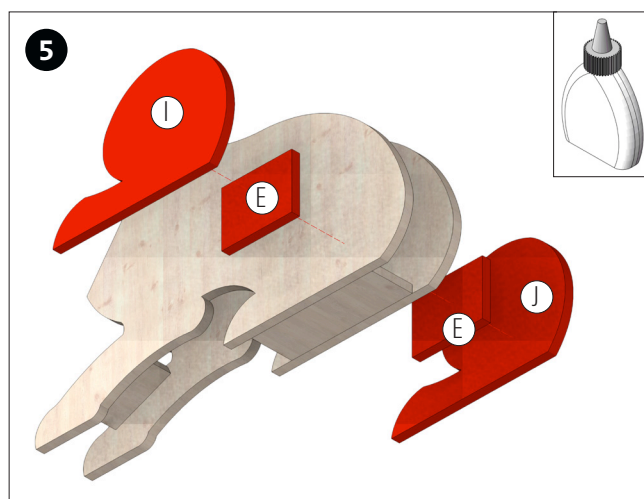

Glue the two parts (E) and the rear legs (I+J) flush with the lower edge as shown.

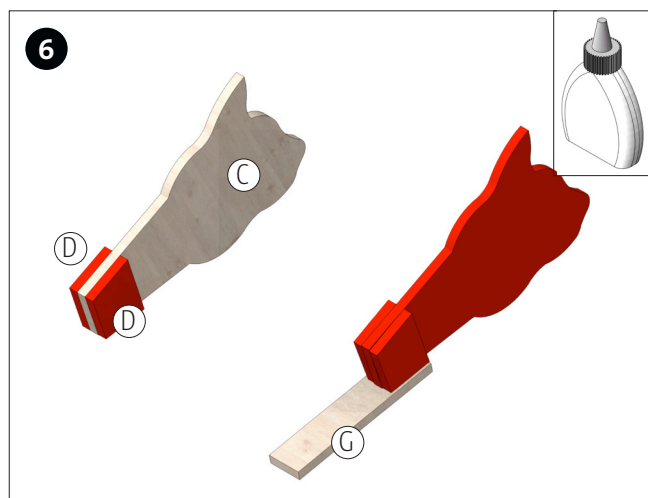

Glue the two parts (D) from both sides flush with the rear edge of the head (C) as shown. Then glue the head onto part (G) as shown.

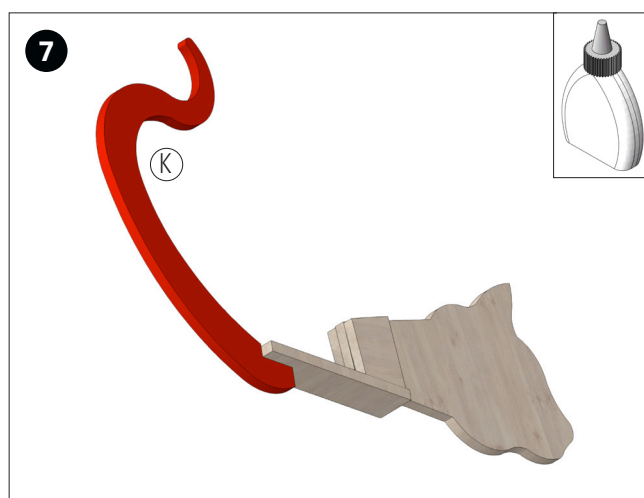

Glue the tail (K) centred to the lower edge of part (D) as shown. Let the glue dry well.

Instructions 122.256  
Wiggling Animals

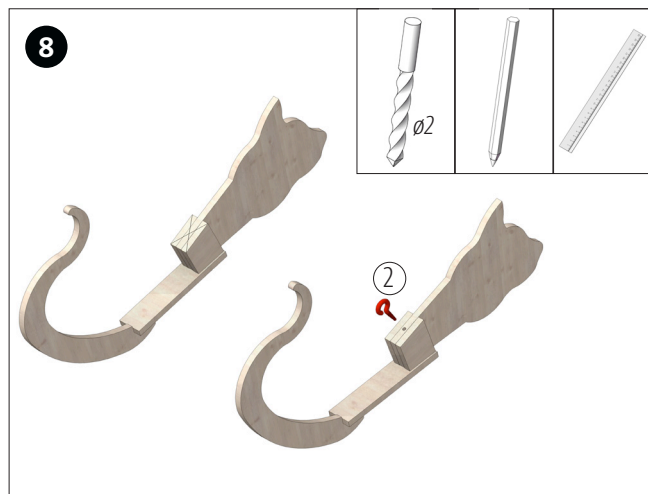

Mark the position for the screw hooks (2) through the diagonal on the top of the head reinforcement. Pre-drill with a Ø2mm drill to prevent the wood from tearing. Then screw in the screw hook.



Hang the finished head in the animal body.

**Note:** the cat is balanced by the mass of the wood. Therefore no weight is required. If it should be necessary to add weight, then cut and attach the perforated plate as in step 9 (dog).



Glue the eyes (4) on both sides of the head. (Self-adhesive! Peel off the protective film!)



Transfer the template for the ears to the foam rubber (6), cut it out and glue it to the head on both sides. Further decoration can be cut out and attached at will.



Done!

Construction Variant 3 Turtle:

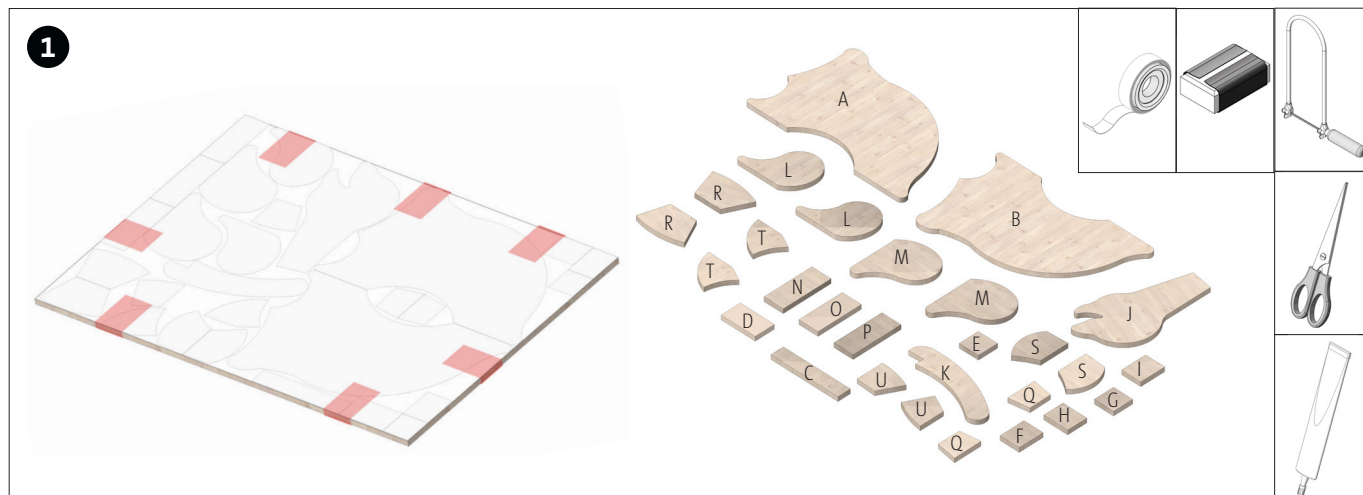

Cut out the template for the turtle (page 19/21) and glue it on the adhesive surface. Then fix it with adhesive tape on the plywood panel. Saw out the single parts and clean all the saw cuts with sandpaper. Mark the position for the spacer bars on the side panels.

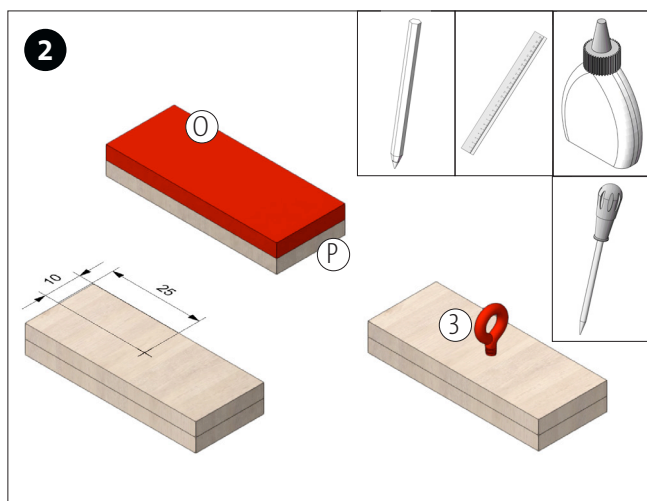

Glue the two wooden bars (O+P) together as shown. Measure the position for the ring screw (3), mark with a prick and screw in the ring screw.

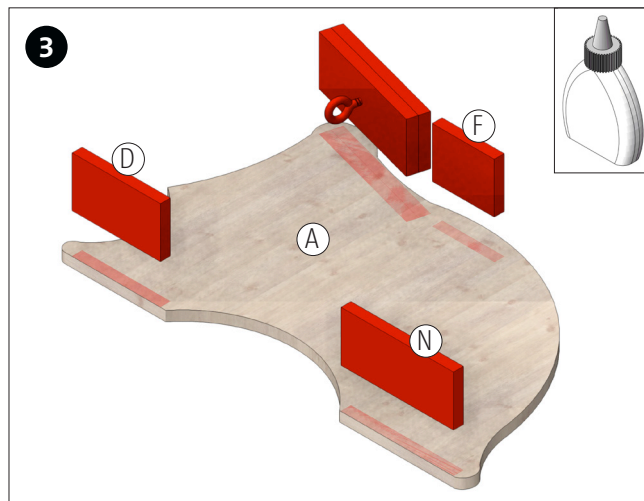

Then glue the bars created in step 2 to the side part (A) at the marked position as shown. Glue on the two bars (F, D+N) as well.

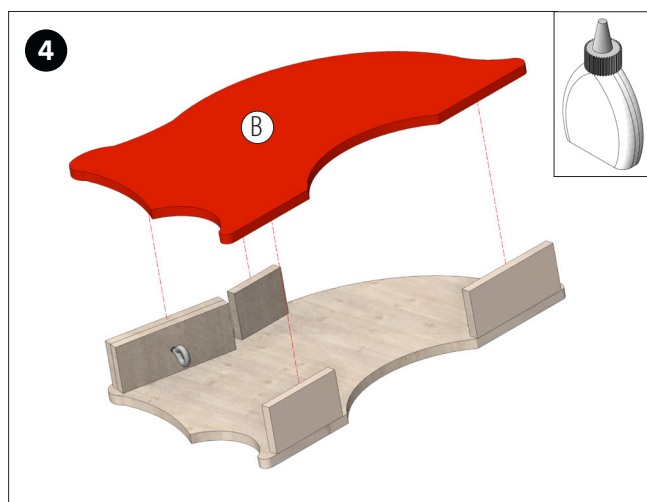

Glue the second side part (B) congruent to part (A) as shown. Let the glue dry well.

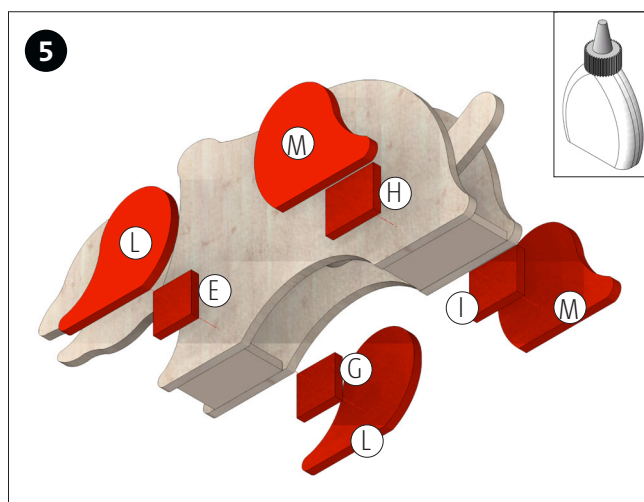

Glue the parts (H + I) with the rear legs (M) flush with the lower edge on both sides of the animal body. Fasten the parts (E + G) with the front legs. See picture!

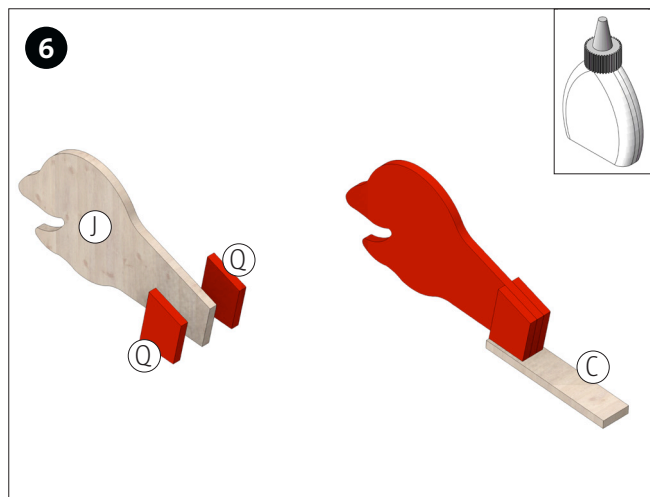

Glue the wooden parts (Q) for the reinforcement of the head on both sides of the part (J) flush with the lower and rear edge. Then glue the finished head flush to the front edge on part C.

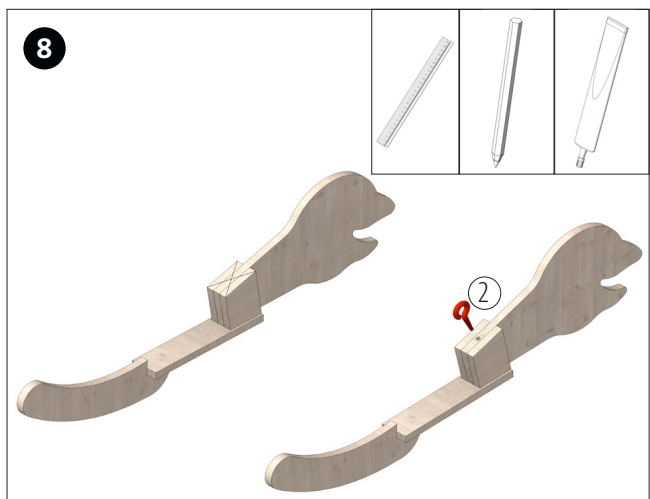

Mark the position for the screw hooks (2) through the diagonal on the top of the head reinforcement. Pre-drill with a  $\varnothing 2$ mm drill to prevent the wood from tearing. Then screw in the screw hook.

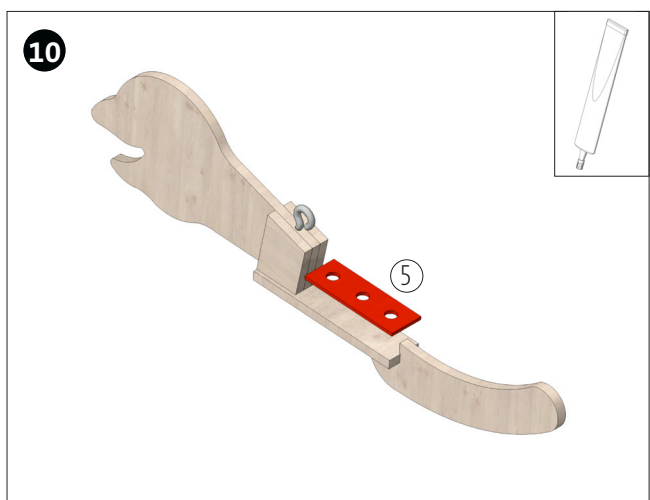

For the balance of the head in the body, only one weight is sufficient. Glue this on with super glue as shown. If the animal is not balanced, then add a second weight.

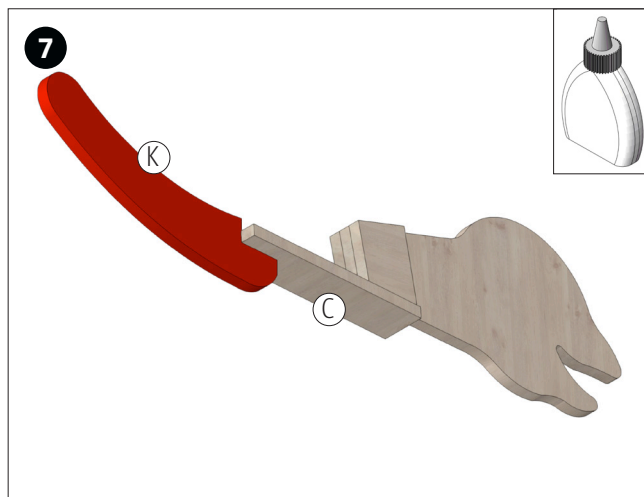

Glue the tail (K) centred to the lower edge of part (C) as shown. Let the glue dry well.

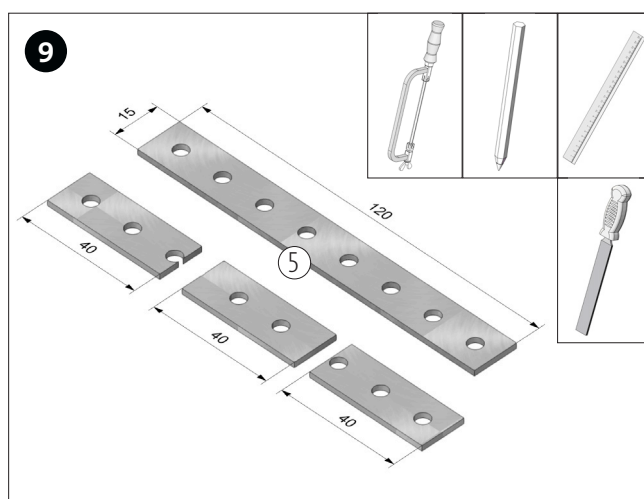

Divide the perforated plate into 3 equal pieces (40 mm each) as shown. Deburr saw cuts.

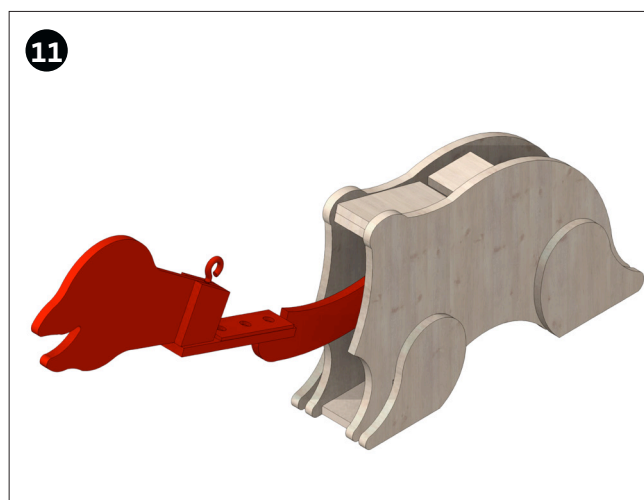

Hang the finished head in the animal body.



Instructions 122.256  
Wiggling Animals

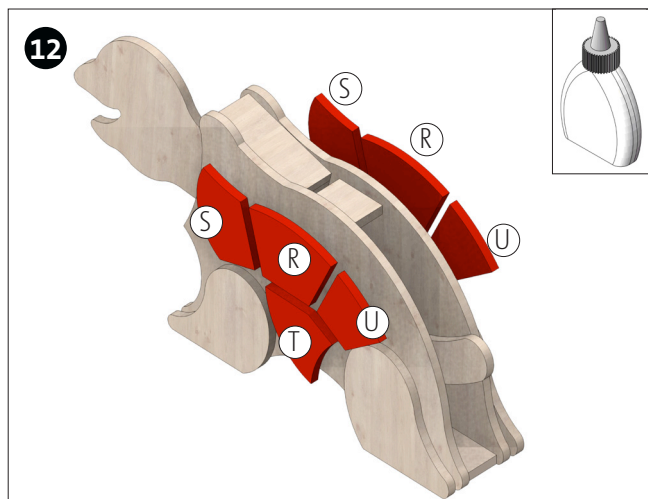

Glue the turtle shell (R-U) on both sides as shown above.

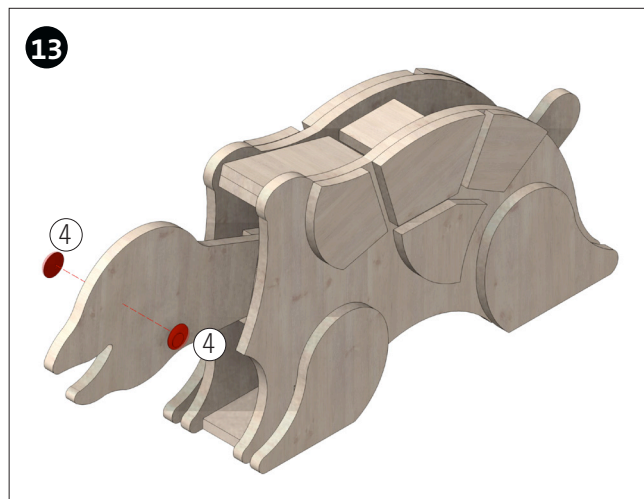

Glue the eyes (4) on both sides of the head. (Selfadhesive! Peel off the protective film!)

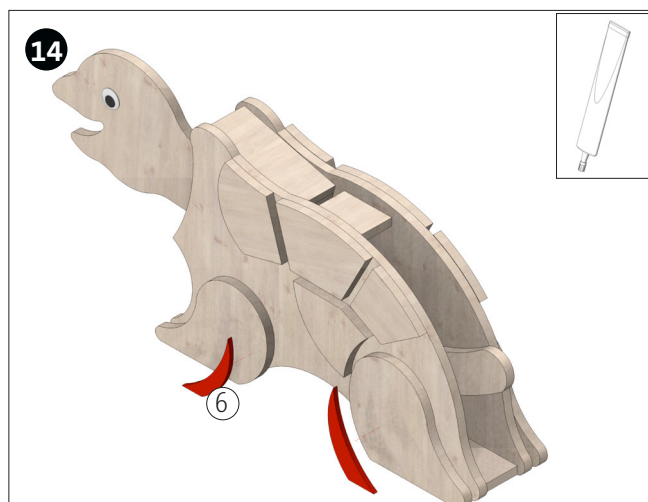

Transfer the template for the leg decoration on the foam rubber (6) and cut out. Then glue on both sides as shown.

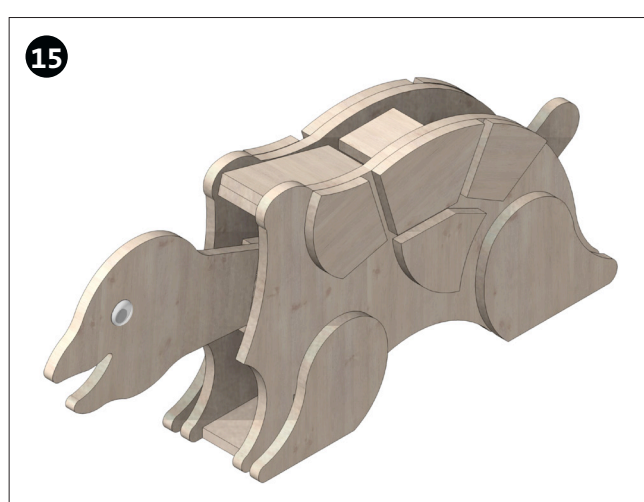

Done!



Template Dog  
Scale 1:1

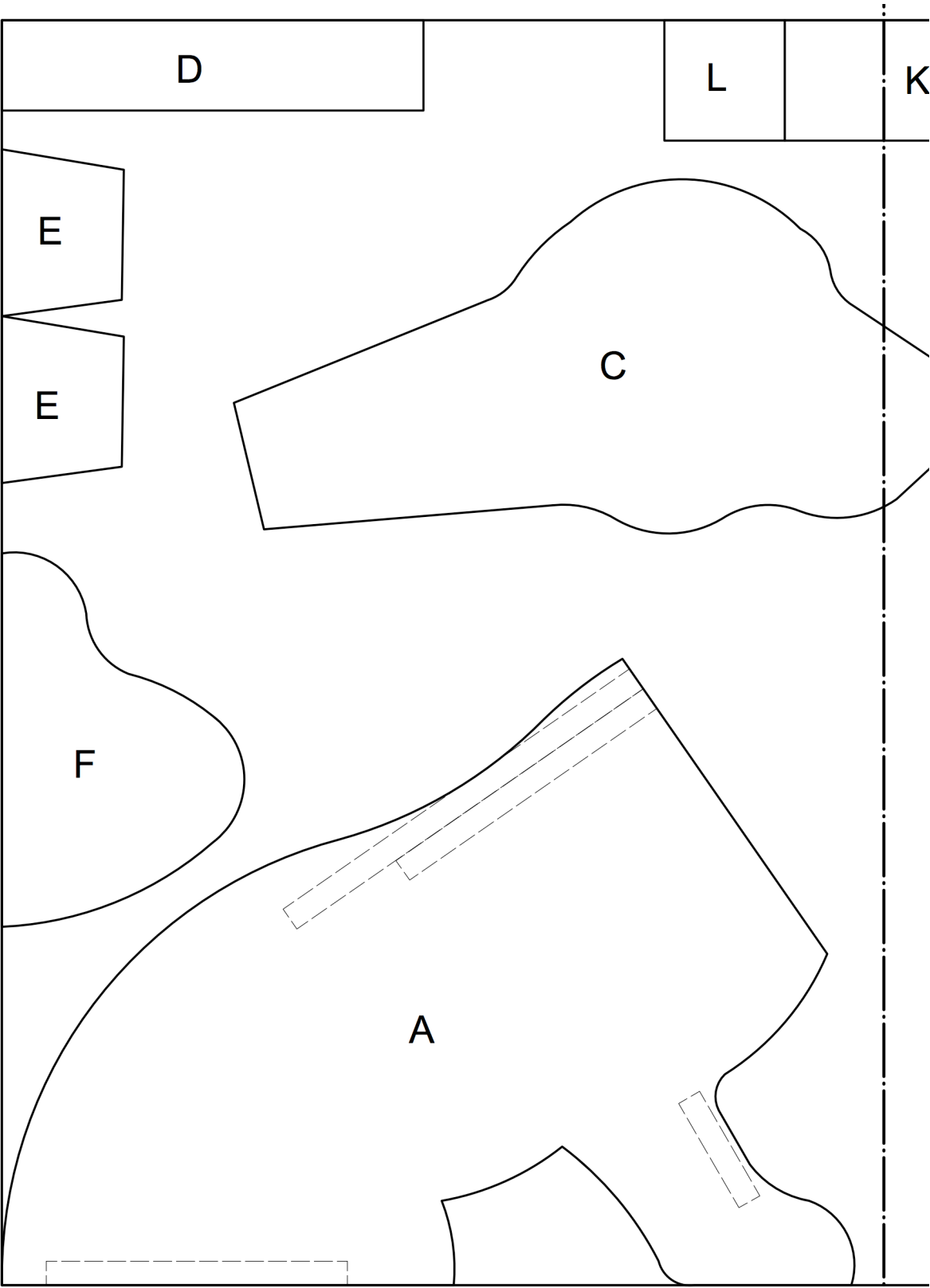

Template Dog  
(Foam Rubber)  
Ears  
Scale 1:1

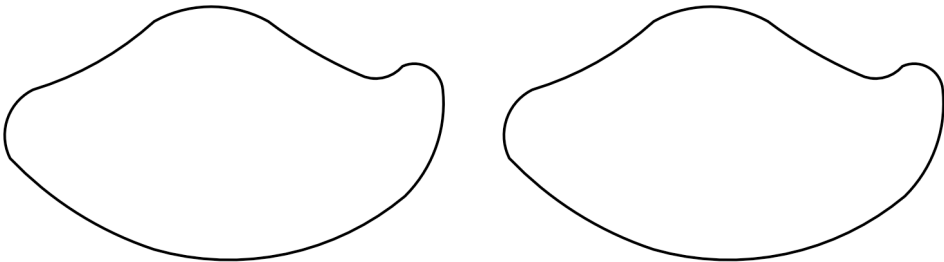





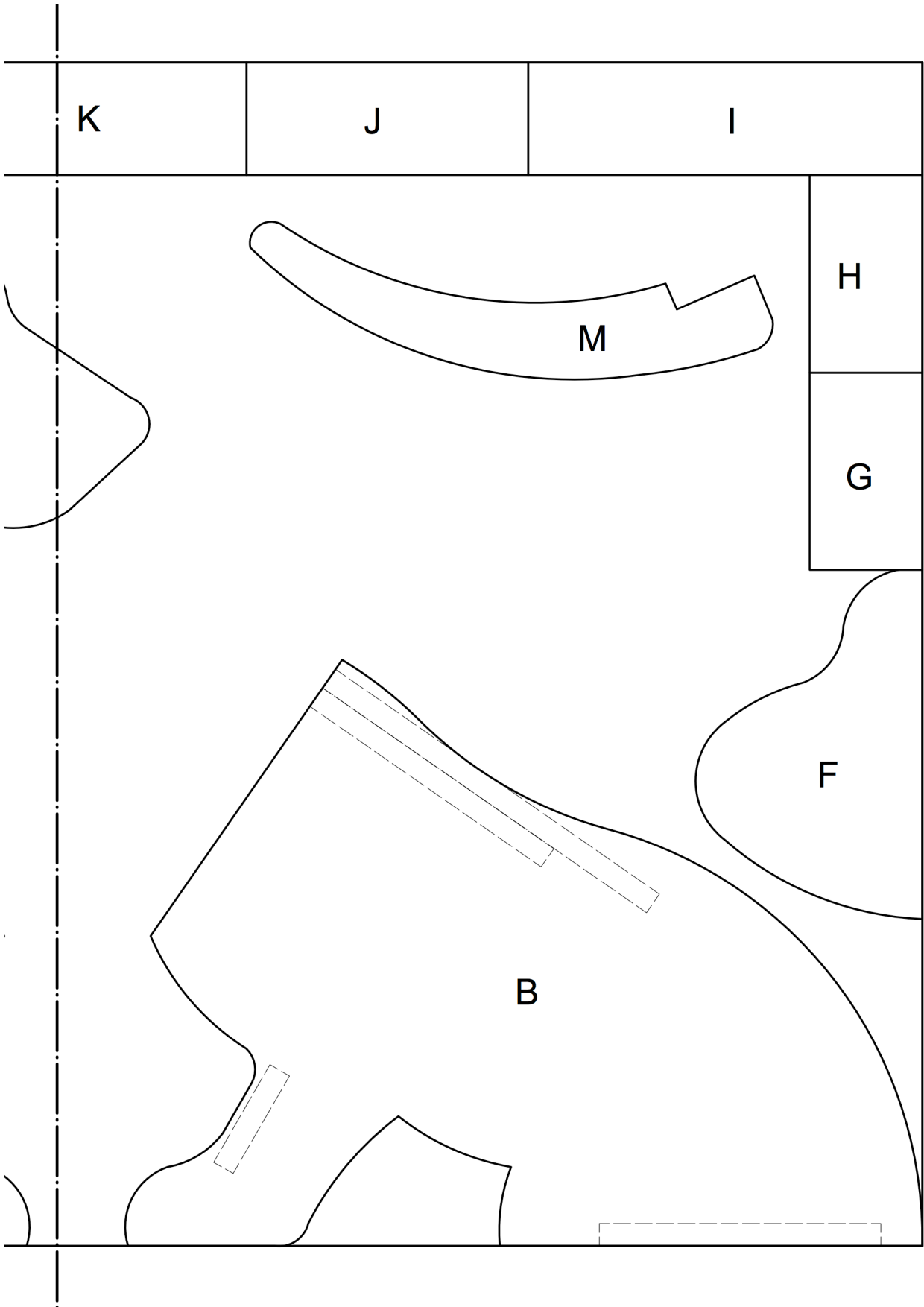



Template Cat  
Scale 1:1

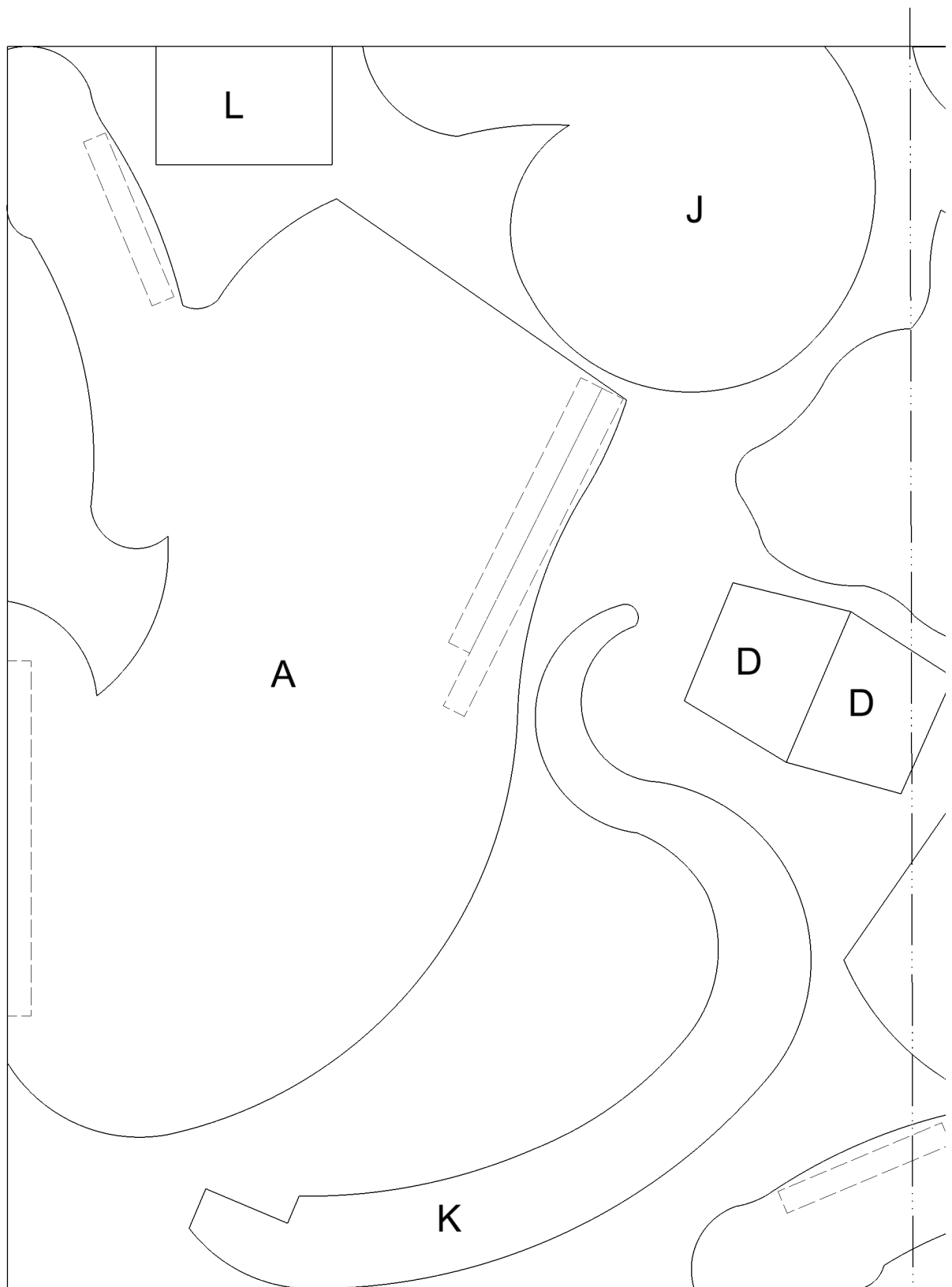

Template Cat  
(Foam Rubber)  
Ears  
Scale 1:1







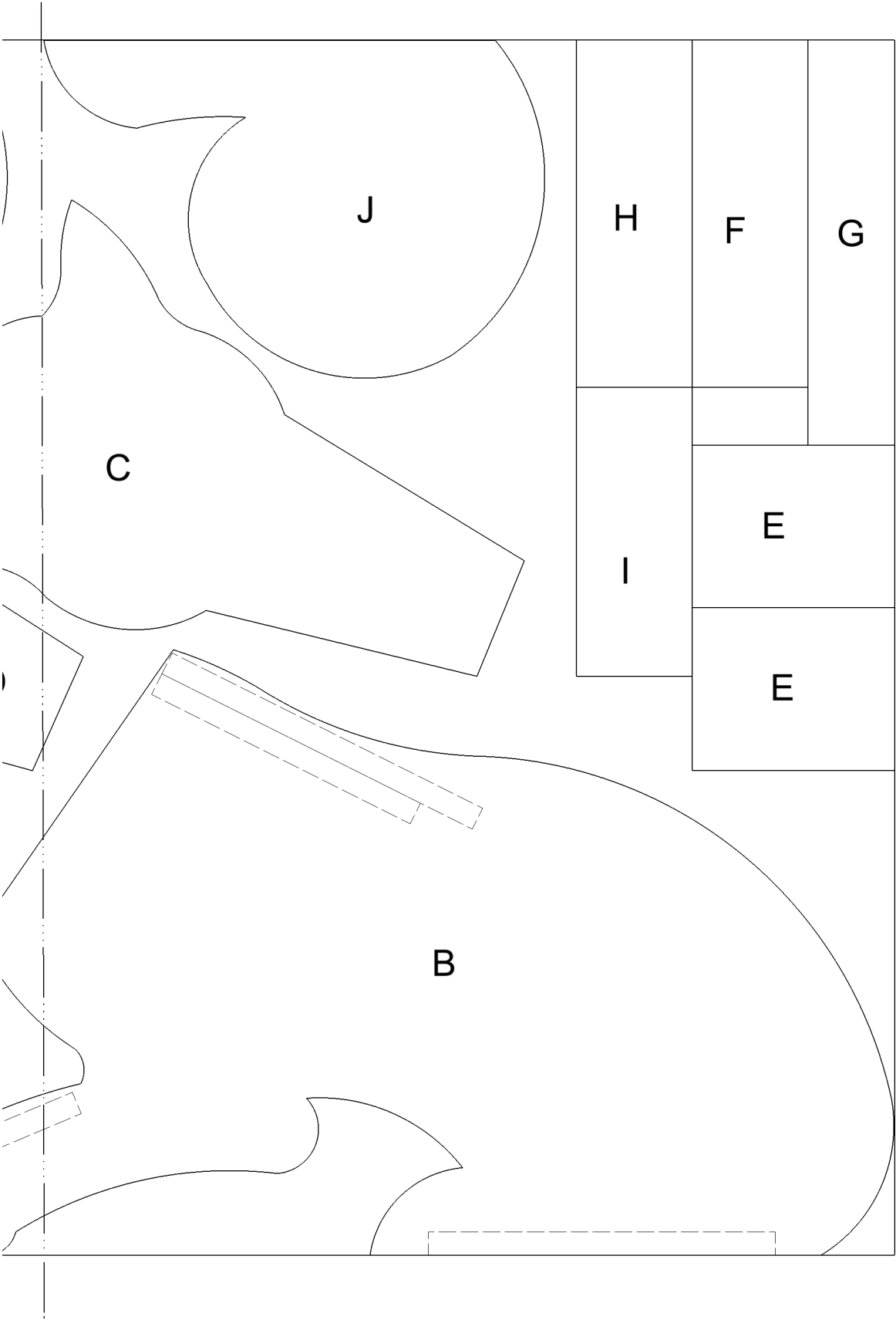



Template Turtle  
Scale 1:1

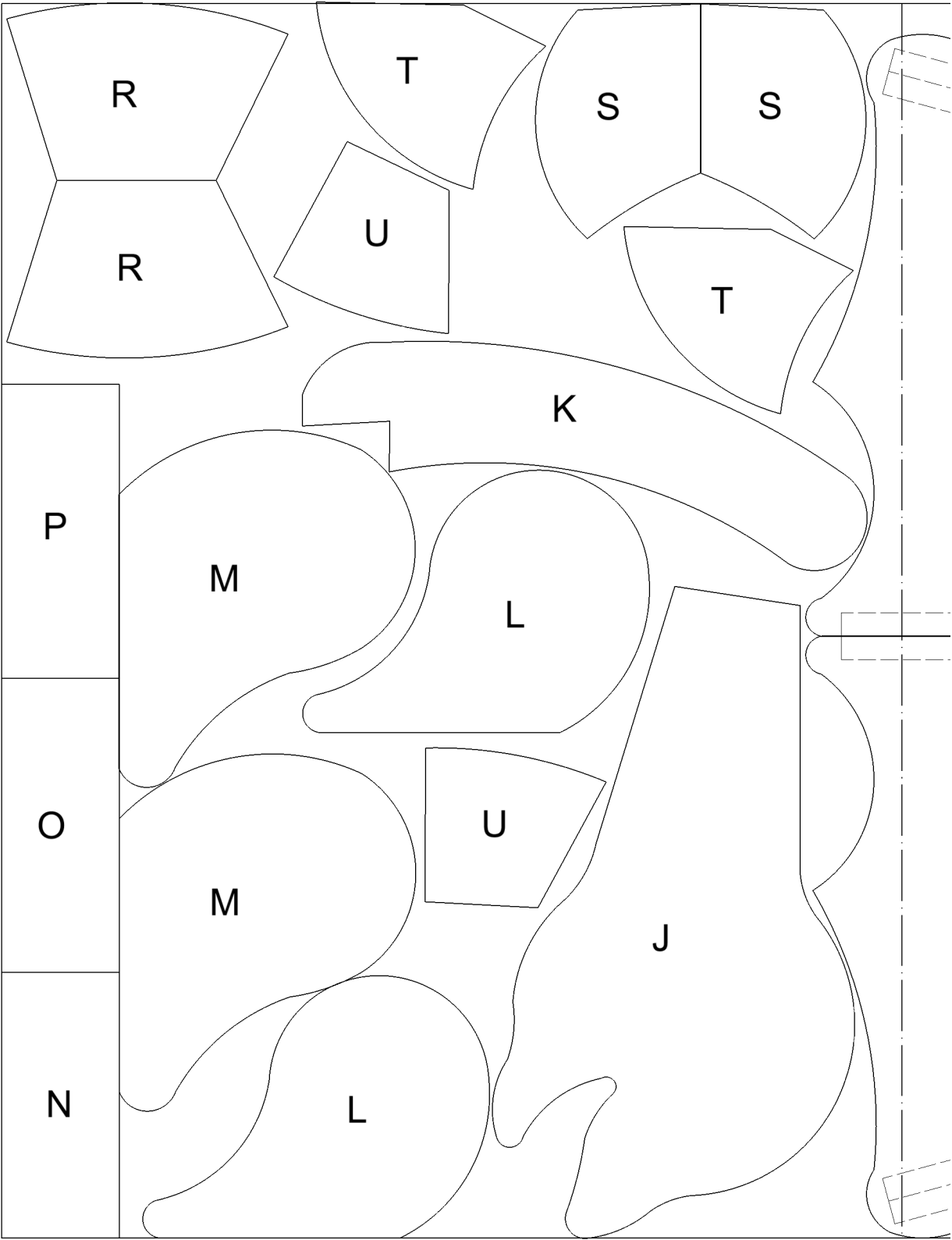

Template Turtle  
(Foam Rubber)  
Legs  
Scale 1:1

