

# 104.416

## Wooden Racer

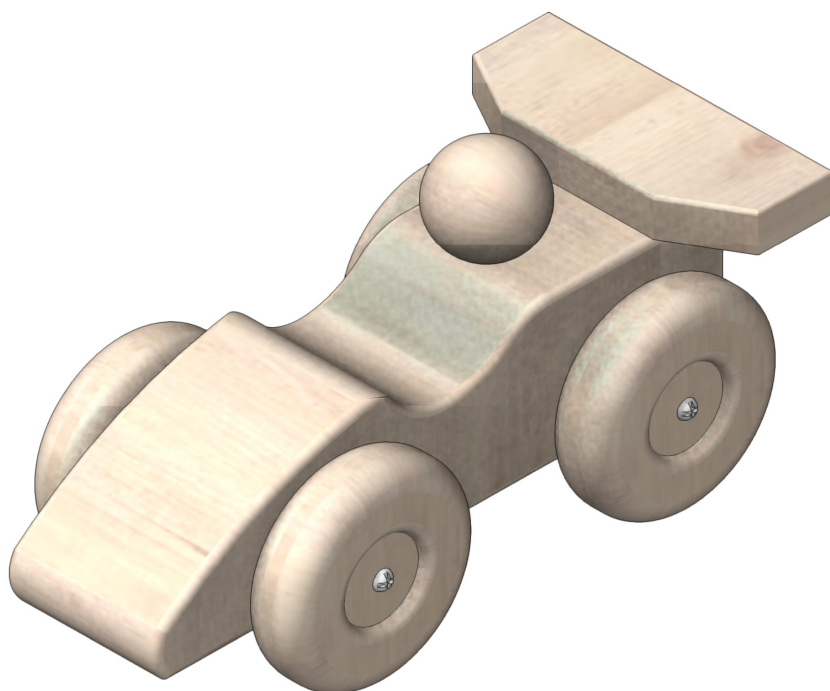

### Required Tools:

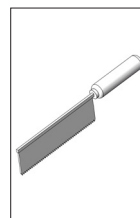

Saw

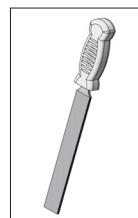

File

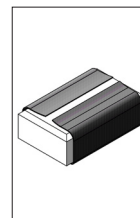

Sandpaper

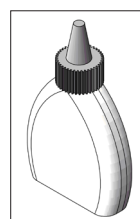

Wood Glue

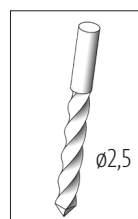

Drill

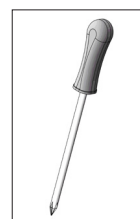

Phillips  
Screwdriver

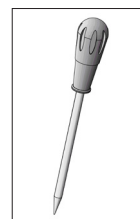

Pricking Awl

### Please Note:

The Opitec Range of projects is not intended as play toys for young children. They are teaching aids for young people learning the skills of craft, design and technology. These projects should only be undertaken and operated with the guidance of a fully qualified adult. The finished projects are not suitable to give to children under 3 years old. Some parts can be swallowed. Danger of suffocation!

Components List	Quantity	Sizes (mm)	Description	Part No.
Wooden Strip	1	150x40x40	Body	1
Wooden Strip	1	75x30x10	Rear Spoiler	2
Profil Wooden Wheel	4	ø50	Wheels	3
Button Head Screws	4	ø3x25	Screws	4
Wooden ball	1	ø25	Head	5

Instructions 104.416  
Wooden Racer

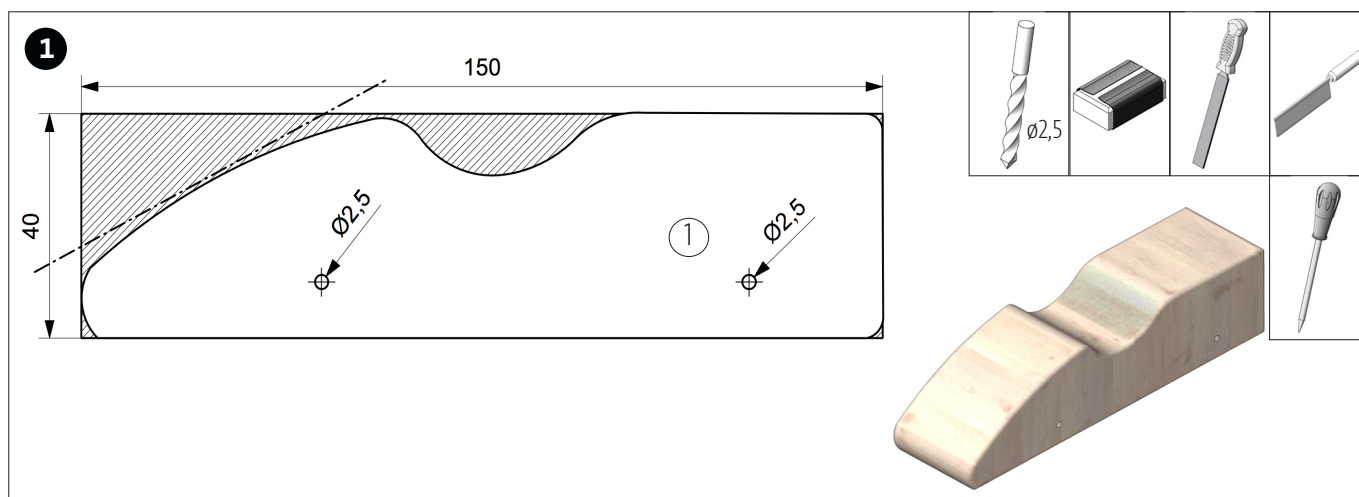

Transfer the pattern for the body to the wooden strip (1) and pre-drill the position of the holes. Drill the  $\varnothing 2.5$  mm holes approx. 10 mm deep. Then saw roughly the shape of the body. Refine the curves with the file and sandpaper.

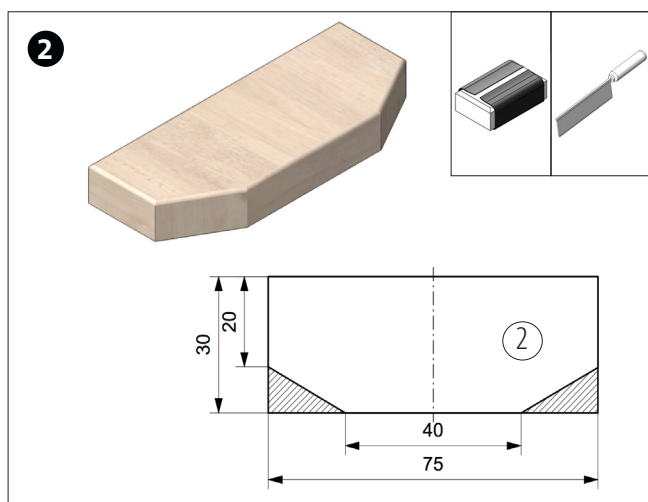

Transfer the pattern for the rear spoiler to the wooden strip (2). Then saw off the two corners and refine the saw cuts with sandpaper.

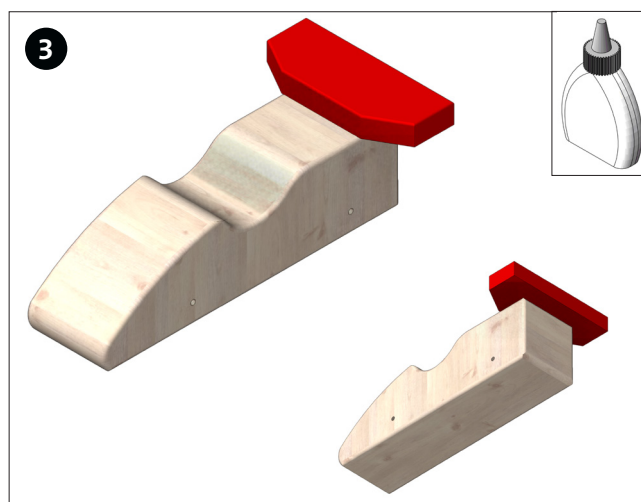

Then, glue the spoiler as shown according to the dimensions.

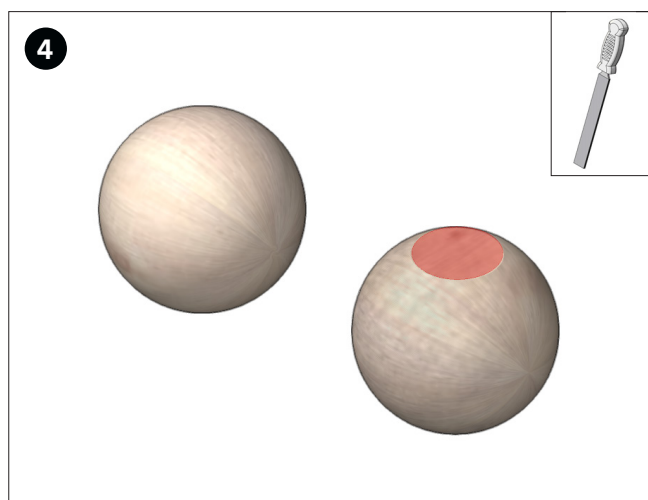

Flatten the wooden ball with a file.

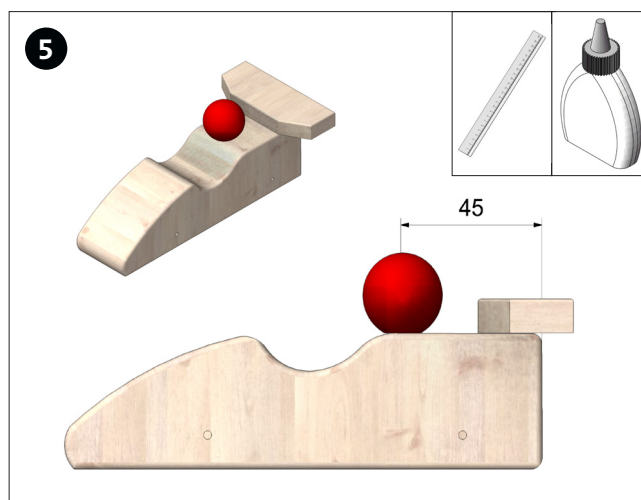

Glue on the wooden ball as shown. Let the glue dry well.  
**Note:** paint the racer as you wish before assembling the wheels.

Instructions 104.416  
Wooden Racer

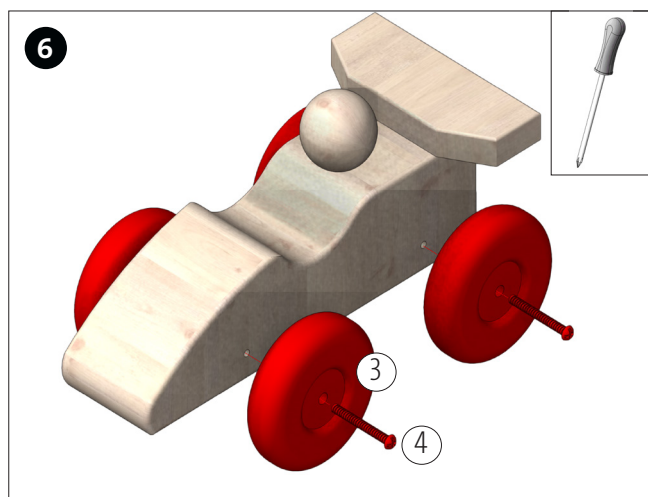

Fasten the wheels with one screw (4) each, so that they can still turn easily.

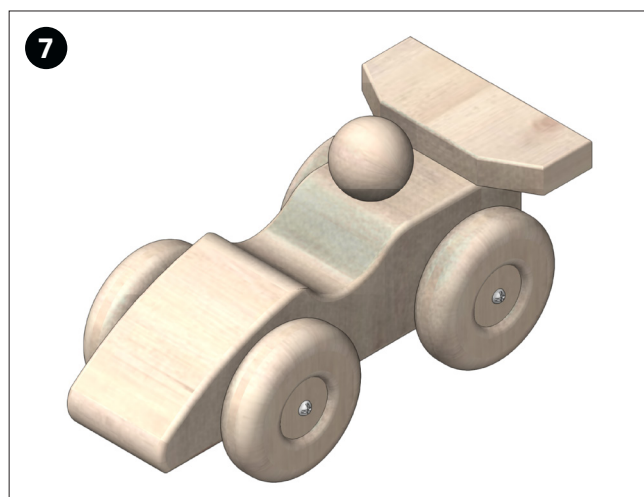

Done!

Pattern Body and Rear Spoiler  
Scale 1:1

