

123.207

Tools and scissors carousel

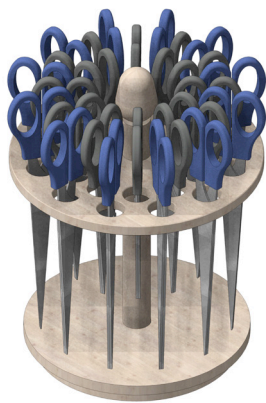

Required Tools:

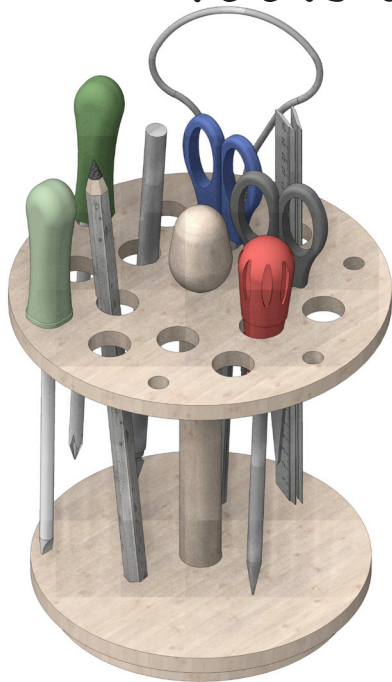
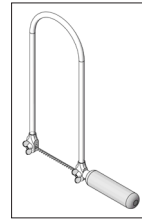

Jigsaw or scroll saw



Drill

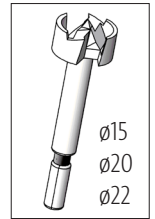

Drill

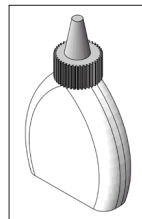

Wood Glue

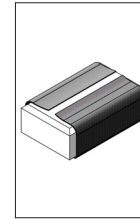

Sand Paper

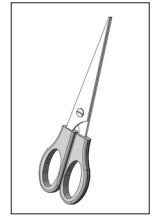

Scissors

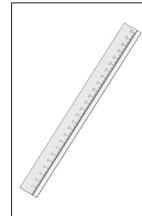

Ruler

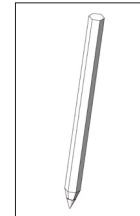

Pencil



Pliers

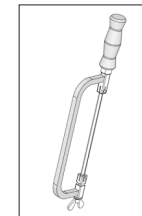

Metal saw

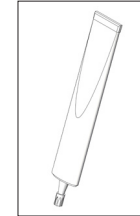

All Purpose Glue

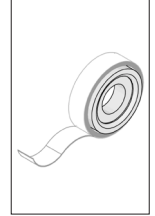

Adhesive tape

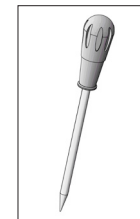

Pricking Awl

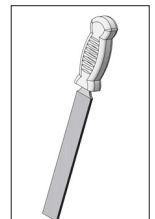

File

Please Note

The Opitec Range of projects is not intended as play toys for young children. They are teaching aids for young people learning the skills of craft, design and technology. These projects should only be undertaken and operated with the guidance of a fully qualified adult. The finished projects are not suitable to give to children under 3 years old. Some parts can be swallowed. Danger of suffocation!

Components List	Quantity	Size (mm)	Description	Part-No.
Plywood	2	400x300x8	Circular blanks	1
Round bar	1	ø20x300	Round bar	2
Round bar	1	ø8x50	Connection ball bearing	3
Ball bearing	1	ø22	Ball bearing	4
Threaded rod	1	M4x100	Screw connection egg	5
Wooden egg	1	40x30	Rotary handle	6
Foam rubber	1	9,92x9,56x2	Stand anti-slip	7

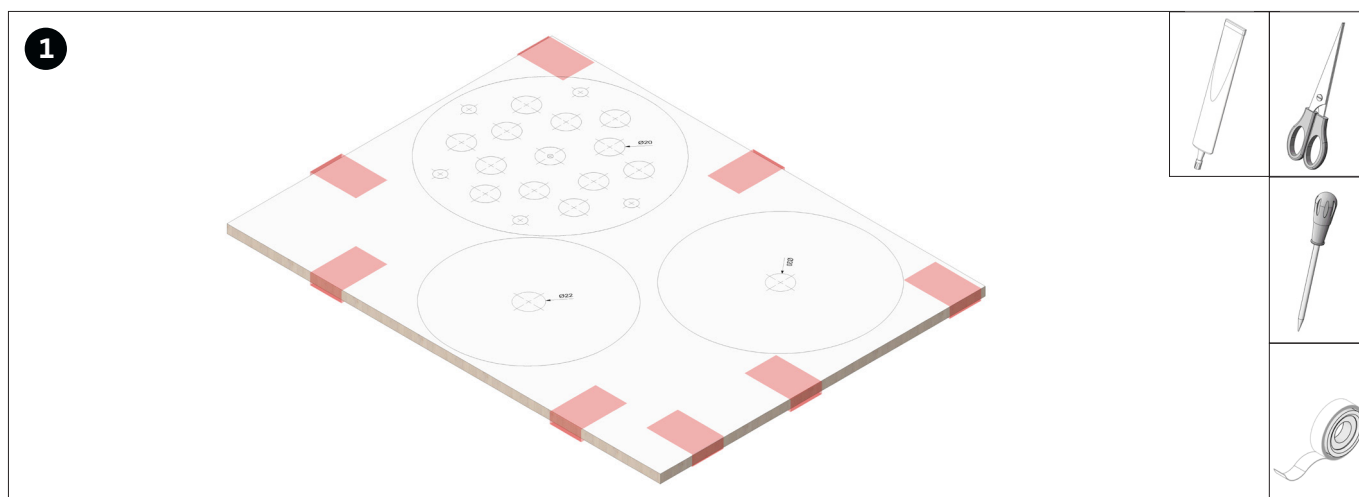

Cut out the template for the round blanks (depending on the version selected, pages 5-11 (general tools) or pages 13-19 (scissors)) and glue them together. Then transfer to the plywood panel (1). Mark all the holes with a pricking awl.

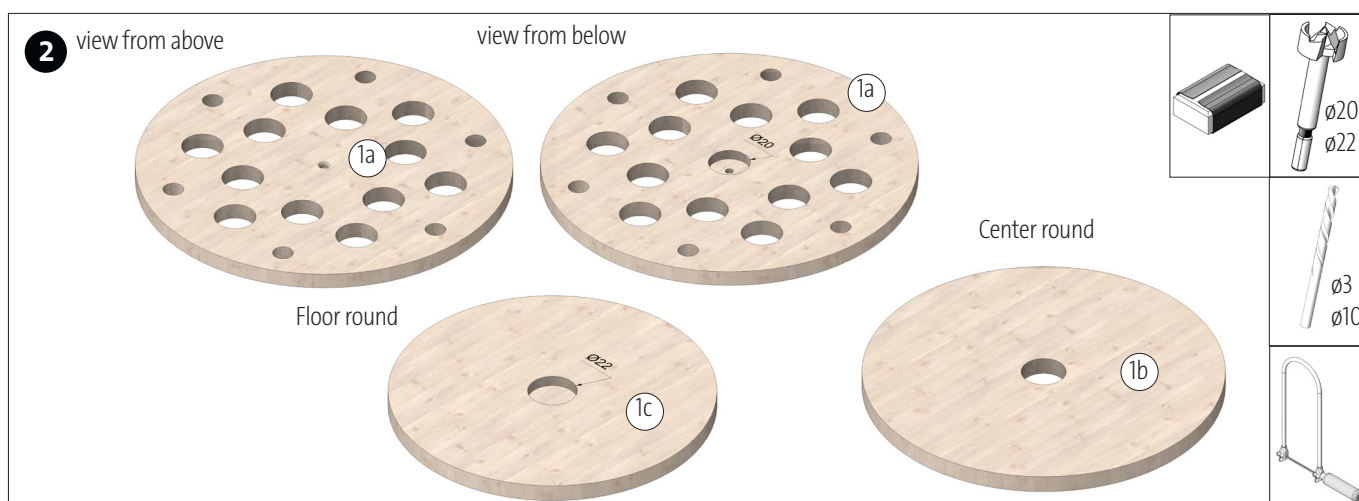

Drill through all the holes ($\varnothing 3$, $\varnothing 10$, $\varnothing 20$ mm). Then drill the blind hole ($\varnothing 22$) 6 mm deep. Drill the blind hole in the tool holder (1a) from below 5 mm deep. Finally, saw out all three circular blanks and clean the saw cuts.

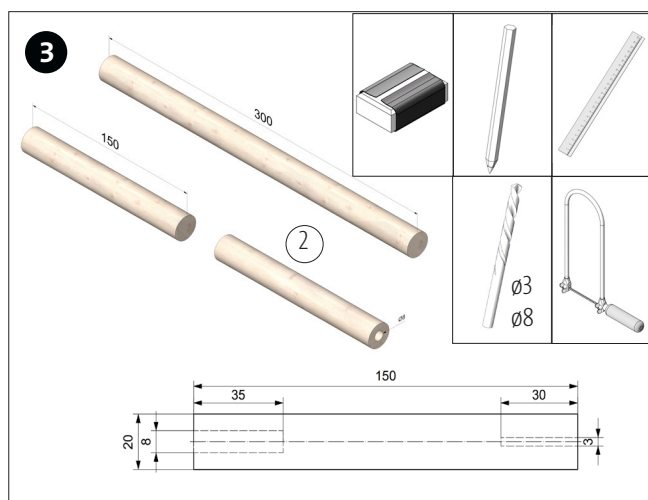

Cut a 150 mm long piece from the round rod (2) and clean the saw cut. Then drill a hole $\varnothing 8$ approx. 35 mm deep at one end. Drill a hole $\varnothing 3$ approx. 30 mm deep on the opposite side. Keep leftover piece!

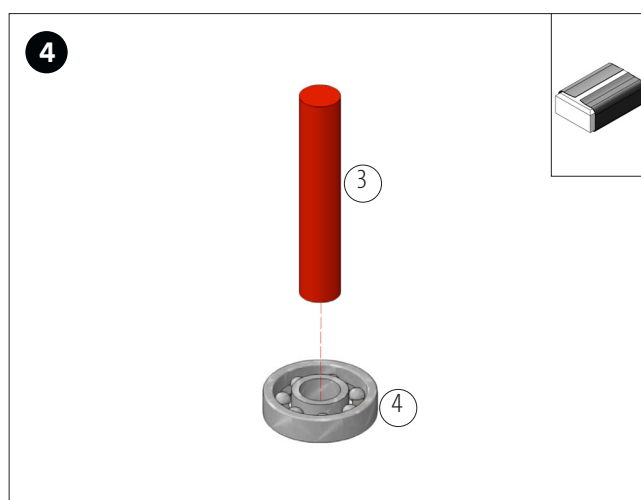

Clean the edges of the round rod (3) with sandpaper. Then press it into the centre hole of the ball bearing (4) as shown.

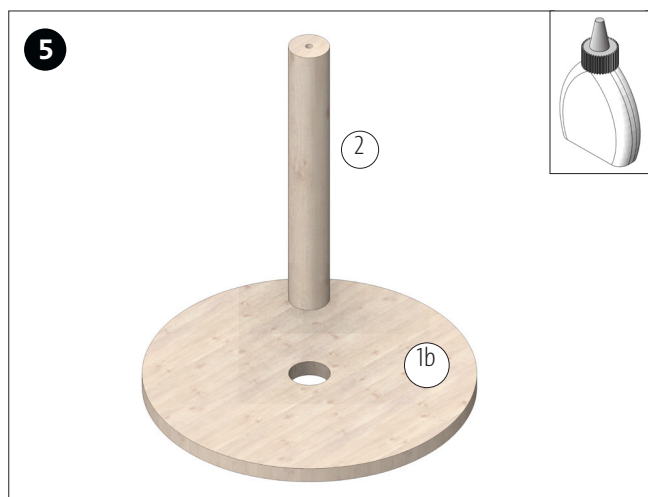

Glue the round rod (2) with the 8 mm hole facing downwards, flush with the lower edge, into the centre round (1b).



Insert the round rod with the ball bearing, as shown, through the hole in the centre round (1b) and glue it in place.

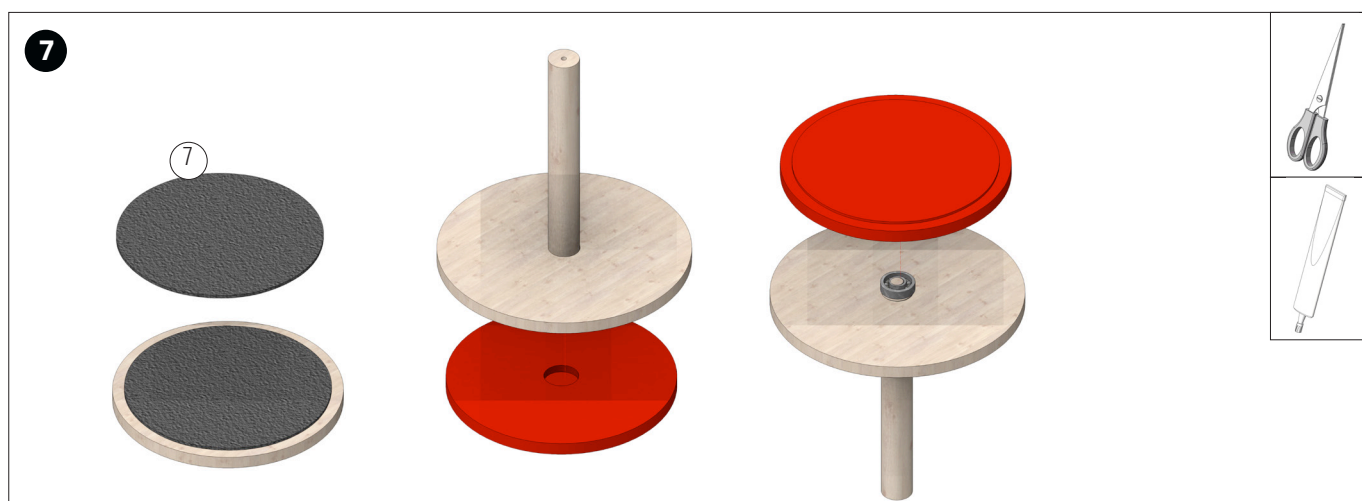

Cut the foam rubber according to the template (page 9). Then glue the foam rubber, centred, onto the back of the base plate. Turn the base plate over and connect it to the rod by inserting the ball bearing into the blind hole of the base plate with the centre round.

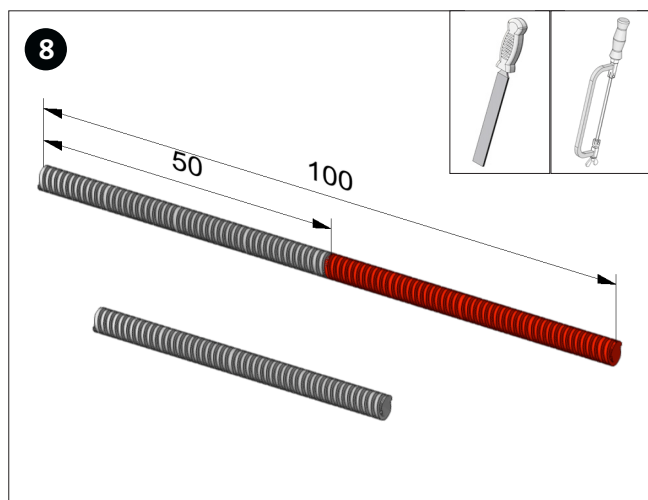

Version tool carousel: Cut the threaded rod (5), in half with a metal saw as shown and clean the saw cut.

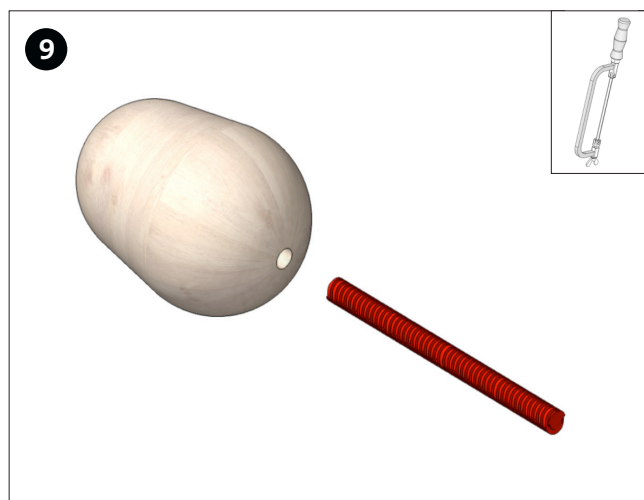

Version tool carousel: Screw the threaded rod (50 mm) halfway into the hole in the wooden ice (6) as shown.

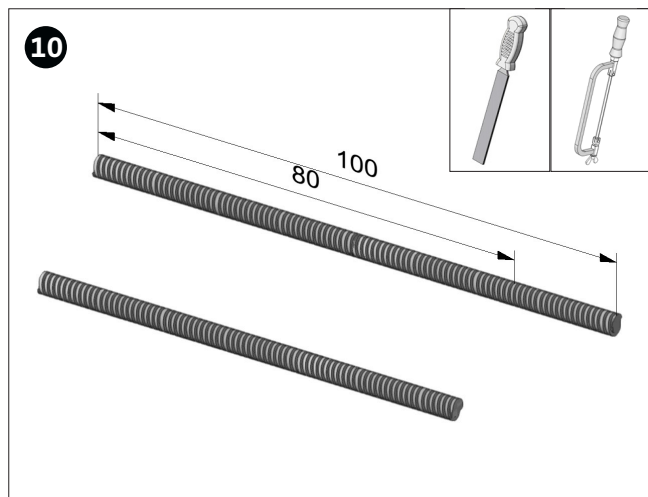

Version scissors carousel: Shorten the threaded rod (5) to 80 mm with a hacksaw as shown and clean the saw cut.

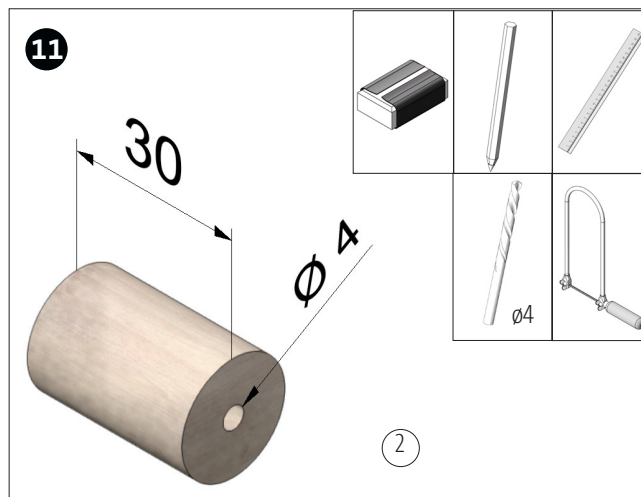

Version scissors carousel: Saw off 30mm from the rest of the round bar (2) and drill a Ø4mm hole through the center.

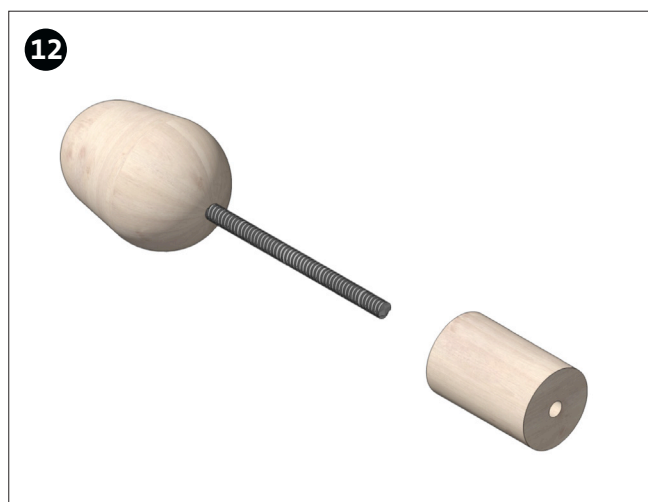

Version scissors carousel: Screw the threaded rod (80 mm), as shown, approx. 25 mm deep into the hole in the wooden rail (6). Then attach the wooden rod.

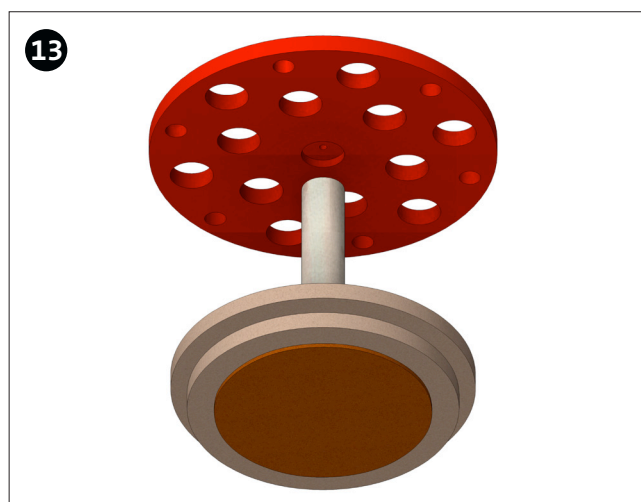

All versions: Fit the drilled circular blank (tool holder) as shown.

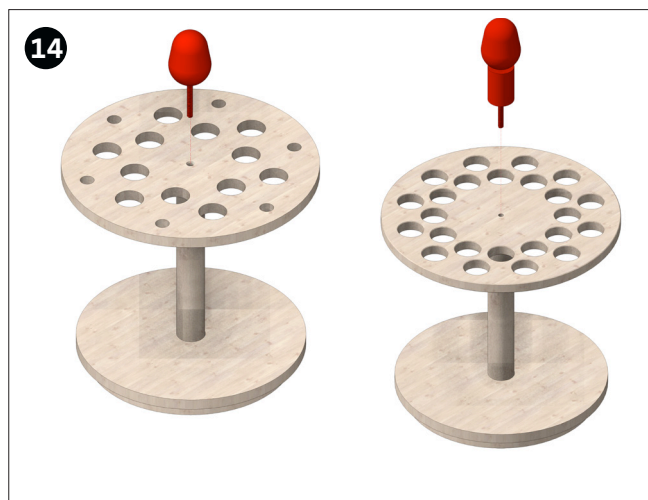

All versions: Screw the wooden egg with threaded rod, as shown, into the hole of the tool holder from above and tighten to fix it.

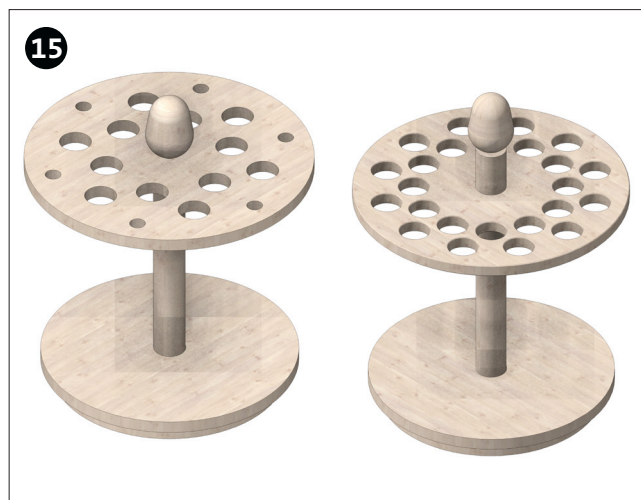

Done!

