

# 101.812

## Tender

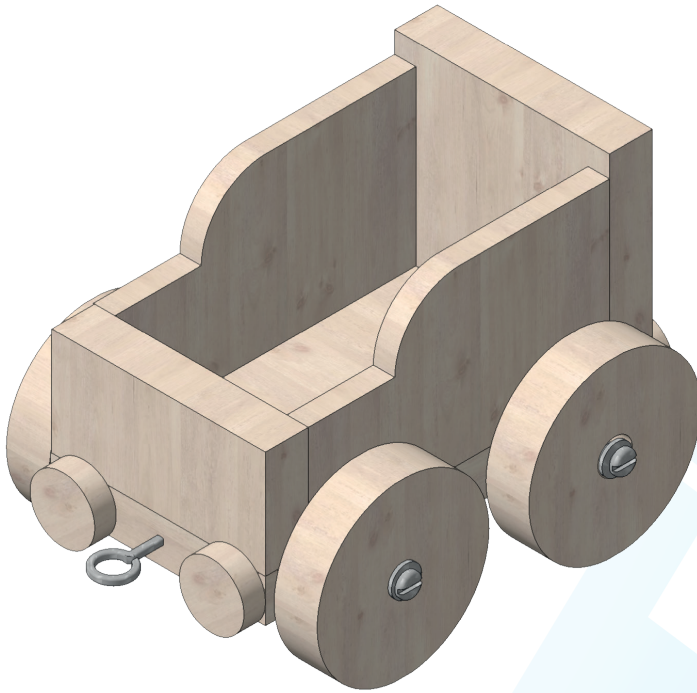

### Tools Required:

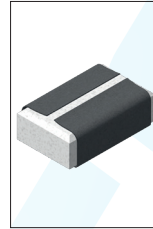

Sandpaper

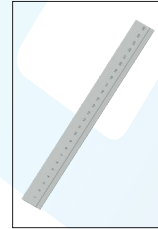

Ruler

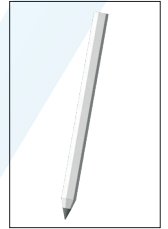

Pencil

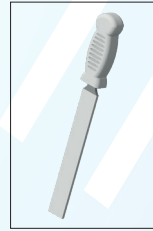

File

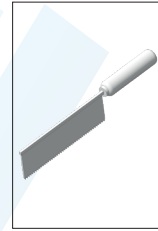

Miter saw

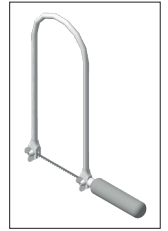

Jig saw

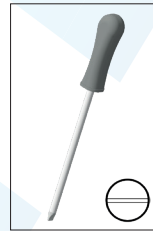

Screwdriver



Drill



Pricker



Pliers



Wood glue

### NOTE:

The OPITEC range of projects is not intended as play toys for young children. They are teaching aids for young people learning the skills of Craft, Design and Technology. These projects should only be undertaken and tested with the guidance of a fully qualified adult. The finished projects are not suitable to give to children under 3 years old. Some parts can be swallowed. Danger of suffocation! Not suitable for children under 36 months. Choking hazard!

Part List	Quantity	Dimensions (mm)	Description	Part no.
Wooden strip	1	200x50x10	Base plate +walls	1
Wooden strip	1	250x40x5	Side panels	2
Round rod	1	ø15x100	Buffer	3
Wooden wheel	4	ø40x10	Wooden wheel	4
Ring Screw	1	12	Clutch	5
Screw Hooks	1	20	Clutch	6
Washer	10	9/4.3	Washer	7
Screw	4	2,9x25	Mounting wheel	8

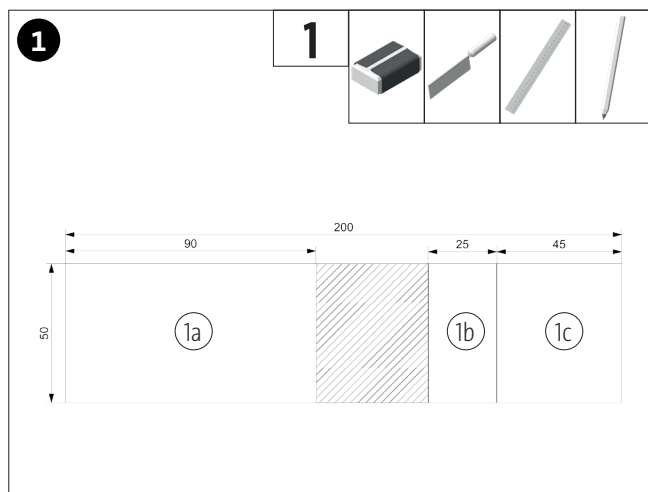

Cut parts 1a, 1b and 1c of the wooden moulding (1) to length as shown and clean the saw cuts.

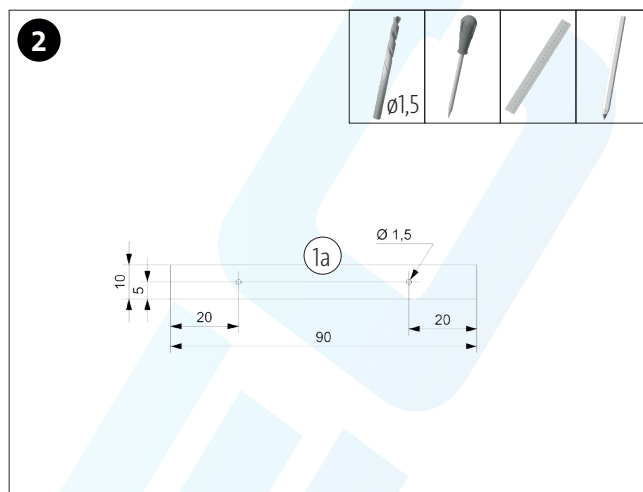

Mark the holes for the wheel bolts on both long sides of the wooden moulding (1a) according to the drawing and pre-drill with a  $\varnothing 1.5$  mm drill bit.

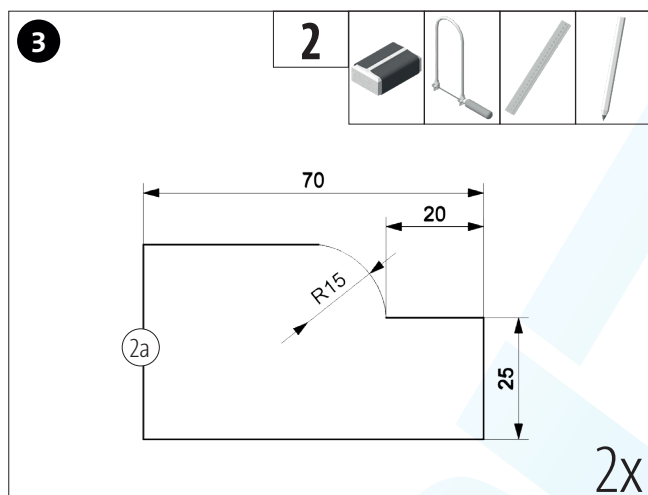

Transfer the dimensions for the side walls to the wooden moulding (2). Saw out and neaten the side panels.

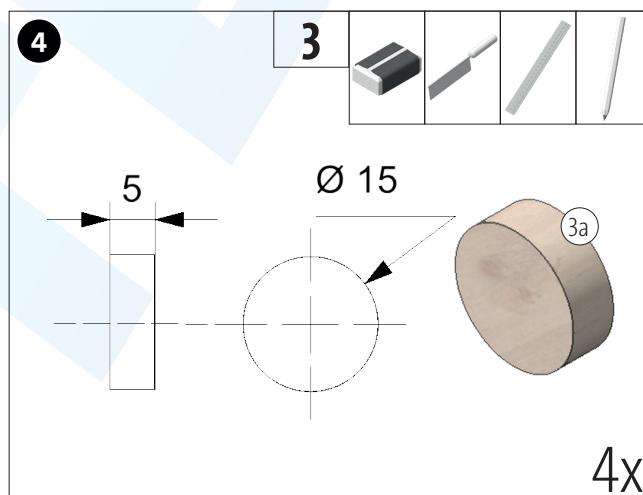

Saw off four 5 mm long buffers from the round bar (2) and neaten them.

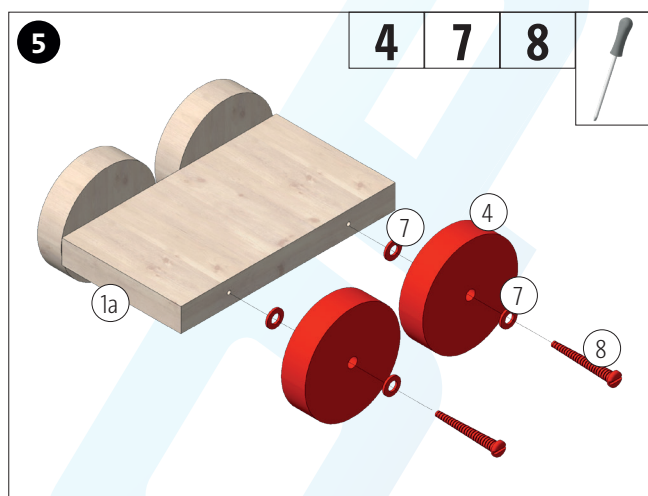

Screw the wheels (4) to the base plate (1a) using the washers (7) and the screws (8).

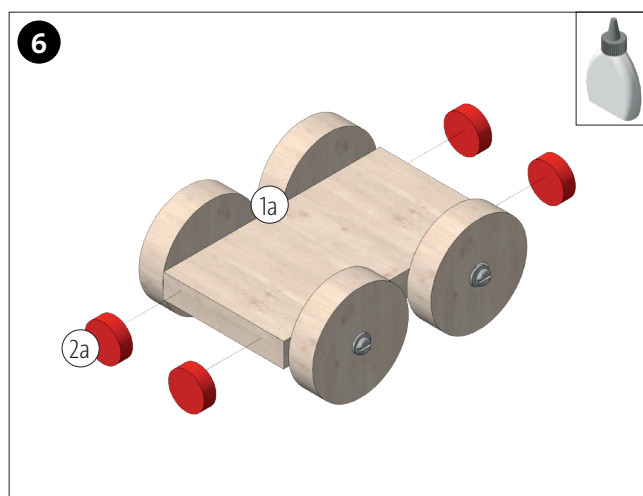

Glue the 4 buffers (2a) to both sides of the base plate (1a) as shown

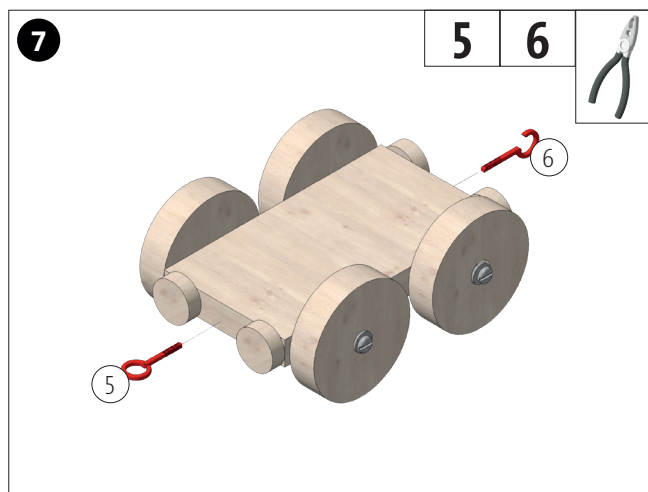

Screw in the eyebolt (5) and the screw hook (6) centred between the buffers.

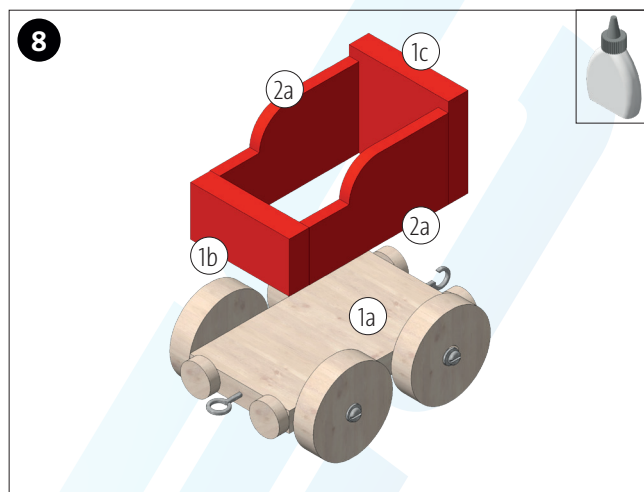

Glue the walls (1b + 1c) and the side walls (2a) to the base plate (1a) as shown.

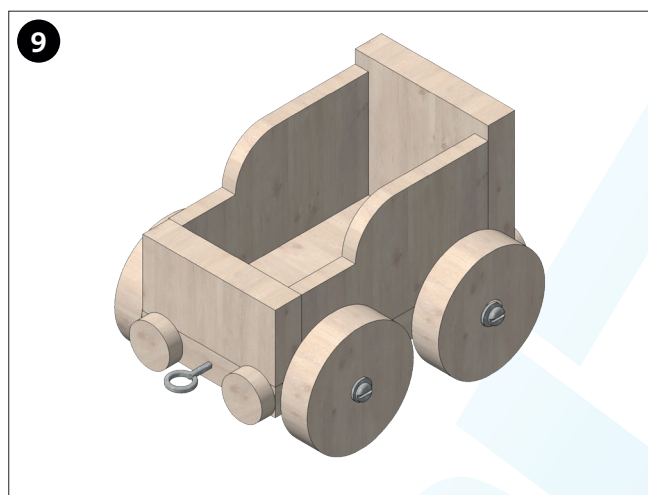

**DONE!**