

111600

HUI-HUI-Machine

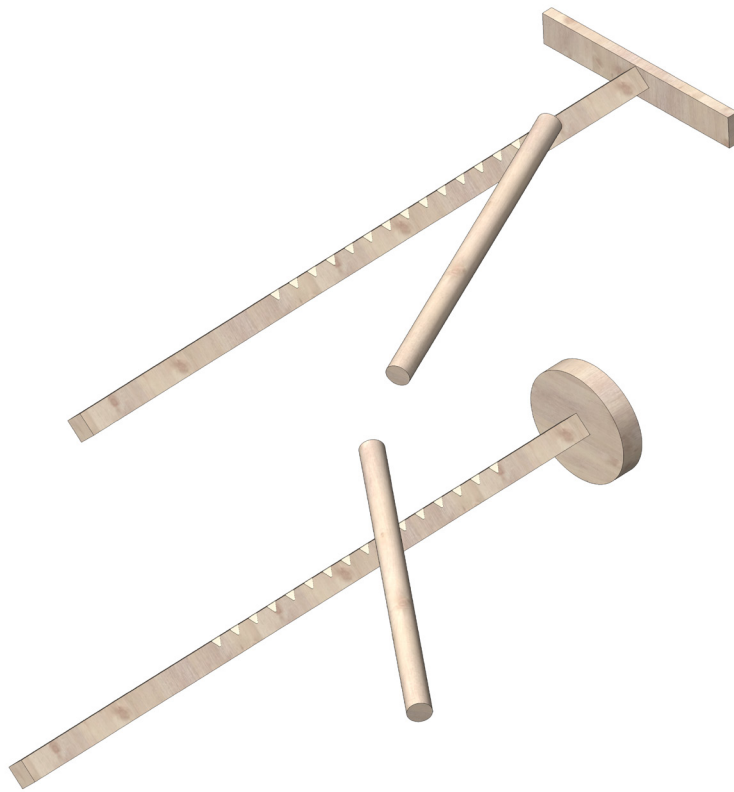

Required Tools:

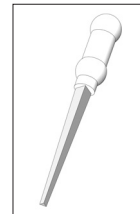

Triangular File

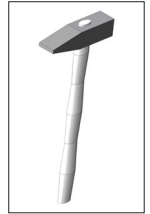

Hammer

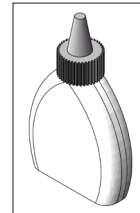

Wood glue

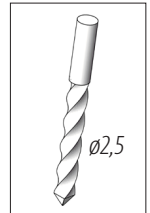

Drill bits

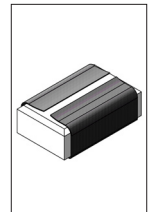

Sandpaper

Please Note:

The Opitec Range of projects is not intended as play toys for young children. They are teaching aids for young people learning the skills of craft, design and technology. These projects should only be undertaken and operated with the guidance of a fully qualified adult. The finished projects are not suitable to give to children under 3 years old. Some parts can be swallowed. Danger of suffocation!

Parts List	Quantity	Size (mm)	Description	Part No.
Wooden strip	1	10 x 10 x 300 mm	Wooden rod	1
Wooden strip	1	5 x 15 x 100 mm	Rotary element	2
Wooden wheel	1	Ø 50 mm	Rotary element	3
Round rod	1	10 x 150 mm	Rub wood	4
Nail	1	1,4 x 25	Fastening	5
Reducer	1	4/2	Reducer wooden wheel	6

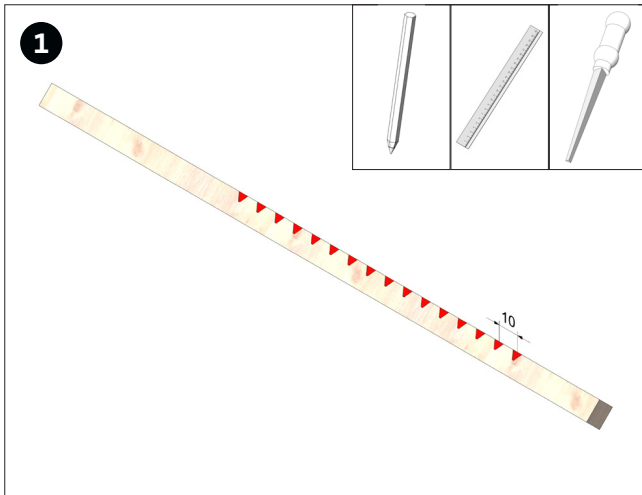

Rotate the wooden strip (1) by 45° and mark 15 indentations at a distance of 10 mm on the upper edge as shown (see page 4). Work out the indentations with the triangular file.

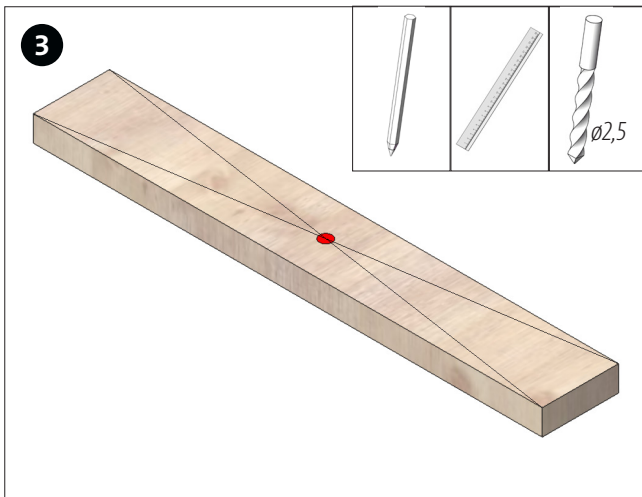

If you choose the wooden strip, drill through the centre of the wooden strip (2) with a Ø 2,5 mm drill bit. **Note:** the centre point can be determined easily using 2 diagonals.

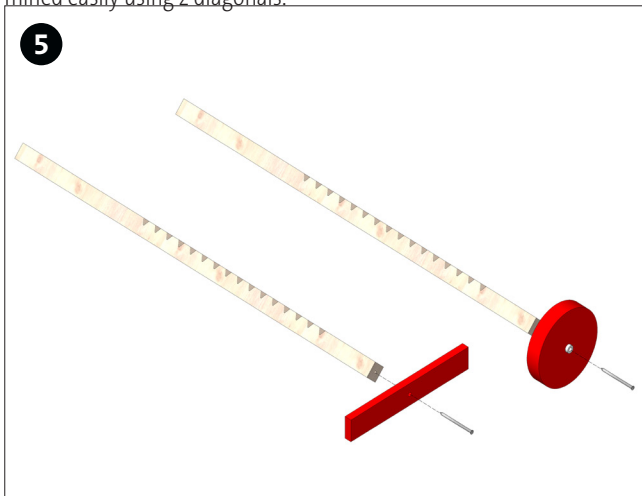

Determine and mark the centre point at the front end of the wooden strip (1). Fasten the wooden strip (2) or the wooden wheel (3) with a nail (5) as shown.



The wooden wheel (3) with reducer (6) or the wooden strip (2) can be used as a propeller.

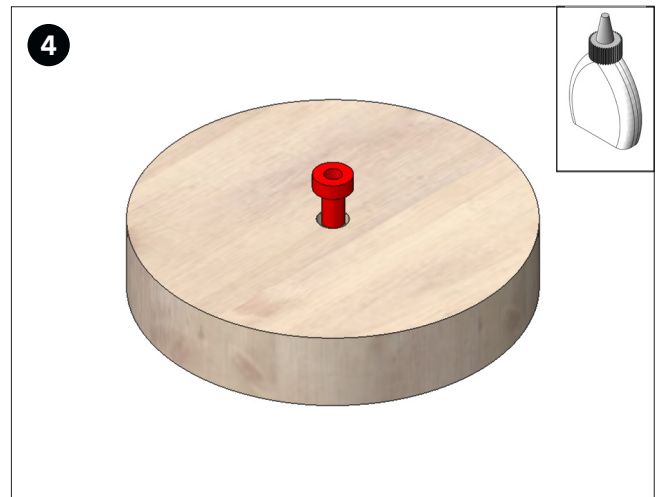

If you choose the wooden wheel, glue the reducer (6) into the wheel hole with wood glue.

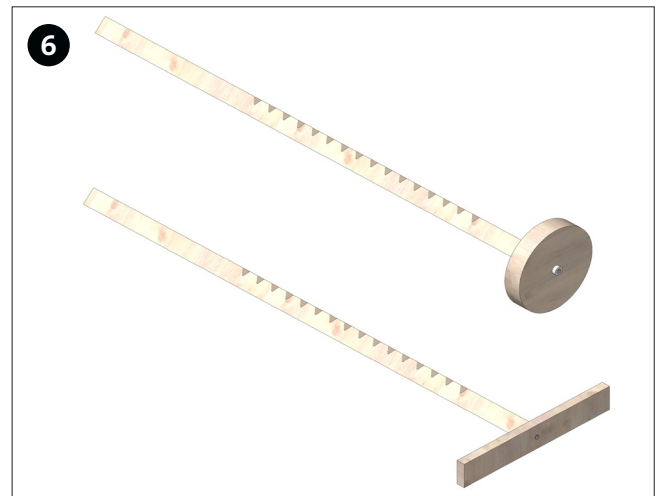

In the Hui-Hui machine, vibration (friction) on the wooden stick causes the rotation of the propeller wheel or wooden strip. The direction of rotation can be changed at any time. Done!

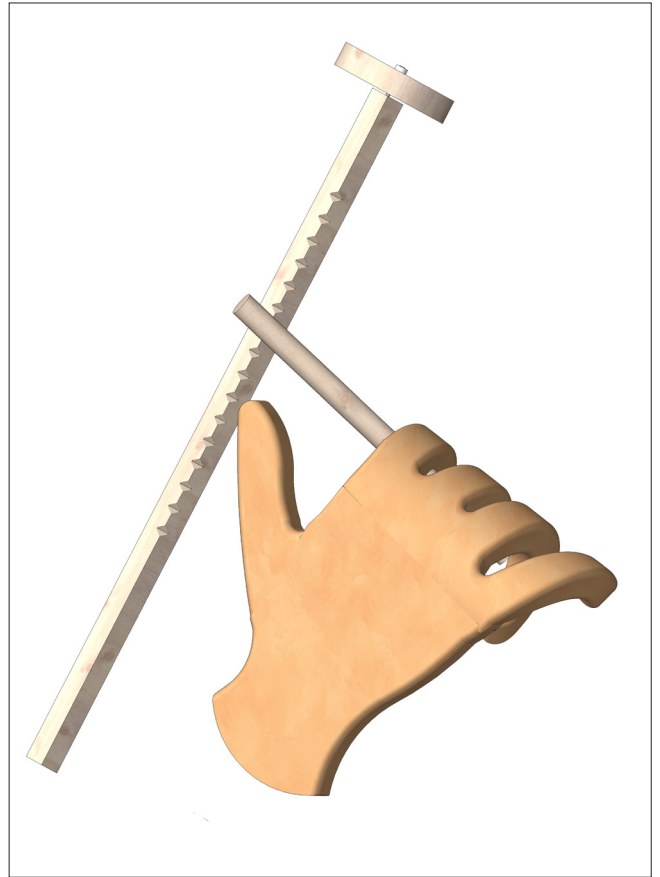
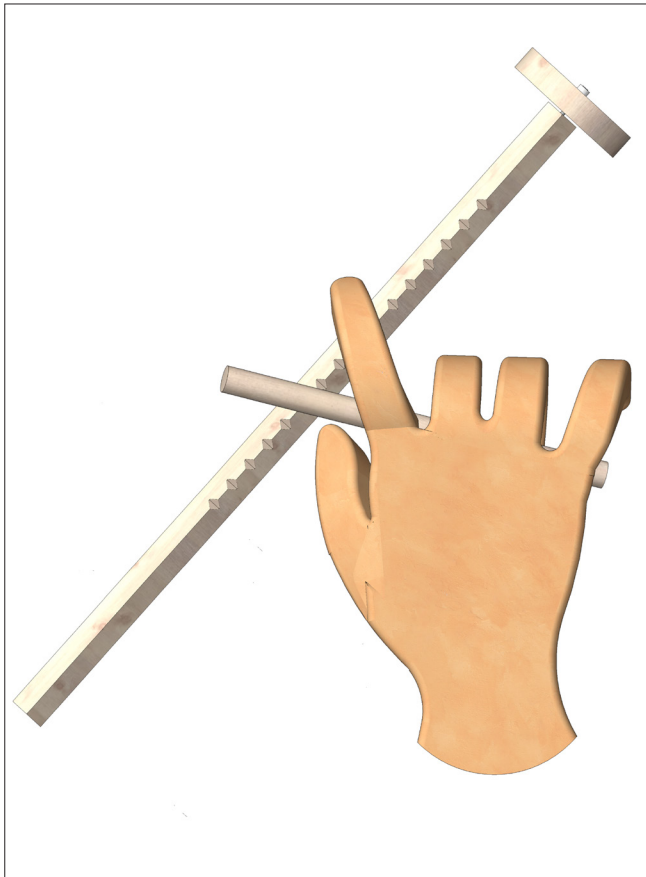

Functioning:

Hold the notched wooden strip with your left hand and rub the the round rod (4) over the notches. The thumb must touch the right notched side of the wooden strip. To change the direction of rotation, remove your thumb and touch the left notched side with your index finger (see figures 5 & 6).

