

OPITEC

Hobbyfix

113.680

Metal tealight "Shadow deco"



Necessary tools:

Fretsaw metal cutting blades
Drill ø 2mm
File & Sandpaper
Pliers
Pencil

Please Note

The OPITEC range of projects is not intended as play toys for young children. They are teaching aids for young people learning the skills of Craft, Design and Technology. These projects should only be undertaken and tested with the guidance of a fully qualified adult. The finished projects are not suitable to give to children under 3 years old. Some parts can be swallowed. Danger of suffocation!

Parts list				
	Part	Size (mm)	Description	Part-Nr.
Aluminium sheet	1	200x200x1	Base	1

INSTRUCTIONS

1. Choose the required design (Page 3-5) on to the aluminium sheet

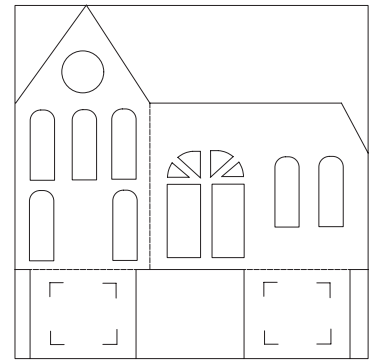
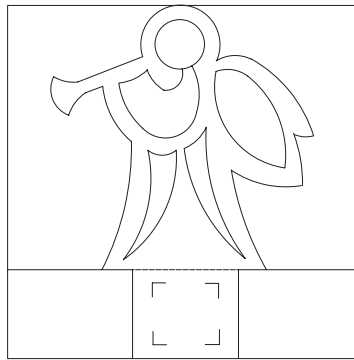
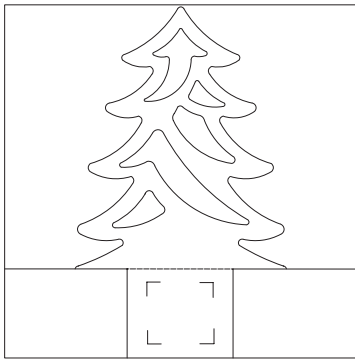

2. Now use a fretsaw to cut out the shape. To cut out the inside the shapes first drill a hole and then insert the fretsaw blade through the hole. Finally bend the shape to finish

Bending instruction

Fir tree

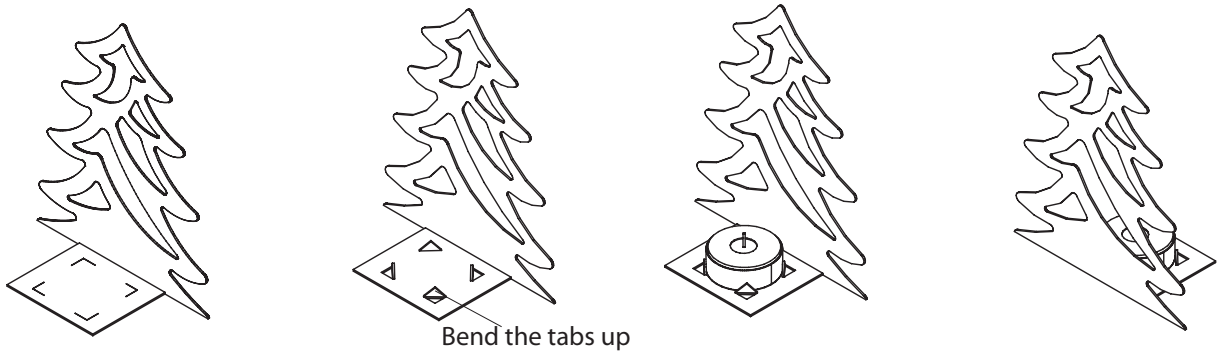

Bend the tabs up

Angel:

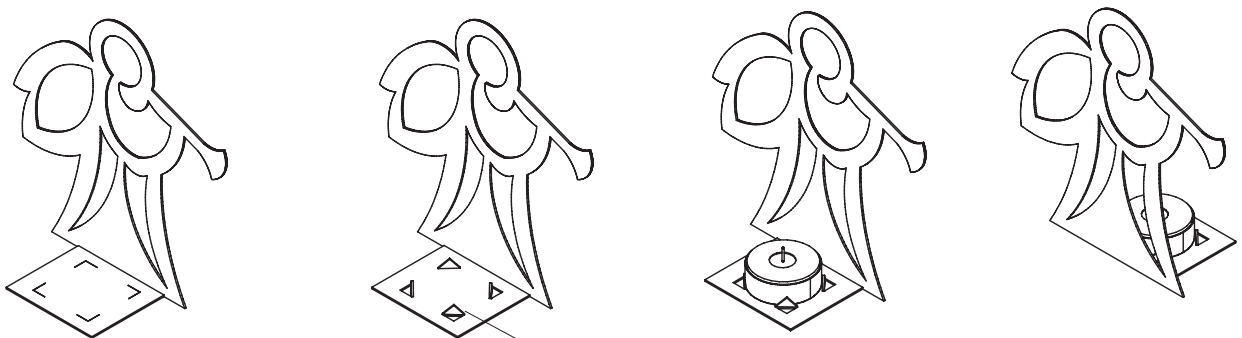

Bend the tabs up

House:

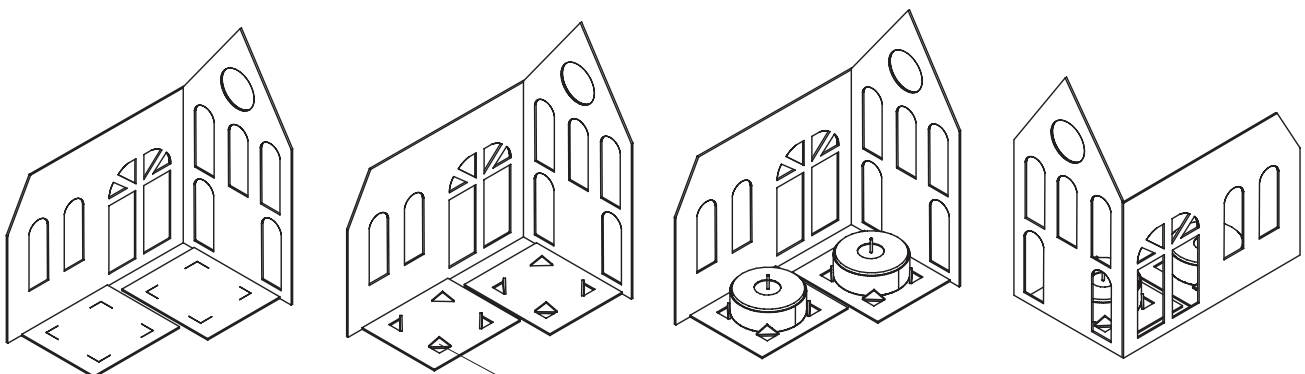

Bend the tabs up

INSTRUCTIONS

Stencil Fir Tree
Scale 1:1

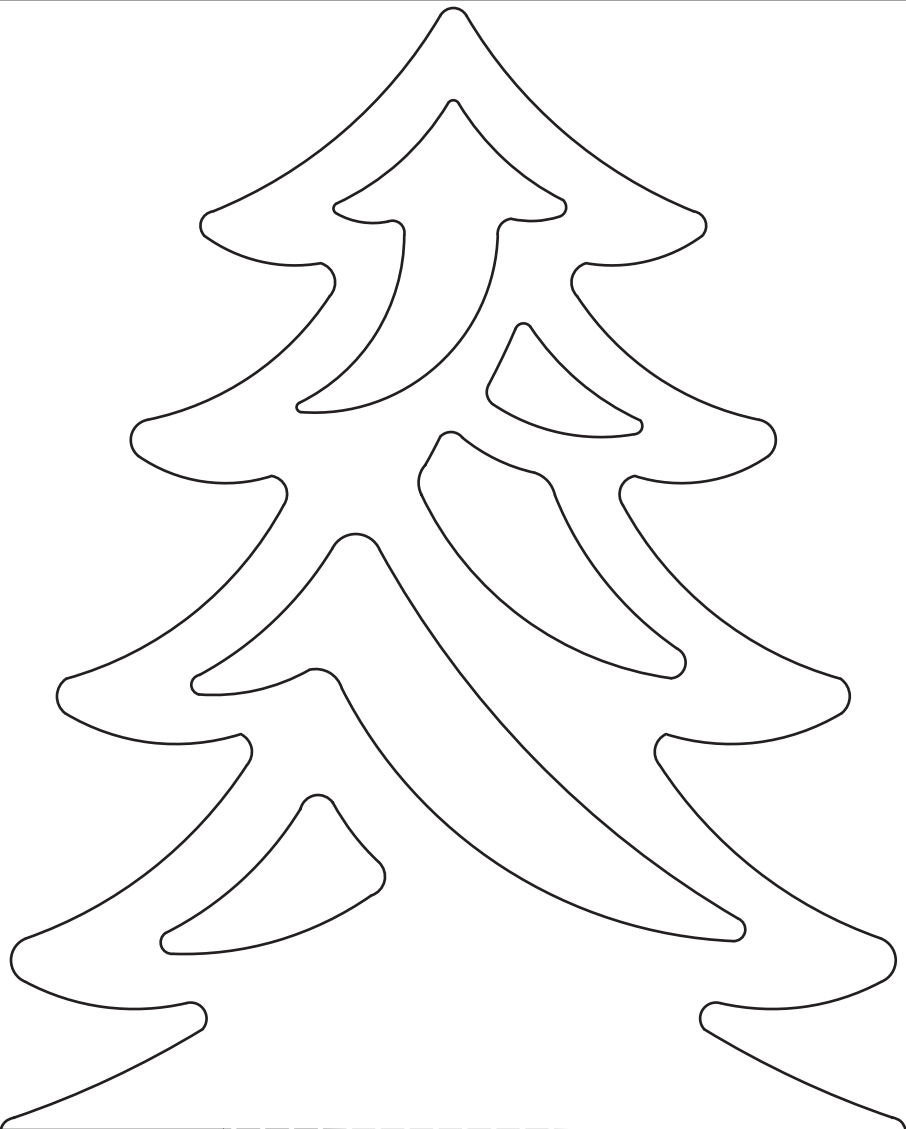

Biegekante

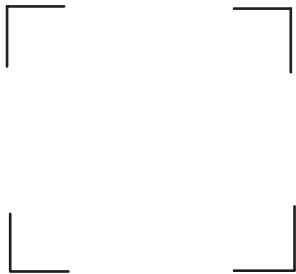

INSTRUCTIONS

Stencil Angel
Scale 1:1

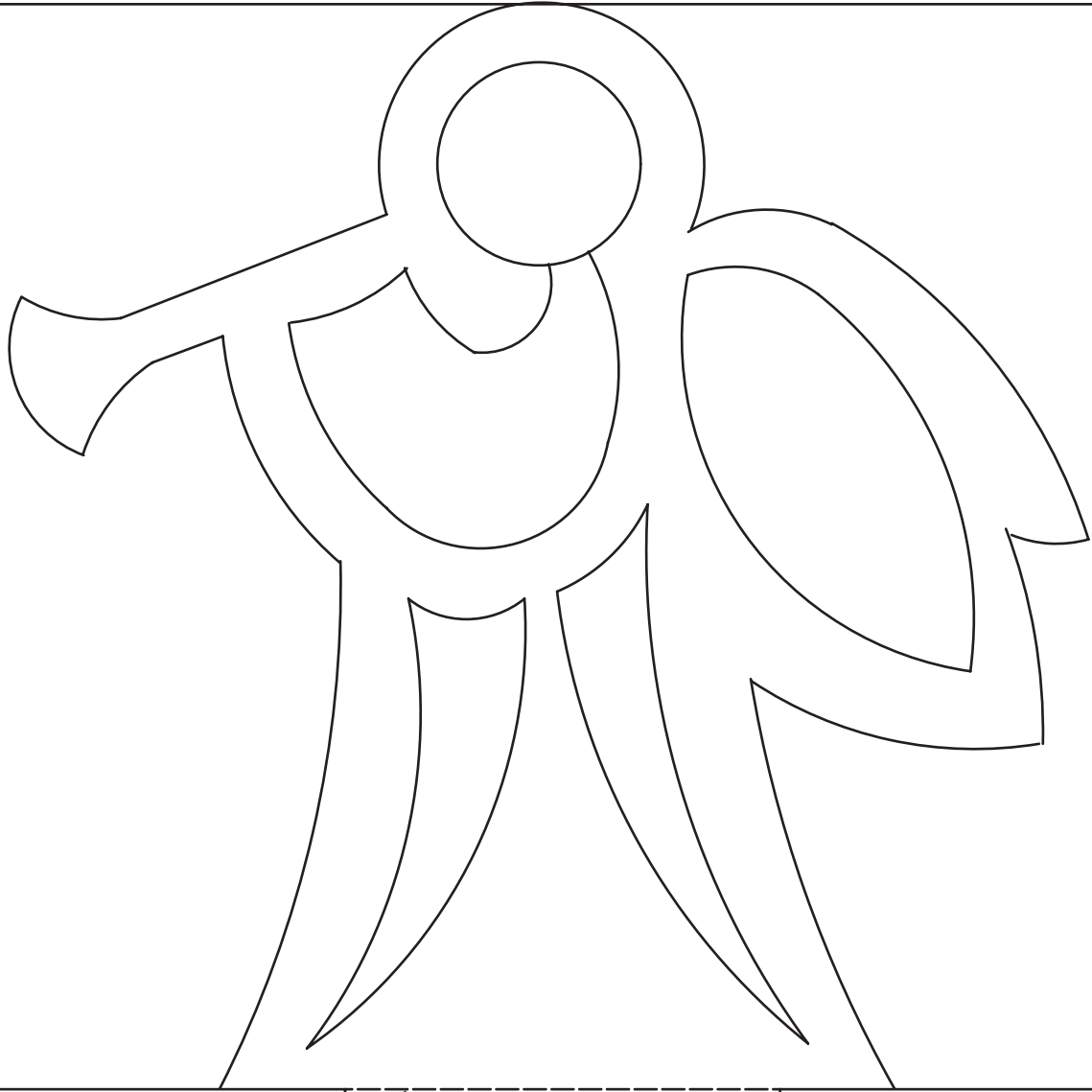

Bend up tabs

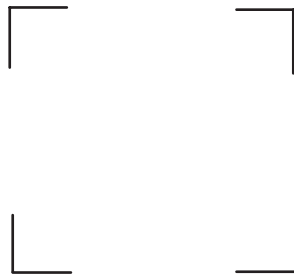

BAUANLEITUNG

Stencil house

Scale 1:1

